



STATE OF NORTH CAROLINA  
DEPARTMENT OF TRANSPORTATION

ROY COOPER  
GOVERNOR

J.R. "JOEY" HOPKINS  
SECRETARY

**DATE:** September 11, 2024  
**TO:** Wright R. Archer, III, PE  
Division Engineer  
Division 7  
**FROM:** Erin Lesh, GISP  
Supervisor, Spatial Data Operations Group  
Geographic Information Systems Unit  
**SUBJECT:** 2024 District 2 Road System Changes

The GIS Unit's Spatial Data Operations Group has been authorized to make the changes indicated below to the state road system. We request that you update the related maps and files in your offices and install appropriate road number signs, if necessary. If our system changes do not conform to the actual conditions in the field, please return this memorandum with recommendations.

Document Number	County	Approval Date
LRS_16651_09-24	GUILFORD	01/04/1991

Questions or comments about changes should be referred to the GIS Help Desk at [GISHelp@ncdot.gov](mailto:GISHelp@ncdot.gov).

Thank you for your assistance.

EAL

- cc: BSIP
- Bridge Maintenance
- Division Right of Way
- IMG
- Pavement Management
- Permit Unit
- State Road Maintenance
- Traffic Engineering
- Traffic Surveys

**MAILING ADDRESS:**  
NC DEPARTMENT OF TRANSPORTATION  
GEOGRAPHIC INFORMATION SYSTEMS UNIT  
1521 MAIL SERVICE CENTER  
RALEIGH, NC 27699-1521

Telephone: (919) 707-2165  
FAX: 919-707-2210  
Customer Service: 1-877-368-4968  
Website: [www.ncdot.gov](http://www.ncdot.gov)

**LOCATION:**  
1020 BIRCH RIDGE DR  
RALEIGH, NC 27610

# 2024 Road System Changes

---

**Project Name:** LRS\_16651\_09-24  
**Date:** 01/04/1991  
**County:** GUILFORD

## Additions

<b>Route</b>	<b>Street Name</b>	<b>Mileage</b>	<b>Map</b>
SR 2469		0.1	

---

## Deletions

<b>Route</b>	<b>Street Name</b>	<b>Mileage</b>	<b>Map</b>
None			

---

## Reassignments

<b>Existing Route</b>	<b>New Route</b>	<b>Street Name</b>	<b>Mileage</b>	<b>Map</b>
None				

---

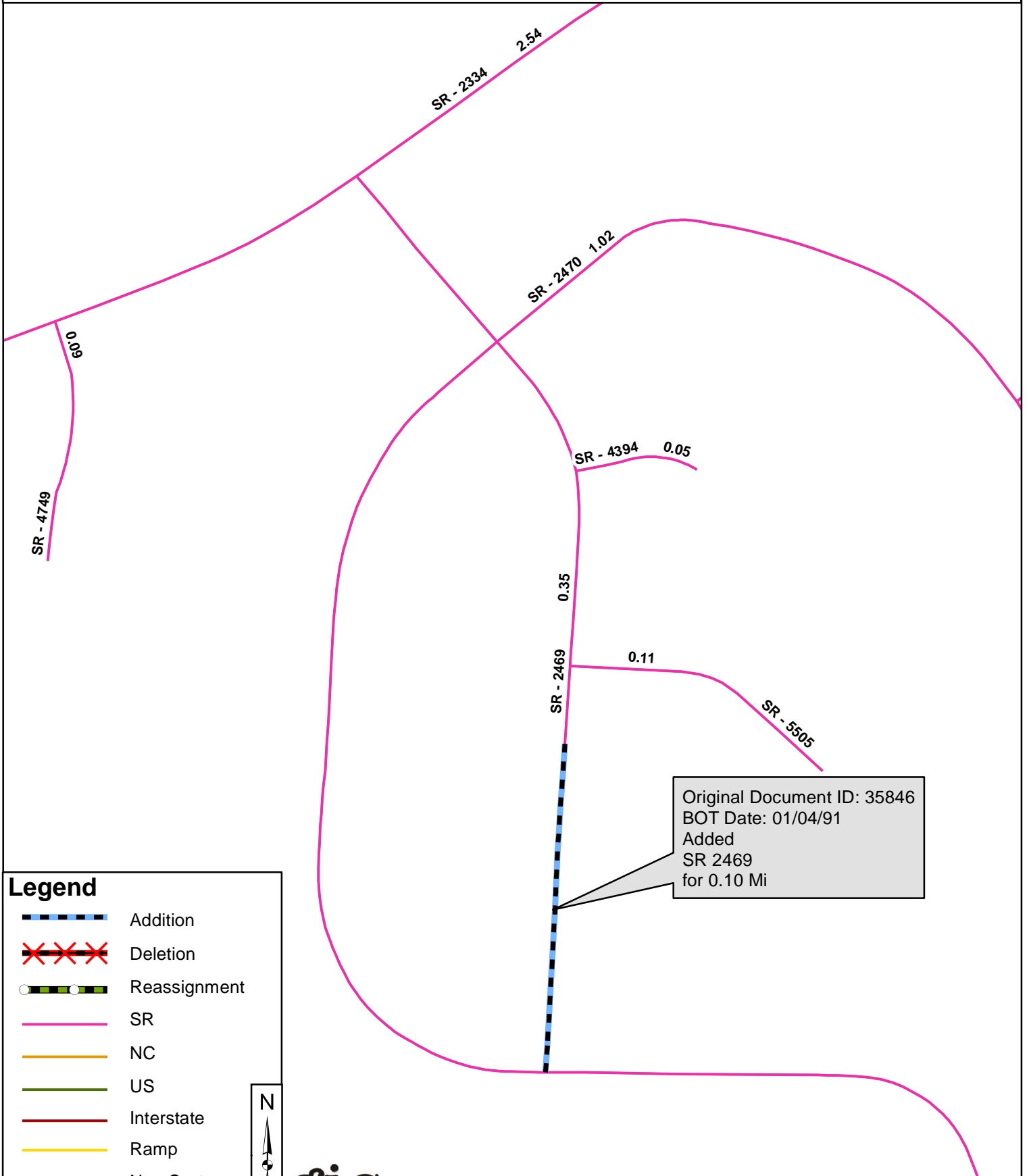

Original Document ID: 35846  
 BOT Date: 01/04/91  
 Added  
 SR 2469  
 for 0.10 Mi

**Legend**

-  Addition
-  Deletion
-  Reassignment
-  SR
-  NC
-  US
-  Interstate
-  Ramp
-  Non-System
-  Obliterated

