



STATE OF NORTH CAROLINA
DEPARTMENT OF TRANSPORTATION

JOSH STEIN
GOVERNOR

DANIEL H. JOHNSON
SECRETARY

DATE: May 13, 2026
TO: Wright R. Archer, III, PE
 Division Engineer
 Division 7
FROM: Erin Lesh, GISP
 Supervisor, Spatial Data Operations Group
 Geographic Information Systems Unit
SUBJECT: 2026 District 1 Road System Changes

The GIS Unit's Spatial Data Operations Group has been authorized to make the changes indicated below to the state road system. We request that you update the related maps and files in your offices and install appropriate road number signs, if necessary. If our system changes do not conform to the actual conditions in the field, please return this memorandum with recommendations.

| Document Number | County | Approval Date |
|-----------------|----------|---------------|
| COR_001_05-26_1 | ALAMANCE | 04/26/1956 |

Questions or comments about changes should be referred to the GIS Help Desk at GISHelp@ncdot.gov.

Thank you for your assistance.

EAL

- cc: BSIP
 Bridge Maintenance
 Division Right of Way
 IMG
 Pavement Management
 Permit Unit
 Rail Coordination & Safety
 State Road Maintenance
 Traffic Engineering
 Traffic Surveys

MAILING ADDRESS:

NC DEPARTMENT OF TRANSPORTATION
 GEOGRAPHIC INFORMATION SYSTEMS UNIT
 1521 MAIL SERVICE CENTER
 RALEIGH, NC 27699-1521

Telephone: (919) 707-2165
 FAX: 919-707-2210
 Customer Service: 1-877-368-4968
 Website: www.ncdot.gov

LOCATION:

1020 BIRCH RIDGE DR
 RALEIGH, NC 27610

2026 Road System Changes

Project Name: COR_001_05-26_1

Date: 04/26/1956

County: ALAMANCE

Additions

| Route | Street Name | Mileage | Map |
|--------------|--------------------|----------------|------------|
| SR 1900 | GEORGE MILES RD | 0.45 | |

Deletions

Route

None

Reassignments

Route

None

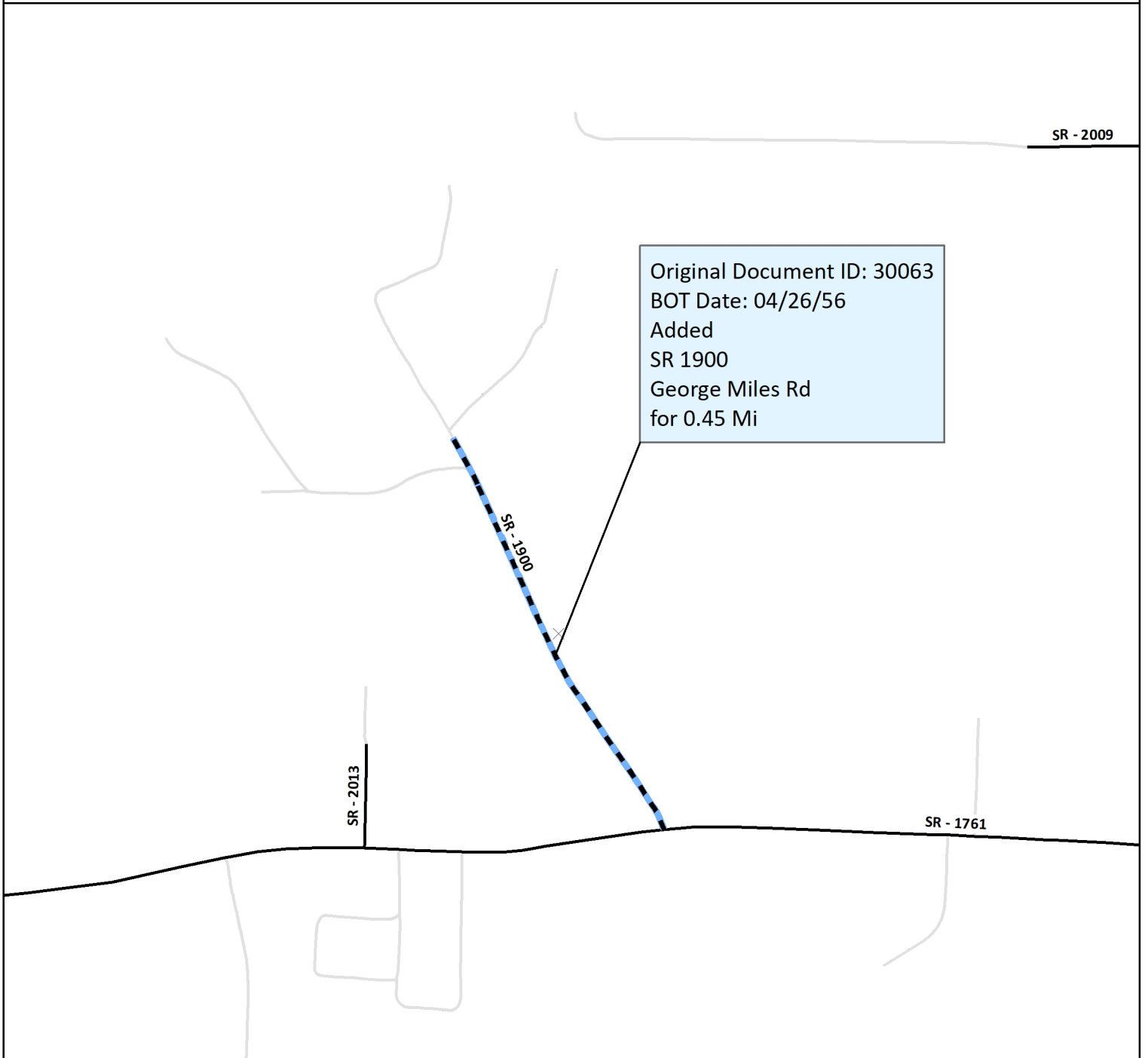

Legend

- Addition
- Deletion
- Reassignment
- Primary Routes
- Secondary Routes
- Non-System and Other Agency Routes
- Obliterated

N

