



STATE OF NORTH CAROLINA  
DEPARTMENT OF TRANSPORTATION

ROY COOPER  
GOVERNOR

J. ERIC BOYETTE  
SECRETARY

**DATE:** March 15, 2023  
**TO:** Michael A. Pettyjohn, PE  
Division Engineer  
Division 11  
**FROM:** Erin Lesh, GISP  
Supervisor, Spatial Data Operations Group  
Geographic Information Systems Unit  
**SUBJECT:** 2023 District 3 Road System Changes

The GIS Unit's Spatial Data Operations Group has been authorized to make the changes indicated below to the state road system. We request that you update the related maps and files in your offices and install appropriate road number signs, if necessary. If our system changes do not conform to the actual conditions in the field, please return this memorandum with recommendations.

Document Number	County	Approval Date
LRS_13295_03-23	ASHE	07/29/1954

Questions or comments about changes should be referred to the GIS Help Desk at [GISHelp@ncdot.gov](mailto:GISHelp@ncdot.gov).

Thank you for your assistance.

EAL

cc: BSIP  
Bridge Maintenance  
Division Right of Way  
IMG  
Pavement Management  
Permit Unit  
State Road Maintenance  
Traffic Engineering  
Traffic Surveys

**MAILING ADDRESS:**  
NC DEPARTMENT OF TRANSPORTATION  
GEOGRAPHIC INFORMATION SYSTEMS UNIT  
1521 MAIL SERVICE CENTER  
RALEIGH, NC 27699-1521

Telephone: (919) 707-2165  
FAX: 919-707-2210  
Customer Service: 1-877-368-4968  
Website: [www.ncdot.gov](http://www.ncdot.gov)

**LOCATION:**  
4101 CAPITAL BLVD.  
RALEIGH, NC 27604

# 2023 Road System Changes

---

**Project Name:** LRS\_13295\_03-23  
**Date:** 07/29/1954  
**County:** ASHE

## Additions

<b>Route</b>	<b>Street Name</b>	<b>Mileage</b>	<b>Map</b>
SR 1318		0.8	

---

## Deletions

<b>Route</b>	<b>Street Name</b>	<b>Mileage</b>	<b>Map</b>
None			

---

## Reassignments

<b>Existing Route</b>	<b>New Route</b>	<b>Street Name</b>	<b>Mileage</b>	<b>Map</b>
None				

---

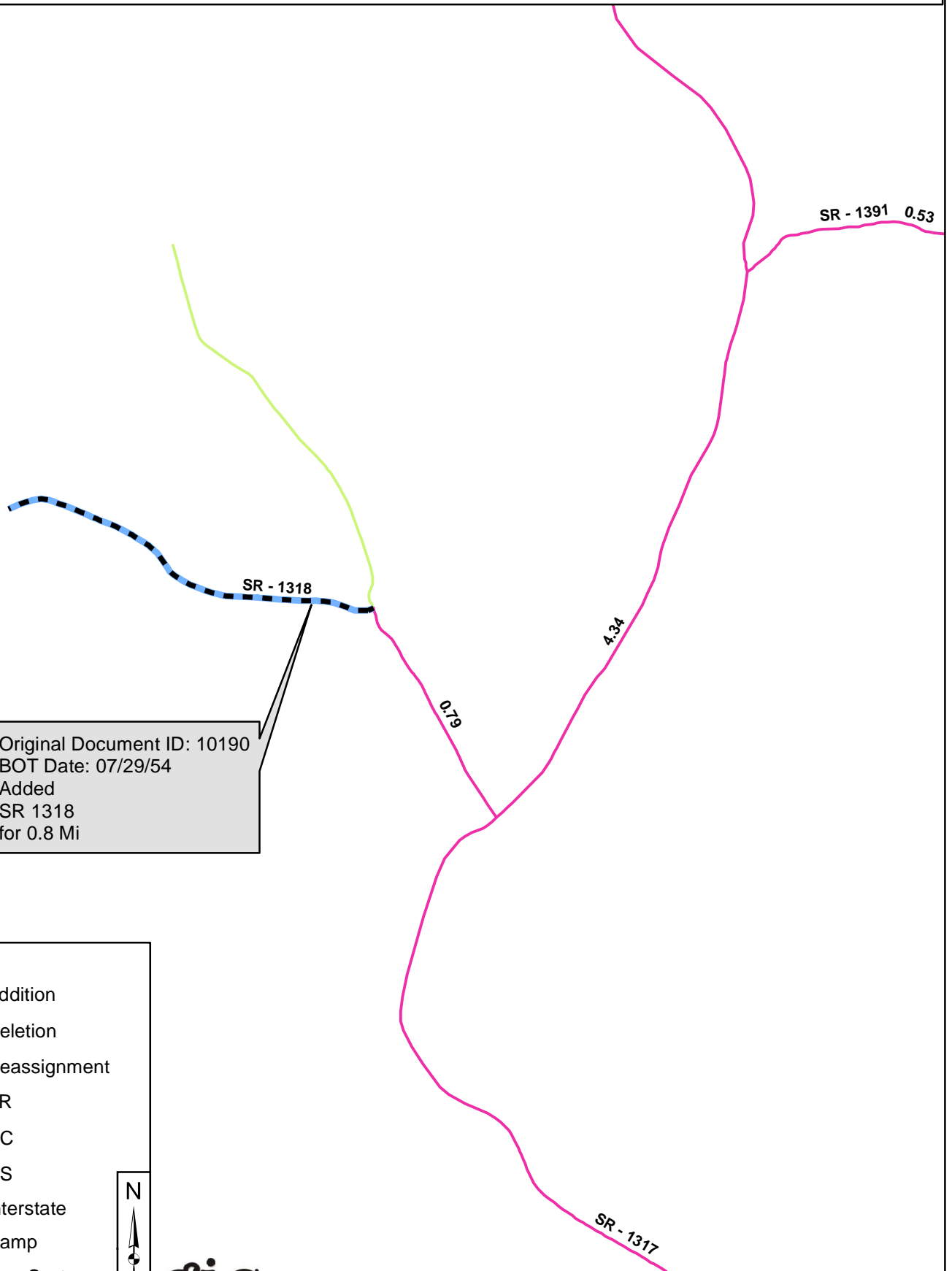

Original Document ID: 10190  
 BOT Date: 07/29/54  
 Added  
 SR 1318  
 for 0.8 Mi

**Legend**

-  Addition
-  Deletion
-  Reassignment
-  SR
-  NC
-  US
-  Interstate
-  Ramp
-  Non-System
-  Obliterated

