



STATE OF NORTH CAROLINA  
DEPARTMENT OF TRANSPORTATION

BEVERLY EAVES PERDUE  
GOVERNOR

Wednesday, January 30, 2013

EUGENE A. CONTI, JR.  
SECRETARY

**MEMORANDUM TO:** Mr. Robert W. Lewis, PE  
Division Engineer  
Division 4

**FROM:** John C. Farley, Manager  
Geographic Information Systems Unit

**SUBJECT:** 2013 District 2 Road Sytem Changes

The Data Conversion Group has been authorized to make the following changes to the state road system as indicated below. We request that you make similar changes to the related maps and files in your Division and District offices, and install appropriate road number signs if necessary. we have updated our records accordingly. If our system changes do not conform to the actual conditions in the field, please return this memorandum with recommendations.

Request Number	County	Approval Date
FR_97_04-39_1	WILSON	4/15/1939

Inquiries about changes should be referred to the GIS Help Desk at (919) 707-2152.  
Thank you for your assistance.

JCF

- cc: BSIP
- Bridge Maintenance
- Division Right of Way
- IMG
- Pavement Management
- Permit Unit
- State Road Maintenance
- Traffic Engineering
- Traffic Surveys

---







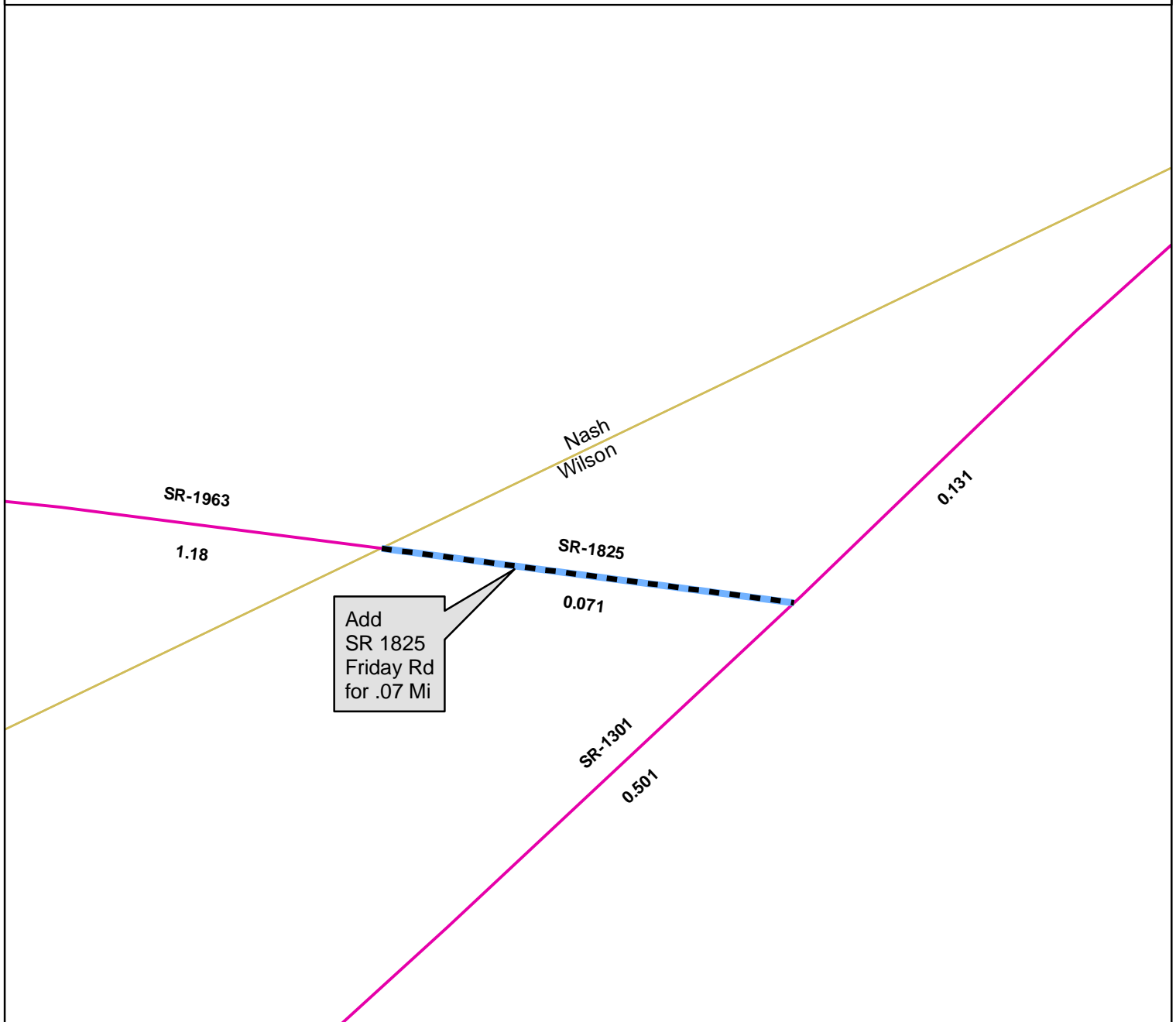

# 2013 ROAD SYSTEM CHANGES

---

<b>FIELD REQUEST</b>	<b>COUNTY</b>	<b>APPROVAL DATE</b>	<b>NEW ROUTE</b>	<b>EXISTING ROUTE</b>	<b>STREET NAME</b>	<b>LENGTH (miles)</b>	<b>TYPE OF CHANGE</b>	<b>REMARKS (See Attached Map)</b>
FR_97_04-39_1	WILSON	4/15/1939	SR 1825		FRIDAY RD	0.07	SYSTEM ADDITION - NEW VIA FIELD REQUEST	MAP , SEGMENT



**Legend**

-  Addition
-  Deletion
-  Reassignment
-  SR
-  NC
-  US
-  Interstate
-  Ramp
-  County Boundary

