

PROJECT REFERENCE NO.	SHEET NO.
U-5875	RW02C-1
Location and Surveys	

SURVEY CONTROL SHEET U-5875
W/EXISTING CENTERLINE ALIGNMENTS PRIOR TO CONSTRUCTION

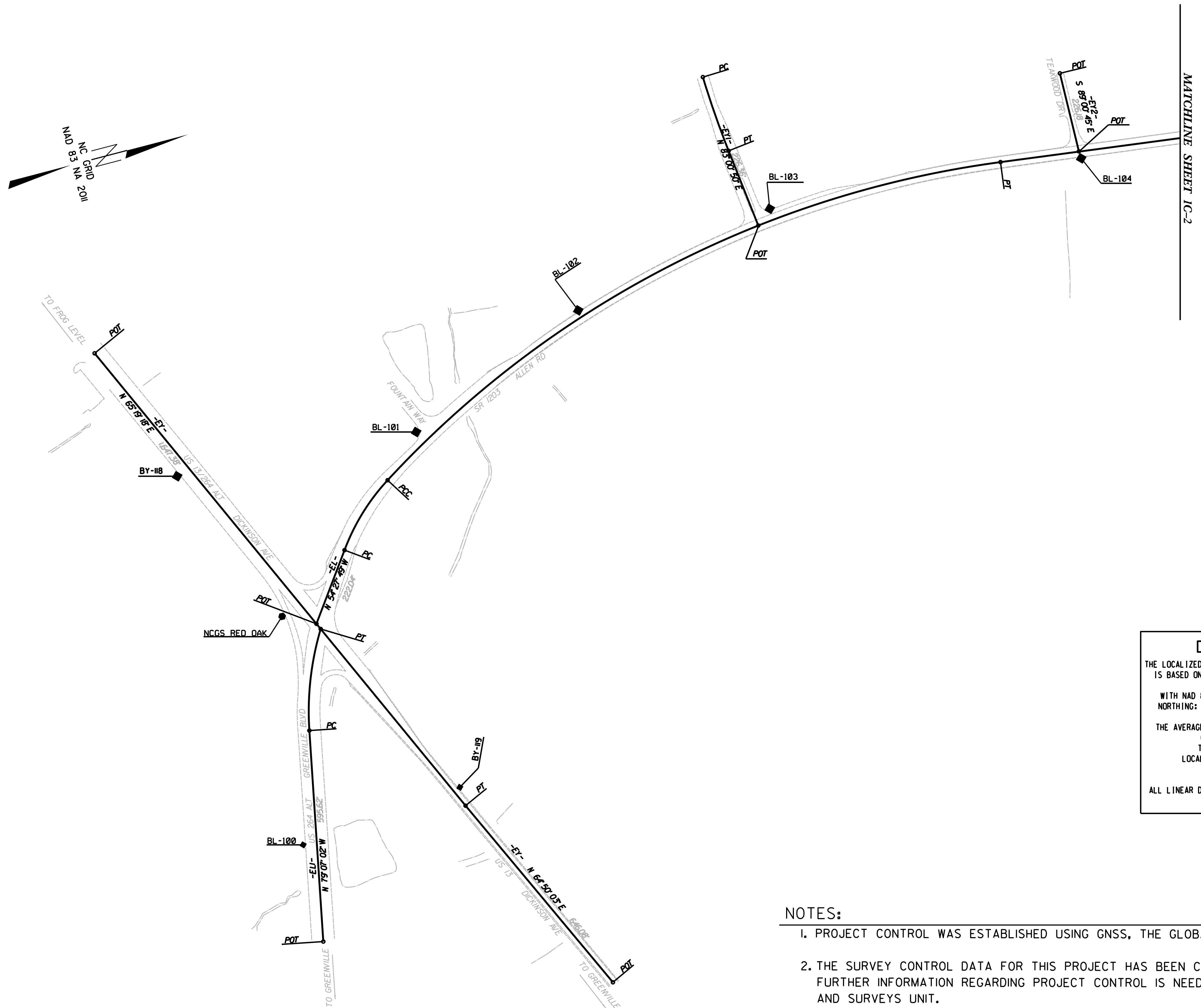

DATUM	DESCRIPTION
1	10/1/1950
2	10/1/1950
3	10/1/1950
4	10/1/1950
5	10/1/1950
6	10/1/1950
7	10/1/1950
8	10/1/1950
9	10/1/1950
10	10/1/1950
11	10/1/1950
12	10/1/1950
13	10/1/1950
14	10/1/1950
15	10/1/1950
16	10/1/1950
17	10/1/1950
18	10/1/1950
19	10/1/1950
20	10/1/1950
21	10/1/1950
22	10/1/1950
23	10/1/1950
24	10/1/1950
25	10/1/1950
26	10/1/1950
27	10/1/1950
28	10/1/1950
29	10/1/1950
30	10/1/1950
31	10/1/1950
32	10/1/1950
33	10/1/1950
34	10/1/1950
35	10/1/1950
36	10/1/1950
37	10/1/1950
38	10/1/1950
39	10/1/1950
40	10/1/1950
41	10/1/1950
42	10/1/1950
43	10/1/1950
44	10/1/1950
45	10/1/1950
46	10/1/1950
47	10/1/1950
48	10/1/1950
49	10/1/1950
50	10/1/1950
51	10/1/1950
52	10/1/1950
53	10/1/1950
54	10/1/1950
55	10/1/1950
56	10/1/1950
57	10/1/1950
58	10/1/1950
59	10/1/1950
60	10/1/1950
61	10/1/1950
62	10/1/1950
63	10/1/1950
64	10/1/1950
65	10/1/1950
66	10/1/1950
67	10/1/1950
68	10/1/1950
69	10/1/1950
70	10/1/1950
71	10/1/1950
72	10/1/1950
73	10/1/1950
74	10/1/1950
75	10/1/1950
76	10/1/1950
77	10/1/1950
78	10/1/1950
79	10/1/1950
80	10/1/1950
81	10/1/1950
82	10/1/1950
83	10/1/1950
84	10/1/1950
85	10/1/1950
86	10/1/1950
87	10/1/1950
88	10/1/1950
89	10/1/1950
90	10/1/1950
91	10/1/1950
92	10/1/1950
93	10/1/1950
94	10/1/1950
95	10/1/1950
96	10/1/1950
97	10/1/1950
98	10/1/1950
99	10/1/1950
100	10/1/1950

THE LOCALIZED COORDINATE SYSTEM DEVELOPED FOR THIS PROJECT
IS BASED ON THE STATE PLANE COORDINATES ESTABLISHED BY
NCGS FOR MONUMENT "MARY"
WITH NAD 83/NA 2011 STATE PLANE GRID COORDINATES OF
NORTHING: 676133.680(±) EASTING: 2467304.200(±)
ELEVATION: 77.840(±)
THE AVERAGE COMBINED GRID FACTOR USED ON THIS PROJECT
(GROUND TO GRID) IS: 0.999892150
THE N.C. LAMBERT GRID BEARING AND
LOCALIZED HORIZONTAL GRID DISTANCE FROM
"MARY" TO -L- STATION IS

ALL LINEAR DIMENSIONS ARE LOCALIZED HORIZONTAL DISTANCES
VERTICAL DATUM USED IS NAVD 88

NOTES:

1. PROJECT CONTROL WAS ESTABLISHED USING GNSS, THE GLOBAL NAVIGATION SATELLITE SYSTEM.
2. THE SURVEY CONTROL DATA FOR THIS PROJECT HAS BEEN COMPILED FROM VARIOUS SOURCES. IF FURTHER INFORMATION REGARDING PROJECT CONTROL IS NEEDED, PLEASE CONTACT THE LOCATION AND SURVEYS UNIT.

NOTE: DRAWING NOT TO SCALE

REVISIONS

09-JAN-2019 09:25
N:\URBANJOBS\U-5875\Control Sheets\U5875_LS_rw02c-l.dgn
mcrhodes AT L SD2-299767

6/2/99