

LEFT EXTENSION QUANTITIES				
CLASS A CONCRETE				
BARREL @	1.54	CY/FT	13.5	C.Y.
WINGS, ETC.			14.4	C.Y.
BOTTOM SLAB STEP			1.6	C.Y.
TOTAL			29.5	C.Y.
REINFORCING STEEL				
BARREL			1,984	LBS.
WINGS, ETC.			900	LBS.
TOTAL			2,884	LBS.
CULVERT EXCAVATION			LUMP SUM	
FOUNDATION COND. MAT'L.			11 TONS	

RIGHT EXTENSION QUANTITIES				
CLASS A CONCRETE				
BARREL @	1.54	CY/FT	10.8	C.Y.
WINGS, ETC.			19.9	C.Y.
BOTTOM SLAB STEP			1.6	C.Y.
SILLS			0.4	C.Y.
TOTAL			32.7	C.Y.
REINFORCING STEEL				
BARREL			1,635	LBS.
WINGS, ETC.			1,180	LBS.
TOTAL			2,815	LBS.
CULVERT EXCAVATION			LUMP SUM	
FOUNDATION COND. MAT'L.			9 TONS	

LEFT EXTENSION BAR SCHEDULE					
BAR	NO.	SIZE	TYPE	LENGTH	WEIGHT
A1	26	#4	1	5'-7"	97
A2	43	#4	1	4'-8"	134
A100	13	#5	STR	13'-8"	185
A200	13	#4	STR	10'-2"	88
A250	13	#4	STR	5'-5"	47
A300	13	#4	STR	13'-8"	119
A400	13	#4	STR	10'-2"	88
A450	13	#4	STR	5'-5"	47
B1	26	#4	STR	10'-3"	178
B2	26	#4	STR	8'-4"	145
B3	17	#4	STR	10'-3"	116
C1	63	#4	STR	8'-4"	351
D1	18	#6	STR	2'-6"	68
G1	4	#5	STR	13'-8"	57
H1	8	#4	STR	10'-2"	54
H2	8	#4	STR	5'-5"	29
L1	8	#6	2	4'-0"	48
L2	6	#6	2	3'-3"	29
L3	8	#6	3	4'-9"	57
L4	6	#6	3	5'-3"	47
REINFORCING STEEL					1,984 LBS.

BAR TYPE					
<div><div><div>VERTICAL LEG</div><div>①</div><div>6" R.</div><div>2'-8"</div><div>1'-9"</div><div>2'-1 1/2"</div><div>9 1/2"</div></div><div><div>1'-9"</div><div>L1</div><div>1'-3"</div><div>L2</div><div>2'-3"</div><div>L1</div><div>2'-0"</div><div>L2</div><div>VERTICAL LEG</div><div>②</div></div><div><div>VERTICAL LEG</div><div>③</div><div>3'-0"</div><div>3'-0"</div><div>L3</div><div>1'-9"</div><div>L3</div><div>L4</div><div>2'-3"</div></div></div>					
DIMENSIONS ARE OUT TO OUT					
SPLICE LENGTHS CHART					
BAR	SIZE	SPLICE LENGTH			
B1	#4	1'-10"			
A200	#4	1'-10"			
A400	#4	1'-10"			
``H``	#4	1'-10"			

RIGHT EXTENSION BAR SCHEDULE					
BAR	NO.	SIZE	TYPE	LENGTH	WEIGHT
A1	20	#4	1	5'-7"	75
A2	33	#4	1	4'-8"	103
A100	10	#5	STR	13'-8"	143
A200	10	#4	STR	10'-2"	68
A250	10	#4	STR	5'-5"	36
A300	10	#4	STR	13'-8"	91
A400	10	#4	STR	10'-2"	68
A450	10	#4	STR	5'-5"	36
B1	20	#4	STR	10'-3"	137
B2	20	#4	STR	8'-4"	111
B3	13	#4	STR	10'-3"	89
C2	63	#4	STR	6'-7"	277
D1	18	#6	STR	2'-6"	68
D2	6	#6	STR	1'-4"	12
G1	4	#5	STR	13'-8"	57
H1	8	#4	STR	10'-2"	54
H2	8	#4	STR	5'-5"	29
L1	8	#6	2	4'-0"	48
L2	6	#6	2	3'-3"	29
L3	8	#6	3	4'-9"	57
L4	6	#6	3	5'-3"	47
REINFORCING STEEL					1,635 LBS.

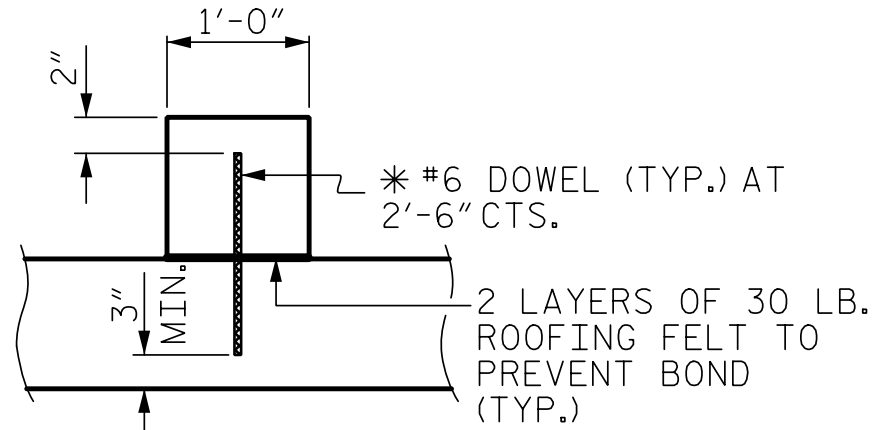

SECTION THROUGH SILL

* DOWELS MAY BE PUSHED INTO GREEN CONCRETE AFTER SLAB HAS BEEN FLOAT FINISHED.

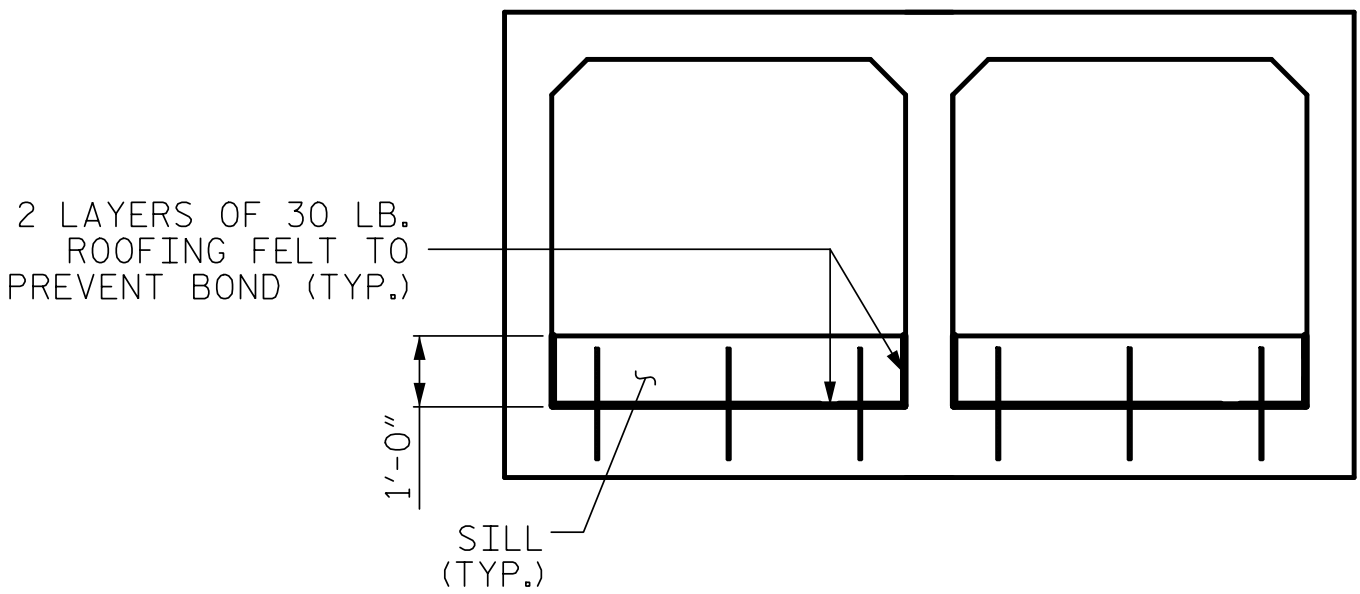

OUTLET ELEVATION

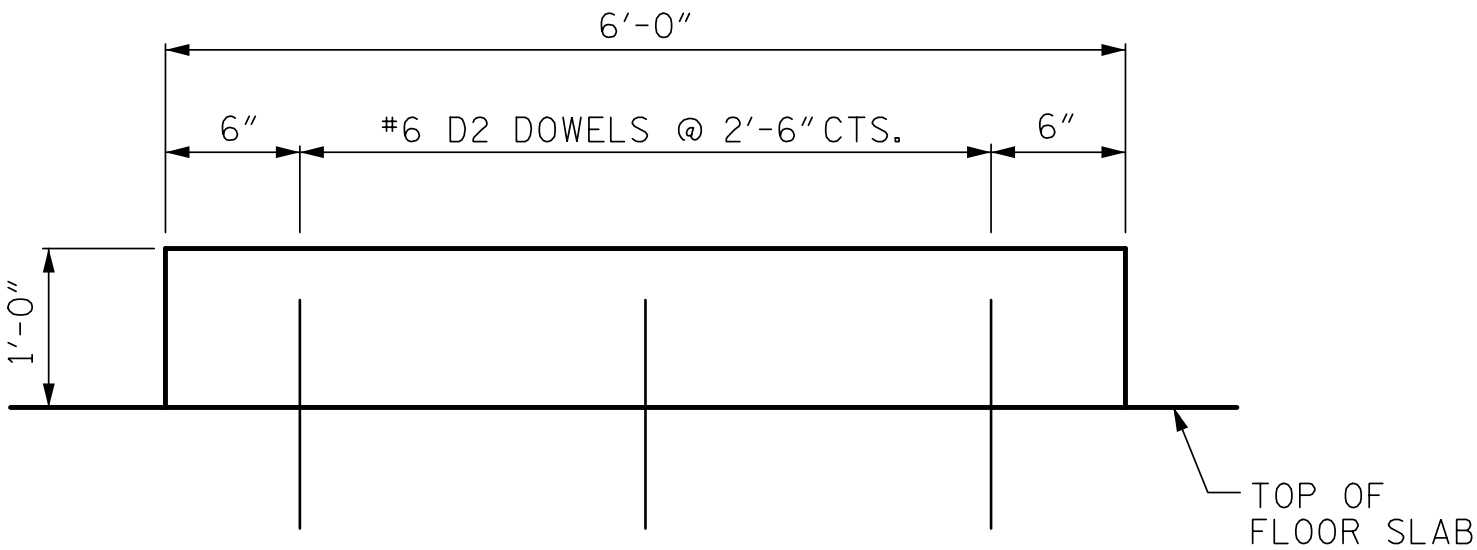

ELEVATION

SILL DETAILS

NOTES

MATERIAL EXCAVATED FROM THE EXISTING BED SHALL BE STOCKPILED FOR USE IN THE PROPOSED CULVERT EXTENSION. BED MATERIAL MAY BE SUPPLEMENTED WITH CLASS B RIP RAP AS NECESSARY. NATIVE MATERIAL BETWEEN SILLS IN THE CULVERT SHALL PROVIDE A CONTINUOUS LOW FLOW CHANNEL. NATIVE MATERIAL CONSISTS OF MATERIAL THAT IS EXCAVATED FROM THE STREAM OR FLOODPLAIN AT THE PROJECT SITE DURING CONSTRUCTION. NATIVE MATERIAL IS SUBJECT TO APPROVAL BY THE ENGINEER AND MAY BE SUBJECT TO PERMIT CONDITIONS.

THE ENTIRE COST OF WORK REQUIRED TO PLACE EXCAVATED MATERIAL OR SUPPLEMENTAL MATERIAL AS SHOWN ON THE PLANS SHALL BE INCLUDED IN THE CONTRACT LUMP SUM PRICE BID FOR CULVERT EXCAVATION.

THE ENTIRE COST OF WORK REQUIRED TO CONSTRUCT THE SILLS SHALL BE INCLUDED IN THE VARIOUS PAY ITEMS.

PROJECT NO. R-5739
NORTHAMPTON COUNTY
STATION: 451+96.00 -L-

SHEET 7 OF 9

STATE OF NORTH CAROLINA

DEPARTMENT OF TRANSPORTATION

RALEIGH

DOUBLE 6 FT. X 9 FT.

CONCRETE BOX CULVERT

LT & RT EXTENSION

90° SKEW

7/23/2025

DOCUMENT NOT CONSIDERED FINAL
UNLESS ALL SIGNATURES COMPLETED

TGS ENGINEERS

706 HILLSBOROUGH STREET

SUITE 200

RALEIGH, NC 27603

PH (919) 773-8887

CORP. LICENSE NO.: C-0275

NO.

BY:

DATE:

NO.

BY:

DATE:

1

2

3

4

NO.

BY:

DATE:

NO.

BY:

DATE:

1

2

3

4

SHEET NO.

C4-7

TOTAL SHEETS

9

DRAWN BY :	STM	DATE :	07/22
CHECKED BY :	MGC	DATE :	08/22
DESIGN ENGINEER OF RECORD:	STM	DATE :	06/22

PLAN OF FLOOR SILL LAYOUT

11/28/2023
X:\NCDOT\NR-5739\Structures\Str. #4 (451 + 96.00 -L-\Final Plans\DCNs\NR-5739.SMU.CU.STR 4.7.dgn
User:zSmith