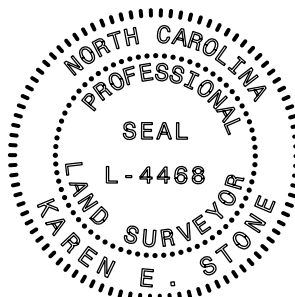

SURVEY CONTROL SHEET
W/ EXISTING CENTERLINE ALIGNMENTS PRIOR TO CONSTRUCTION

PROJECT REFERENCE NO.	SHEET NO.
R-5739	RW02C-5
Location and Surveys	
JoynerKeeny, PLLC 1051 N. Winstead Avenue Rocky Mount, NC 27804 252-977-3124 North Carolina Firm Number P-0551	
PROJECT SURVEYOR  DOCUMENT NOT CONSIDERED FINAL UNLESS ALL SIGNATURES COMPLETED	

I, KAREN E. STONE, PLS, certify that the Project Control was verified under my supervision from an actual GPS survey made under my supervision and the following information was used to perform the survey:

Class of survey: **AA**
Type of GPS field procedure: RTN
Dates of survey: February 2017 (per control file provided by NCDOT)
Datum/Epoch: NAD83/2011 DATUM
Published/Fixed-control use: N/A
Localized around: "R5739-9"
Northing: 1004104.855 (US FEET)
Easting: 2370564.222 (US FEET)
Combined grid factor: 1.000104741
Geoid model: GEOID 12A
Units: US SURVEY FEET

I also certify that this project was staked from baseline control provided by the North Carolina Department of Transportation and recovered under my supervision;

This 13th day of January, 2025.

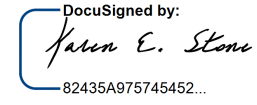
Signed by:
824354975745452

Professional Land Surveyor L-4468

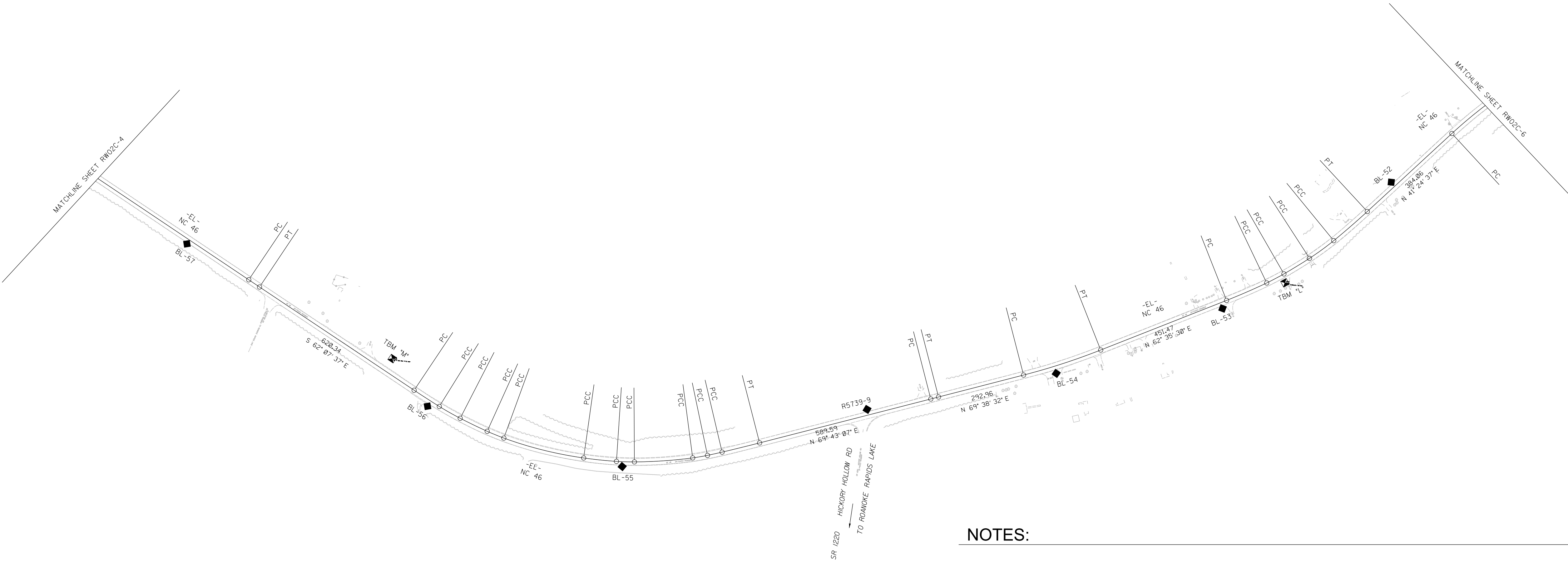

SEE SHEETS
RW02C-11 THRU RW02C-16
FOR FURTHER ALIGNMENT DETAILS

NOTES:

- PROJECT CONTROL WAS ESTABLISHED USING GNSS, THE GLOBAL NAVIGATION SATELLITE SYSTEM.
- THE SURVEY CONTROL DATA FOR THIS PROJECT HAS BEEN COMPILED FROM VARIOUS SOURCES. IF FURTHER INFORMATION REGARDING PROJECT CONTROL IS NEEDED, PLEASE CONTACT THE LOCATION AND SURVEYS UNIT.