

5/28/2019

PIPE HYDRAULIC DATA
EX. DUAL 48" RCP Sta. 12+81. -L-

DRAINAGE AREA	= 86.7	AC
DESIGN FREQUENCY	= 25	YRS
DESIGN DISCHARGE	= 110	CFS
DESIGN HW ELEVATION	= 29.8	FT
100 YEAR DISCHARGE	= 170	CFS
100 YEAR HW ELEVATION	= 30.8	FT
OVERTOPPING FREQUENCY	= 100+	YRS
OVERTOPPING DISCHARGE	= 350	CFS
OVERTOPPING ELEVATION	= 36.3	FT

PIPE HYDRAULIC DATA
EXISTING 48" RCP Sta. 13+68. -L-

DRAINAGE AREA	= 131	AC
DESIGN FREQUENCY	= 25	YRS
DESIGN DISCHARGE	= 150	CFS
DESIGN HW ELEVATION	= 33.4	FT
100 YEAR DISCHARGE	= 240	CFS
100 YEAR HW ELEVATION	= 40.7	FT
OVERTOPPING FREQUENCY	= 1/2-50	YRS
OVERTOPPING DISCHARGE	= 195	CFS
OVERTOPPING ELEVATION	= 36.3	FT

DITCH LEGEND

LEFT DITCH -----

MEDIAN DITCH - - - - -

RIGHT DITCH -----

DITCH VPI

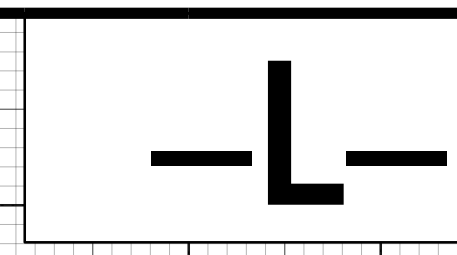

PROJECT REFERENCE NO.	U-5789	SHEET NO.	11
ROADWAY DESIGN ENGINEER		HYDRAULIC DESIGN ENGINEER	

DOCUMENT NOT CONSIDERED FINAL
UNLESS ALL SIGNATURES COMPLETED

DAVENPORT
119 BROOKSTOWN AVE, SUITE PH-1
WINSTON-SALEM, NC 27101
336-744-1656 www.davenportnc.com
NCBELS FIRM LICENSE NO. C-2522

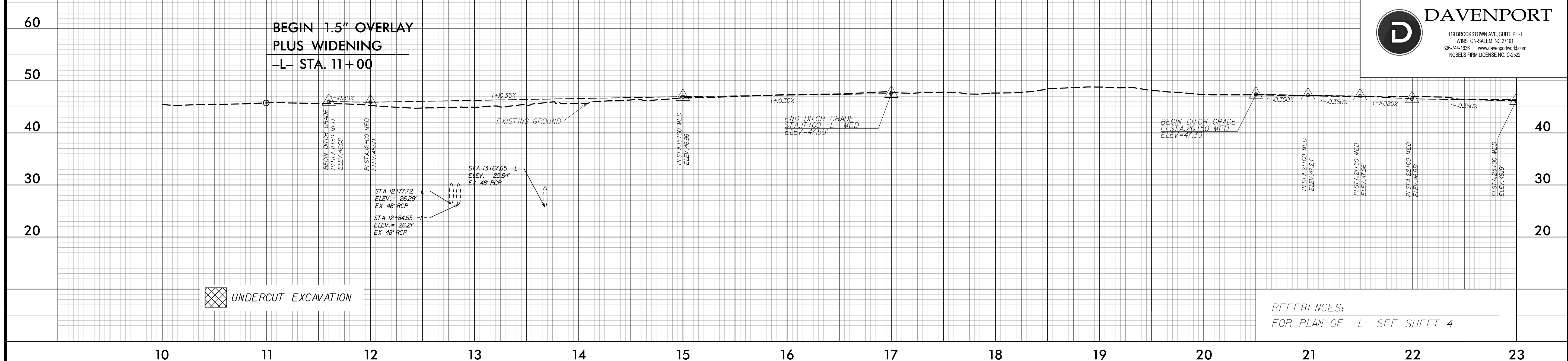

REFERENCES:
FOR PLAN OF -L- SEE SHEET 4

DITCH LEGEND

LEFT DITCH -----

MEDIAN DITCH - - - - -

RIGHT DITCH -----

DITCH VPI

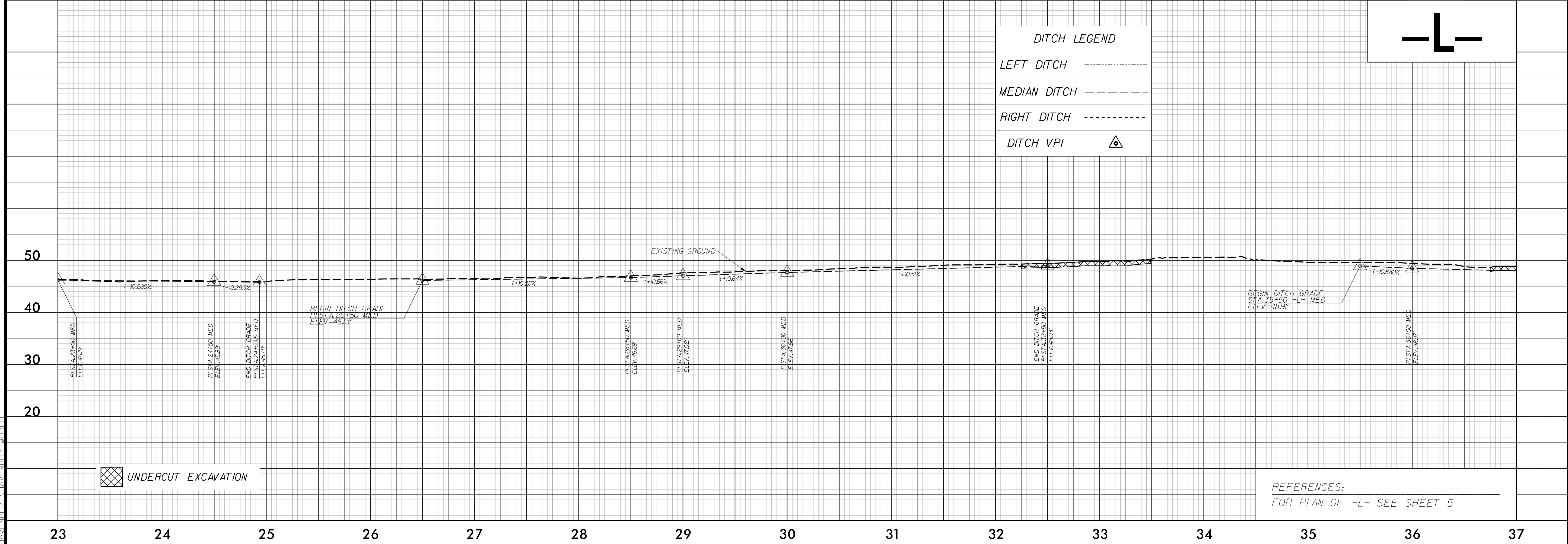
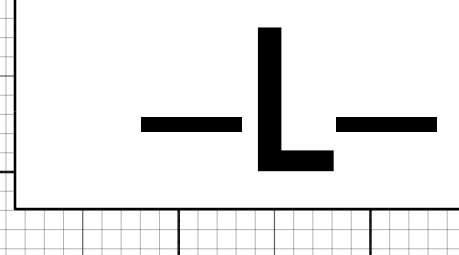

REFERENCES:
FOR PLAN OF -L- SEE SHEET 5

50,0000' / in.
Z:\2019\330907_NCDOT_U5789_NC53_Jack_DESIGN\U5789_Roadway\Pro\U5789_RDY_PSH_11_PFL_04.dgn