

TIP PROJECT: U-4913A

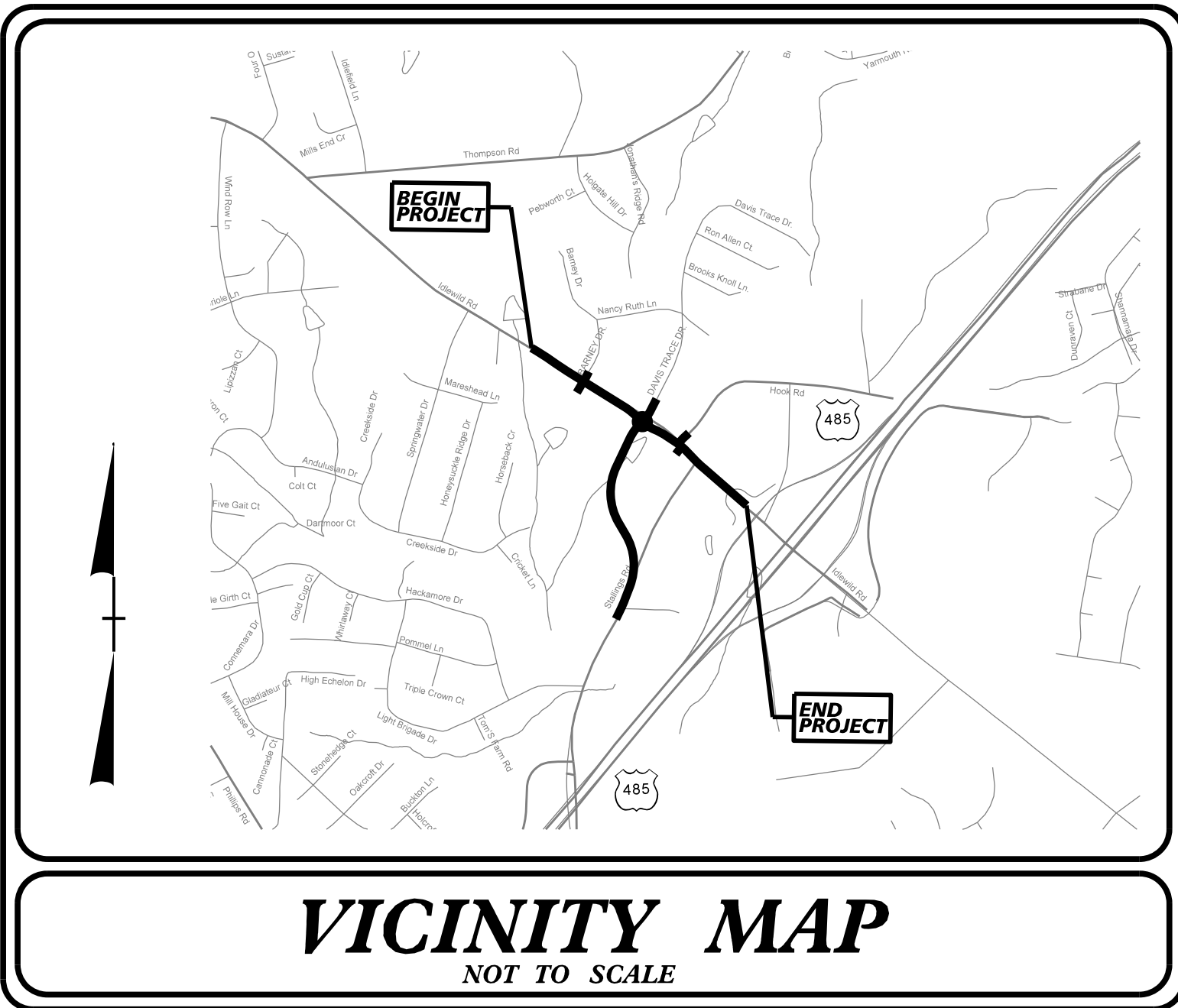

STATE OF NORTH CAROLINA
DIVISION OF HIGHWAYS
PLAN FOR PROPOSED
HIGHWAY EROSION CONTROL
MECKLENBURG COUNTY

LOCATION: IDLEWILD ROAD FROM BARNEY DRIVE AREA TO
GOVERNOR JAMES G. MARTIN FREEWAY (I-485)

TYPE OF WORK: GRADING, DRAINAGE, AND PAVING

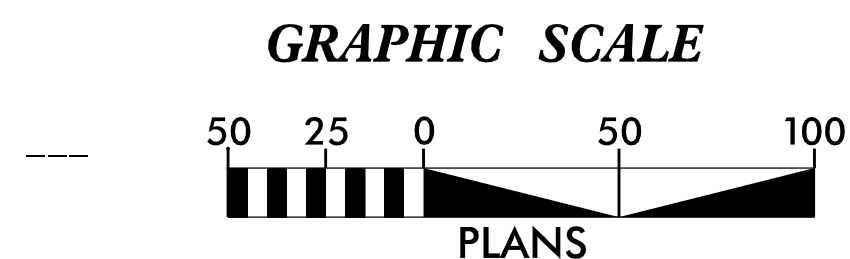
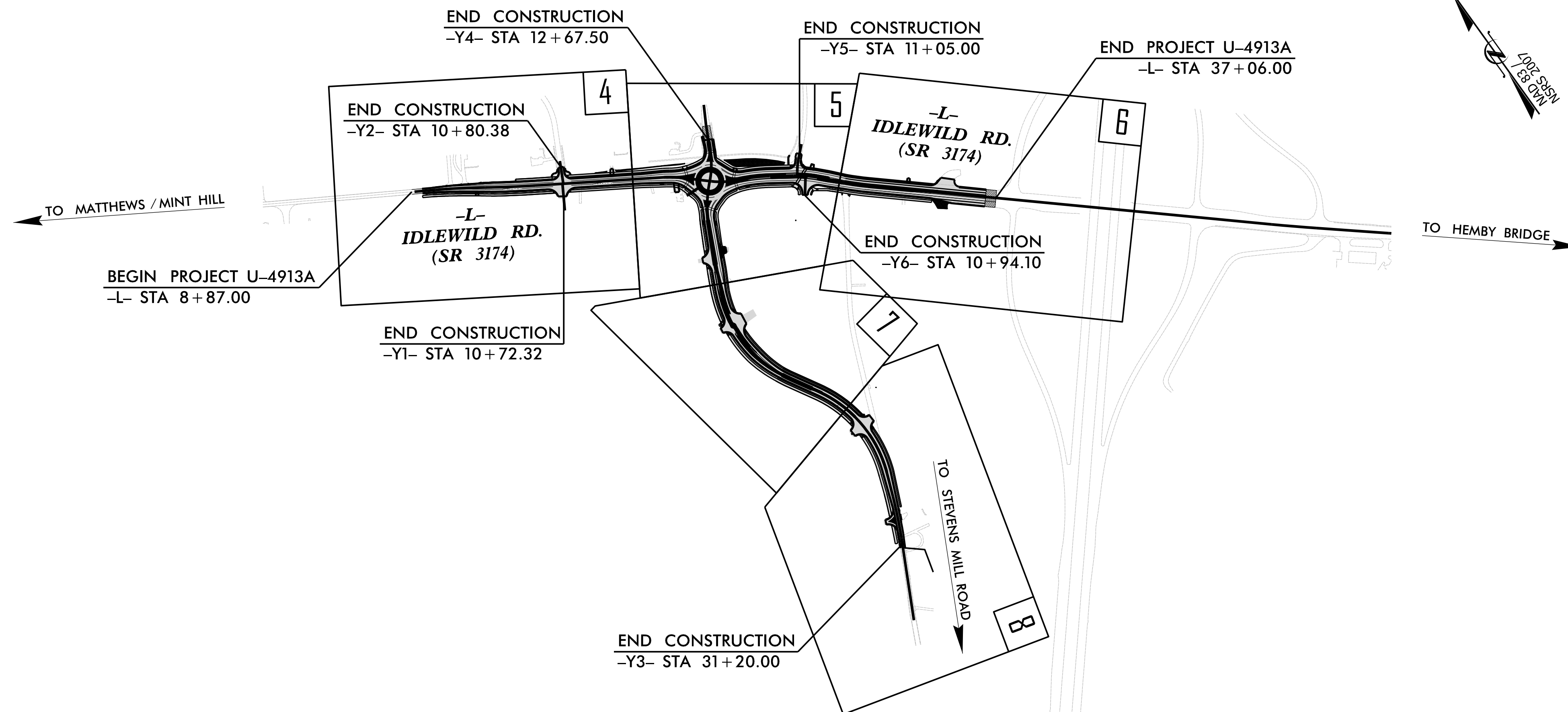

THESE EROSION AND SEDIMENT CONTROL PLANS COMPLY WITH
THE APPLICABLE REGULATIONS SET FORTH BY THE NCG-010000
GENERAL CONSTRUCTION PERMIT ISSUED BY THE NORTH
CAROLINA DIVISION OF ENERGY, MINERAL, AND LAND RESOURCES.

Kimley»Horn
200 S. TRYON ST. • CHARLOTTE, NC 28202

Prepared In the Office of:
Kimley»Horn
200 South Tryon Street, Suite 200
Charlotte, North Carolina 28202

Designed by:
Adam Recker, EIT 4733
NAME LEVEL III CERTIFICATION NO.

Roadway Standard Drawings

The "Roadway Standard Drawings"- Roadway Design Unit - N. C.
Department of Transportation - Raleigh, N. C., dated January 2024
and the latest revision thereto are applicable to this project and by
reference hereby are considered a part of these plans.

STATE	STATE PROJECT REFERENCE NO.	SHEET NO.	TOTAL SHEETS
N.C.	U-4913A	EC-1	
STATE PROJ. NO.	F.A. PROJ. NO.	DESCRIPTION	
40543.1.3	N/A	PE	
40543.2.4	N/A	RW	
40543.2.5	N/A	UTILITIES	
40543.3.2	N/A	CONST.	

DIVISION OF HIGHWAYS
STATE OF NORTH CAROLINA

Kimley»Horn

200 S. TRYON ST. • CHARLOTTE, NC 28202

RIGHT-OF-WAY REV.

CONST. REV.

PROJECT REFERENCE NO.

U-4913A

SHEET NO.

EC-2

ROADWAY DESIGN ENGINEER

HYDRAULICS ENGINEER

EROSION & SEDIMENT CONTROL LEGEND

Std. #	Description	Symbol	Std. #	Description	Symbol
1605.01	Temporary Silt Fence		1633.01	Temporary Rock Silt Check Type A	
1606.01	Special Sediment Control Fence		1633.02	Temporary Rock Silt Check Type B	
1622.01	Temporary Berms and Slope Drains		1633.03	Temporary Rock Silt Check Type A with Excelsior Matting and Flocculant	
1630.02	Silt Basin Type B		1634.01	Temporary Rock Sediment Dam Type A	
1630.03	Temporary Silt Ditch		1634.02	Temporary Rock Sediment Dam Type B	
1630.04	Stilling Basin		1635.01	Rock Pipe Inlet Sediment Trap Type A	
1630.05	Temporary Diversion		1635.02	Rock Pipe Inlet Sediment Trap Type B	
1630.06	Special Stilling Basin		1636.01	Excelsior Wattle Check	
1630.07	Skimmer Basin		1636.01	Excelsior Wattle Check with Flocculant	
1630.08	Tiered Skimmer Basin		1636.01	Coir Fiber Wattle Check	
1630.09	Earthen Dam with Skimmer		1636.01	Coir Fiber Wattle Check with Flocculant	
	Infiltration Basin		1636.02	Silt Fence Excelsior Wattle Break	
	Rock Inlet Sediment Trap:			Silt Fence Coir Fiber Wattle Break	
1632.01	Type A		1636.03	Excelsior Wattle Barrier	
1632.02	Type B		1636.03	Coir Fiber Wattle Barrier	
1632.03	Type C				

ONSITE CONCRETE WASHOUT STRUCTURE WITH LINER

Kimley»Horn
© 2025

200 S. TRYON ST. • CHARLOTTE, NC 28202

RIGHT-OF-WAY REV.

CONST. REV.

PROJECT REFERENCE NO.

U-4913A

SHEET NO.

EC-2A

ROADWAY DESIGN
ENGINEER

HYDRAULICS
ENGINEER

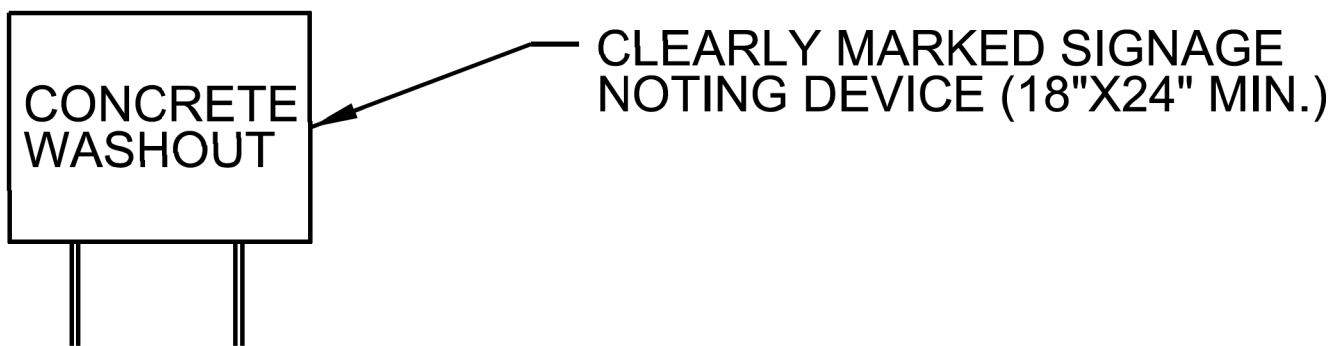
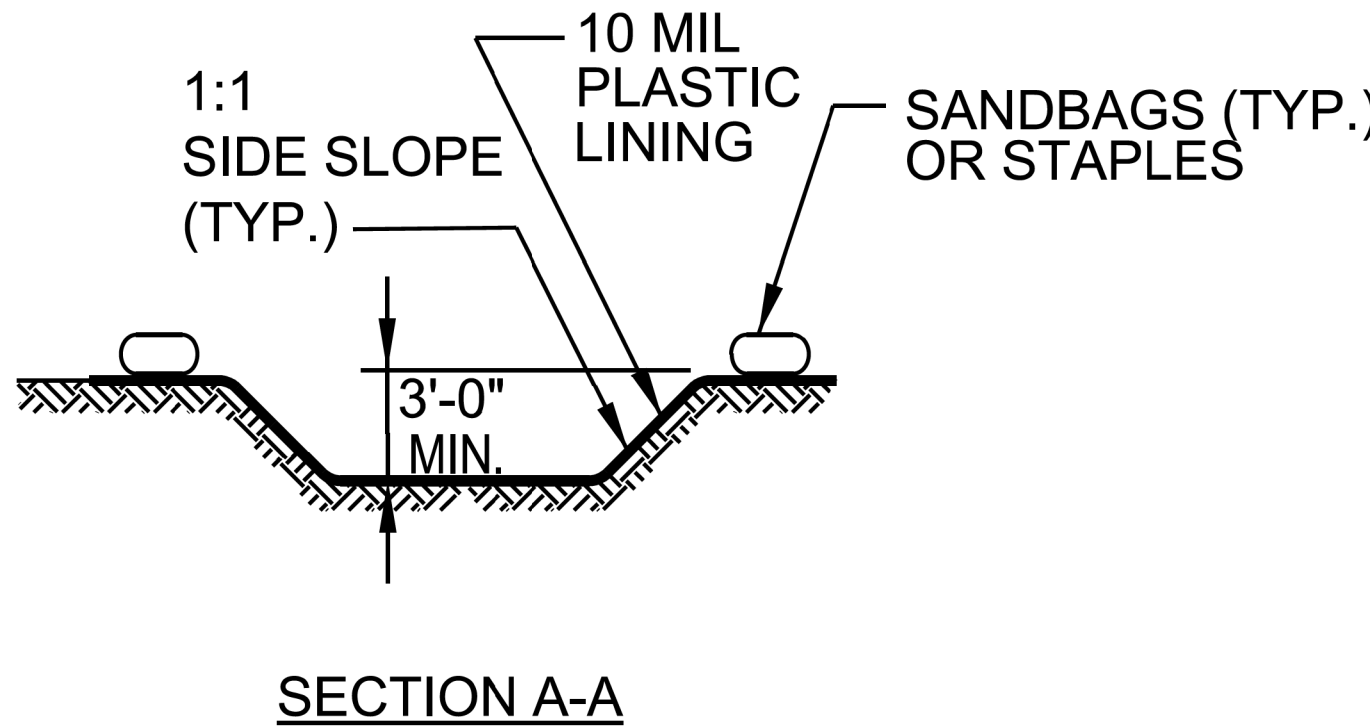
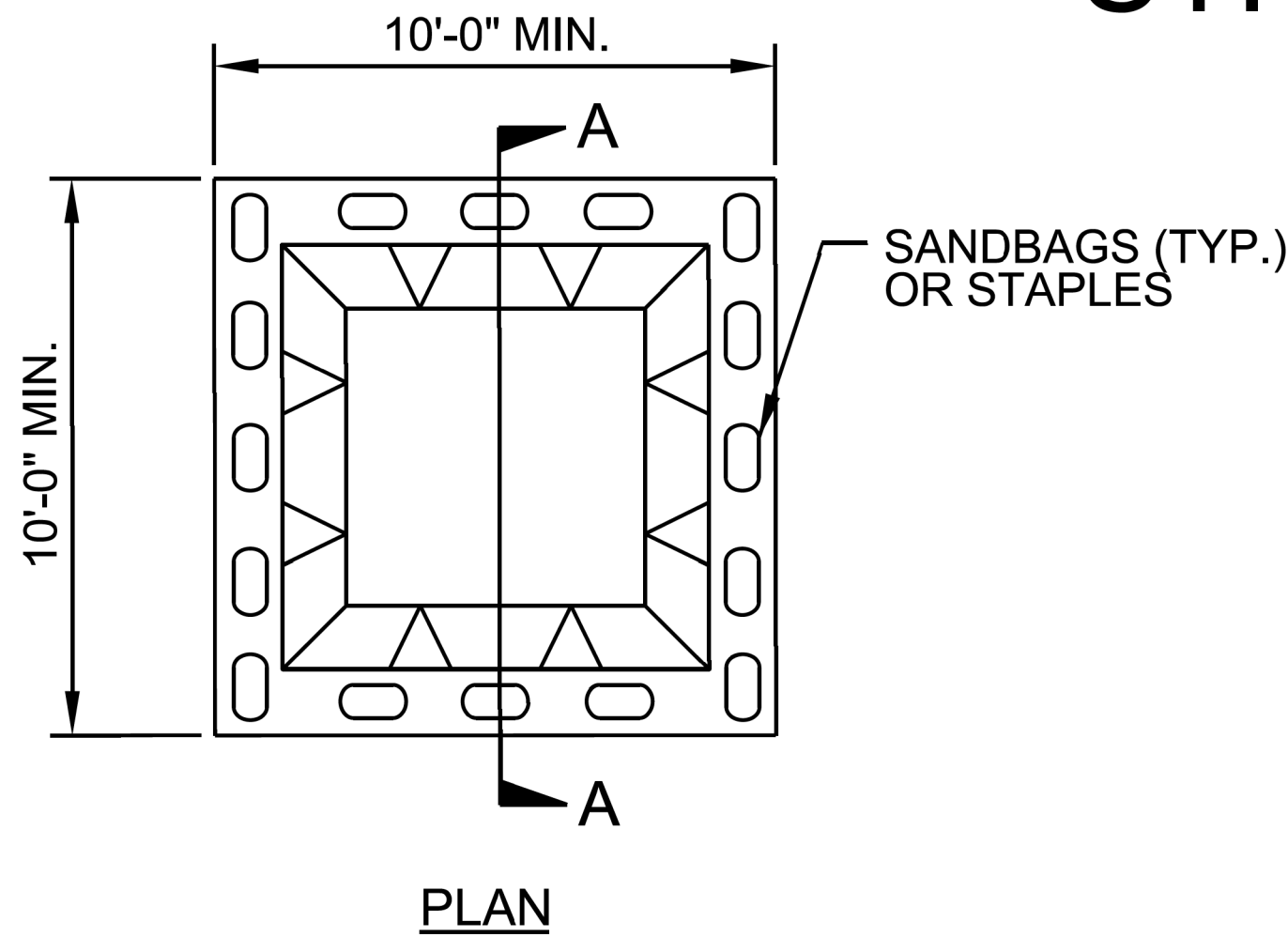

BELOW GRADE WASHOUT STRUCTURE
NOT TO SCALE

NOTES:

1. ACTUAL LOCATION DETERMINED IN FIELD
2. THE CONCRETE WASHOUT STRUCTURES SHALL BE MAINTAINED WHEN THE LIQUID AND/OR SOLID REACHES 75% OF THE STRUCTURES CAPACITY TO PROVIDE ADEQUATE HOLDING CAPACITY WITH A MINIMUM 12 INCHES OF FREEBOARD.
3. CONCRETE WASHOUT STRUCTURE NEEDS TO BE CLEARLY MARKED WITH SIGNAGE NOTING DEVICE.

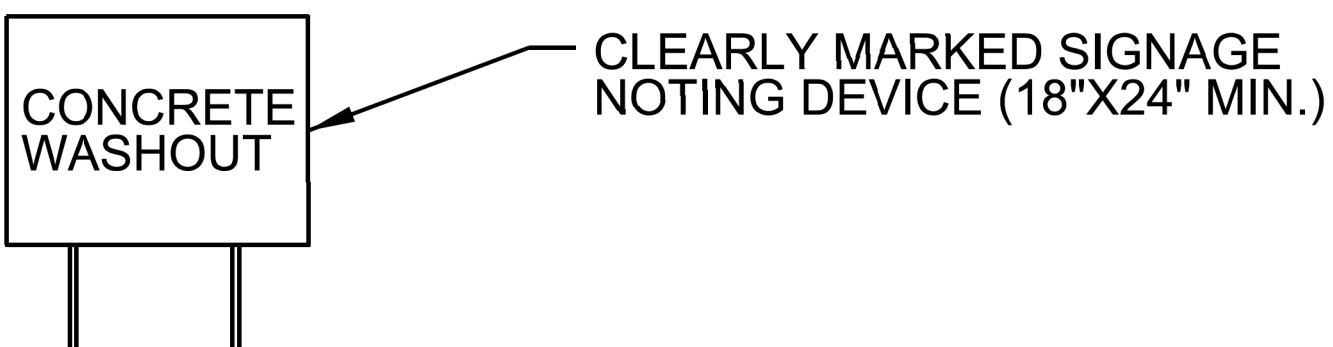
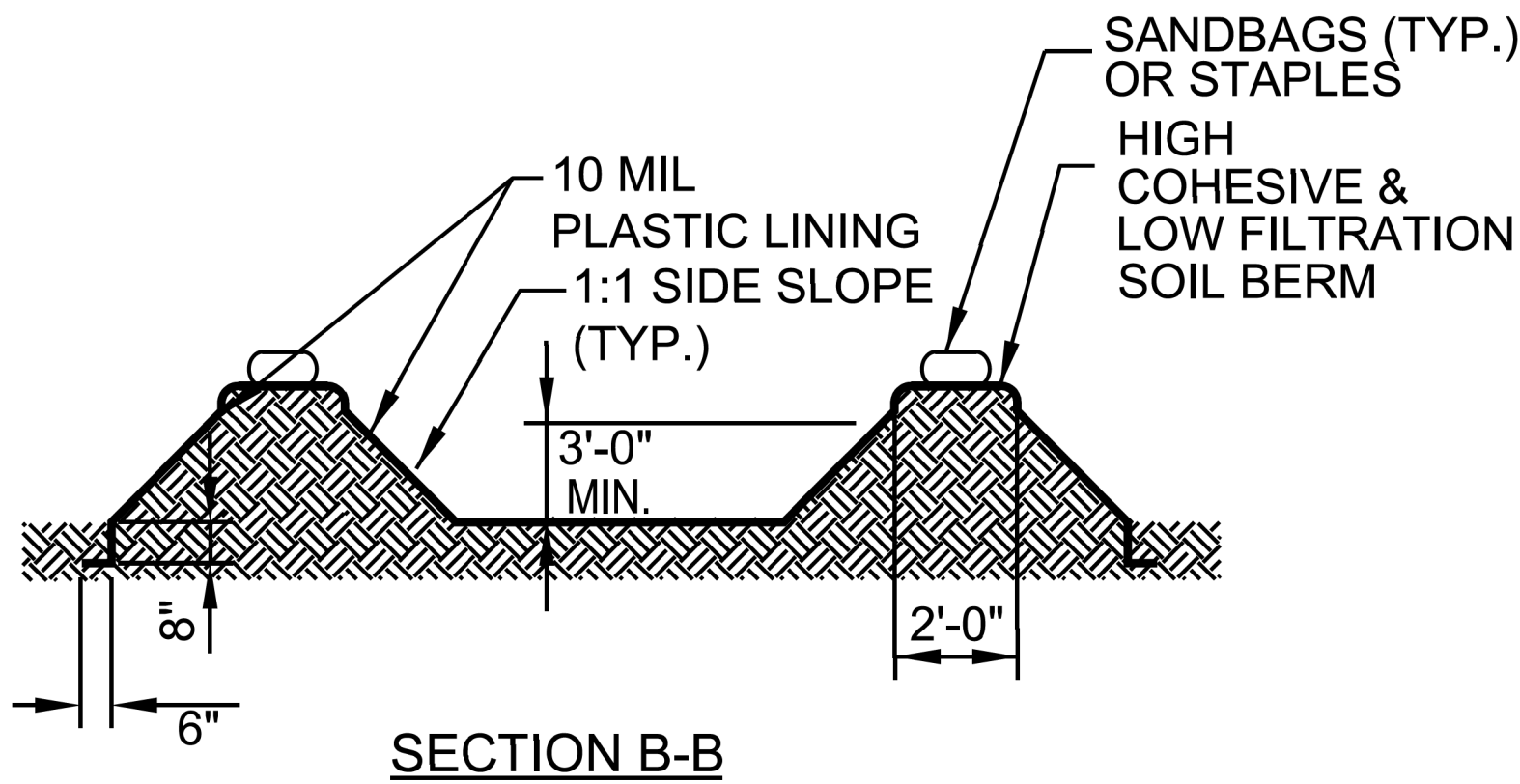
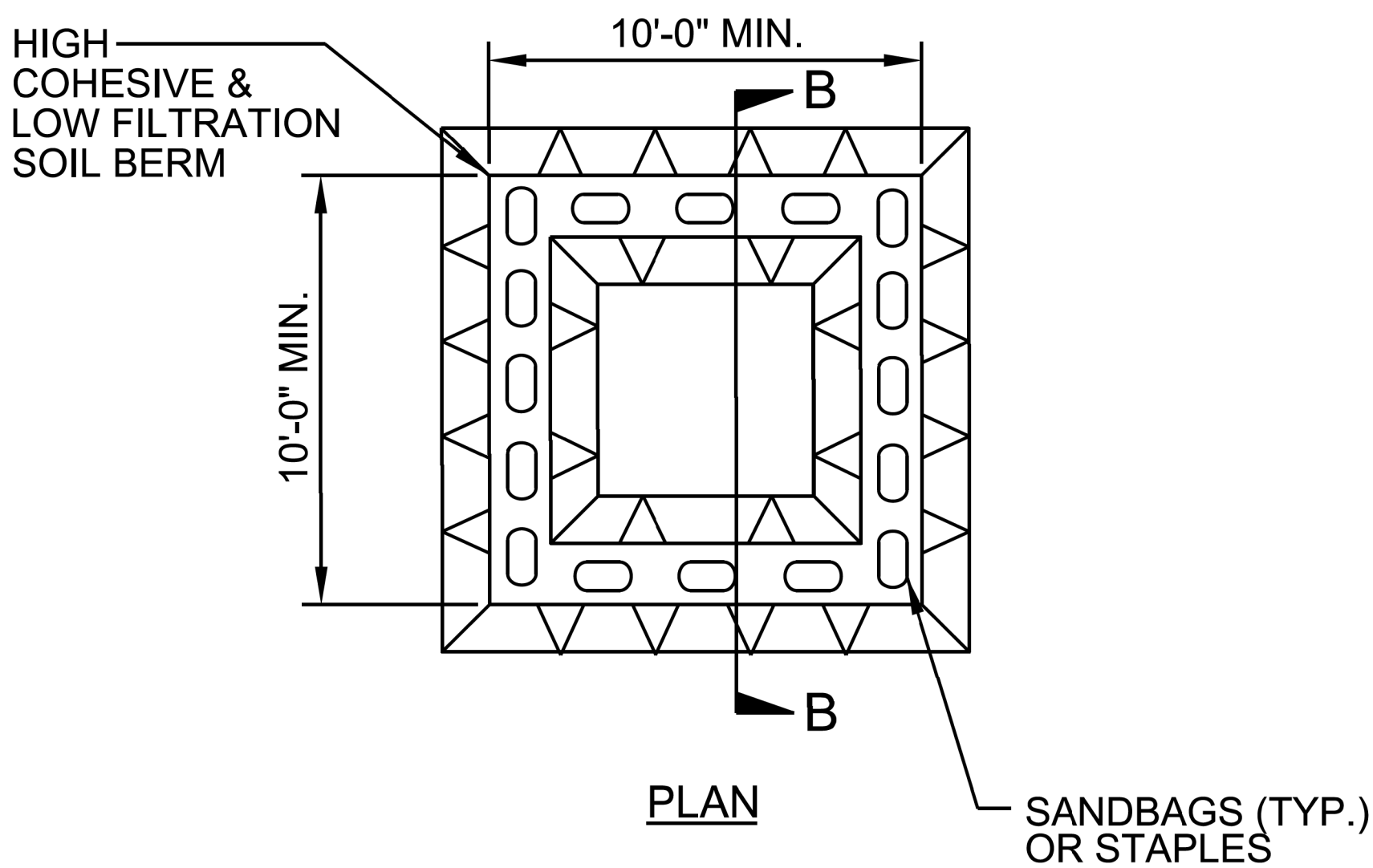

ABOVE GRADE WASHOUT STRUCTURE
NOT TO SCALE

NOTES:

1. ACTUAL LOCATION DETERMINED IN FIELD
2. THE CONCRETE WASHOUT STRUCTURES SHALL BE MAINTAINED WHEN THE LIQUID AND/OR SOLID REACHES 75% OF THE STRUCTURES CAPACITY TO PROVIDE ADEQUATE HOLDING CAPACITY WITH A MINIMUM 12 INCHES OF FREEBOARD.
3. CONCRETE WASHOUT STRUCTURE NEEDS TO BE CLEARLY MARKED WITH SIGNAGE NOTING DEVICE.

DIVISION OF HIGHWAYS
STATE OF NORTH CAROLINA

SOIL STABILIZATION SUMMARY SHEET

STRAW MATTING FOR EROSION CONTROL

[illegible]

200 S. TRYON ST. • CHARLOTTE, NC 28202

RIGHT-OF-WAY RE

CONST. RE

PROJECT REFERENCE NO.

SHEET NO.

U-4913A

EC-3

ROADWAY DESIGN
ENGINEER

**HYDRAULICS
ENGINEER**

SOIL STABILIZATION TIMEFRAMES

SITE DESCRIPTION	STABILIZATION TIME	TIMEFRAME EXCEPTIONS
PERIMETER DIKES, SWALES, DITCHES AND SLOPES	7 DAYS	NONE
HIGH QUALITY WATER (HQW) ZONES	7 DAYS	NONE
SLOPES STEEPER THAN 3:1	7 DAYS	IF SLOPES ARE 10’ OR LESS IN LENGTH AND ARE NOT STEEPER THAN 2:1, 14 DAYS ARE ALLOWED.
SLOPES 3:1 TO 4:1	14 DAYS	7 DAYS FOR SLOPES GREATER THAN 50’ IN LENGTH WITH SLOPES STEEPER THAN 4:1. 7 DAYS FOR PERIMETER DIKES, SWALES, DITCHES PERIMETER SLOPES, AND HQW ZONES
ALL OTHER AREAS WITH SLOPES FLATTER THAN 4:1	14 DAYS	7 DAYS FOR PERIMETER DIKES, SWALES, DITCHES PERIMETER SLOPES, AND HQW ZONES

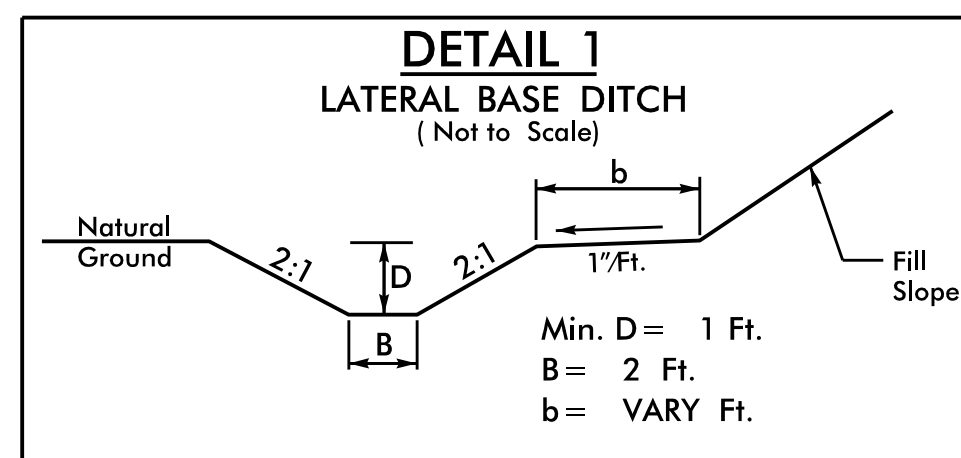

FROM -L- STA. 14+05 (LT) TO -L- STA. 15+28 (LT)

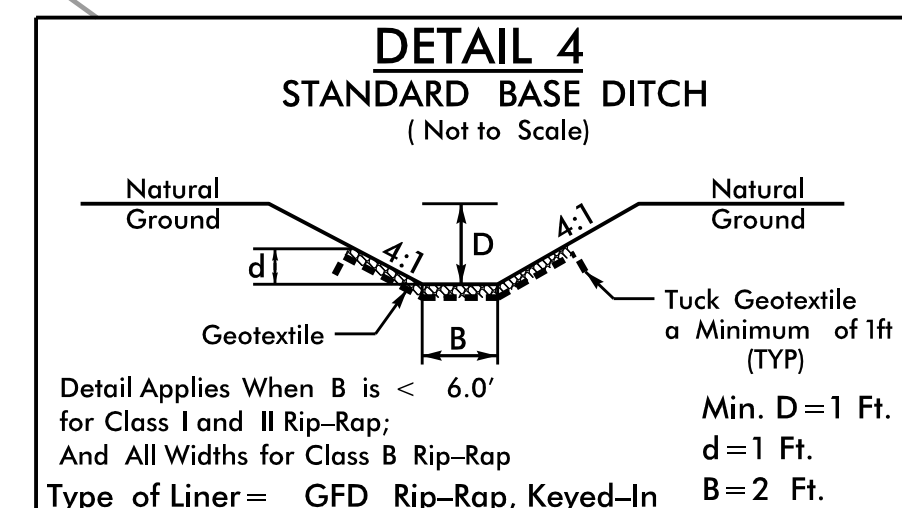

FROM -L- STA. 9+26 (RT) TO -L- STA. 9+92 (R

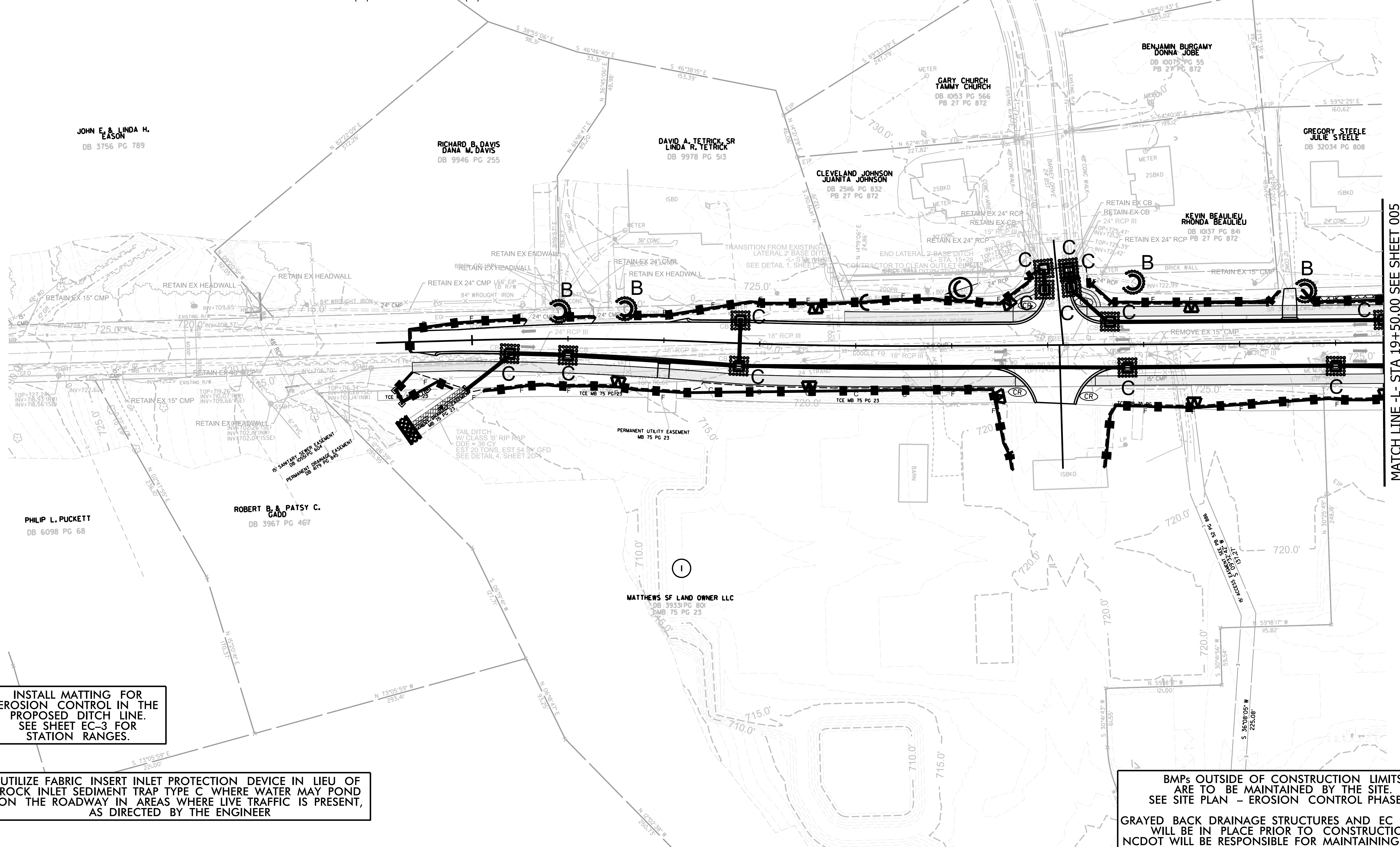

INSTALL MATTING FOR
EROSION CONTROL IN THE
PROPOSED DITCH LINE.
SEE SHEET EC-3 FOR
STATION RANGES.

UTILIZE FABRIC INSERT INLET PROTECTION DEVICE IN LIEU OF
ROCK INLET SEDIMENT TRAP TYPE C WHERE WATER MAY POND
ON THE ROADWAY IN AREAS WHERE LIVE TRAFFIC IS PRESENT,
AS DIRECTED BY THE ENGINEER

BMPs OUTSIDE OF CONSTRUCTION LIMITS
ARE TO BE MAINTAINED BY THE SITE.
SEE SITE PLAN - EROSION CONTROL PHASE 2.

GRAYED BACK DRAINAGE STRUCTURES AND EC DEVICES
WILL BE IN PLACE PRIOR TO CONSTRUCTION.
NCDOT WILL BE RESPONSIBLE FOR MAINTAINING THESE.

Kimley»Horn

200 S. TRYON ST. • CHARLOTTE, NC 28202

[illegible]

RIGHT-OF-WAY REV.

CONST. REV.

<p>FINAL PHASE EROSION CONTROL FOR CONSTRUCTION SHEET 4</p>

MORRIS MURPHY
DB 10093 PG 457

HYDRAULICS
ENGINEER

INCOMPLETE PLANS
DO NOT USE FOR R/W ACQUISITION

PREPARED BY

Kimley»Horn

2023

REVISIONS

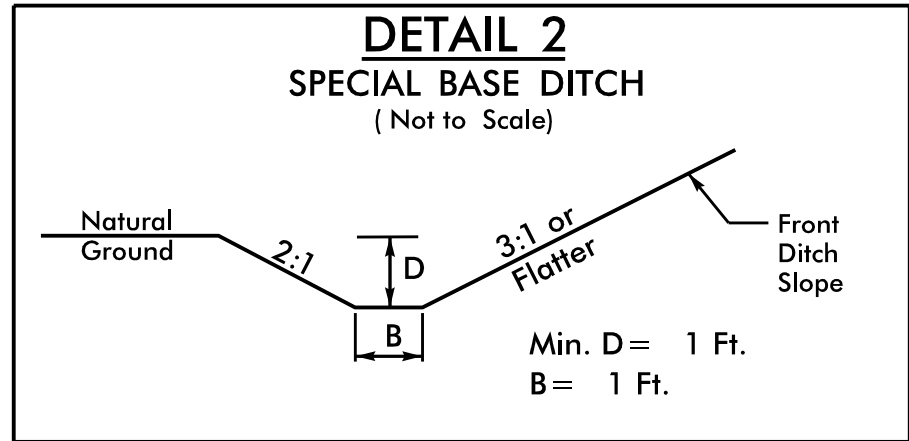

FROM -L- STA. 23+92 (LT) TO STA. -L- STA. 24+60 (LT)
FROM -L- STA. 24+60 (LT) TO STA. -L- STA. 26+85 (LT)

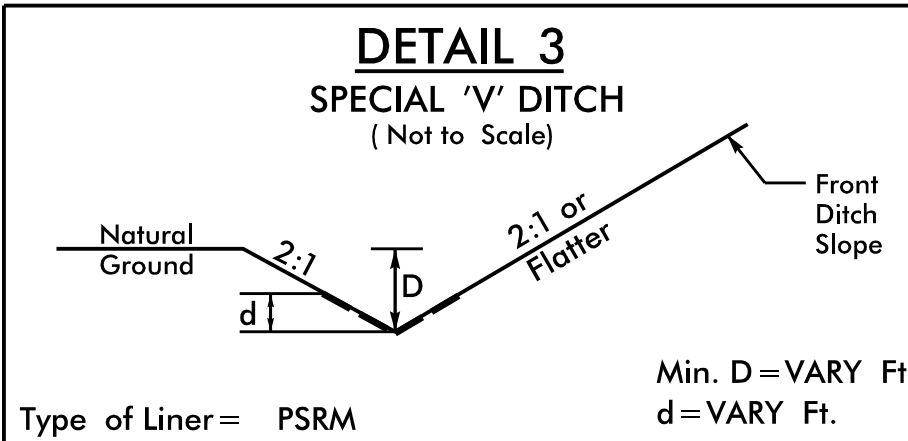

Type of Liner = PSRM
FROM -L- STA. 28+90 (LT) TO -L- STA. 31+93 (LT)

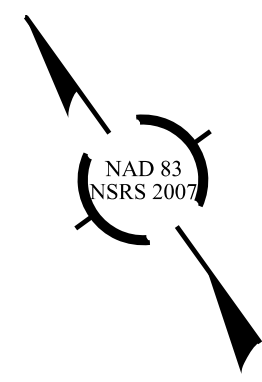
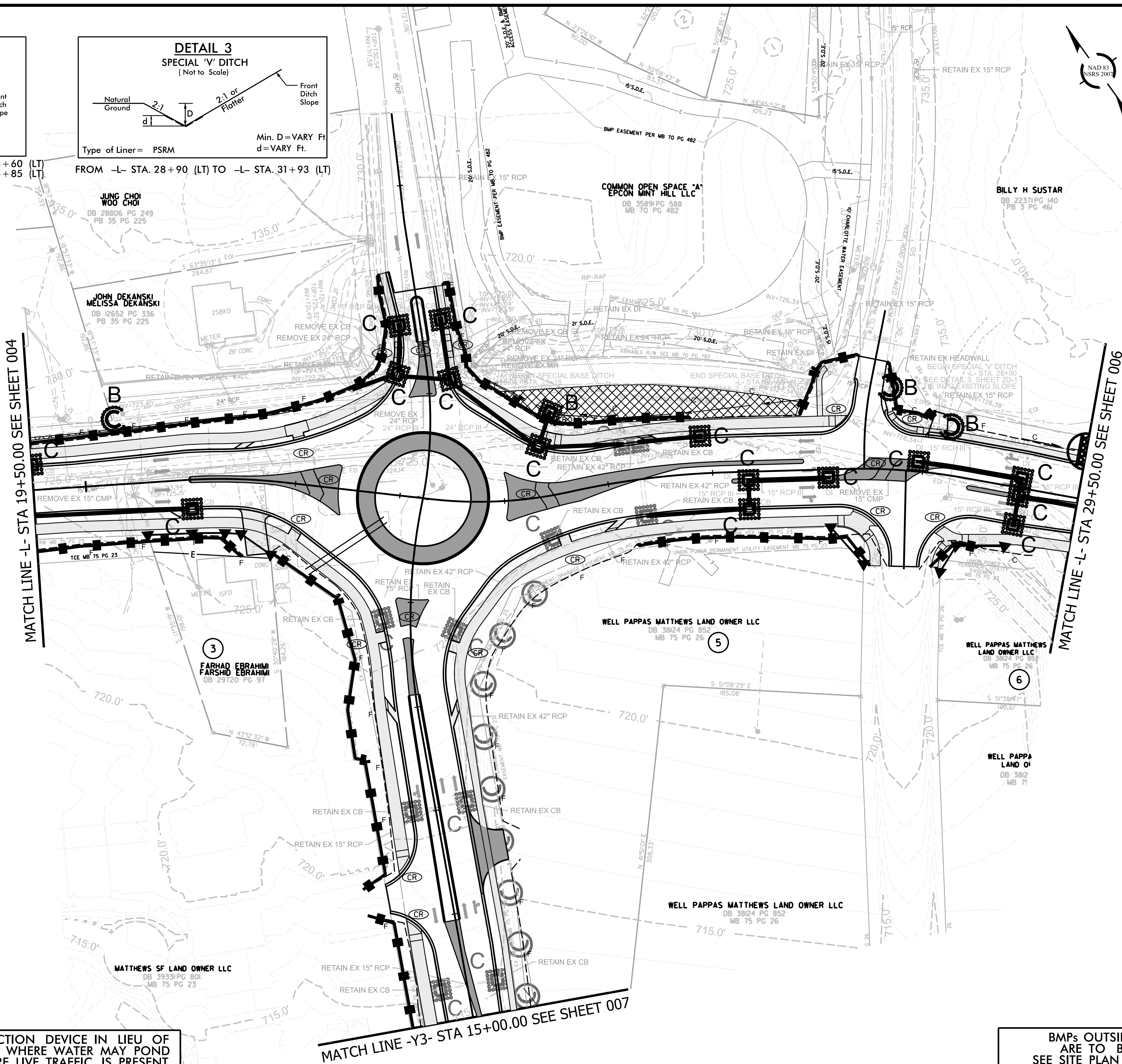

Kimley»Horn
200 S. TRYON ST. • CHARLOTTE, NC 28202
RIGHT-OF-WAY REV.
CONST. REV.

U-4913A
EC-5 CONST.5
NORTH CAROLINA
DEPARTMENT OF TRANSPORTATION
MECKLENBURG COUNTY
ROADWAY DESIGN UNIT
ROADWAY DESIGN
ENGINEER

FINAL PHASE
EROSION CONTROL FOR
CONSTRUCTION SHEET 5

HYDRAULICS ENGINEER
INCOMPLETE PLANS DO NOT USE FOR R/W ACQUISITION
PREPARED BY Kimley»Horn

INSTALL MATTING FOR
EROSION CONTROL IN THE
PROPOSED DITCH LINE.
SEE SHEET EC-3 FOR
STATION RANGES.

UTILIZE FABRIC INSERT INLET PROTECTION DEVICE IN LIEU OF
ROCK INLET SEDIMENT TRAP TYPE C WHERE WATER MAY POND
ON THE ROADWAY IN AREAS WHERE LIVE TRAFFIC IS PRESENT,
AS DIRECTED BY THE ENGINEER

BMPs OUTSIDE OF CONSTRUCTION LIMITS
ARE TO BE MAINTAINED BY THE SITE.
SEE SITE PLAN - EROSION CONTROL PHASE 2.
GRAYED BACK DRAINAGE STRUCTURES AND EC DEVICES
WILL BE IN PLACE PRIOR TO CONSTRUCTION.
NCDOT WILL BE RESPONSIBLE FOR MAINTAINING THESE.

REVISIONS

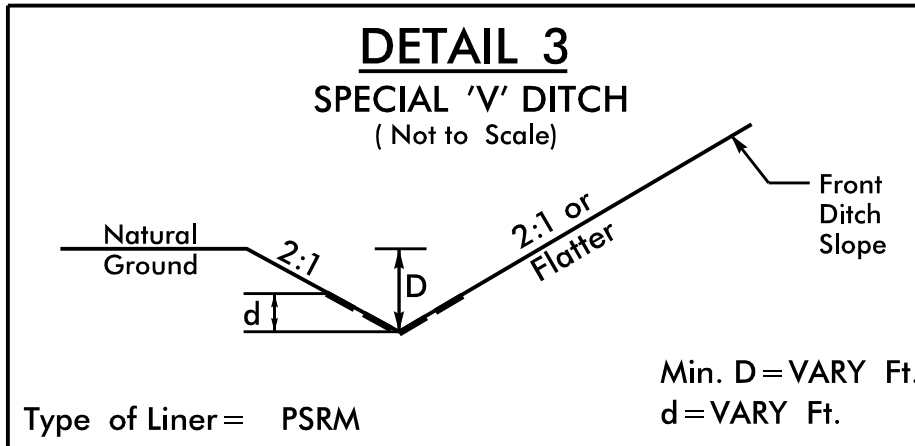

FROM -L- STA. 28+90 (LT) TO -L- STA. 31+93 (LT)

MATCH LINE -L- STA 29+50.00 SEE SHEET 005

INSTALL MATTING FOR
EROSION CONTROL IN THE
PROPOSED DITCH LINE.
SEE SHEET EC-3 FOR
STATION RANGES.

UTILIZE FABRIC INSERT INLET PROTECTION DEVICE IN LIEU OF
ROCK INLET SEDIMENT TRAP TYPE C WHERE WATER MAY POND
ON THE ROADWAY IN AREAS WHERE LIVE TRAFFIC IS PRESENT,
AS DIRECTED BY THE ENGINEER

Kimley»Horn

200 S. TRYON ST. • CHARLOTTE, NC 28202

RIGHT-OF-WAY REV.
CONST. REV.

FINAL PHASE
EROSION CONTROL FOR
CONSTRUCTION SHEET 6

U-4913A
EC-6 CONST.6

NORTH CAROLINA
DEPARTMENT OF TRANSPORTATION
MECKLENBURG COUNTY

ROADWAY DESIGN UNIT
ROADWAY DESIGN
ENGINEER

HYDRAULICS
ENGINEER

INCOMPLETE PLANS
DO NOT USE FOR R/W ACQUISITION

PREPARED BY
Kimley»Horn

REVISIONS

BMPs OUTSIDE OF CONSTRUCTION LIMITS
ARE TO BE MAINTAINED BY THE SITE.
SEE SITE PLAN - EROSION CONTROL PHASE 2.

GRAYED BACK DRAINAGE STRUCTURES AND EC DEVICES
WILL BE IN PLACE PRIOR TO CONSTRUCTION.
NCDOT WILL BE RESPONSIBLE FOR MAINTAINING THESE.

5/26/20

UTILIZE FABRIC INSERT INLET PROTECTION DEVICE IN LIEU OF ROCK INLET SEDIMENT TRAP TYPE C WHERE WATER MAY POND ON THE ROADWAY IN AREAS WHERE LIVE TRAFFIC IS PRESENT, AS DIRECTED BY THE ENGINEER

INSTALL MATTING FOR EROSION CONTROL IN THE PROPOSED DITCH LINE. SEE SHEET EC-3 FOR STATION RANGES.

Kimley»Horn

200 S. TRYON ST. • CHARLOTTE, NC 28202

RIGHT-OF-WAY REV.

CONST. REV.

FINAL PHASE
EROSION CONTROL FOR
CONSTRUCTION SHEET 7

U-4913A
EC-7 CONST.7

NORTH CAROLINA
DEPARTMENT OF TRANSPORTATION
MECKLENBURG COUNTY

ROADWAY DESIGN UNIT
ROADWAY DESIGN
ENGINEER

HYDRAULICS
ENGINEER

INCOMPLETE PLANS
DO NOT USE FOR R/W ACQUISITION

PREPARED BY
Kimley»Horn

REVISIONS

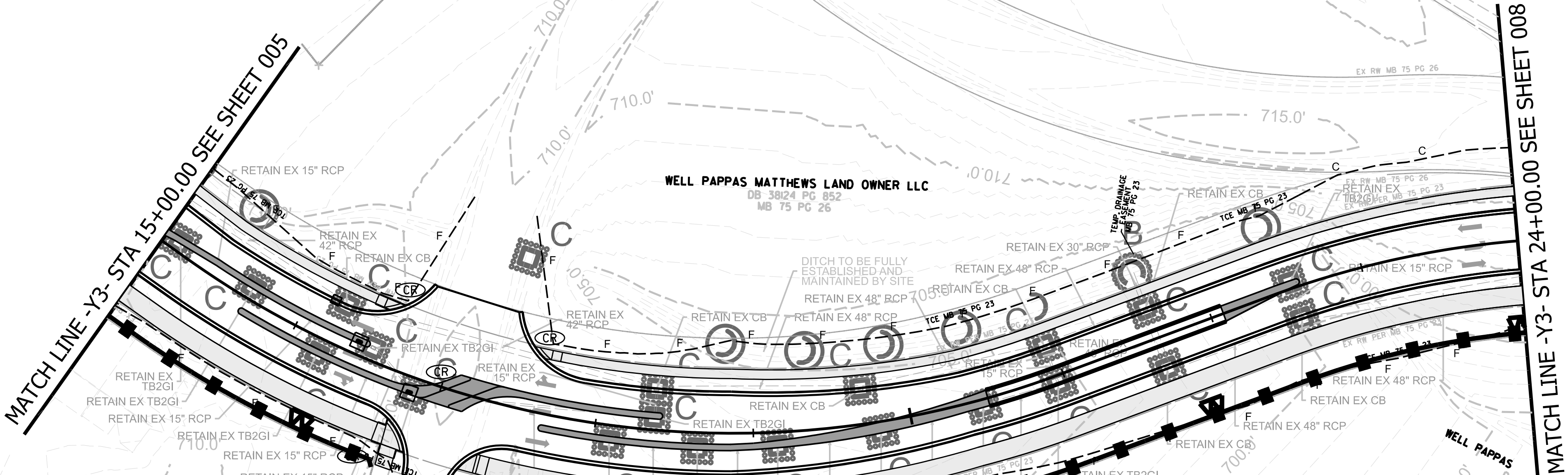

BMPs OUTSIDE OF CONSTRUCTION LIMITS ARE TO BE MAINTAINED BY THE SITE. SEE SITE PLAN - EROSION CONTROL PHASE 2.

GRAYED BACK DRAINAGE STRUCTURES AND EC DEVICES WILL BE IN PLACE PRIOR TO CONSTRUCTION. NCDOT WILL BE RESPONSIBLE FOR MAINTAINING THESE.

5/26/20

UTILIZE FABRIC INSERT INLET PROTECTION DEVICE IN LIEU OF ROCK INLET SEDIMENT TRAP TYPE C WHERE WATER MAY POND ON THE ROADWAY IN AREAS WHERE LIVE TRAFFIC IS PRESENT, AS DIRECTED BY THE ENGINEER

INSTALL MATTING FOR EROSION CONTROL IN THE PROPOSED DITCH LINE. SEE SHEET EC-3 FOR STATION RANGES.

Kimley»Horn

200 S. TRYON ST. • CHARLOTTE, NC 28202

RIGHT-OF-WAY REV.
CONST. REV.

FINAL PHASE
EROSION CONTROL FOR
CONSTRUCTION SHEET 8

U-4913A
EC-8 CONST.8

NORTH CAROLINA
DEPARTMENT OF TRANSPORTATION
MECKLENBURG COUNTY

ROADWAY DESIGN UNIT
ENGINEER

HYDRAULICS
ENGINEER

INCOMPLETE PLANS
DO NOT USE FOR R/W ACQUISITION

PREPARED BY

Kimley»Horn

REVISIONS

BMPs OUTSIDE OF CONSTRUCTION LIMITS ARE TO BE MAINTAINED BY THE SITE. SEE SITE PLAN - EROSION CONTROL PHASE 2.
GRAYED BACK DRAINAGE STRUCTURES AND EC DEVICES WILL BE IN PLACE PRIOR TO CONSTRUCTION. NCDOT WILL BE RESPONSIBLE FOR MAINTAINING THESE.