

TIP PROJECT: U-4913A

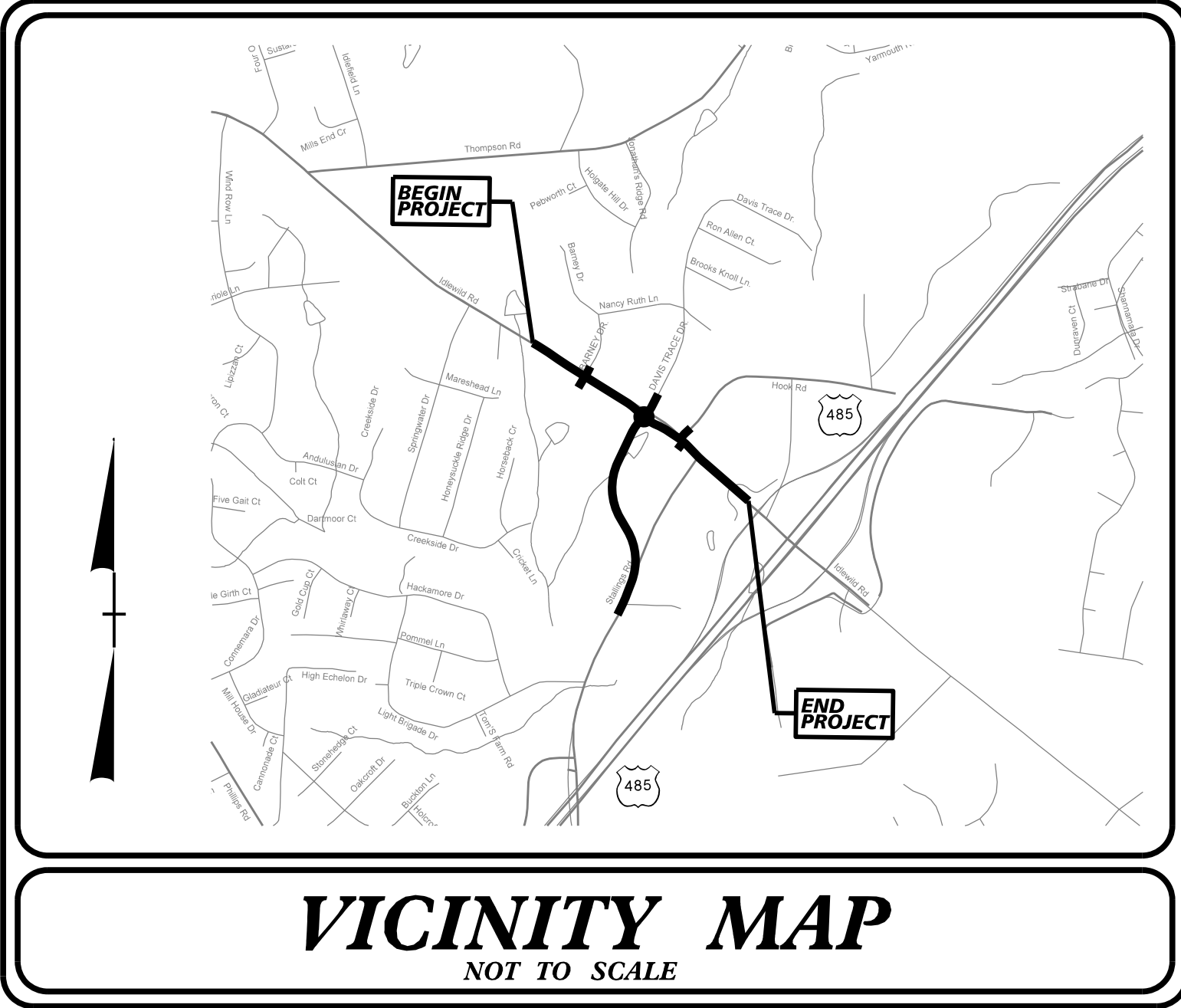

STATE OF NORTH CAROLINA  
DIVISION OF HIGHWAYS  
PLAN FOR PROPOSED  
HIGHWAY EROSION CONTROL  
MECKLENBURG COUNTY

LOCATION: IDLEWILD ROAD FROM BARNEY DRIVE AREA TO  
GOVERNOR JAMES G. MARTIN FREEWAY (I-485)

TYPE OF WORK: GRADING, DRAINAGE, AND PAVING

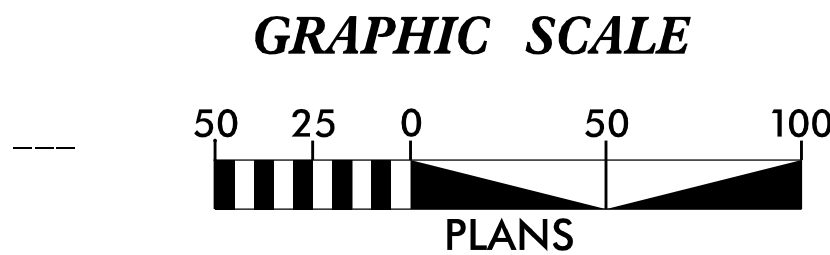
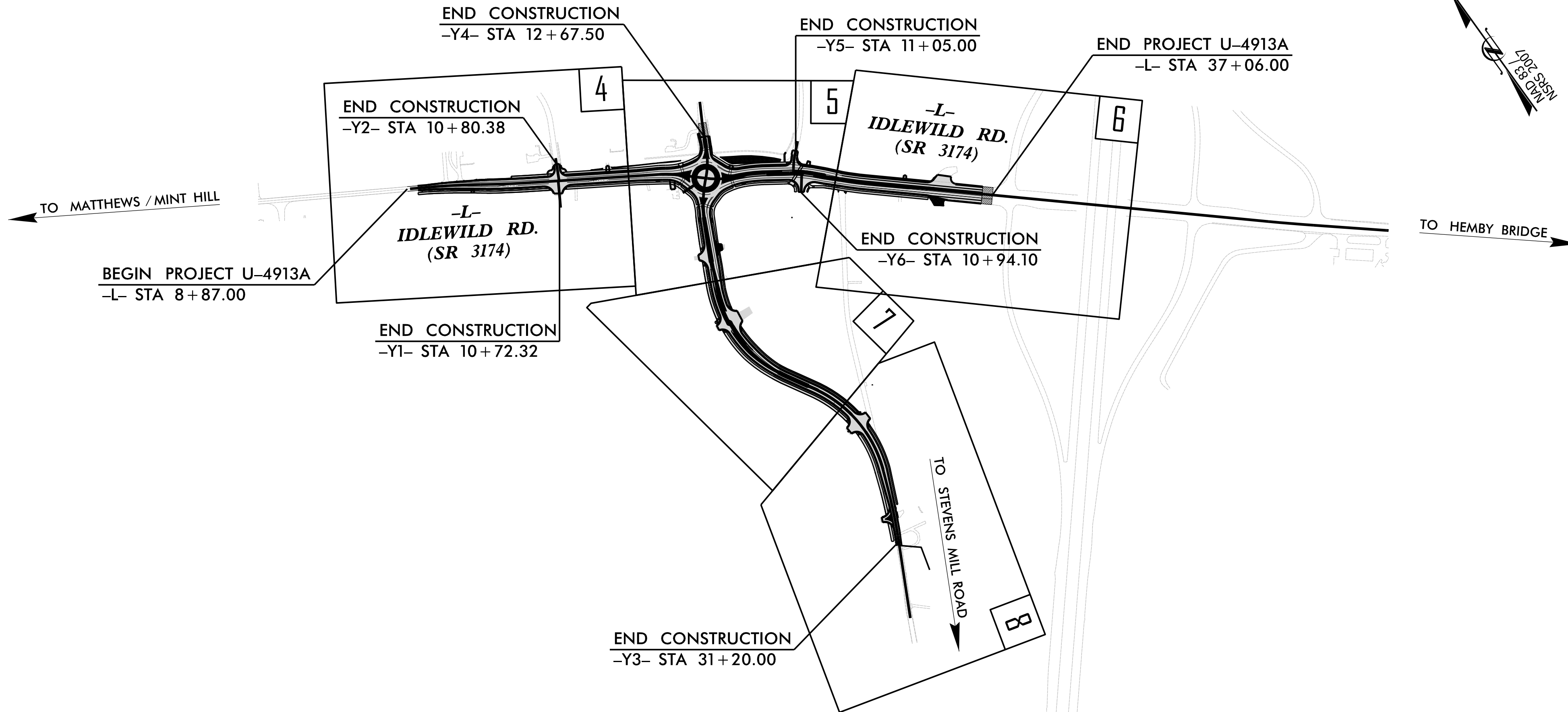

THESE EROSION AND SEDIMENT CONTROL PLANS COMPLY WITH  
THE APPLICABLE REGULATIONS SET FORTH BY THE NCG-010000  
GENERAL CONSTRUCTION PERMIT ISSUED BY THE NORTH  
CAROLINA DIVISION OF ENERGY, MINERAL, AND LAND RESOURCES.

**Kimley»Horn**  
©2025  
200 S. TRYON ST. • CHARLOTTE, NC 28202

Prepared In the Office of:  
**Kimley»Horn**  
©2024  
200 South Tryon Street, Suite 200  
Charlotte, North Carolina 28202

Designed by:  
Adam Recker, EIT 4733  
NAME LEVEL III CERTIFICATION NO.

Roadway Standard Drawings

The "Roadway Standard Drawings"- Roadway Design Unit - N. C.  
Department of Transportation - Raleigh, N. C., dated January 2024  
and the latest revision thereto are applicable to this project and by  
reference hereby are considered a part of these plans.

STATE	STATE PROJECT REFERENCE NO.	SHEET NO.	TOTAL SHEETS
N.C.	U-4913A	EC-1	
STATE PROJ. NO.	F.A. PROJ. NO.	DESCRIPTION	
40543.1.3	N/A	PE	
40543.2.4	N/A	RW	
40543.2.5	N/A	UTILITIES	
40543.3.2	N/A	CONST.	