

PHASING DIAGRAM

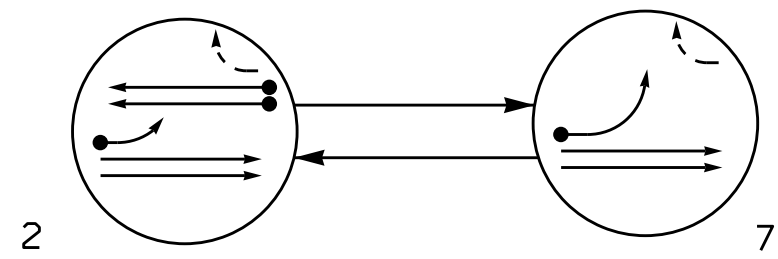

PHASING DIAGRAM DETECTION LEGEND

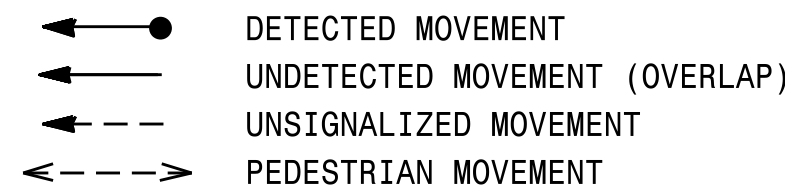

TABLE OF OPERATION

SIGNAL FACE	PHASE		
	2	7	FLASH
11	Y	Y	R
21	Y	R	R
22	G	R	R
61	G	G	R
62	Y	Y	R

OASIS 2070 LOOP & DETECTOR INSTALLATION CHART												
INDUCTIVE LOOPS					DETECTOR PROGRAMMING							
ZONE	SIZE (FT)	DISTANCE FROM STOPBAR (FT)	TURNS	NEW LOOP	PHASE	CALLING	EXTENSION	FULL TIME DELAY	STRETCH TIME	DELAY TIME	LOOP SYSTEM	NEW CARD
1A*	6X40	0	*	-	7	Y	Y	-	-	15	-	*
2A*	6X6	200	*	-	2	Y	Y	-	-	-	-	*
2B*	6X6	200	*	-	2	Y	Y	-	-	-	-	*

* Non-Intrusive detection zone.

2 Phase
Fully Actuated
(Winston-Salem Signal System)

NOTES

- Refer to "Roadway Standard Drawings NCDOT" dated January 2024 and "Standard Specifications for Roads and Structures" dated January 2024.
- Do not program signal for late night flashing operation unless otherwise directed by the Engineer.
- Disconnect and bag existing signal heads 41 and 42.
- Set all detector units to presence mode.
- This intersection uses non-intrusive detection. Install detectors according to the manufacturer's instructions to achieve the desired detection.
- Maximum times shown in timing chart are for free-run operation only. Coordinated signal system timing values supersede these values.

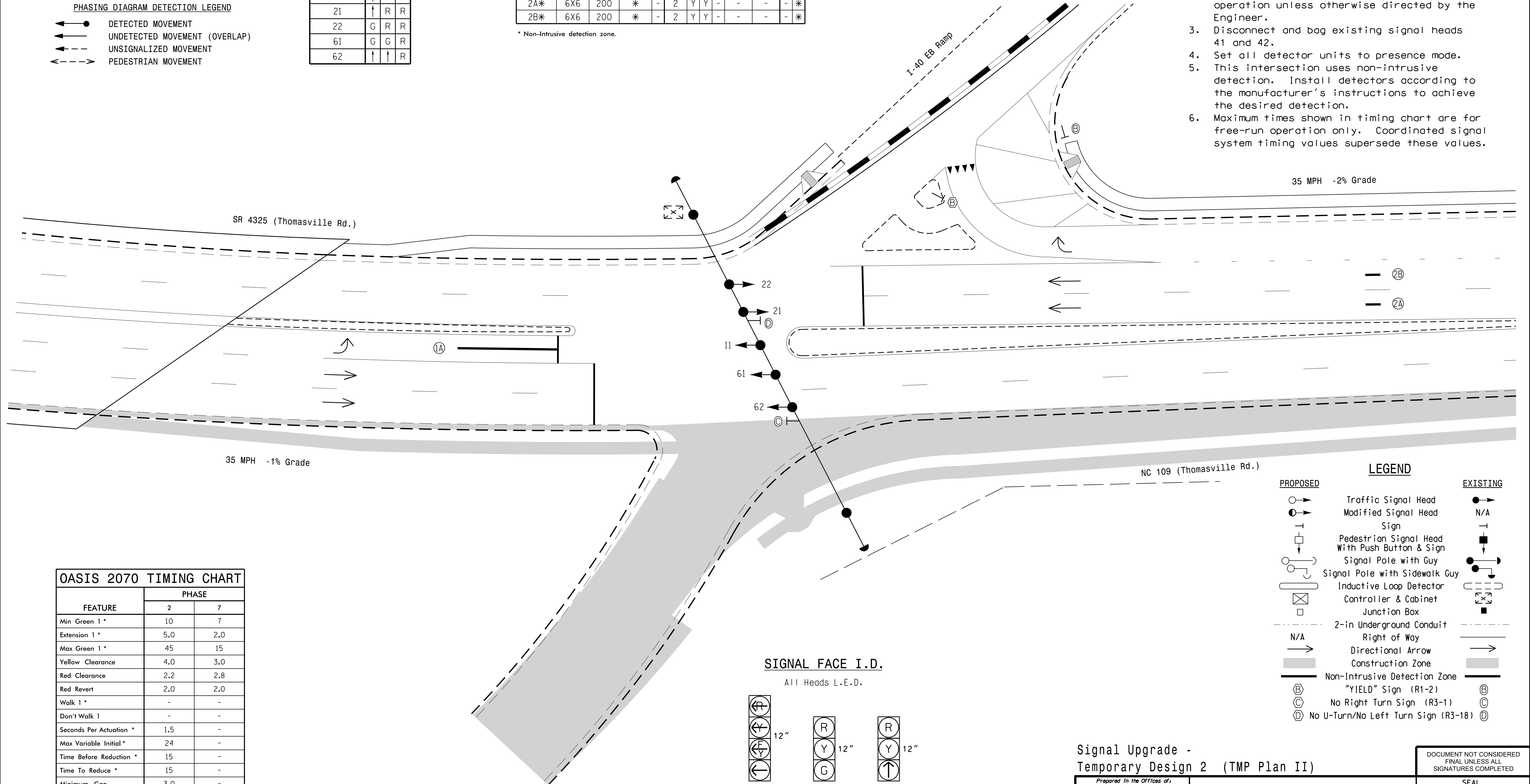

OASIS 2070 TIMING CHART

FEATURE	PHASE	
	2	7
Min Green 1 *	10	7
Extension 1 *	5.0	2.0
Max Green 1 *	45	15
Yellow Clearance	4.0	3.0
Red Clearance	2.2	2.8
Red Revert	2.0	2.0
Walk 1 *	-	-
Don't Walk 1	-	-
Seconds Per Actuation *	1.5	-
Max Variable Initial *	24	-
Time Before Reduction *	15	-
Time To Reduce *	15	-
Minimum Gap	3.0	-
Recall Mode	MIN RECALL	-
Vehicle Call Memory	YELLOW	-
Dual Entry	-	-
Simultaneous Gap	ON	ON

* These values may be field adjusted. Do not adjust Min Green and Extension times for phases 2 and 6 lower than what is shown. Min Green for all other phases should not be lower than 4 seconds.

SIGNAL FACE I.D.

All Heads L.E.D.

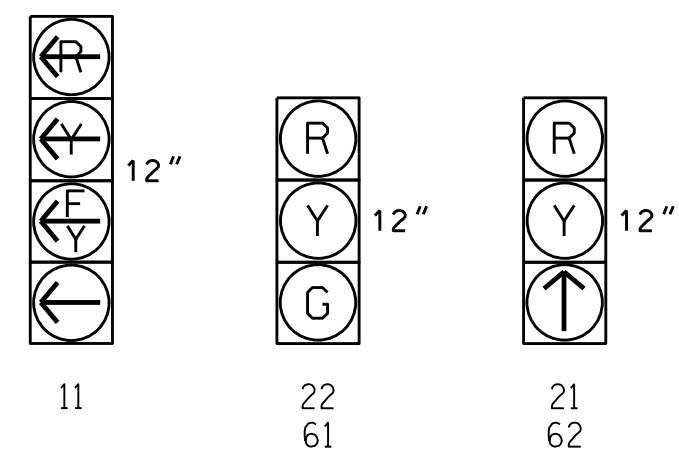

LEGEND

PROPOSED	EXISTING

Signal Upgrade -
Temporary Design 2 (TMP Plan II)

Prepared in the Offices of:

750 N. Greenfield Pkwy, Garner, NC 27529

NC 109/SR 4325 (Thomasville Road)
at
I-40 EB Ramp

Division 9 Forsyth County Winston-Salem

PLAN DATE: September 2024 REVIEWED BY:

PREPARED BY: J.A. Lohr REVIEWED BY:

REVISIONS	INIT.	DATE

0 SCALE 20
1"=20'

DOCUMENT NOT CONSIDERED FINAL UNLESS ALL SIGNATURES COMPLETED

SEAL
NORTH CAROLINA PROFESSIONAL ENGINEER
ROBERT J. ZIMMERMAN
026486

01/02/2025
DATE

SIG. INVENTORY NO. 09-0600T2