

09/08/99

TIP PROJECT: HE-0002

CONTRACT: C204898

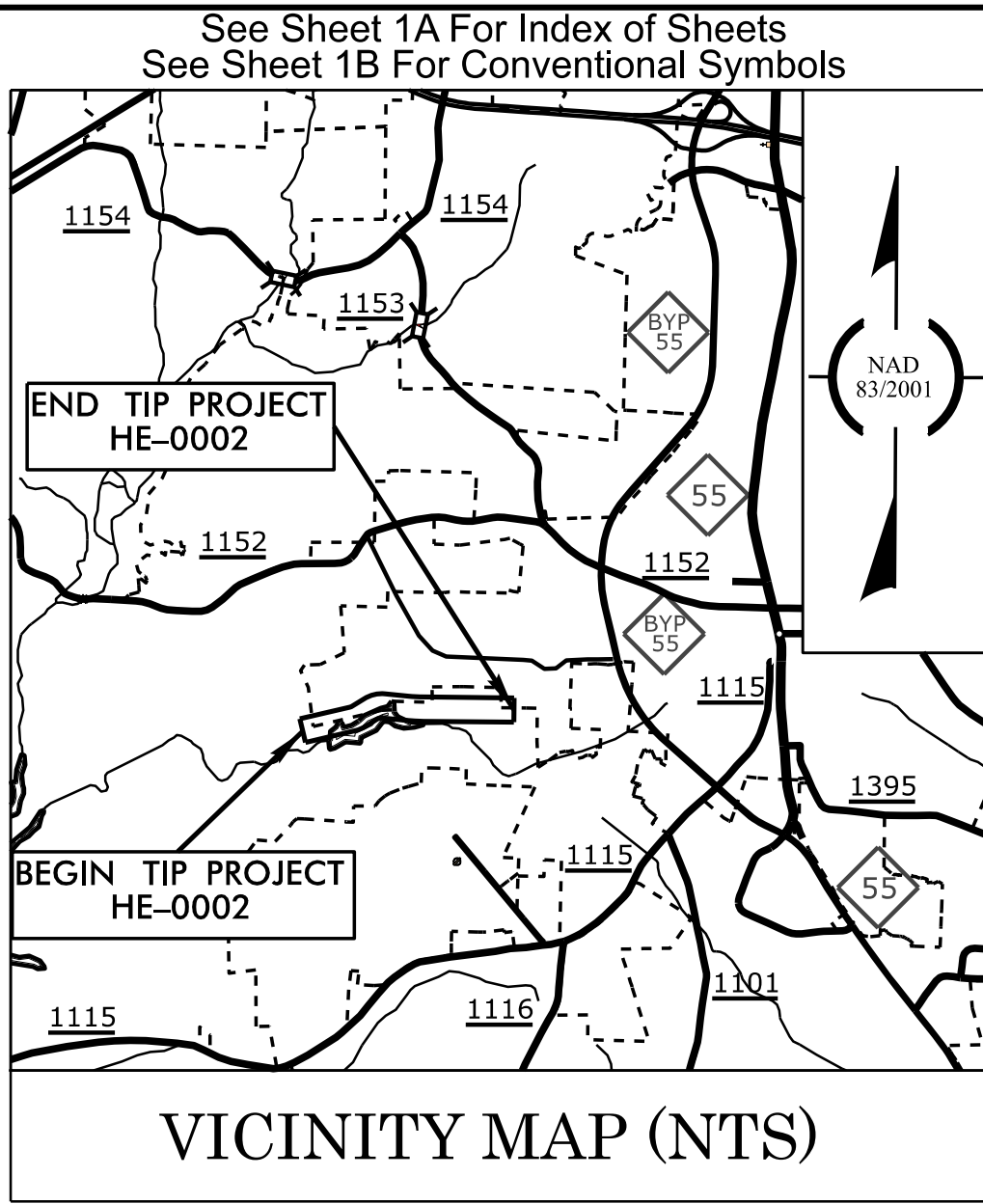

STATE OF NORTH CAROLINA  
DIVISION OF HIGHWAYS

WAKE COUNTY

LOCATION: *HOLLY SPRINGS BUSINESS PARK SOUTHERN ACCESS ROAD  
FROM FUJI DIOSYNTH BIOTECHNOLOGIES PROPERTY  
& SEWER PUMP STATION TO 110 FEET WEST OF THE  
BUMGARDNER ROAD EXTENSION INTERSECTION*

TYPE OF WORK: *GRADING, DRAINAGE, PAVING, AND CULVERT*

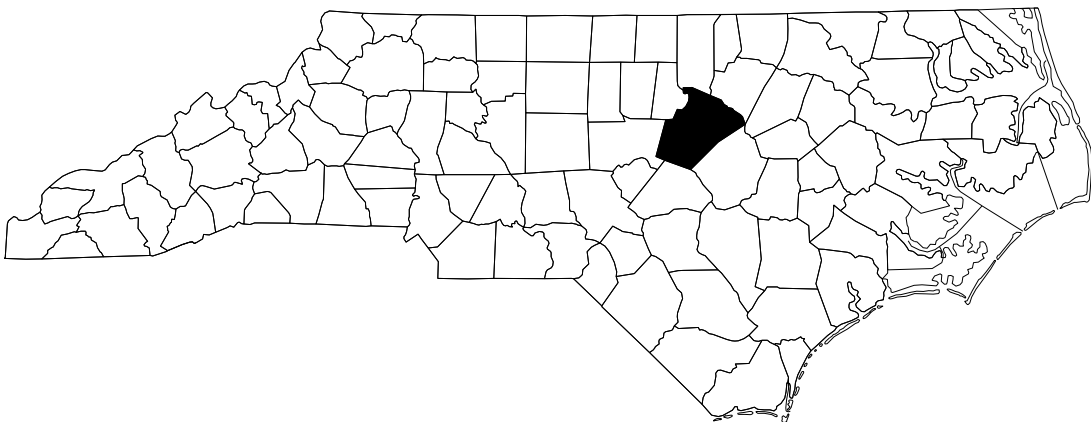

STATE	STATE PROJECT REFERENCE NO.	SHEET NO.	TOTAL SHEETS
N.C.	HE-0002	11	
STATE PROJ. NO.	F. A. PROJ. NO.	DESCRIPTION	
49745.1.1	N/A	PE	
49745.2.1	N/A	R/W	
49745.2.2	N/A	UTIL.	
49745.3.1	N/A	CONST.	

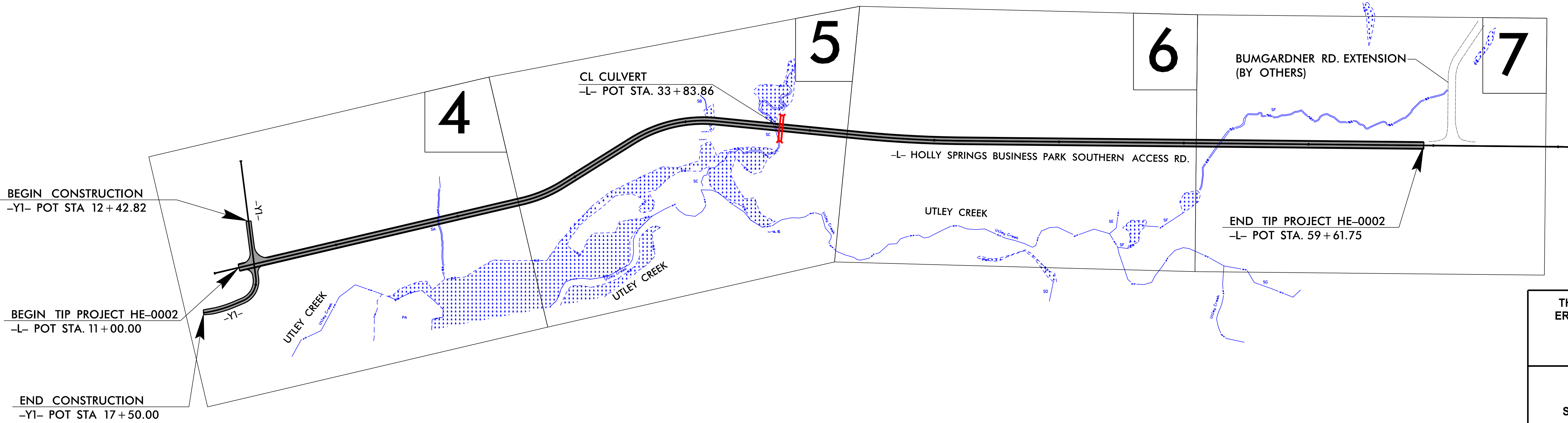
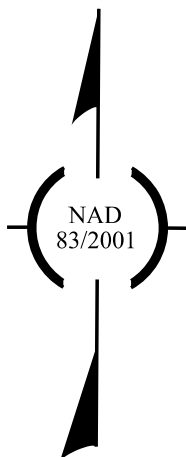

THIS PROJECT CONTAINS  
EROSION CONTROL PLANS  
FOR CLEARING AND  
GRUBBING PHASE OF  
CONSTRUCTION.

THIS PROJECT HAS  
BEEN DESIGNED TO  
SENSITIVE WATERSHED  
STANDARDS.

GRAPHIC SCALE



THESE EROSION AND SEDIMENT CONTROL PLANS COMPLY  
WITH THE REGULATIONS SET FORTH BY THE  
NCG-010000 GENERAL STORMWATER CONSTRUCTION PERMIT  
ISSUED BY THE NORTH CAROLINA DEPARTMENT OF  
ENVIRONMENTAL QUALITY DIVISION OF ENERGY,  
MINERAL, AND LAND RESOURCES.

CDM  
Smith

Prepared in the Office of:

CDM SMITH

5400 Glenwood Avenue  
Suite 400

Raleigh, NC 27612-3228  
NC COA No. F-1255

Designed by:

HEATHER HARKENRIDER, P.E. 3281

NAME

LEVEL III CERTIFICATION NO.

Roadway Standard Drawings

The "Roadway Standard Drawings"- Roadway Design Unit - N. C.  
Department of Transportation - Raleigh, N. C., dated January 2024  
and the latest revision thereto are applicable to this project and by  
reference hereby are considered a part of these plans.