

REFERENCE: R-5963A

PROJECT: 48599

CONTENTS

SHEET NO.	DESCRIPTION
1	TITLE SHEET
2	LEGEND (SOIL & ROCK)
3	SITE PLAN
4	PROFILE(S)
5	SOIL TEST RESULTS

STATE OF NORTH CAROLINA
DEPARTMENT OF TRANSPORTATION
DIVISION OF HIGHWAYS
GEOTECHNICAL ENGINEERING UNIT

STRUCTURE
SUBSURFACE INVESTIGATION

COUNTY CHATHAM
PROJECT DESCRIPTION CHATHAM PARK WAY FROM
US 15-501 TO US 64 BUSINESS

SITE DESCRIPTION RETAINING WALL NO. 3:
FROM -W3- STA. 80+38.61 TO -W3- STA. 81+87.29

STATE	STATE PROJECT REFERENCE NO.	SHEET NO.	TOTAL SHEETS
N.C.	R-5963A	1	

CAUTION NOTICE

THE SUBSURFACE INFORMATION AND THE SUBSURFACE INVESTIGATION ON WHICH IT IS BASED WERE MADE FOR THE PURPOSE OF STUDY, PLANNING AND DESIGN, AND NOT FOR CONSTRUCTION OR PAY PURPOSES. THE VARIOUS FIELD BORING LOGS, ROCK CORES AND SOIL TEST DATA AVAILABLE MAY BE REVIEWED OR INSPECTED IN RALEIGH BY CONTACTING THE N.C. DEPARTMENT OF TRANSPORTATION, GEOTECHNICAL ENGINEERING UNIT, AT (919) 707-6850. THE SUBSURFACE PLANS AND REPORTS, FIELD BORING LOGS, ROCK CORES AND SOIL TEST DATA ARE NOT PART OF THE CONTRACT.

GENERAL SOIL AND ROCK STRATA DESCRIPTIONS AND INDICATED BOUNDARIES ARE BASED ON A GEOTECHNICAL INTERPRETATION OF ALL AVAILABLE SUBSURFACE DATA AND MAY NOT NECESSARILY REFLECT THE ACTUAL SUBSURFACE CONDITIONS BETWEEN BORINGS OR BETWEEN SAMPLED STRATA WITHIN THE BOREHOLE. THE LABORATORY SAMPLE DATA AND THE IN SITU (IN-PLACE) TEST DATA CAN BE RELIED ON ONLY TO THE DEGREE OF RELIABILITY INHERENT IN THE STANDARD TEST METHOD. THE OBSERVED WATER LEVELS OR SOIL MOISTURE CONDITIONS INDICATED IN THE SUBSURFACE INVESTIGATIONS ARE AS RECORDED AT THE TIME OF THE INVESTIGATION. THESE WATER LEVELS OR SOIL MOISTURE CONDITIONS MAY VARY CONSIDERABLY WITH TIME ACCORDING TO CLIMATIC CONDITIONS INCLUDING TEMPERATURES, PRECIPITATION AND WIND, AS WELL AS OTHER NON-CLIMATIC FACTORS.

THE BIDDER OR CONTRACTOR IS CAUTIONED THAT DETAILS SHOWN ON THE SUBSURFACE PLANS ARE PRELIMINARY ONLY AND IN MANY CASES THE FINAL DESIGN DETAILS ARE DIFFERENT. FOR BIDDING AND CONSTRUCTION PURPOSES, REFER TO THE CONSTRUCTION PLANS AND DOCUMENTS FOR FINAL DESIGN INFORMATION ON THIS PROJECT. THE DEPARTMENT DOES NOT WARRANT OR GUARANTEE THE SUFFICIENCY OR ACCURACY OF THE INVESTIGATION MADE, NOR THE INTERPRETATIONS MADE, OR OPINION OF THE DEPARTMENT AS TO THE TYPE OF MATERIALS AND CONDITIONS TO BE ENCOUNTERED. THE BIDDER OR CONTRACTOR IS CAUTIONED TO PERFORM INDEPENDENT SUBSURFACE INVESTIGATIONS AND MAKE INTERPRETATIONS AS NECESSARY TO CONFIRM CONDITIONS ENCOUNTERED ON THE PROJECT. THE CONTRACTOR SHALL HAVE NO CLAIM FOR ADDITIONAL COMPENSATION OR FOR AN EXTENSION OF TIME FOR ANY REASON RESULTING FROM THE ACTUAL CONDITIONS ENCOUNTERED AT THE SITE DIFFERING FROM THOSE INDICATED IN THE SUBSURFACE INFORMATION.

- NOTES:
- THE INFORMATION CONTAINED HEREIN IS NOT IMPLIED OR GUARANTEED BY THE N.C. DEPARTMENT OF TRANSPORTATION AS ACCURATE NOR IS IT CONSIDERED PART OF THE PLANS, SPECIFICATIONS OR CONTRACT FOR THE PROJECT.
 - BY HAVING REQUESTED THIS INFORMATION, THE CONTRACTOR SPECIFICALLY WAIVES ANY CLAIMS FOR INCREASED COMPENSATION OR EXTENSION OF TIME BASED ON DIFFERENCES BETWEEN THE CONDITIONS INDICATED HEREIN AND THE ACTUAL CONDITIONS AT THE PROJECT SITE.

PERSONNEL

P. PERRY, E.I.T.

CG2 EXPLORATION

INVESTIGATED BY CG2, PLLC

DRAWN BY K. DE MONTBRUN, P.E.

CHECKED BY M. WALKO, P.E.

SUBMITTED BY CG2, PLLC

DATE NOVEMBER 2024

Prepared in the Office of:



CAROLINAS
GEOTECHNICAL
GROUP

2400 CROWNPOINT EXECUTIVE DRIVE
SUITE 800
CHARLOTTE, NC 28227
(980) 339-8684

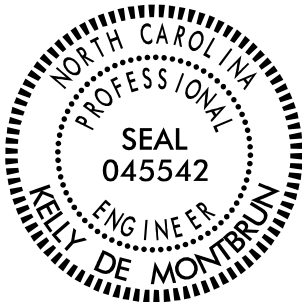

Signed by: Kelly De Montbrun 12/04/2024

BAB66070E9D747C SIGNATURE DATE

DOCUMENT NOT CONSIDERED FINAL
UNLESS ALL SIGNATURES COMPLETED

SOIL AND ROCK LEGEND, TERMS, SYMBOLS, AND ABBREVIATIONS

DATE: 8-15-14

PROJECT REFERENCE NO.	SHEET NO.
R-5963A	3
SITE PLAN	
0 50 100 FEET	
RETAINING WALL NO. 3: FROM -W3- STA. 80+38.61 TO -W3- STA. 81+87.29	

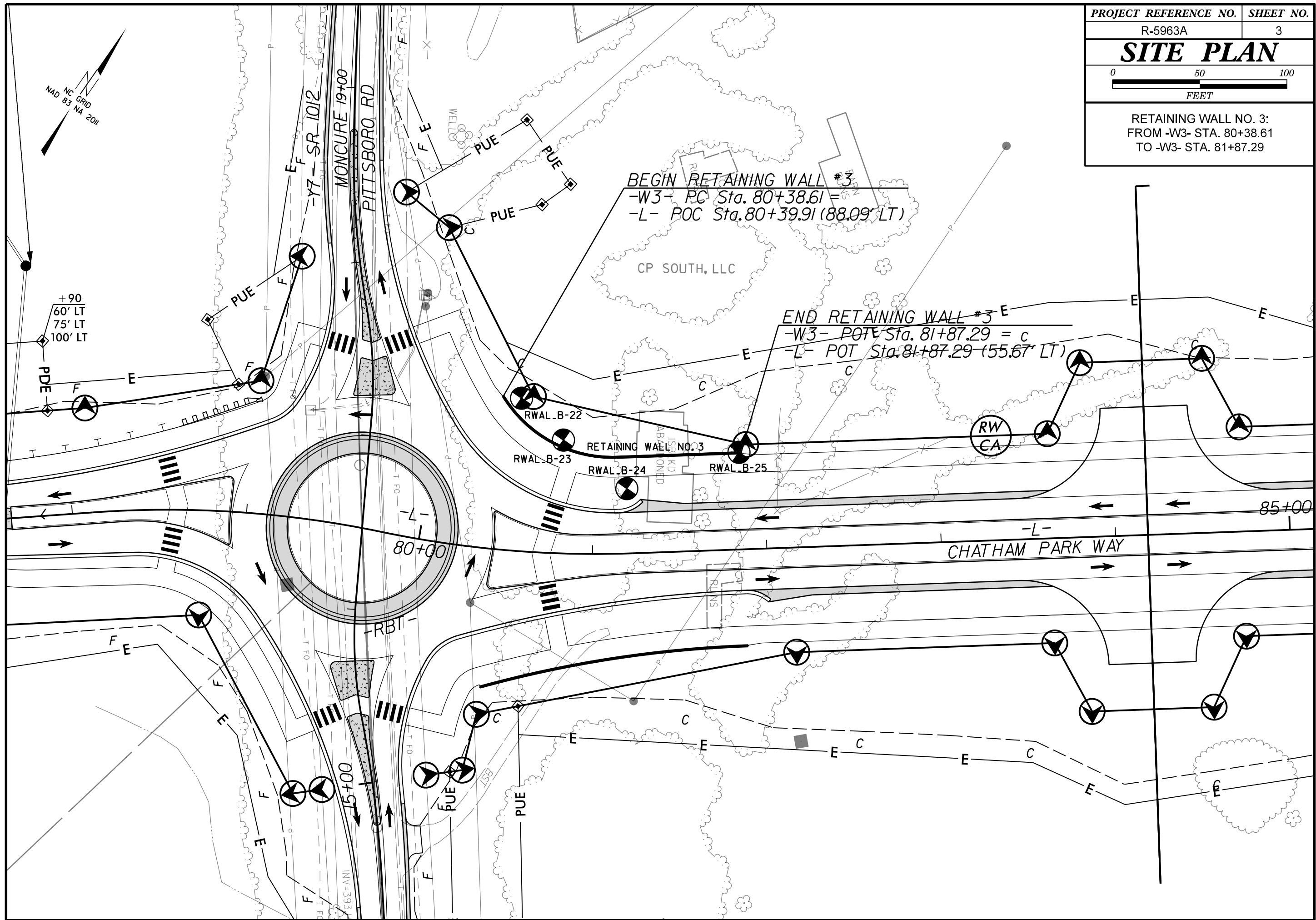

SOIL TEST RESULTS																		
BORING ID	SAMPLE NO.	OFFSET	STATION	NORTHING	EASTING	DEPTH INTERVAL	AASHTO CLASS.	L.L.	P.I.	% BY WEIGHT				% PASSING (SIEVES)			% MOISTURE	% ORGANIC
										C. SAND	F. SAND	SILT	CLAY	10	40	200		
RWAL B-23	SS-522	4' LT	80+83 -W3-	707586	1953542	1.0 - 2.5'	A-7-6(14)	47	20	10.1	4.5	32.3	53.1	81.0	74.4	69.9	18.9	ND
RWAL B-23	SS-523	4' LT	80+83 -W3-	707586	1953542	3.9 - 5.4'	A-7-5(21)	55	14	0.3	0.6	66.3	32.8	100.0	99.9	99.2	45.4	ND
RWAL B-23	SS-525	4' LT	80+83 -W3-	707586	1953542	8.9 - 10.4'	A-4(8)	38	6	1.9	7.0	62.3	28.8	100.0	98.9	94.0	34.5	ND
RWAL B-25	SS-494	CL	81+86 -W3-	707638	1953629	3.9 - 5.4'	A-7-5(30)	60	23	0.2	0.9	49.8	49.1	100.0	100.0	99.0	39.0	ND
RWAL B-25	SS-496	CL	81+86 -W3-	707638	1953629	8.9 - 10.4'	A-7-5(17)	53	13	2.7	8.0	52.2	37.1	100.0	98.3	92.2	40.7	ND
RWAL B-25	SS-498	CL	81+86 -W3-	707638	1953629	18.9 - 20.4'	A-4(8)	38	9	1.9	21.7	52.1	24.3	100.0	99.2	82.2	26.1	ND

Alex M. Armulsky

AUTHORIZED SIGNATURE
NCDOT CERT NO. 130-04-0212

Prepared in the Office of:
F&ME CONSULTANTS, INC.
COLUMBIA, SOUTH CAROLINA
NCDOT LAB CERT. NO. 130-0212