

STATE	STATE PROJECT REFERENCE NO.	SHEET NO.	TOTAL SHEETS
N.C.	17BP.9.R.83	RW01	07

STATE OF NORTH CAROLINA
DIVISION OF HIGHWAYS

SURVEY CONTROL, EXISTING CENTERLINES,
RIGHT OF WAY, EASEMENTS AND PROPERTY TIES

STOKES COUNTY

TIP PROJECT: 17BP.9.R.83

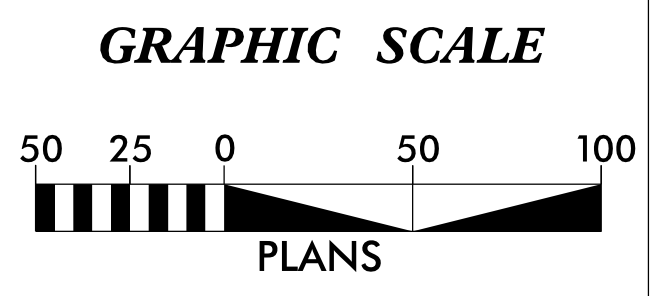
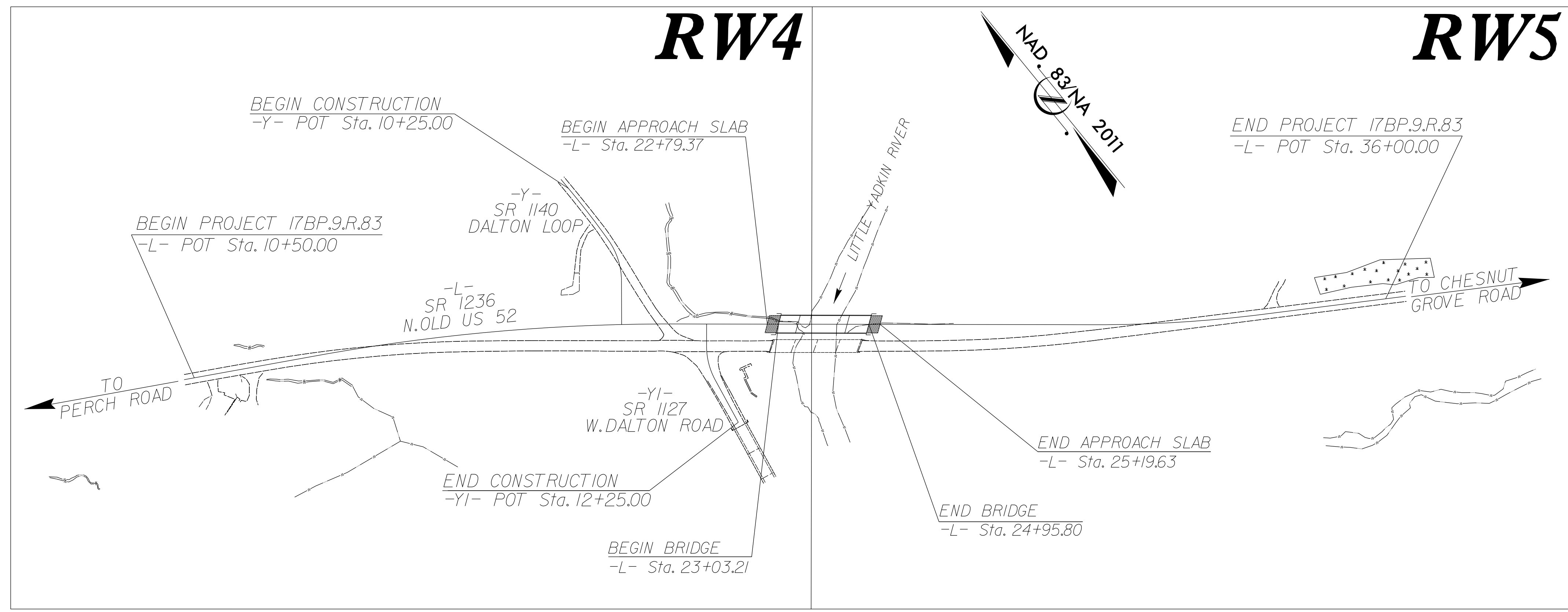

DATUM DESCRIPTION
 THE LOCALIZED COORDINATE SYSTEM DEVELOPED FOR THIS PROJECT IS BASED ON THE STATE PLANE COORDINATES ESTABLISHED BY NCDOT FOR MONUMENT "840286-2" WITH NAD 83/NA 2011 STATE PLANE GRID COORDINATES OF NORTHING: 935,681.548(ft) EASTING: 1,587,402.718(ft) ELEVATION: 855.89(ft)
 THE AVERAGE COMBINED GRID FACTOR USED ON THIS PROJECT (GROUND TO GRID) IS: 1.000008391
 THE N.C. LAMBERT GRID BEARING AND LOCALIZED HORIZONTAL GROUND DISTANCE FROM "840286-2" TO -L- STATION 10+00.00 IS N 53°10'24.85" W 1476.23(ft)
 ALL LINEAR DIMENSIONS ARE LOCALIZED HORIZONTAL DISTANCES
 VERTICAL DATUM USED IS NAVD 88

Prepared in the Office of:

2024 STANDARD SPECIFICATIONS

RIGHT OF WAY DATE: _____ **LETTING DATE:** _____

PROFESSIONAL LAND SURVEYOR

DocuSigned by:
M.L. Motzinger
SIGNATURE

01/26/2023
Date:

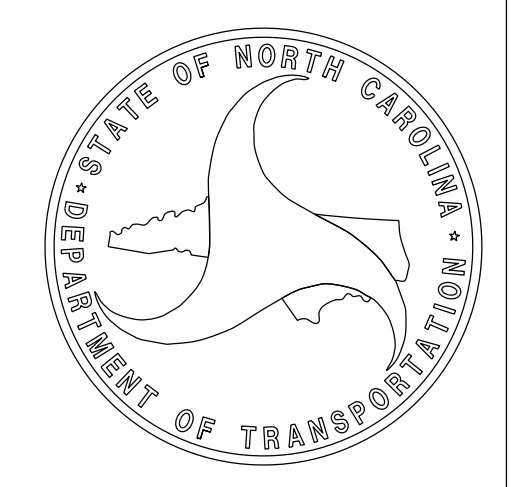

26-JAN-2023 08:25 F:\Bridge\Division\Lowmpac\84-0286\Right of Way Staking\survey control\sheet\to be checked\84-0286_ls_rw01.dgn mmotzinger AT LS-3286.rtl