

STATE OF NORTH CAROLINA
DIVISION OF HIGHWAYS

TRANSPORTATION MANAGEMENT PLAN

ASHE COUNTY

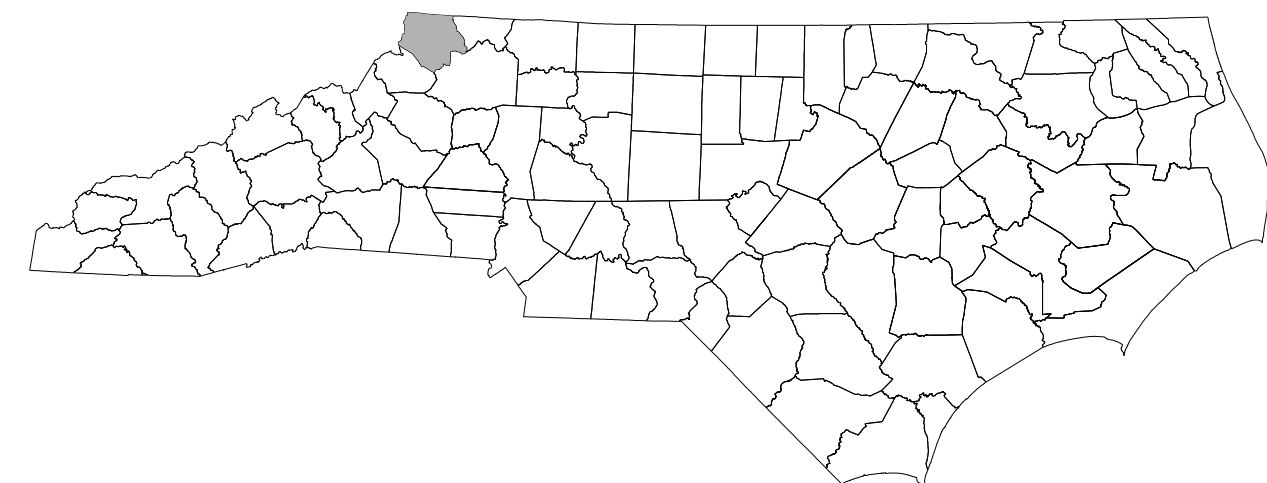

LOCATION: BRIDGE #040019 ON NC 194 OVER BIG HORSE CREEK
BRIDGE #040032 ON NC 194 OVER HELTON CREEK
BRIDGE #040478 ON W. DEEP FORD RD (SR 1514) OVER N. FORK NEW RIVER
BRIDGE #040507 ON MCNEIL RD (SR 1644) OVER N. FORK NEW RIVER

TYPE OF WORK: BRIDGE PRESERVATION

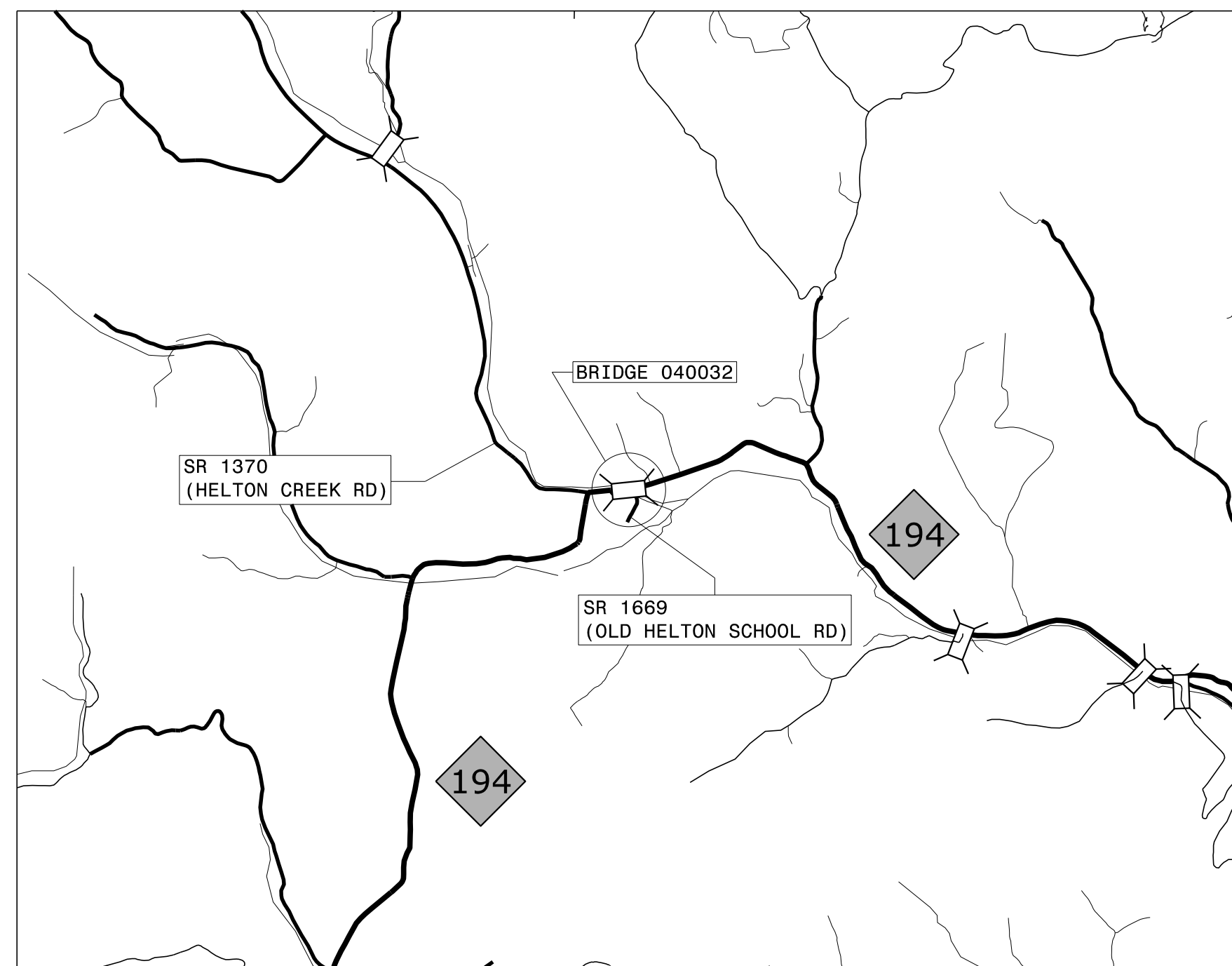

SKETCH MAP SHOWING THE VICINITY OF BRIDGE 040032

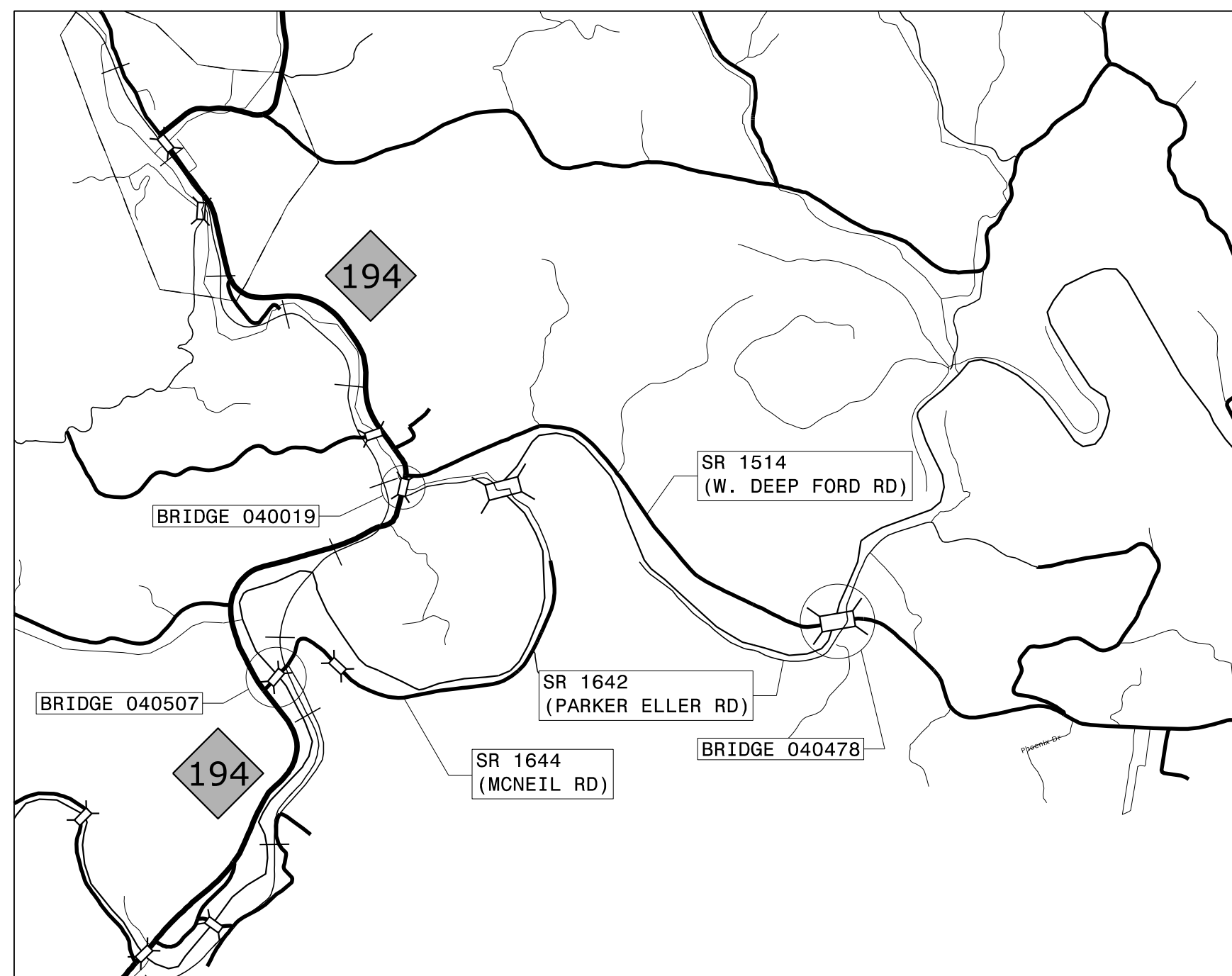

SKETCH MAP SHOWING THE VICINITY OF BRIDGES 040019, 040478 AND 040507

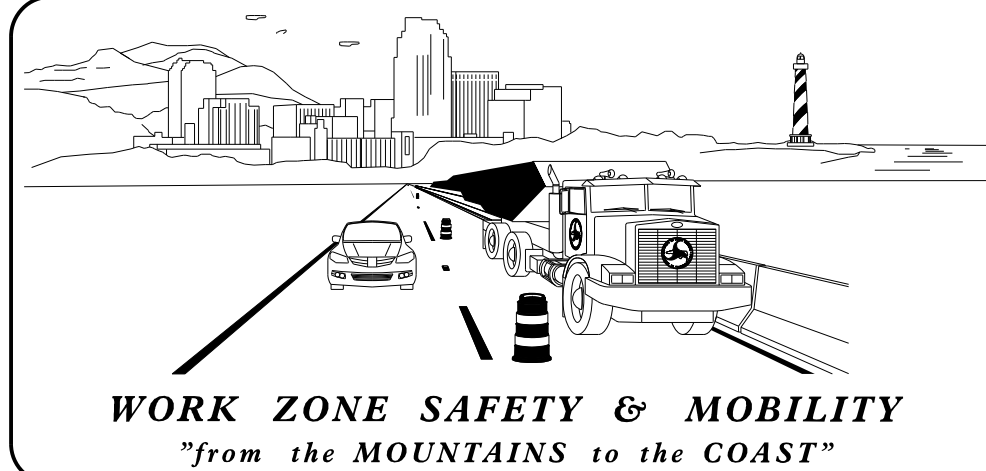

PLANS PREPARED BY:

RICK NELSON, PE
PROJECT ENGINEER
BENJAMIN A. WHITE, PE
PROJECT DESIGN ENGINEER

NCDOT CONTACT:

TIM SHERRILL, PE
PROJECT MANAGER

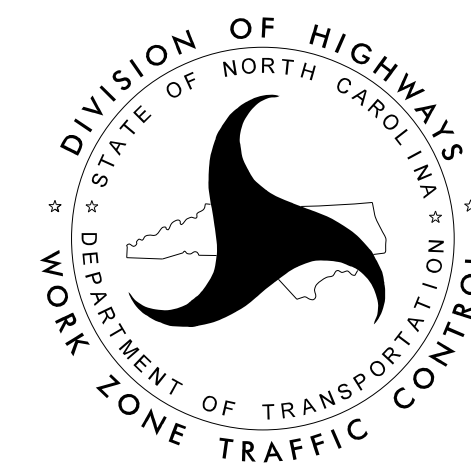

INDEX OF SHEETS

| SHEET NO. | TITLE |
|-----------|--|
| TMP-1 | TITLE SHEET, VICINITY MAP, INDEX OF SHEETS AND MANAGEMENT STRATEGIES |
| TMP-1A | LIST OF APPLICABLE ROADWAY STANDARD DRAWINGS AND LEGEND |
| TMP-1B | GENERAL NOTES |
| TMP-3 | PHASING |
| TMP-4 | BRIDGE 040019 PHASE I DETAIL |
| TMP-5 | BRIDGE 040019 PHASE II DETAIL |
| TMP-6 | BRIDGE 040032 PHASE I DETAIL |
| TMP-7 | BRIDGE 040032 PHASE II DETAIL |
| TMP-8 | BRIDGE 040478 PHASE I DETAIL |
| TMP-9 | BRIDGE 040478 PHASE II DETAIL |
| TMP-10 | BRIDGE 040507 PHASE I DETAIL |
| TMP-11 | BRIDGE 040507 PHASE II DETAIL |

MANAGEMENT STRATEGIES

TRAFFIC MANAGEMENT STRATEGIES:

- LANE SHIFTS OR CLOSURES
- SHOULDER CLOSURES
- ONE-LANE, TWO WAY OPERATION (FLAGGING)
- ONE-LANE, TWO WAY OPERATION (SIGNALIZED)
- NIGHT WORK

WORK ZONE SAFETY & MOBILITY STRATEGIES:

- TEMPORARY TRAFFIC SIGNALS
- WORK ZONE PERFORMANCE PAVEMENT MARKINGS

CONTRACTING & INNOVATIVE CONSTRUCTION STRATEGIES:

- INTERMEDIATE CONTRACT TIMES / LIQUIDATED DAMAGES

DOCUMENT NOT CONSIDERED FINAL
UNLESS ALL SIGNATURES COMPLETED



APPROVED:
DATE: 12/19/2024

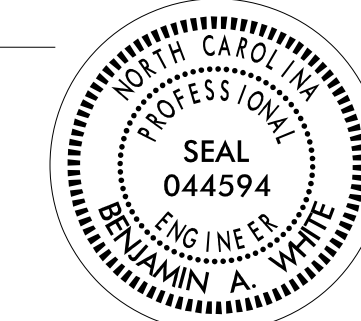

SEAL

12/19/2024 pw:\gfn\pw.bentley.com\gfn\pw-0\Documents\Projects\63639\5-Work\Task 017 - 15BPR\33.3 Ashe\TrafficControl\15BPR\33.3_TC_TMP01.dgn User:bwwhite

TIP PROJECT: 15BPR.133.3

ROADWAY STANDARD DRAWINGS

THE FOLLOWING ROADWAY STANDARDS AS SHOWN IN "ROADWAY STANDARD DRAWINGS" - N.C. DEPARTMENT OF TRANSPORTATION - RALEIGH, N.C., DATED JANUARY 2024 ARE APPLICABLE TO THIS PROJECT AND BY REFERENCE HEREBY ARE CONSIDERED A PART OF THESE PLANS:

| STD. NO. | TITLE |
|----------|---|
| 1101.01 | WORK ZONE WARNING SIGNS |
| 1101.02 | TEMPORARY LANE CLOSURES |
| 1101.11 | TRAFFIC CONTROL DESIGN TABLES |
| 1110.01 | STATIONARY WORK ZONE SIGNS |
| 1110.02 | PORTABLE WORK ZONE SIGNS |
| 1130.01 | DRUMS |
| 1135.01 | CONES |
| 1150.01 | FLAGGING DEVICES |
| 1160.01 | TEMPORARY CRASH CUSHION |
| 1170.01 | PORTABLE CONCRETE BARRIER |
| 1180.01 | SKINNY DRUMS |
| 1205.01 | PAVEMENT MARKINGS - LINE TYPES AND OFFSETS |
| 1205.02 | PAVEMENT MARKINGS - TWO LANE AND MULTILANE ROADWAYS |
| 1205.04 | PAVEMENT MARKINGS - INTERSECTIONS |
| 1205.12 | PAVEMENT MARKINGS - BRIDGES |

LEGEND

GENERAL

- DIRECTION OF TRAFFIC FLOW
- DIRECTION OF PEDESTRIAN TRAFFIC FLOW
- EXIST. PVMT.
- NORTH ARROW
- PROPOSED PVMT.
- TEMP. SHORING (LOCATION PURPOSES ONLY)

WORK AREA

REMOVAL

USER DEFINED (IF NEEDED)

USER DEFINED (IF NEEDED)

SIGNALS

- EXISTING
- PROPOSED
- TEMPORARY
- PORTABLE
- DRIVEWAY SIGNAL

PAVEMENT MARKINGS

- EXISTING LINES
- TEMPORARY LINES

TRAFFIC CONTROL DEVICES

- BARRICADE (TYPE III)
- CONE
- DRUM SKINNY DRUM TUBULAR MARKER
- TEMPORARY CRASH CUSHION
- FLASHING ARROW BOARD
- FLAGGER
- LAW ENFORCEMENT
- TRUCK MOUNTED ATTENUATOR (TMA)
- CHANGEABLE MESSAGE SIGN

TEMPORARY SIGNING

- PORTABLE SIGN
- STATIONARY SIGN
- STATIONARY OR PORTABLE SIGN

PAVEMENT MARKERS

- CRYSTAL / CRYSTAL
- CRYSTAL / RED
- YELLOW / YELLOW

PAVEMENT MARKING SYMBOLS

- PAVEMENT MARKING SYMBOLS

TEMPORARY PAVEMENT MARKINGS

FOR TEMPORARY PAVEMENT MARKINGS, SEE PAVEMENT MARKING SCHEDULE ON INDIVIDUAL DETAIL SHEETS

PERMANENT PAVEMENT MARKINGS

- T1 THERMOPLASTIC WHITE EDGELINE (4", 90 MIL)
- T13 THERMOPLASTIC YELLOW DOUBLE CENTER (4", 90 MIL)

2/14/2025 pw:\gfn\pw.bentley.com\gfn\Projects\63639\5-Working\Task 017 - 15BPR.133.3 - Ashe\TrafficControl\15BPR.133.3_TC_TMP1A.dgn User:bwht



APPROVED: 68F776221617443

DATE: 2/14/2025

SEAL

DOCUMENT NOT CONSIDERED FINAL UNLESS ALL SIGNATURES COMPLETED

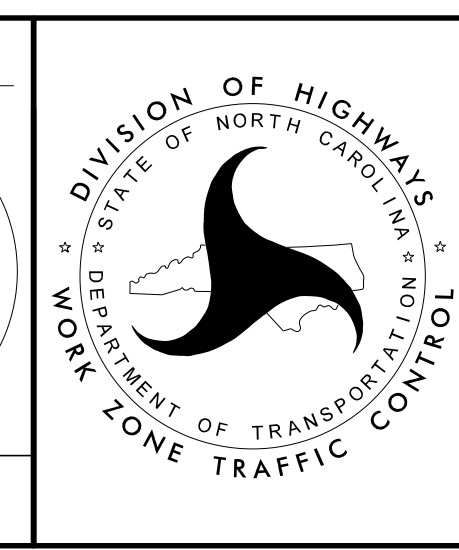

ROADWAY STANDARD DRAWINGS & LEGEND

GENERAL NOTES

CHANGES MAY BE REQUIRED WHEN PHYSICAL DIMENSIONS IN THE DETAIL DRAWINGS, STANDARD DETAILS, AND ROADWAY DETAILS ARE NOT ATTAINABLE TO MEET FIELD CONDITIONS OR RESULT IN DUPLICATE OR UNDESIRE OVERLAPPING OF DEVICES. MODIFICATION MAY INCLUDE: MOVING, SUPPLEMENTING, COVERING, OR REMOVAL OF DEVICES AS DIRECTED BY THE ENGINEER.

THE FOLLOWING GENERAL NOTES APPLY AT ALL TIMES FOR THE DURATION OF THE CONSTRUCTION PROJECT EXCEPT WHEN OTHERWISE NOTED IN THE PLAN OR DIRECTED BY THE ENGINEER.

TIME RESTRICTIONS

A) DO NOT CLOSE OR NARROW TRAVEL LANES AS FOLLOWS:

| ROAD NAME | DAY AND TIME RESTRICTIONS |
|---|--|
| SR 1644 MCNEIL RD (ALONG BRIDGE 040507) | MONDAY THRU SUNDAY 6:00 A.M. TO 7:00 P.M. |

B) DO NOT CLOSE OR NARROW TRAVEL LANES DURING HOLIDAYS AND SPECIAL EVENTS AS FOLLOWS:

| ROAD NAME |
|---|
| NC 194 (ALONG BRIDGES 040019 AND 040032) |
| SR 1514 W. DEEP FORD RD (ALONG BRIDGE 040478) |
| SR 1501 DEEP FORD RD (ALONG BRIDGE 040478) |
| SR 1644 MCNEIL RD (ALONG BRIDGE 040507) |

HOLIDAY

- FOR ANY UNEXPECTED OCCURRENCE THAT CREATES UNUSUALLY HIGH TRAFFIC VOLUMES, AS DIRECTED BY THE ENGINEER.
- FOR NEW YEAR'S, BETWEEN THE HOURS OF 6:00 A.M. DECEMBER 31st TO 7:00 P.M. JANUARY 2ND. IF NEW YEAR'S DAY IS ON A FRIDAY, SATURDAY, SUNDAY, OR MONDAY THEN UNTIL 7:00 P.M. THE FOLLOWING TUESDAY.
- FOR EASTER, BETWEEN THE HOURS OF 6:00 A.M. THURSDAY AND 7:00 P.M. MONDAY.
- FOR MEMORIAL DAY, BETWEEN THE HOURS OF 6:00 A.M. FRIDAY TO 7:00 P.M. TUESDAY.
- FOR INDEPENDENCE DAY, BETWEEN THE HOURS OF 6:00 A.M. THE DAY BEFORE INDEPENDENCE DAY AND 7:00 P.M. THE DAY AFTER INDEPENDENCE DAY.

IF INDEPENDENCE DAY IS ON A FRIDAY, SATURDAY, SUNDAY OR MONDAY THEN BETWEEN THE HOURS OF 6:00 A.M. THE THURSDAY BEFORE INDEPENDENCE DAY AND 7:00 P.M. THE TUESDAY AFTER INDEPENDENCE DAY.
- FOR LABOR DAY, BETWEEN THE HOURS OF 6:00 A.M. FRIDAY AND 7:00 P.M. TUESDAY.
- FOR THANKSGIVING DAY, BETWEEN THE HOURS OF 6:00 A.M. TUESDAY TO 7:00 P.M. MONDAY.
- FOR CHRISTMAS, BETWEEN THE HOURS OF 6:00 A.M. THE FRIDAY BEFORE THE WEEK OF CHRISTMAS DAY AND 7:00 P.M. THE FOLLOWING TUESDAY AFTER THE WEEK OF CHRISTMAS.

LANE AND SHOULDER CLOSURE REQUIREMENTS

- C) REMOVE LANE CLOSURE DEVICES FROM THE LANE WHEN WORK IS NOT BEING PERFORMED BEHIND THE LANE CLOSURE OR WHEN A LANE CLOSURE IS NO LONGER NEEDED OR AS DIRECTED BY THE ENGINEER.
- D) WHEN PERSONNEL AND/OR EQUIPMENT ARE WORKING WITHIN 15 FT OF AN OPEN TRAVEL LANE, CLOSE THE NEAREST OPEN SHOULDER USING ROADWAY STANDARD DRAWING NO. 1101.04 UNLESS THE WORK AREA IS PROTECTED BY BARRIER OR GUARDRAIL OR A LANE CLOSURE IS INSTALLED.

E) WHEN PERSONNEL AND/OR EQUIPMENT ARE WORKING WITHIN 5 FT OF AN OPEN TRAVEL LANE ON AN UNDIVIDED FACILITY, CLOSE THE NEAREST OPEN TRAVEL LANE USING ROADWAY STANDARD DRAWING NO. 1101.02 UNLESS THE WORK AREA IS PROTECTED BY BARRIER OR GUARDRAIL.

WHEN PERSONNEL AND/OR EQUIPMENT ARE WORKING WITHIN 10 FT OF AN OPEN TRAVEL LANE ON A DIVIDED FACILITY, CLOSE THE NEAREST OPEN TRAVEL LANE USING ROADWAY STANDARD DRAWING NO. 1101.02 UNLESS THE WORK AREA IS PROTECTED BY BARRIER OR GUARDRAIL.

F) WHEN PERSONNEL AND/OR EQUIPMENT ARE WORKING WITHIN A LANE OF TRAVEL OF AN UNDIVIDED OR DIVIDED FACILITY, CLOSE THE LANE ACCORDING TO THE TRAFFIC CONTROL PLANS, ROADWAY STANDARD DRAWINGS, OR AS DIRECTED BY THE ENGINEER. CONDUCT THE WORK SO THAT ALL PERSONNEL AND/OR EQUIPMENT REMAIN WITHIN THE CLOSED TRAVEL LANE.

G) DO NOT WORK SIMULTANEOUSLY WITHIN 15 FT ON BOTH SIDES OF AN OPEN TRAVELWAY, RAMP, OR LOOP WITHIN THE SAME LOCATION UNLESS PROTECTED WITH GUARDRAIL OR BARRIER.

PAVEMENT EDGE DROP OFF REQUIREMENTS

H) BACKFILL AT A 6:1 SLOPE UP TO THE EDGE AND ELEVATION OF EXISTING PAVEMENT IN AREAS ADJACENT TO AN OPENED TRAVEL LANE THAT HAS AN EDGE OF PAVEMENT DROP-OFF AS FOLLOWS:

BACKFILL DROP-OFFS THAT EXCEED 2 INCHES ON ROADWAYS WITH POSTED SPEED LIMITS OF 45 MPH OR GREATER.

BACKFILL DROP-OFFS THAT EXCEED 3 INCHES ON ROADWAYS WITH POSTED SPEED LIMITS LESS THAN 45 MPH.

BACKFILL WITH SUITABLE COMPACTED MATERIAL, AS APPROVED BY THE ENGINEER, AT NO EXPENSE TO THE DEPARTMENT.

I) DO NOT EXCEED A DIFFERENCE OF 2 INCHES IN ELEVATION BETWEEN OPEN LANES OF TRAFFIC FOR NOMINAL LIFTS OF 1.5 INCHES. INSTALL ADVANCE WARNING "UNEVEN LANES" SIGNS (W8-11) IN ADVANCE AND A MINIMUM OF EVERY HALF MILE THROUGHOUT THE UNEVEN AREA.

TRAFFIC PATTERN ALTERATIONS

J) NOTIFY THE ENGINEER THIRTY (30) CALENDAR DAYS PRIOR TO ANY TRAFFIC PATTERN ALTERATION.

SIGNING

K) INSTALL ADVANCE WORK ZONE WARNING SIGNS WHEN WORK IS WITHIN 40 FT FROM THE EDGE OF TRAVEL LANE AND NO MORE THAN THREE (3) DAYS PRIOR TO THE BEGINNING OF CONSTRUCTION.

L) ENSURE ALL NECESSARY SIGNING IS IN PLACE PRIOR TO ALTERING ANY TRAFFIC PATTERN.

TRAFFIC BARRIER

M) INSTALL TEMPORARY BARRIER ACCORDING TO THE TRANSPORTATION MANAGEMENT PLANS A MAXIMUM OF TWO (2) WEEKS PRIOR TO BEGINNING WORK IN ANY LOCATION. ONCE TEMPORARY BARRIER IS INSTALLED AT ANY LOCATION PROCEED IN A CONTINUOUS MANNER TO COMPLETE THE PROPOSED WORK IN THAT LOCATION UNLESS OTHERWISE STATED IN THE TRANSPORTATION MANAGEMENT PLANS OR AS DIRECTED BY THE ENGINEER.

DO NOT PLACE BARRIER DIRECTLY ON ANY SURFACE OTHER THAN ASPHALT OR CONCRETE.

ONCE TEMPORARY BARRIER IS INSTALLED AT ANY LOCATION AND NO WORK IS PERFORMED BEHIND THE TEMPORARY BARRIER FOR A PERIOD LONGER THAN TWO (2) MONTHS, REMOVE / RESET TEMPORARY BARRIER AT NO COST TO THE DEPARTMENT UNLESS OTHERWISE STATED IN THE TRANSPORTATION MANAGEMENT PLANS, TEMPORARY BARRIER IS PROTECTING A HAZARD, OR AS DIRECTED BY THE ENGINEER.

INSTALL TEMPORARY BARRIER WITH THE TRAFFIC FLOW BEGINNING WITH THE UPSTREAM SIDE OF TRAFFIC. REMOVE TEMPORARY BARRIER AGAINST THE TRAFFIC FLOW BEGINNING WITH THE DOWNSTREAM SIDE OF TRAFFIC.

INSTALL AND SPACE DRUMS NO GREATER THAN TWICE THE POSTED SPEED LIMIT (MPH) TO CLOSE OR KEEP THE SECTION OF THE ROADWAY CLOSED UNTIL THE TEMPORARY BARRIER CAN BE PLACED OR AFTER THE TEMPORARY BARRIER IS REMOVED.

N) PROTECT THE APPROACH END OF MOVABLE/PORTABLE CONCRETE BARRIER AT ALL TIMES DURING THE INSTALLATION AND REMOVAL OF THE BARRIER BY EITHER A TRUCK MOUNTED ATTENUATOR (MAXIMUM 72 HOURS) OR A TEMPORARY CRASH CUSHION.

PROTECT THE APPROACH END OF MOVABLE/PORTABLE CONCRETE BARRIER FROM ONCOMING TRAFFIC AT ALL TIMES BY A TEMPORARY CRASH CUSHION UNLESS THE APPROACH END OF MOVABLE/PORTABLE CONCRETE BARRIER IS OFFSET FROM ONCOMING TRAFFIC AS FOLLOWS OR AS SHOWN IN THE PLANS: (SEE ALSO 1101.05)

| POSTED SPEED LIMIT | MINIMUM OFFSET |
|--------------------|----------------|
| 40 OR LESS | 15 FT |
| 45 - 50 | 20 FT |
| 55 | 25 FT |
| 60 MPH or HIGHER | 30 FT |

TRAFFIC CONTROL DEVICES

O) WHEN LANE CLOSURES ARE NOT IN EFFECT SPACE CHANNELIZING DEVICES IN WORK AREAS NO GREATER IN FEET THAN TWICE THE POSTED SPEED LIMIT (MPH) EXCEPT, 10 FT ON-CENTER IN RADII, AND 3 FT OFF THE EDGE OF AN OPEN TRAVELWAY. REFER TO STANDARD SPECIFICATIONS FOR ROADS AND STRUCTURES SECTIONS 1130 (DRUMS), 1135 (CONES) AND 1180 (SKINNY DRUMS) FOR ADDITIONAL REQUIREMENTS.

PAVEMENT MARKINGS AND MARKERS

P) PLACE ONE APPLICATION OF PAINT FOR TEMPORARY TRAFFIC PATTERNS. PLACE A SECOND APPLICATION OF PAINT SIX (6) MONTHS AFTER THE INITIAL APPLICATION AND EVERY SIX MONTHS AS DIRECTED BY THE ENGINEER.

Q) TIE PROPOSED PAVEMENT MARKING LINES TO EXISTING PAVEMENT MARKING LINES.

R) REMOVE/REPLACE ANY CONFLICTING/DAMAGED PAVEMENT MARKINGS AND MARKERS BY THE END OF EACH DAY'S OPERATION.

LOCAL NOTES

TEN (10) CALENDAR DAYS BEFORE BEGINNING OF CONSTRUCTION AT EACH BRIDGE LOCATION, CONTACT BEN HINNANT WITH NCDOT OVERSIZE/OVERWEIGHT PERMIT DIVISION TO PLACE RESTRICTION ON OVERSIZE/OVERWEIGHT LOADS ALONG BRIDGE ROUTE. UPON COMPLETION OF CONSTRUCTION AT EACH BRIDGE LOCATION, CONTACT OVERSIZE/OVERWEIGHT PERMIT DIVISION TO LIFT RESTRICTION ALONG BRIDGE ROUTE.

12/19/2024 12:19:2024 pw:\gfn\pw-bentley.com\gfn\pw-0\Documents\Projects\63639\5-WorKing\Task 017 - 15BPR.133.3 - Ashe\TrafficControl\15BPR.133.3_TC_TMP1B.dgn User:bwwhite



APPROVED: 
 DATE: 12/19/2024
 SEAL
 DOCUMENT NOT CONSIDERED FINAL UNLESS ALL SIGNATURES COMPLETED

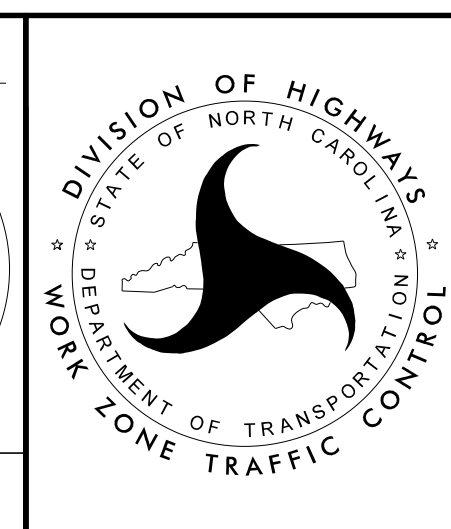

GENERAL NOTES

PHASING

BRIDGE REHABILITATION INCLUDES DECK RECONSTRUCTION, DECK OVERLAYS, GIRDER REPAIRS, BEARING REPLACEMENTS AND PAINTING. BRIDGE WORK ALSO INCLUDES DECK EXPANSION JOINTS, DECK GROOVING AND SUBSTRUCTURE REPAIRS UNDER THE BRIDGE. WORK ON BRIDGES 040019 AND 040478 SHALL NOT BE PERFORMED CONCURRENTLY UNLESS APPROVED BY THE ENGINEER.

BRIDGE 040019

NOTE: BEFORE BEGINNING CONSTRUCTION, THE CONTRACTOR SHALL PLACE ADVANCE WORK ZONE WARNING SIGNS ALONG NC 194. SEE ROADWAY STANDARD DRAWING 1101.01, SHEET 3 OF 3.

COMPLETE THE REQUIREMENTS OF PHASES I AND II WITHIN A CONSECUTIVE ONE HUNDRED SEVENTY-THREE (173) CALENDAR DAY PERIOD. SEE INTERMEDIATE CONTRACT TIME AND LIQUIDATED DAMAGES.

PHASE I

- STEP 1:** USING LANE CLOSURES, INSTALL TEMPORARY PORTABLE SIGNALS, DRIVEWAY SIGNALS, TEMPORARY PAVEMENT MARKINGS AND PORTABLE CONCRETE BARRIER AS SHOWN ON SHEET TMP-4 USING ROADWAY STANDARD DRAWING 1101.02 SHEET 1 OF 19.
- STEP 2:** PLACE TEMPORARY SIGNAL SIGNAGE AND ACTIVATE TEMPORARY PORTABLE SIGNALS AND DRIVEWAY SIGNALS. CLOSE THE WESTBOUND LANE OF NC 194 AND SHIFT TRAFFIC FROM A TWO-LANE, TWO-WAY PATTERN TO A ONE-LANE, TWO-WAY PATTERN ON NC 194 AS SHOWN ON SHEET TMP-4.
- STEP 3:** PERFORM DECK RECONSTRUCTION, DECK OVERLAY AND ASSOCIATED MILLING AND PAVING. REPLACE ANY OBLITERATED PAVEMENT MARKINGS.

PHASE II

- STEP 1:** USING LANE CLOSURES, RESET TEMPORARY PORTABLE SIGNALS, DRIVEWAY SIGNALS, TEMPORARY PAVEMENT MARKINGS AND PORTABLE CONCRETE BARRIER AS SHOWN ON SHEET TMP-5 USING ROADWAY STANDARD DRAWING 1101.02 SHEET 1 OF 19.
- STEP 2:** PLACE TEMPORARY SIGNAL SIGNAGE AND ACTIVATE TEMPORARY PORTABLE SIGNALS AND DRIVEWAY SIGNALS. CLOSE THE EASTBOUND LANE OF NC 194 AND SHIFT TRAFFIC FROM A TWO-LANE, TWO-WAY PATTERN TO A ONE-LANE, TWO-WAY PATTERN ON NC 194 AS SHOWN ON SHEET TMP-5.
- STEP 3:** PERFORM DECK RECONSTRUCTION, DECK OVERLAY AND ASSOCIATED MILLING AND PAVING. REPLACE ANY OBLITERATED PAVEMENT MARKINGS.
- STEP 4:** ONCE DECK RECONSTRUCTION, DECK OVERLAY AND MILLING AND PAVING WORK IS COMPLETE, REMOVE TEMPORARY PORTABLE SIGNALS, DRIVEWAY SIGNALS AND PORTABLE CONCRETE BARRIER. USING ROADWAY STANDARD DRAWING 1101.02 SHEET 1 OF 19, REMOVE TEMPORARY PAVEMENT MARKINGS, PERFORM FINAL BRIDGE WORK SUCH AS JOINT INSTALLATION AND GROOVING, INSTALL FINAL PAVEMENT MARKINGS AND RETURN NC 194 TRAFFIC TO A TWO-LANE, TWO-WAY PATTERN.

BRIDGE 040032

NOTE: BEFORE BEGINNING CONSTRUCTION, THE CONTRACTOR SHALL PLACE ADVANCE WORK ZONE WARNING SIGNS ALONG NC 194. SEE ROADWAY STANDARD DRAWING 1101.01 SHEET 3 OF 3.

COMPLETE THE REQUIREMENTS OF PHASES I AND II WITHIN A CONSECUTIVE ONE HUNDRED THIRTY-FIVE (135) CALENDAR DAY PERIOD. SEE INTERMEDIATE CONTRACT TIME AND LIQUIDATED DAMAGES.

PHASE I

- STEP 1:** USING LANE CLOSURES, INSTALL TEMPORARY PORTABLE SIGNALS, DRIVEWAY SIGNALS, TEMPORARY PAVEMENT MARKINGS AND PORTABLE CONCRETE BARRIER AS SHOWN ON SHEET TMP-6 USING ROADWAY STANDARD DRAWING 1101.02 SHEET 1 OF 19.
- STEP 2:** PLACE TEMPORARY SIGNAL SIGNAGE AND ACTIVATE TEMPORARY PORTABLE SIGNALS AND DRIVEWAY SIGNALS. CLOSE THE EASTBOUND LANE OF NC 194 AND SHIFT TRAFFIC FROM A TWO-LANE, TWO-WAY PATTERN TO A ONE-LANE, TWO-WAY PATTERN ON NC 194 AS SHOWN ON SHEET TMP-6.
- STEP 3:** PERFORM DECK RECONSTRUCTION, DECK OVERLAY AND ASSOCIATED MILLING AND PAVING. REPLACE ANY OBLITERATED PAVEMENT MARKINGS.

PHASE II

- STEP 1:** USING LANE CLOSURES, RESET PORTABLE CONCRETE BARRIER AS SHOWN ON SHEET TMP-7 USING ROADWAY STANDARD DRAWING 1101.02 SHEET 1 OF 19.
- STEP 2:** CLOSE THE WESTBOUND LANE OF NC 194 AND SHIFT TRAFFIC TO A ONE-LANE, TWO-WAY PATTERN ON NC 194 AS SHOWN ON SHEET TMP-7.
- STEP 3:** PERFORM DECK RECONSTRUCTION, DECK OVERLAY AND ASSOCIATED MILLING AND PAVING. REPLACE ANY OBLITERATED PAVEMENT MARKINGS.
- STEP 4:** ONCE DECK RECONSTRUCTION, DECK OVERLAY AND MILLING AND PAVING WORK IS COMPLETE, REMOVE TEMPORARY PORTABLE SIGNALS, DRIVEWAY SIGNALS, PORTABLE CONCRETE BARRIER AND TRAFFIC CONTROL DEVICES. USING ROADWAY STANDARD DRAWING 1101.02 SHEET 1 OF 19, REMOVE TEMPORARY PAVEMENT MARKINGS, PERFORM FINAL BRIDGE WORK SUCH AS JOINT INSTALLATION AND GROOVING, INSTALL FINAL PAVEMENT MARKINGS AND RETURN NC 194 TRAFFIC TO A TWO-LANE, TWO-WAY PATTERN.

BRIDGE 040478

NOTE: BEFORE BEGINNING CONSTRUCTION, THE CONTRACTOR SHALL PLACE ADVANCE WORK ZONE WARNING SIGNS ALONG W. DEEP FORD RD AND DEEP FORD RD. SEE ROADWAY STANDARD DRAWING 1101.01 SHEET 3 OF 3.

PHASE I

- STEP 1:** USING ROADWAY STANDARD DRAWING 1101.02 SHEET 1 OF 19, CLOSE THE WESTBOUND LANE ON W. DEEP FORD RD AND SHIFT TRAFFIC FROM A TWO-LANE, TWO-WAY PATTERN TO A ONE-LANE, TWO-WAY PATTERN ALONG W. DEEP FORD RD/DEEP FORD RD AS SHOWN ON SHEET TMP-8.
- STEP 2:** USING LANE CLOSURES WITH FLAGGERS, COMPLETE BRIDGE REHAB WORK. SEE STRUCTURE PLANS FOR MORE DETAILS.

PHASE II

- STEP 1:** USING ROADWAY STANDARD DRAWING 1101.02 SHEET 1 OF 19, CLOSE THE EASTBOUND LANE ON W. DEEP FORD RD AND SHIFT TRAFFIC FROM A TWO-LANE, TWO-WAY PATTERN TO A ONE-LANE, TWO-WAY PATTERN ALONG W. DEEP FORD RD/DEEP FORD RD AS SHOWN ON SHEET TMP-9.
- STEP 2:** USING LANE CLOSURES WITH FLAGGERS, COMPLETE BRIDGE REHAB WORK. SEE STRUCTURE PLANS FOR MORE DETAILS.
- STEP 3:** USING LANE CLOSURES WITH FLAGGERS, INSTALL FINAL PAVEMENT MARKINGS AND RETURN TRAFFIC TO A TWO-LANE, TWO-WAY PATTERN.

BRIDGE 040507

NOTE: BEFORE BEGINNING CONSTRUCTION, THE CONTRACTOR SHALL PLACE ADVANCE WORK ZONE WARNING SIGNS ALONG MCNEIL RD. SEE ROADWAY STANDARD DRAWING 1101.01 SHEET 3 OF 3.

PHASE I

- STEP 1:** USING ROADWAY STANDARD DRAWING 1101.02 SHEET 1 OF 19, CLOSE THE WESTBOUND LANE ON MCNEIL RD AND SHIFT TRAFFIC FROM A TWO-LANE, TWO-WAY PATTERN TO A ONE-LANE, TWO-WAY PATTERN ALONG MCNEIL RD AS SHOWN ON SHEET TMP-10.
- STEP 2:** USING NIGHTLY LANE CLOSURES WITH FLAGGERS, COMPLETE BRIDGE REHAB WORK. SEE STRUCTURE PLANS FOR MORE DETAILS. PROVIDE TASK LIGHTING AT EACH FLAGGER LOCATION.

PHASE II

- STEP 1:** USING ROADWAY STANDARD DRAWING 1101.02 SHEET 1 OF 19, CLOSE THE EASTBOUND LANE ON MCNEIL RD AND SHIFT TRAFFIC FROM A TWO-LANE, TWO-WAY PATTERN TO A ONE-LANE, TWO-WAY PATTERN ALONG MCNEIL RD AS SHOWN ON SHEET TMP-11.
- STEP 2:** USING NIGHTLY LANE CLOSURES WITH FLAGGERS, COMPLETE BRIDGE REHAB WORK. SEE STRUCTURE PLANS FOR MORE DETAILS. PROVIDE TASK LIGHTING AT EACH FLAGGER LOCATION.
- STEP 3:** USING LANE CLOSURES WITH FLAGGERS, INSTALL FINAL PAVEMENT MARKINGS AND RETURN TRAFFIC TO A TWO-LANE, TWO-WAY PATTERN.

2/14/2025
pw:\gfnnet-pw.bentley.com\gfnnet-pw-0\Documents\Projects\63639\5-WorKing\Task 017 - 15BPR.133.3 Ashe\TrafficControl\15BPR.133.3.TC_TMP03.dgn
User:jolson



APPROVED: 
DATE: 2/14/2025

SEAL

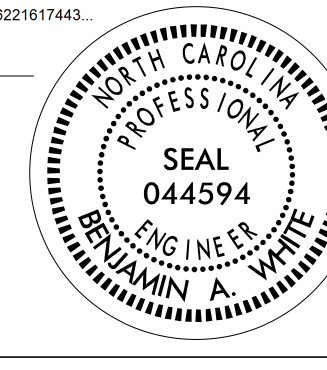

**DOCUMENT NOT CONSIDERED FINAL
UNLESS ALL SIGNATURES COMPLETED**

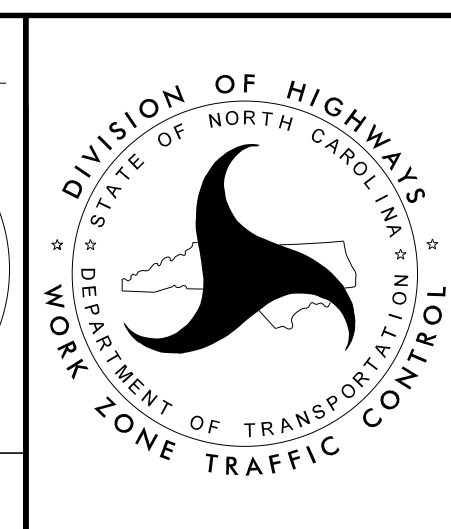

PHASING

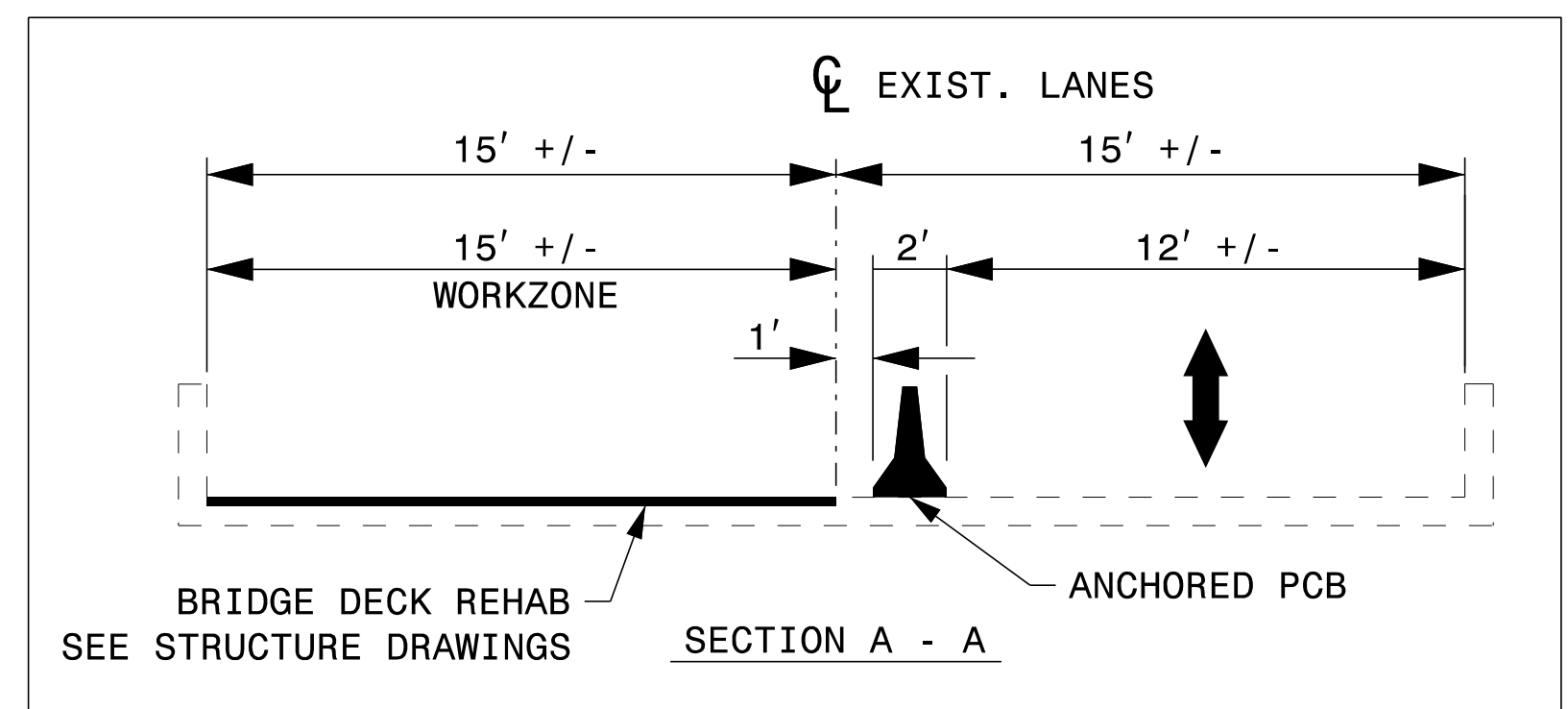
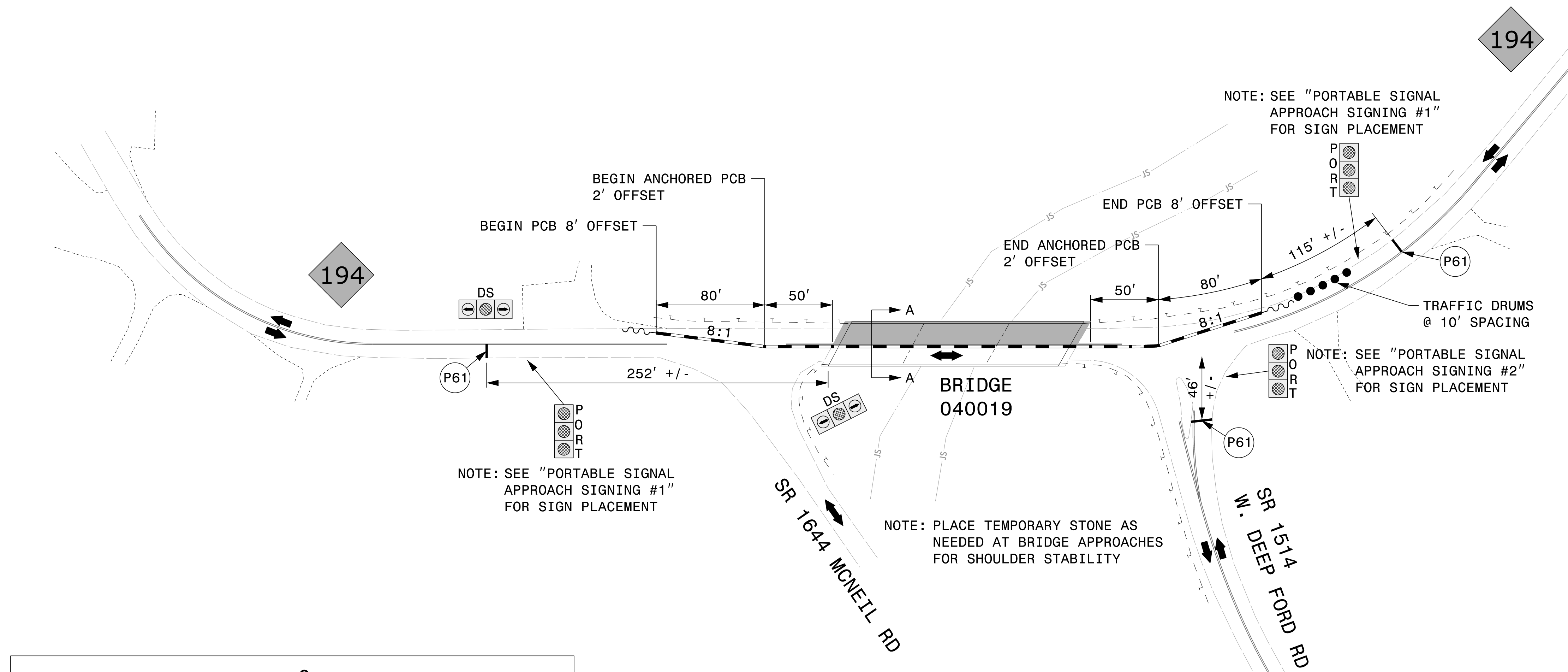
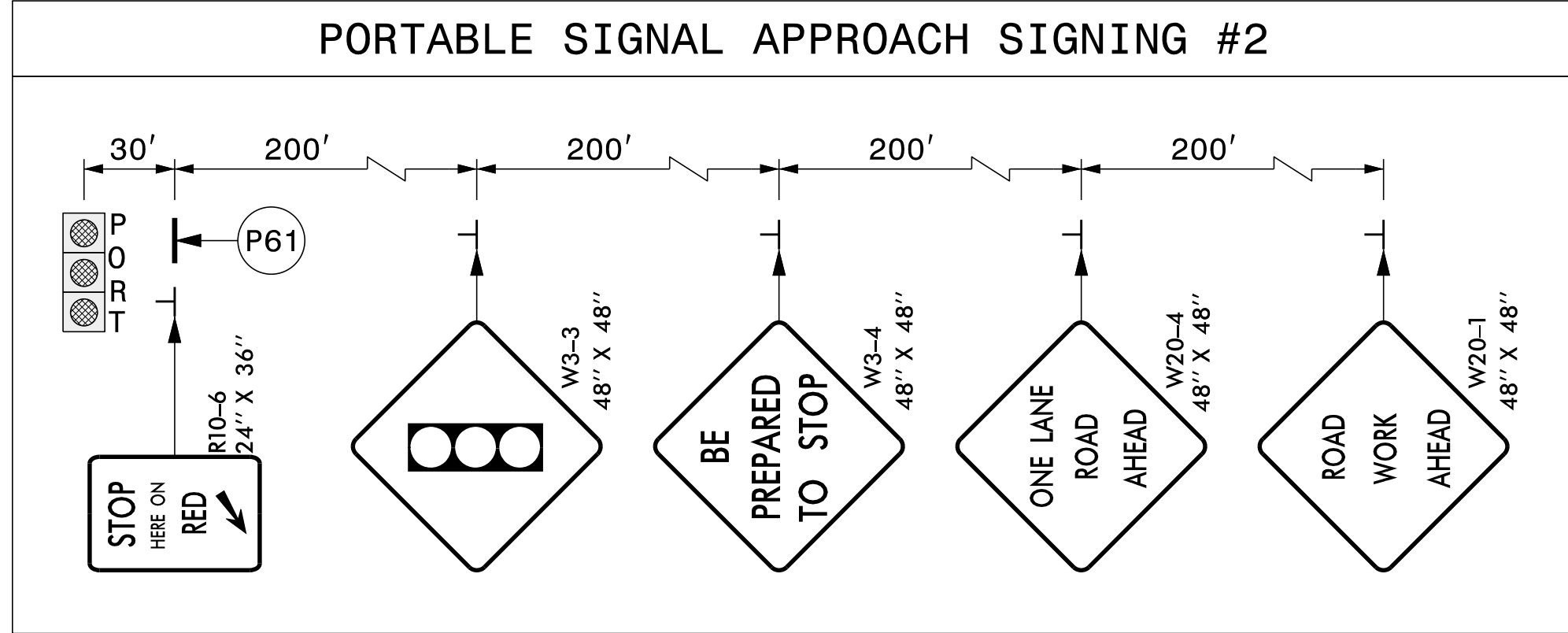
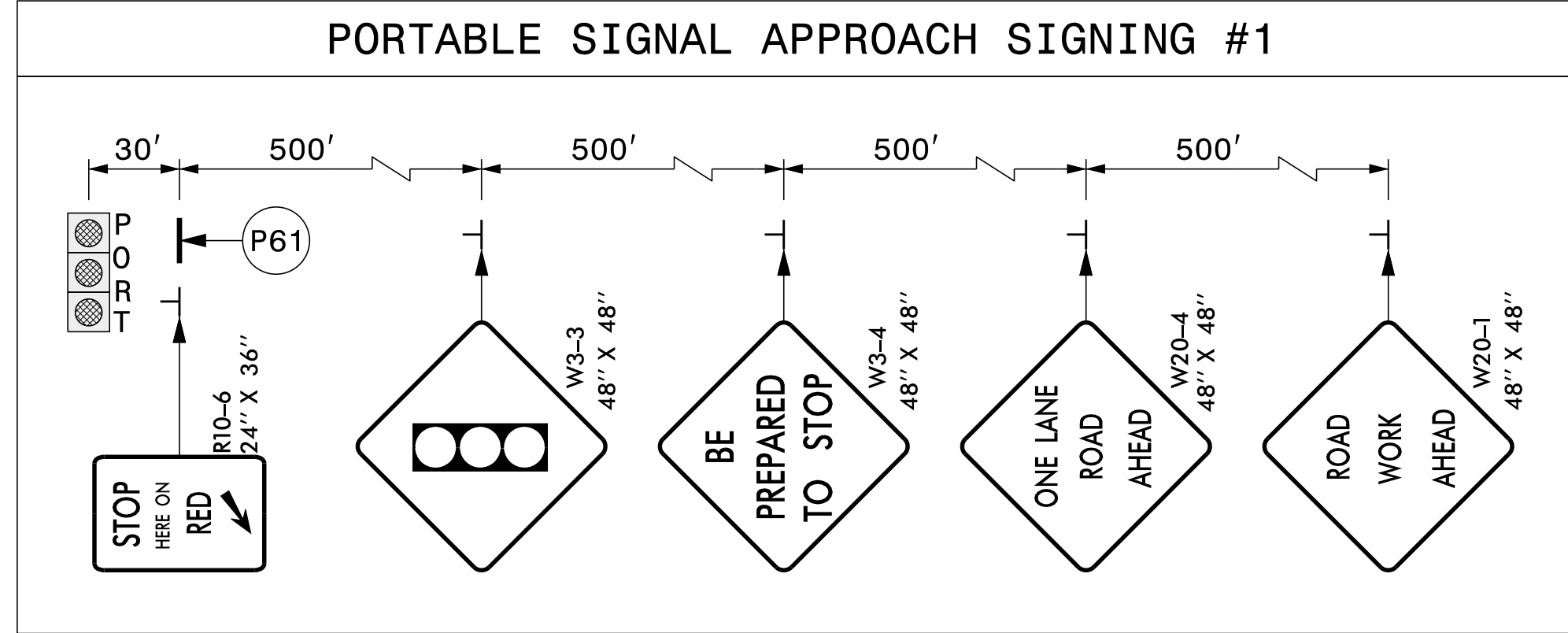

TEMPORARY PAVEMENT MARKING LEGEND

| |
|-----------------------------------|
| (P61) PAINT - WHITE STOPBAR (24") |
|-----------------------------------|

APPROVED: *Benjamin A. White*
 DATE: 12/19/2024

SEAL

DOCUMENT NOT CONSIDERED FINAL
UNLESS ALL SIGNATURES COMPLETED



BRIDGE 040019
PHASE 1 DETAIL



12/19/2024
 pw:\gfn\pw.bentley.com\gfn\pw-01\Documents\Projects\63639\5-Working\Task 017 - 15BPR.133.3 - Ashe\TrafficControl\15BPR.133.3_TC_TMP04.dgn
 User: bwhite

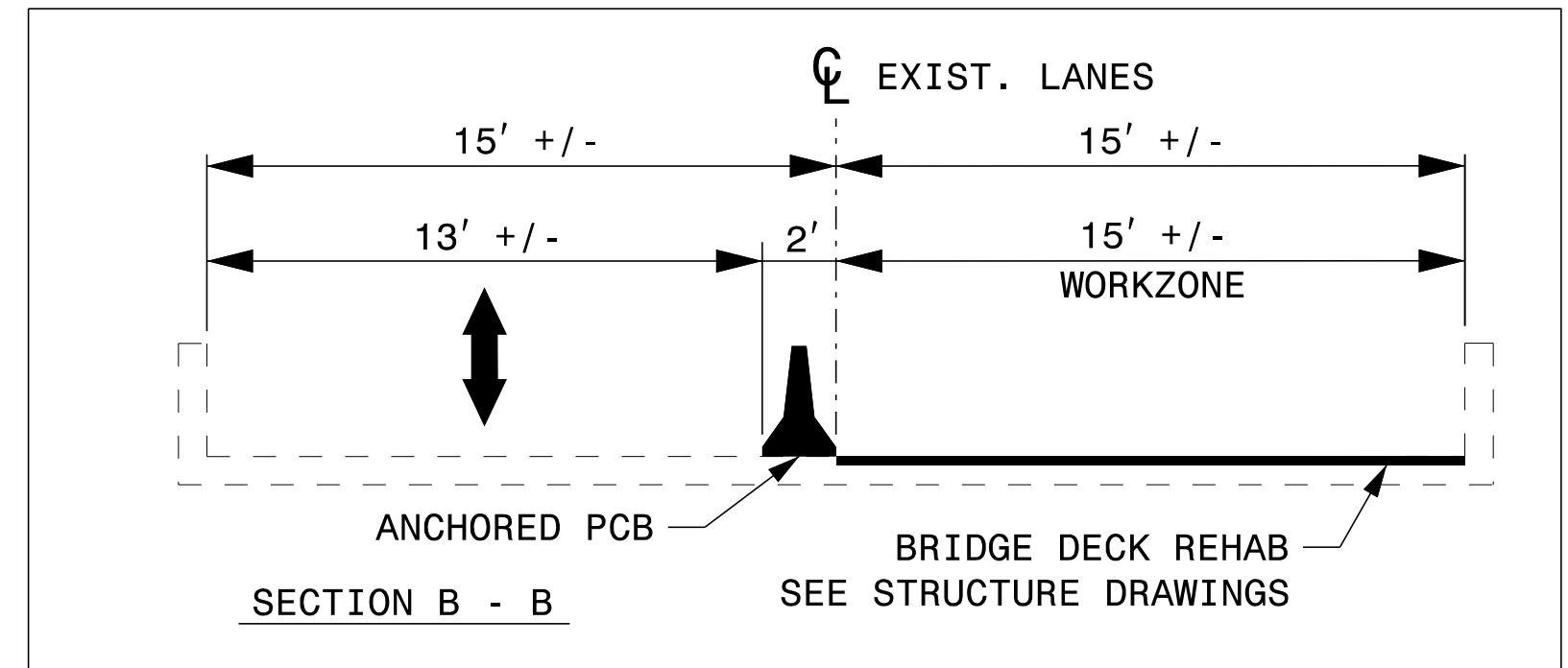
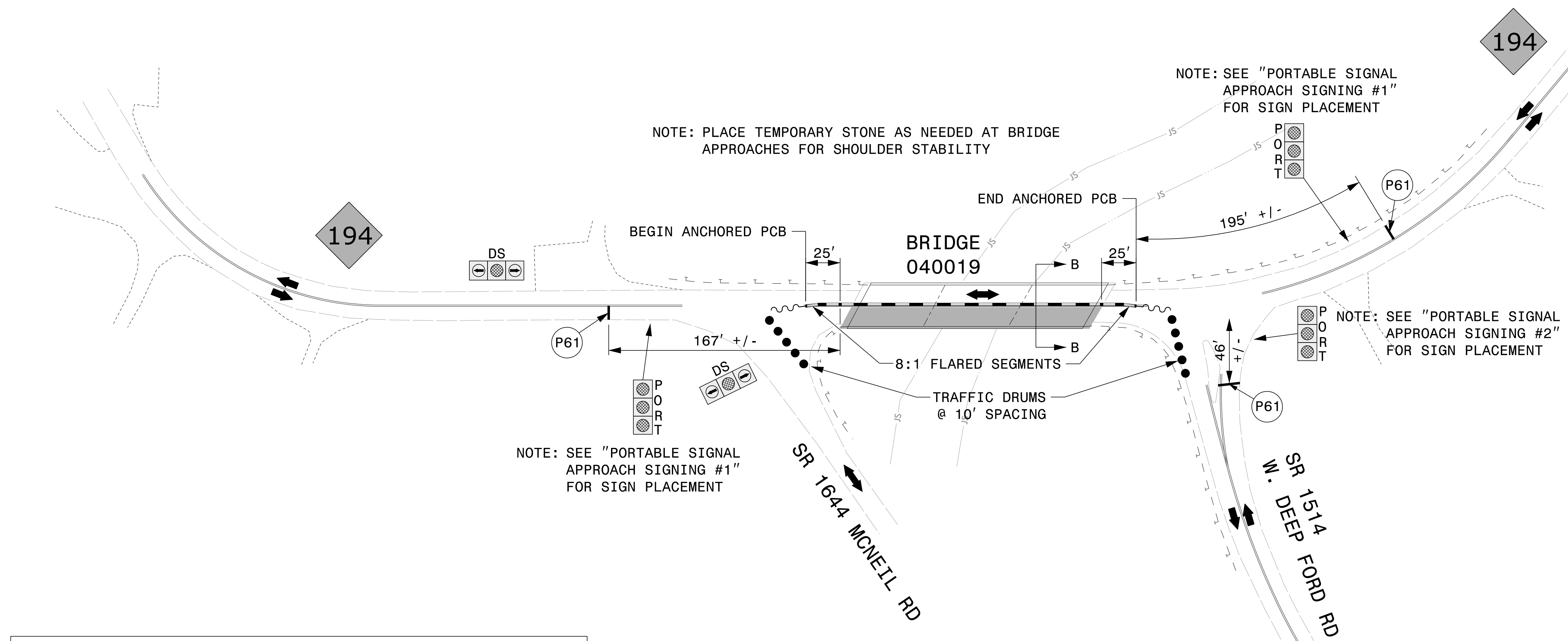
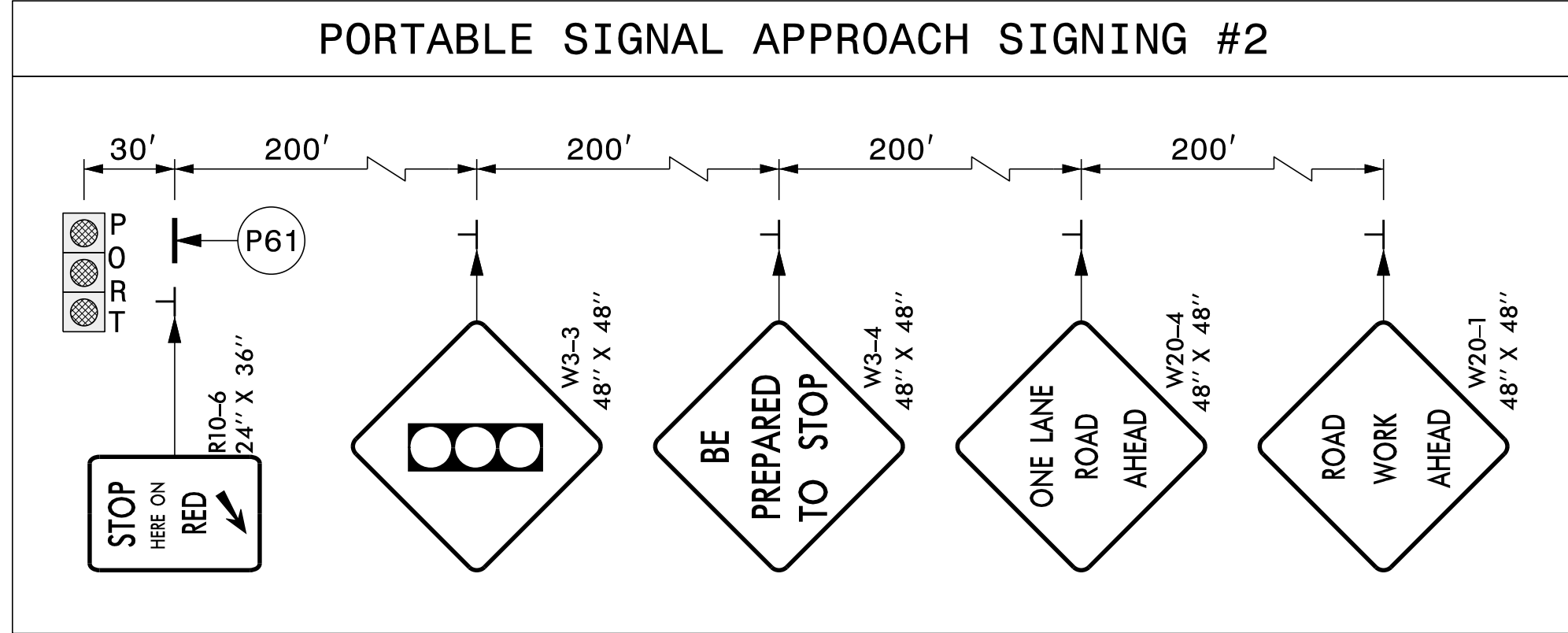
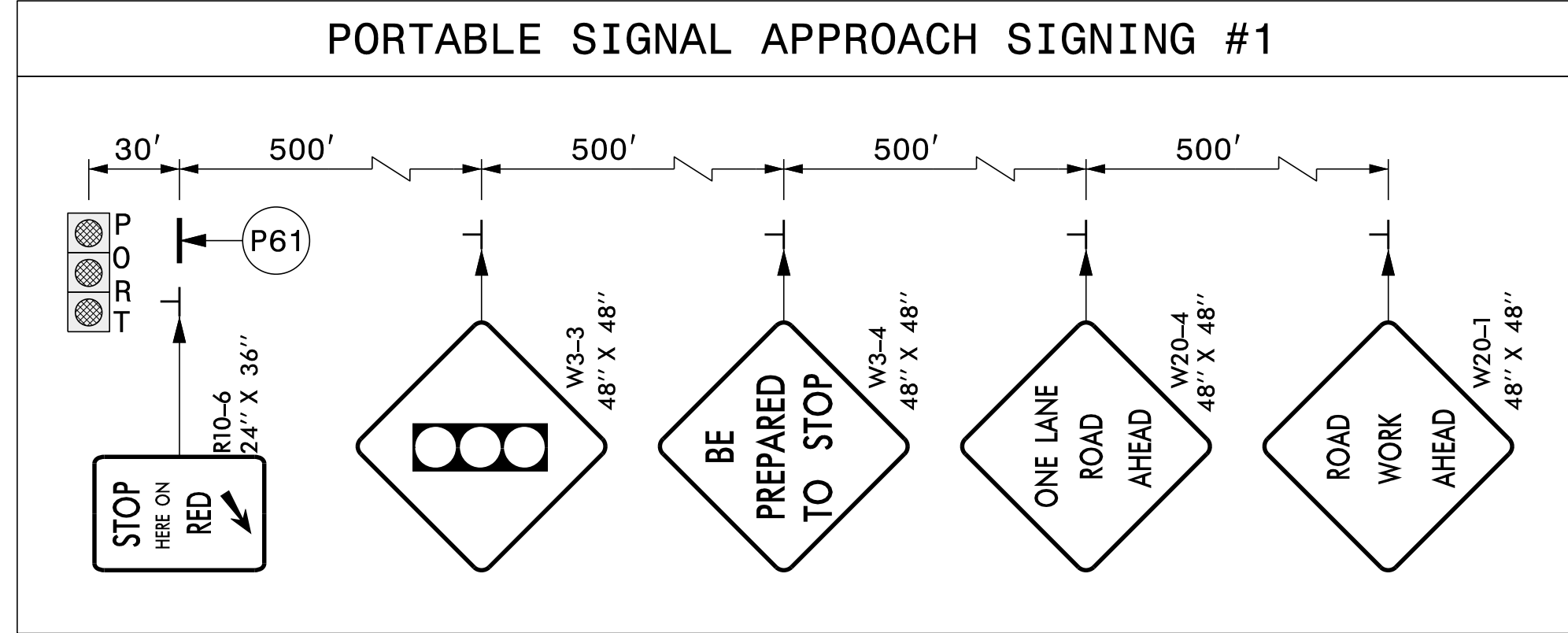

TEMPORARY PAVEMENT MARKING LEGEND

| |
|-----------------------------------|
| (P61) PAINT - WHITE STOPBAR (24") |
|-----------------------------------|

APPROVED: *Benjamin A. White*
DATE: 12/19/2024

SEAL

DOCUMENT NOT CONSIDERED FINAL
UNLESS ALL SIGNATURES COMPLETED

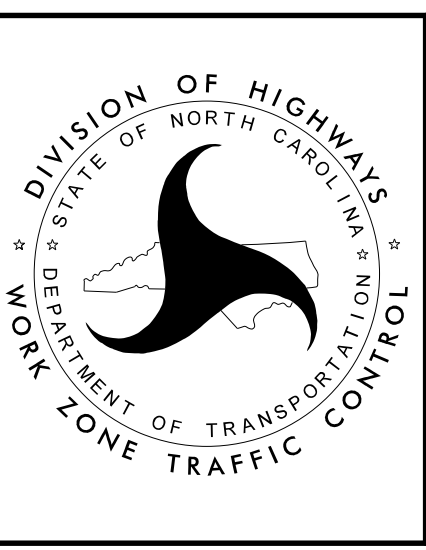

BRIDGE 040019
PHASE 2 DETAIL

Division of Highways
Department of Transportation
Work Zone Traffic Control

12/19/2024
pw:\gfn\pw.bentley.com\gfn\pw-01\Documents\Projects\63639\5-Working\Task 017 - 15BPR.133.3 - Ashe\TrafficControl\15BPR.133.3_TC_TMP05.dgn
User: bwhite



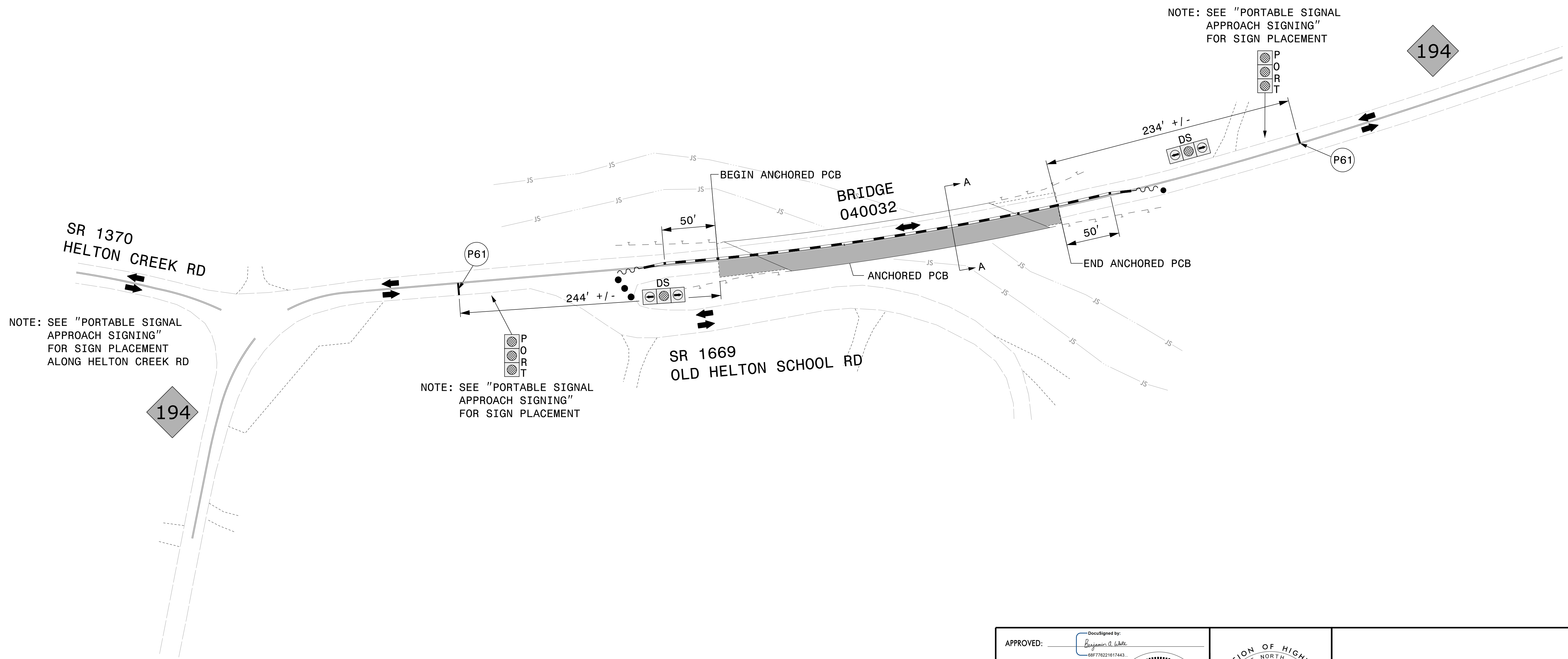
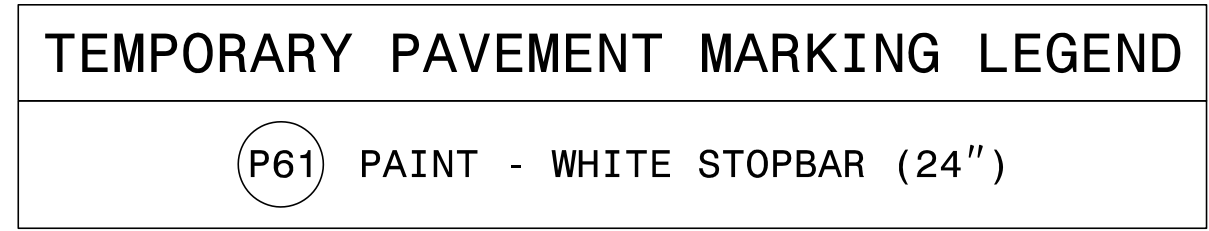
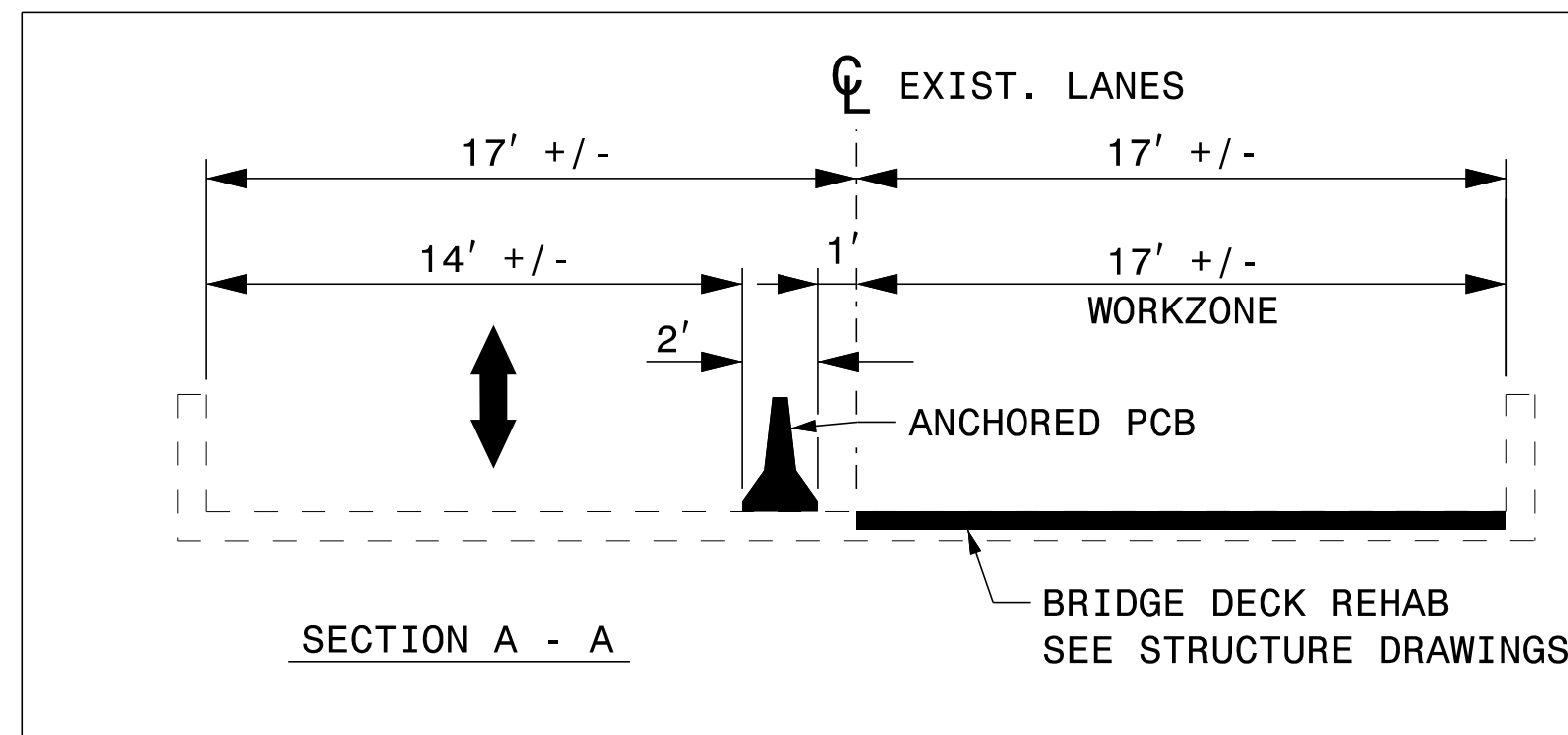
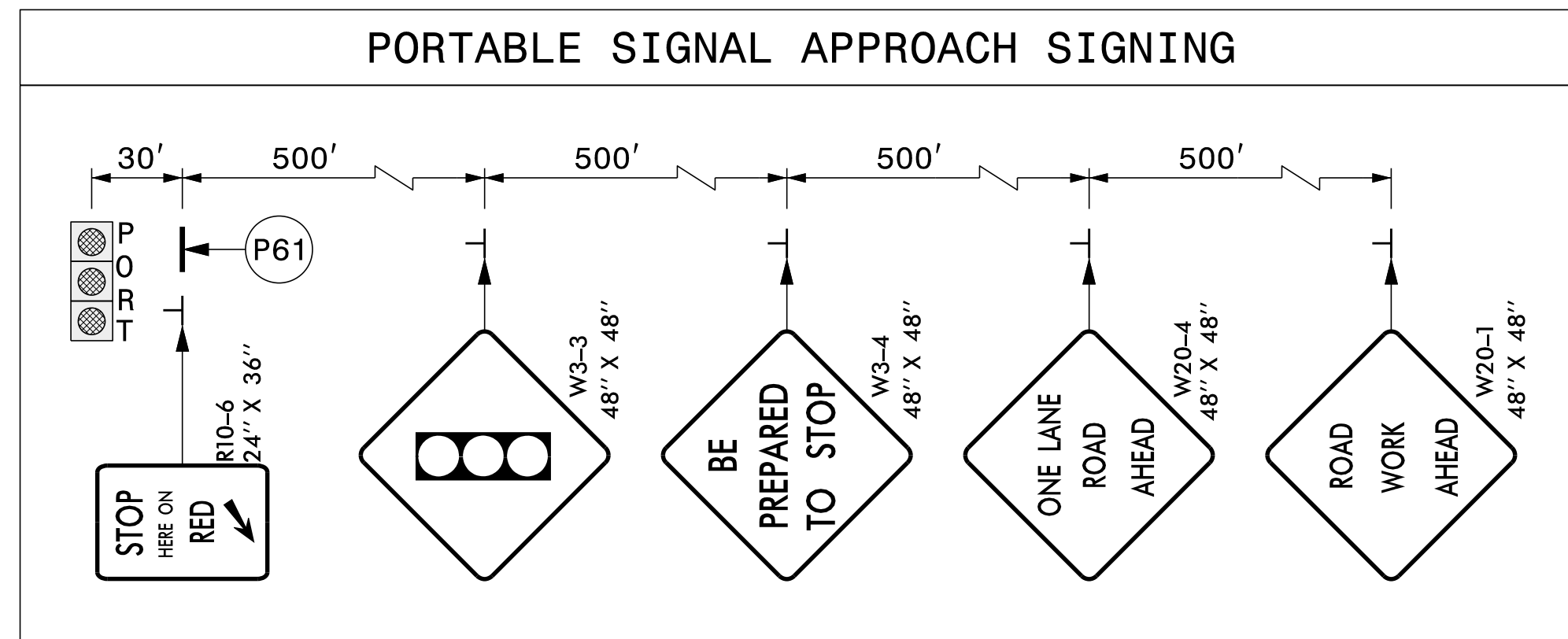

12/19/2024
 pw:\gfn\et-pw-bentley.com\mgfnet-pw-0\Documents\Projects\63639\5-Working\Task 017 - 15BPR.133.3 - Ashe\TrafficControl\15BPR.133.3_TC_TMP06.dgn
 User: bwhite

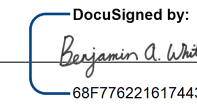
APPROVED: 
 DATE: 12/19/2024

SEAL

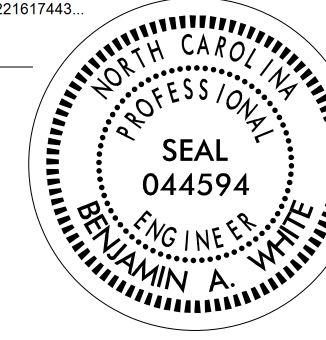

**DOCUMENT NOT CONSIDERED FINAL
UNLESS ALL SIGNATURES COMPLETED**

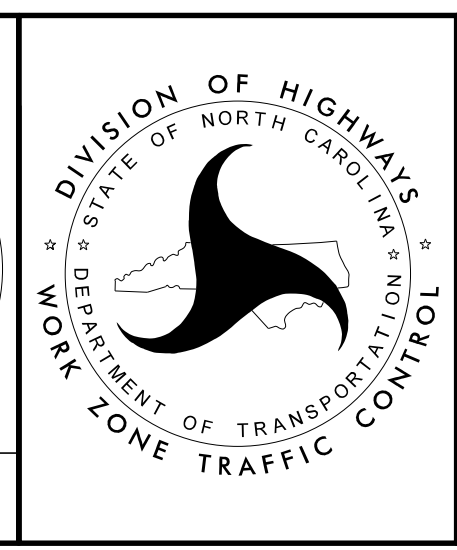

**BRIDGE 040032
PHASE 1 DETAIL**

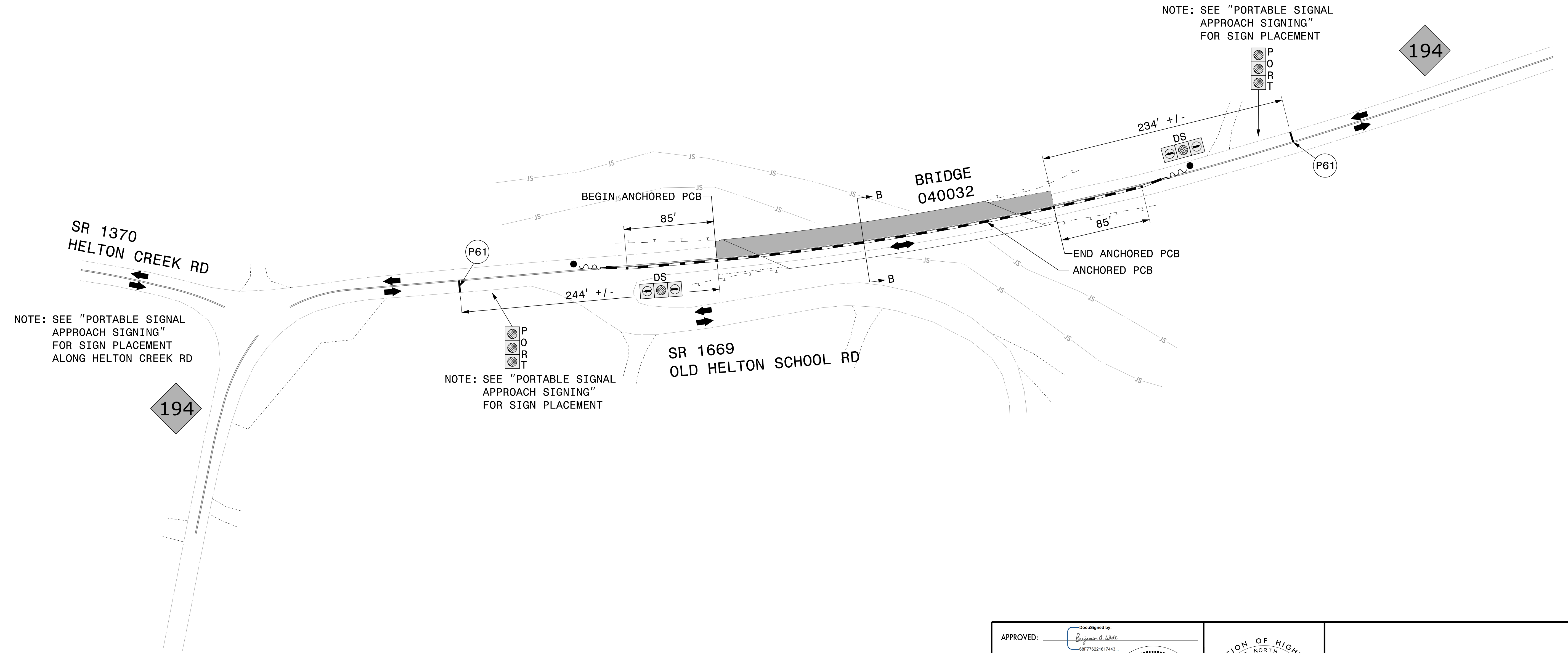
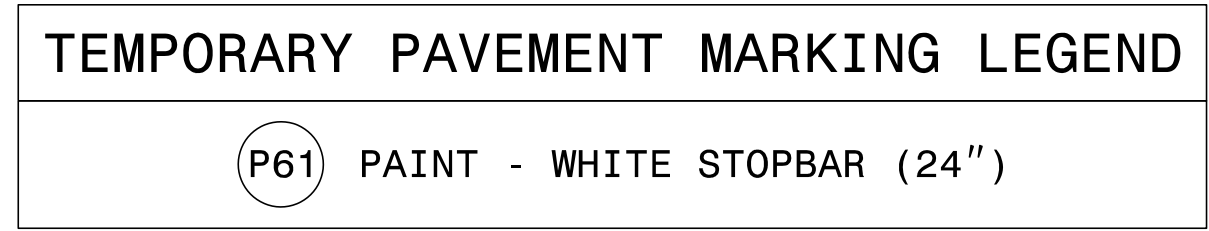
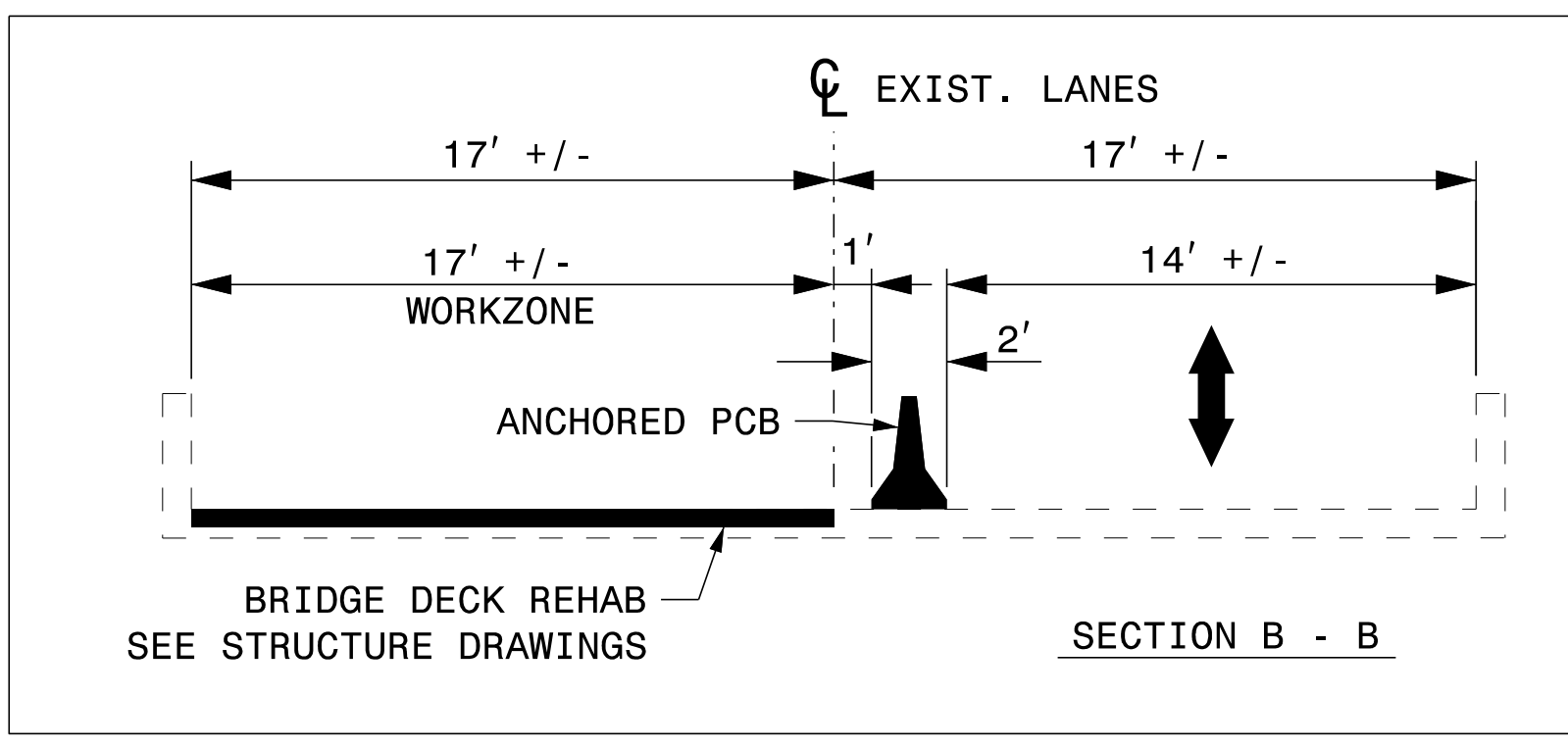
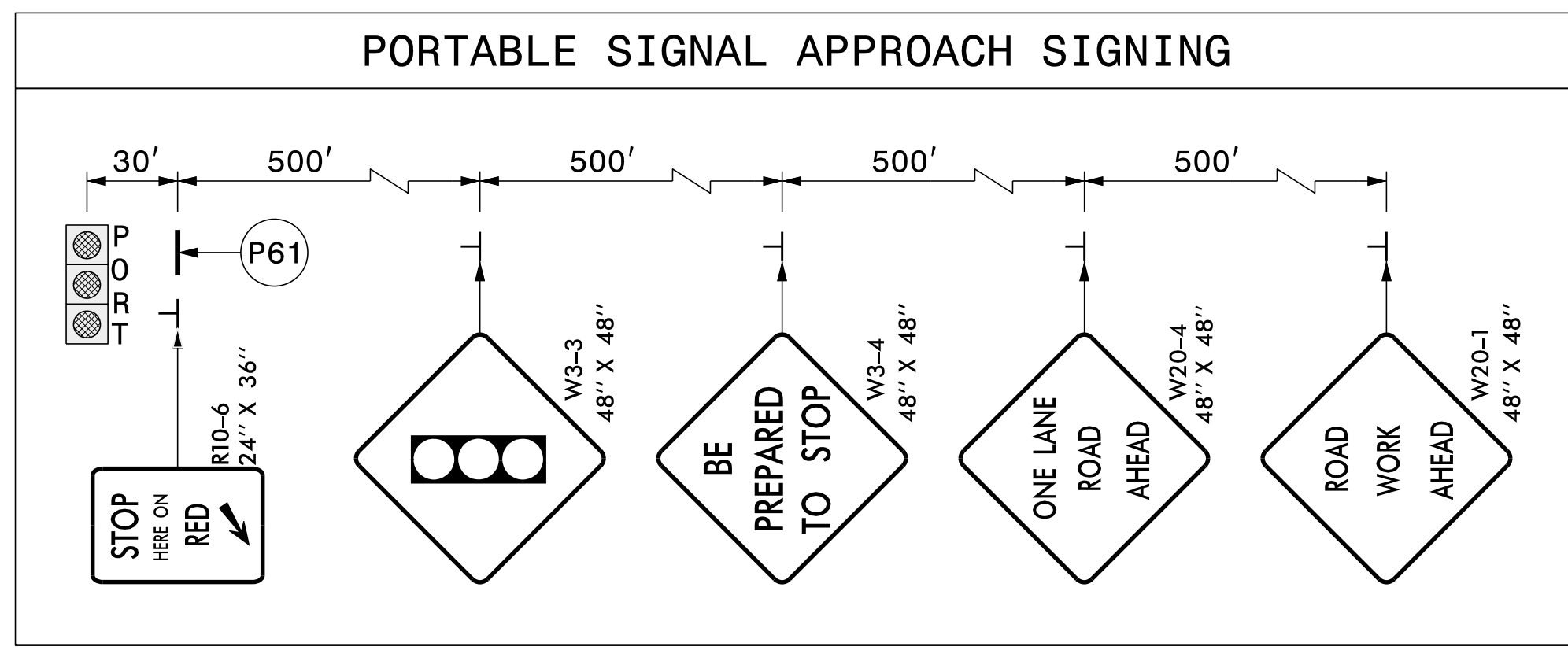

12/19/2024
 pw:\gfn\pw.bentley.com\gfn\pw-01\Documents\Projects\63639\5-Working\Task 017 - 15BPR.133.3 - Ashe\TrafficControl\15BPR.133.3_TC_TMP07.dgn
 User: bwhite

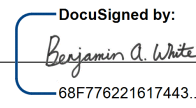
APPROVED: 
 DATE: 12/19/2024

SEAL

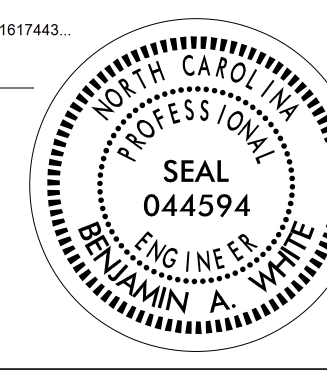

**DOCUMENT NOT CONSIDERED FINAL
UNLESS ALL SIGNATURES COMPLETED**

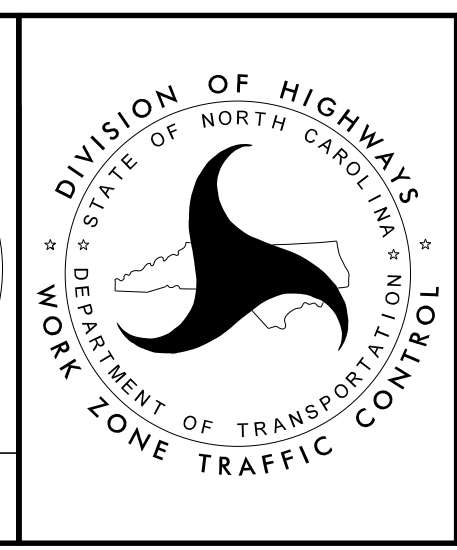

**BRIDGE 040032
PHASE 2 DETAIL**



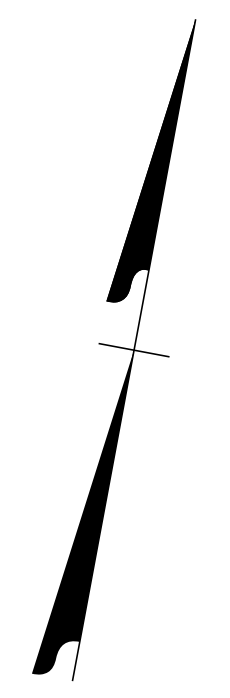
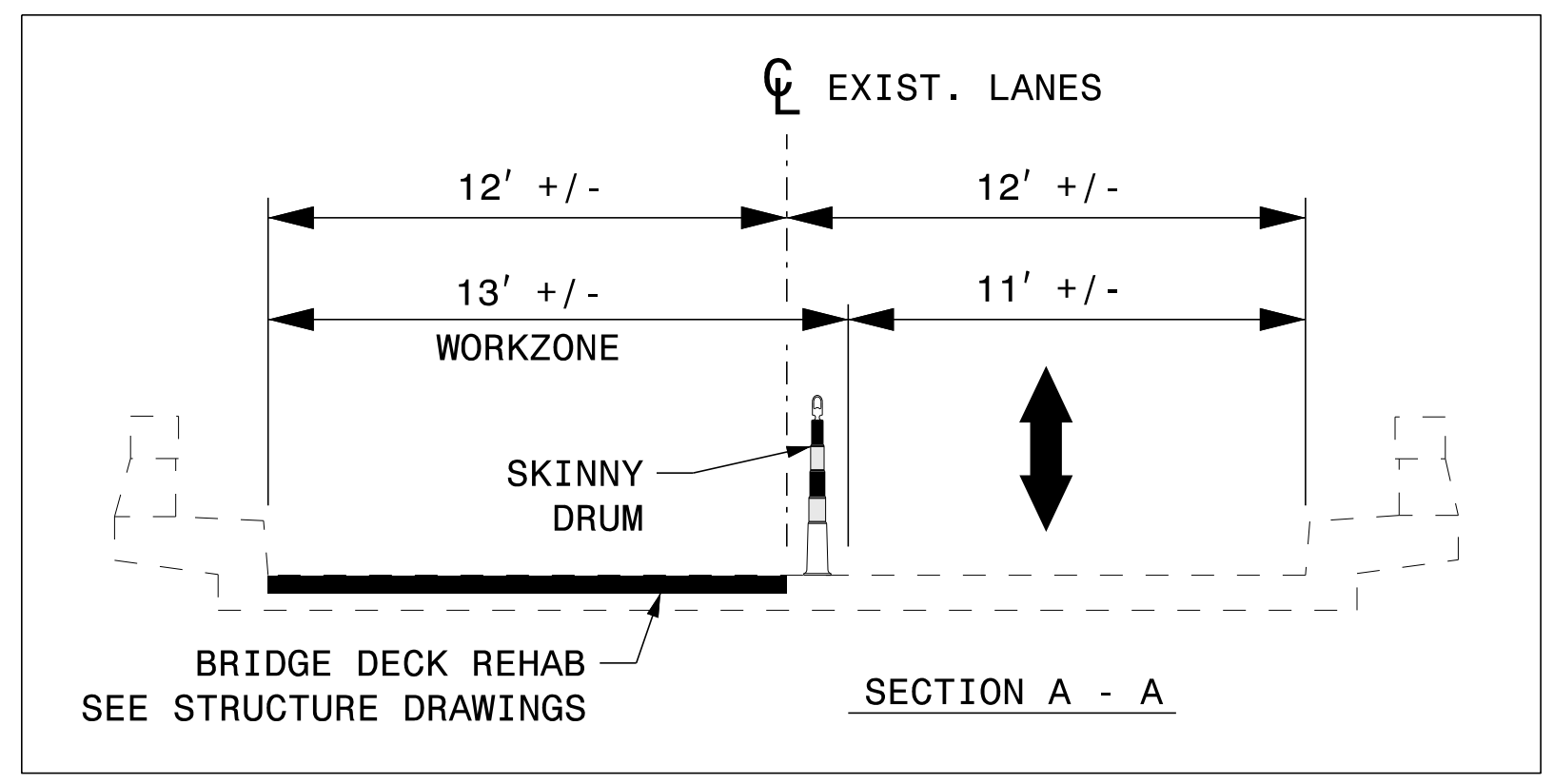
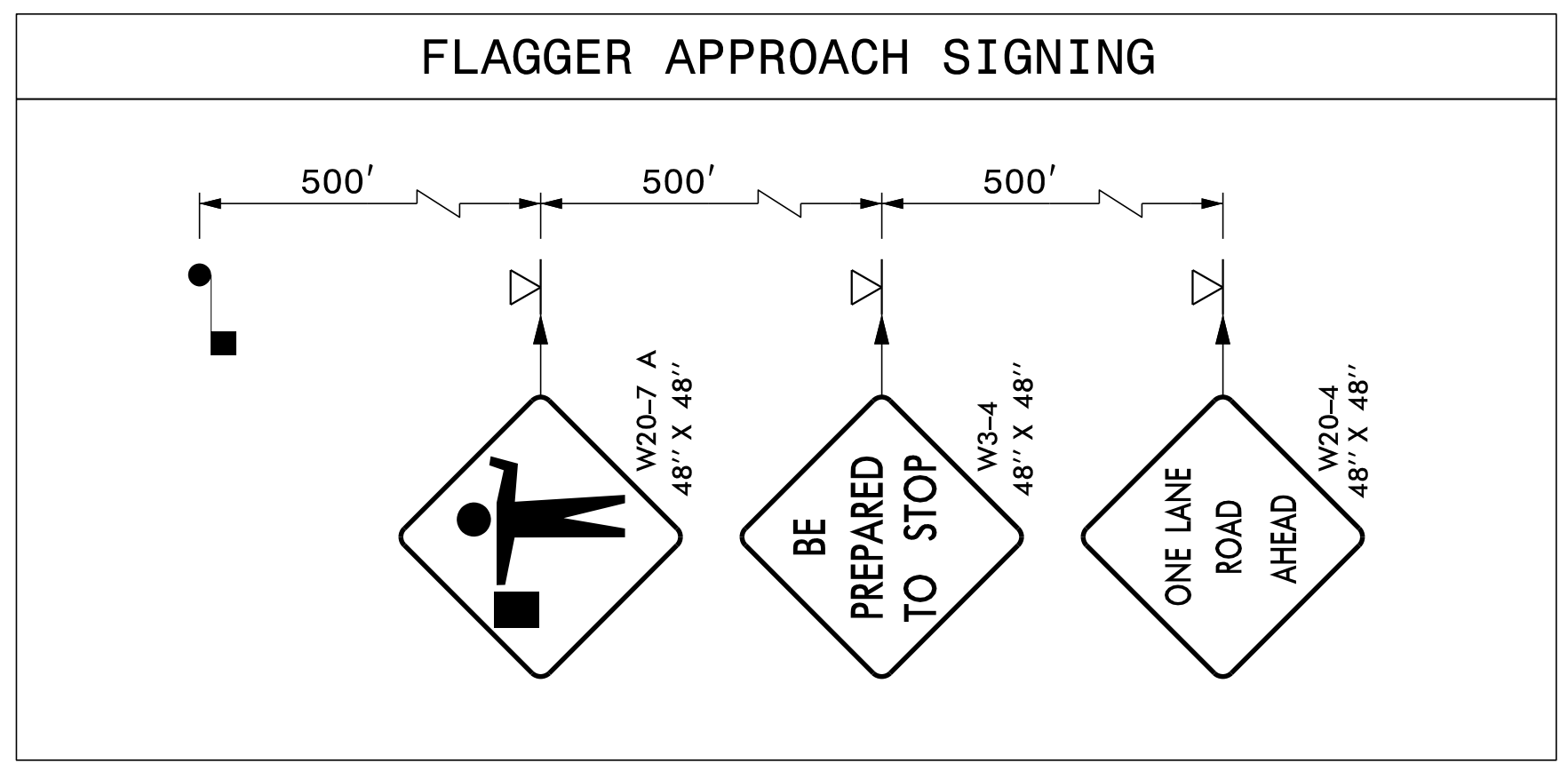

NOTE: ALL ROADWAYS HAVE 55 MPH (STATUTORY) SPEED LIMIT. FIELD ADJUST SIGN SPACING AS NECESSARY BASED ON APPROACH ROADWAY CONDITIONS.

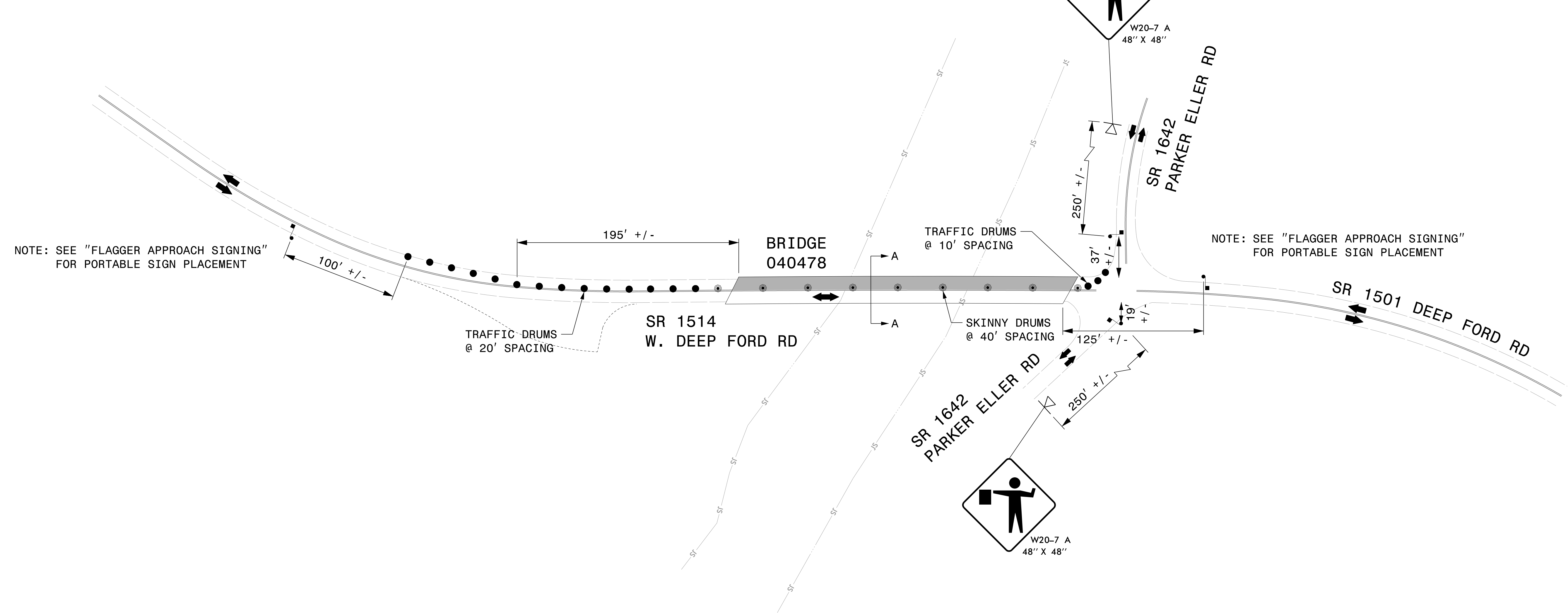

12/19/2024 pw:\gfn\pw.bentley.com\gfn\pw-0\Documents\Projects\63639\5-Working\Task 017 - 15BPR.133.3 - Ashe\TrafficControl\15BPR.133.3_TC_TMP08.dgn User:bwht



APPROVED: *Benjamin A. White*
 DATE: 12/19/2024

SEAL

DOCUMENT NOT CONSIDERED FINAL UNLESS ALL SIGNATURES COMPLETED

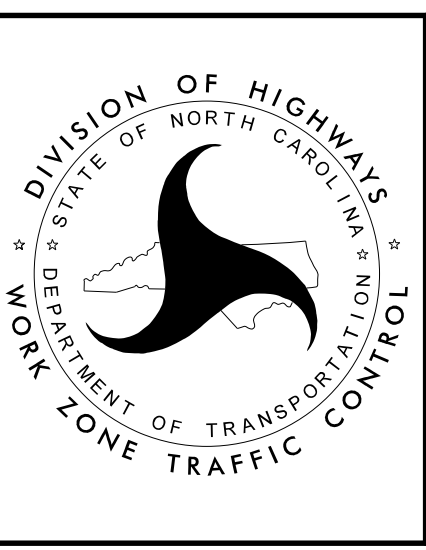

**BRIDGE 04078
 PHASE 1 DETAIL**

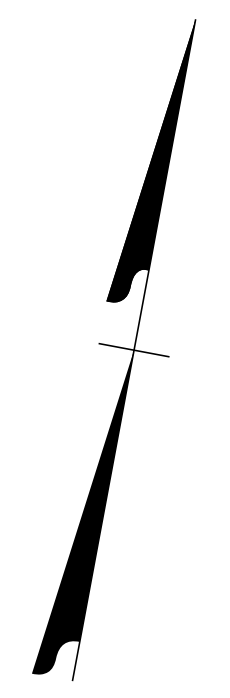
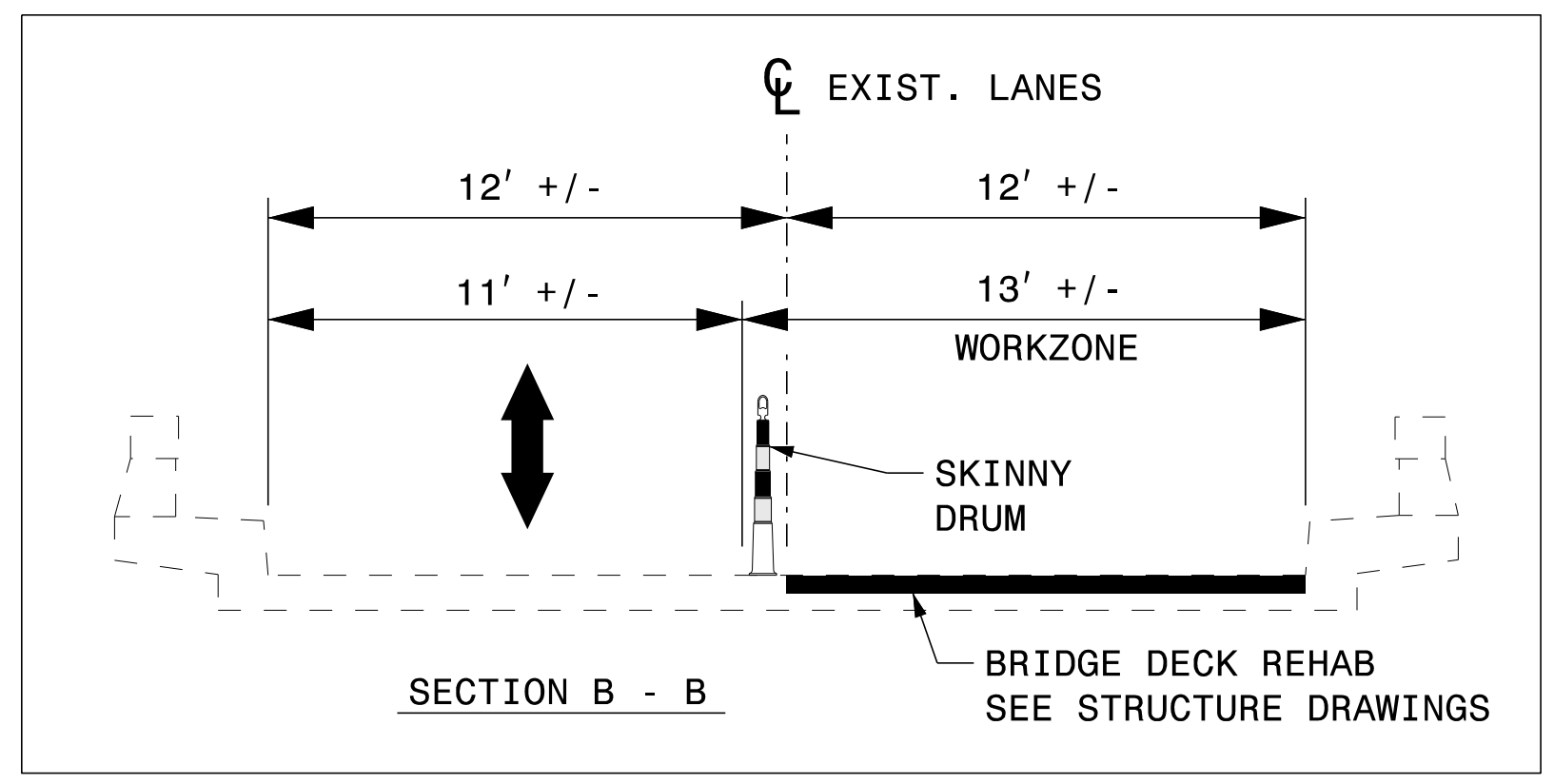
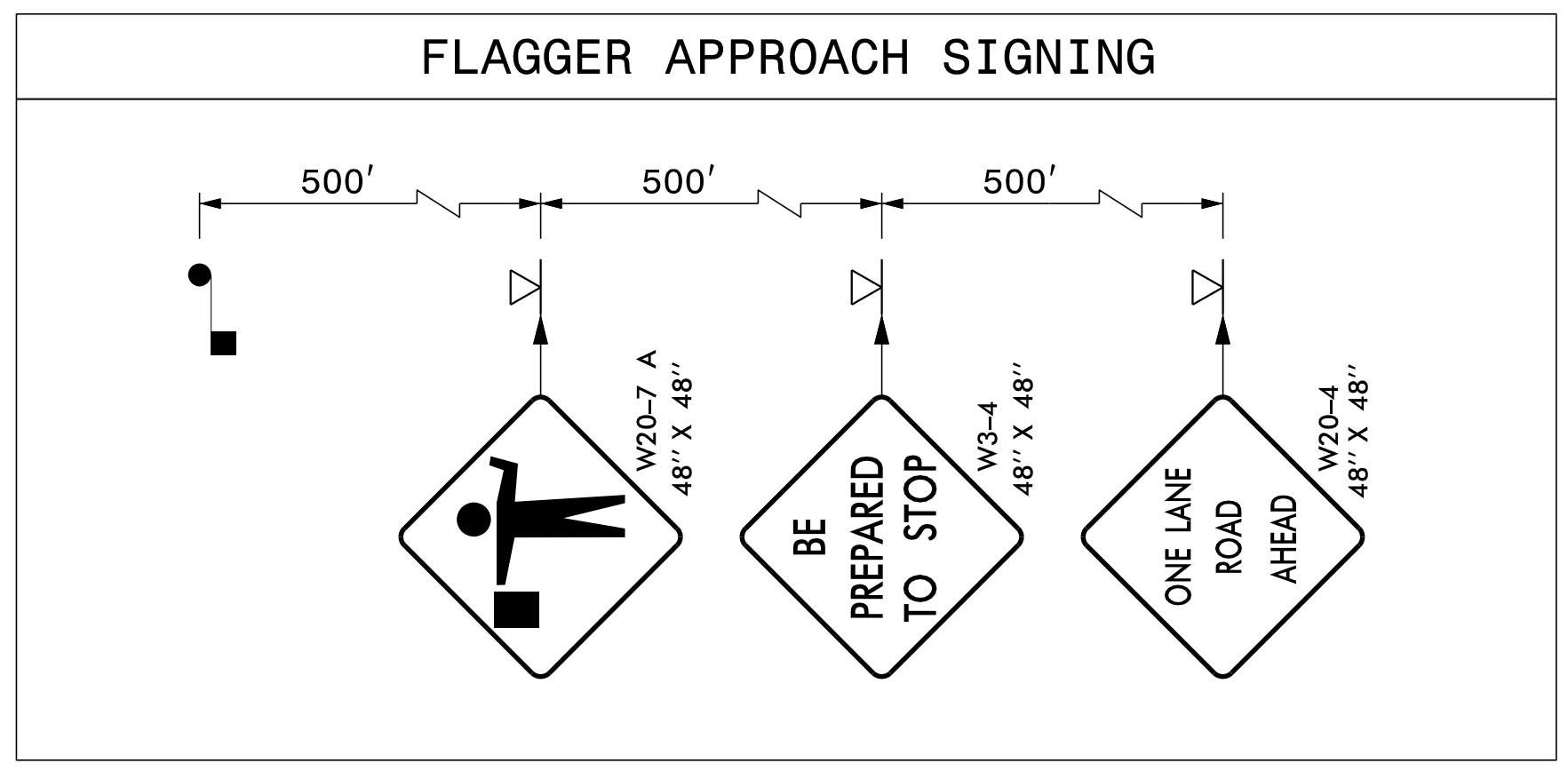

NOTE: ALL ROADWAYS HAVE 55 MPH (STATUTORY) SPEED LIMIT. FIELD ADJUST SIGN SPACING AS NECESSARY BASED ON APPROACH ROADWAY CONDITIONS.

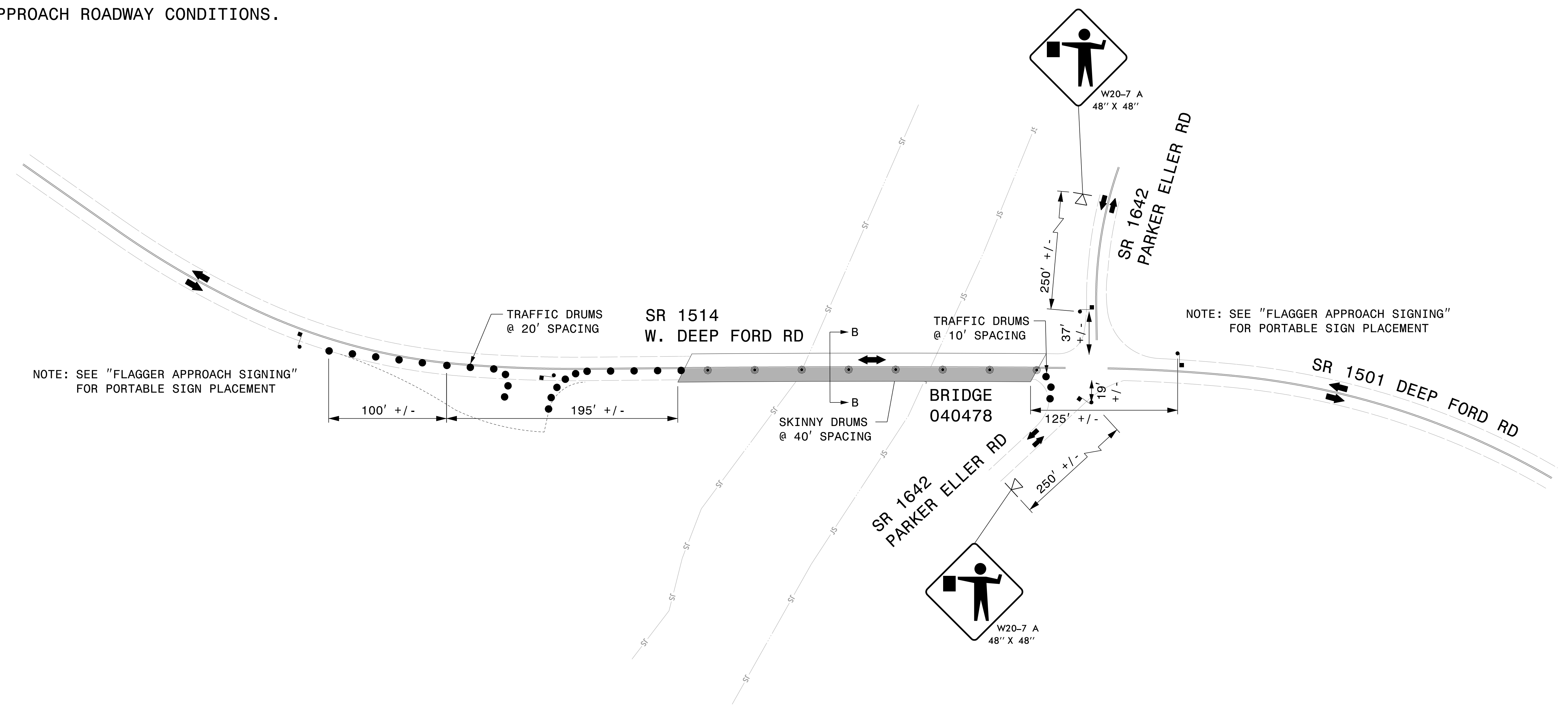

12/19/2024 pw:\gfn\pw.bentley.com\gfn\pw-01\Documents\Projects\63639\5-Working\Task 017 - 15BPR.133.3 - Ashe\TrafficControl\15BPR.133.3_TC_TMP09.dgn User:bwht



APPROVED: *Benjamin A. White*
 DATE: 12/19/2024
 SEAL
 DOCUMENT NOT CONSIDERED FINAL UNLESS ALL SIGNATURES COMPLETED



BRIDGE 040478
 PHASE 2 DETAIL

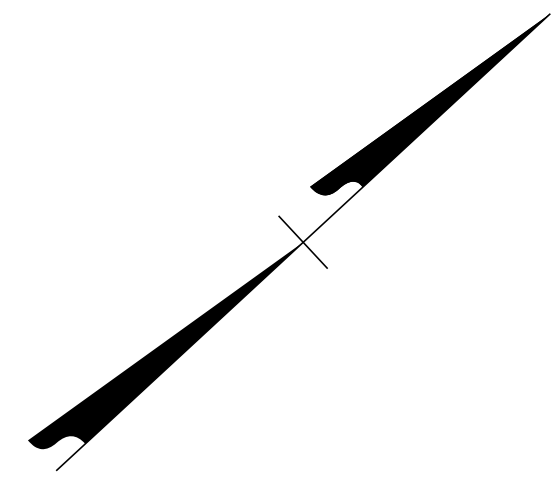
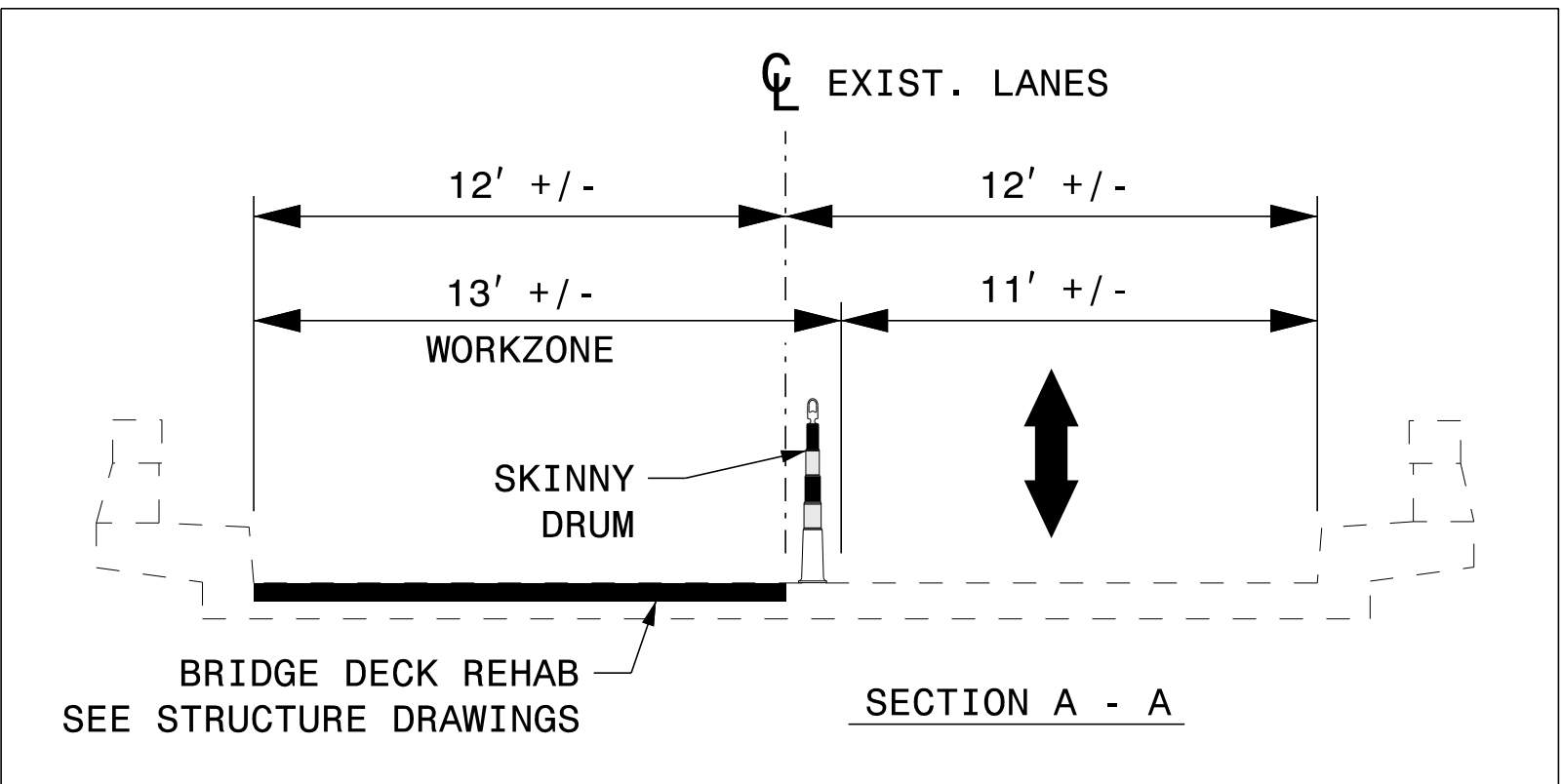
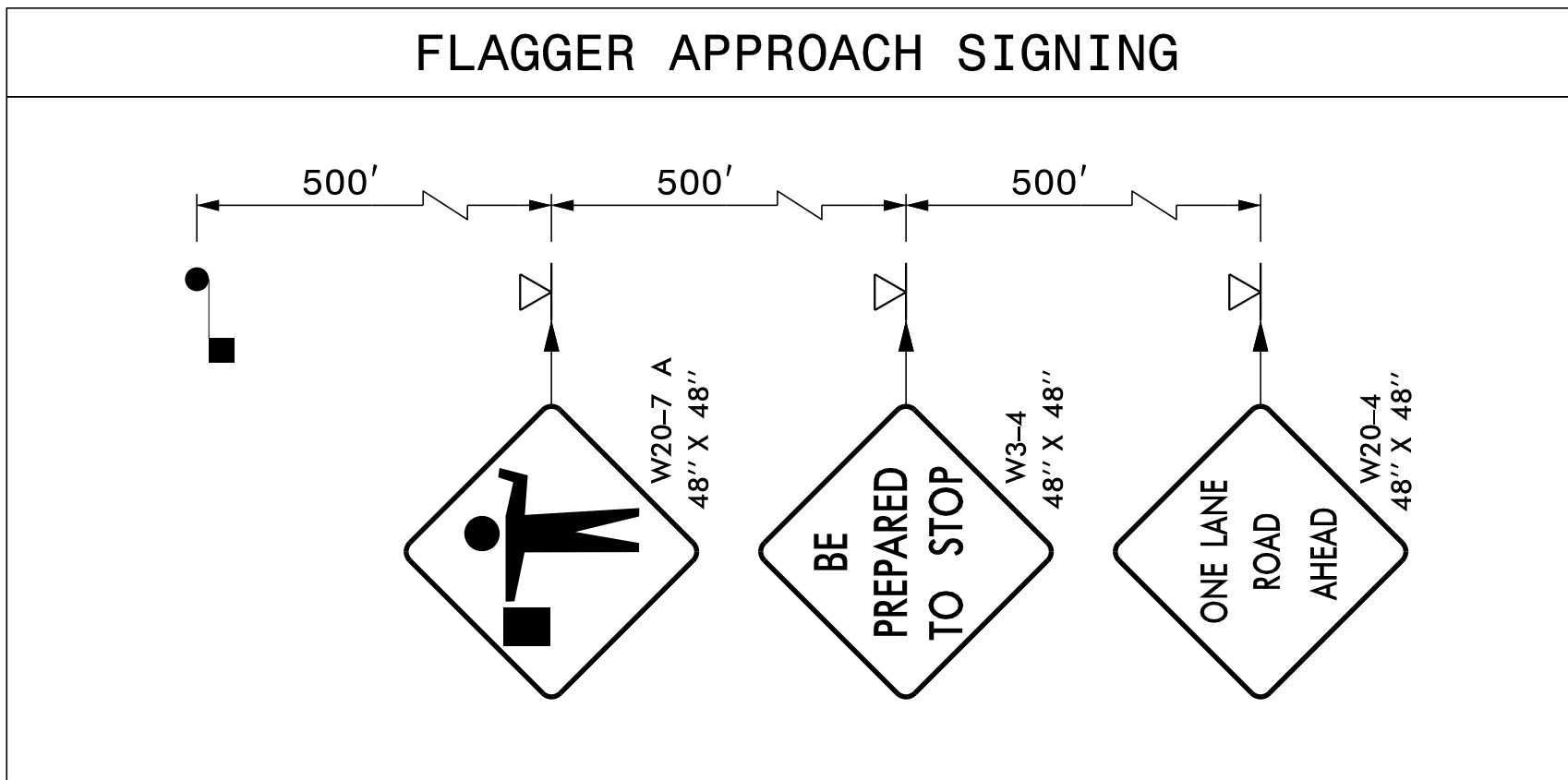

NOTE: ALL ROADWAYS HAVE 55 MPH (STATUTORY) SPEED LIMIT. FIELD ADJUST SIGN SPACING AS NECESSARY BASED ON APPROACH ROADWAY CONDITIONS.

PROVIDE TASK LIGHTING AT EACH FLAGGER LOCATION.

NOTE: SEE "FLAGGER APPROACH SIGNING" FOR PORTABLE SIGN PLACEMENT

PROVIDE TASK LIGHTING AT EACH FLAGGER LOCATION

NOTE: SEE "FLAGGER APPROACH SIGNING" FOR PORTABLE SIGN PLACEMENT

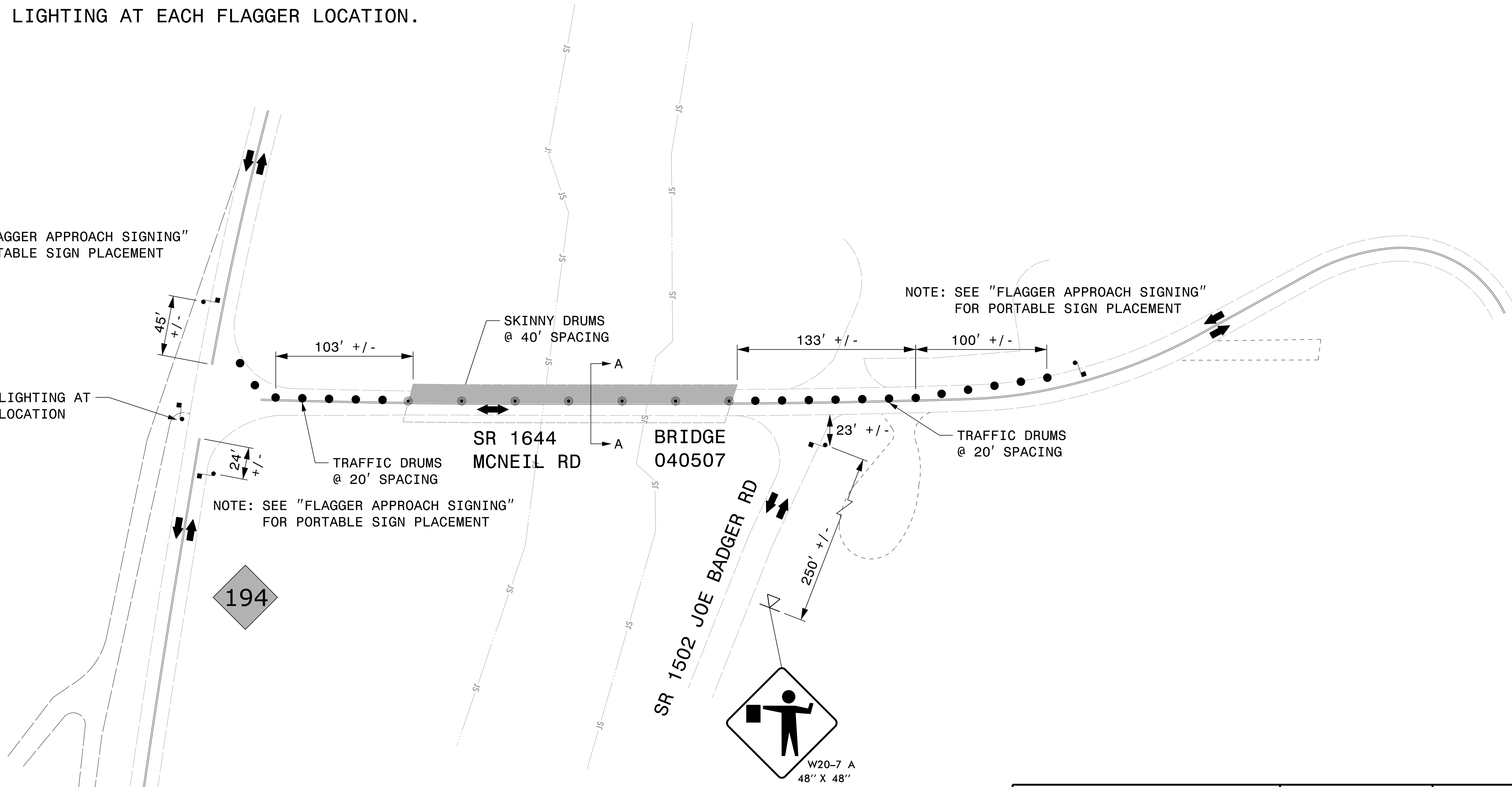

12/19/2024 pw:\gfn\pw.bentley.com\gfn\pw-0\Documents\Projects\63639\5-Working\Task 017 - 15BPR.133.3 - Ashe\TrafficControl\15BPR.133.3_TC_TMP10.dgn User:bwht



APPROVED: *Benjamin A. White*
 DATE: 12/19/2024
 SEAL
 DOCUMENT NOT CONSIDERED FINAL UNLESS ALL SIGNATURES COMPLETED

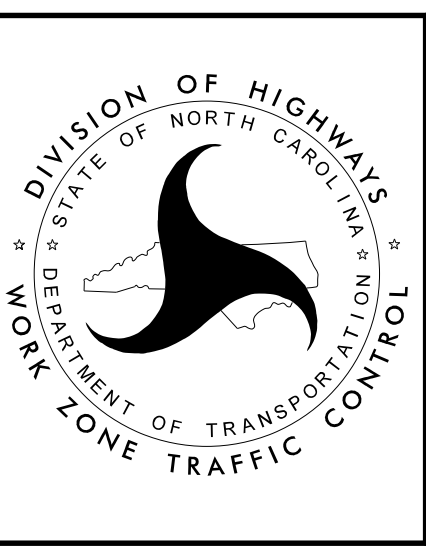

BRIDGE 040507
 PHASE 1 DETAIL

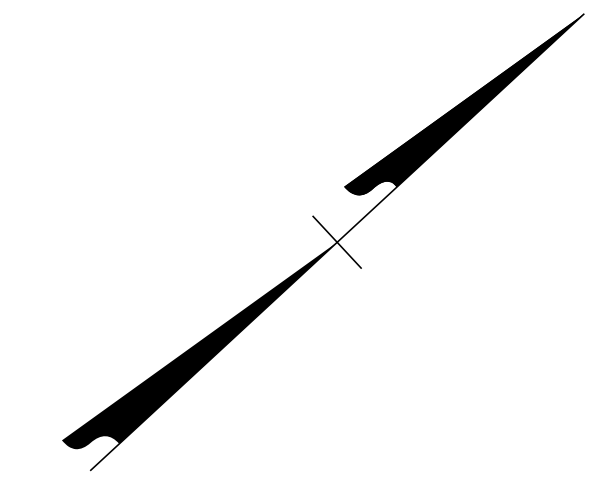
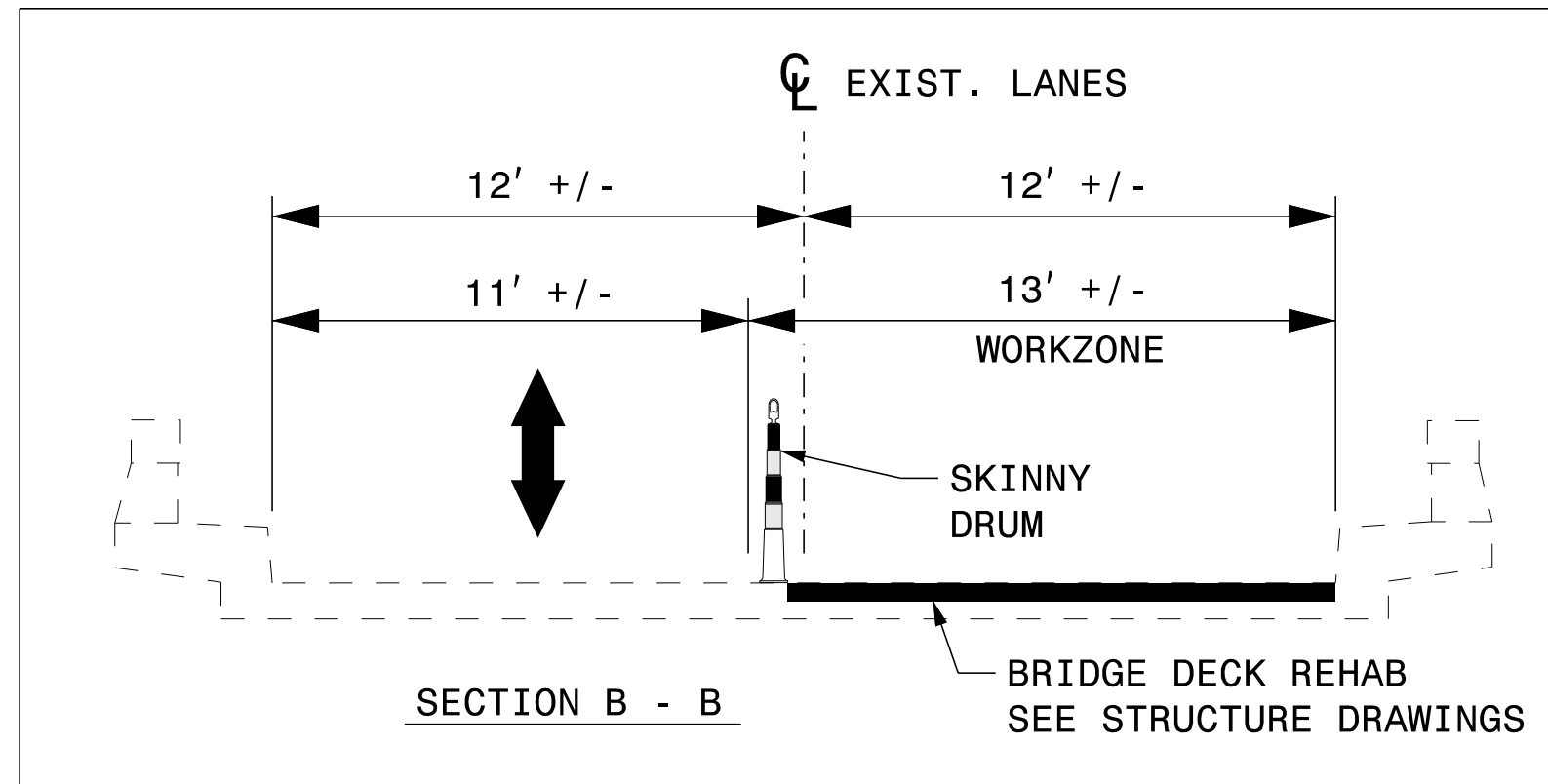
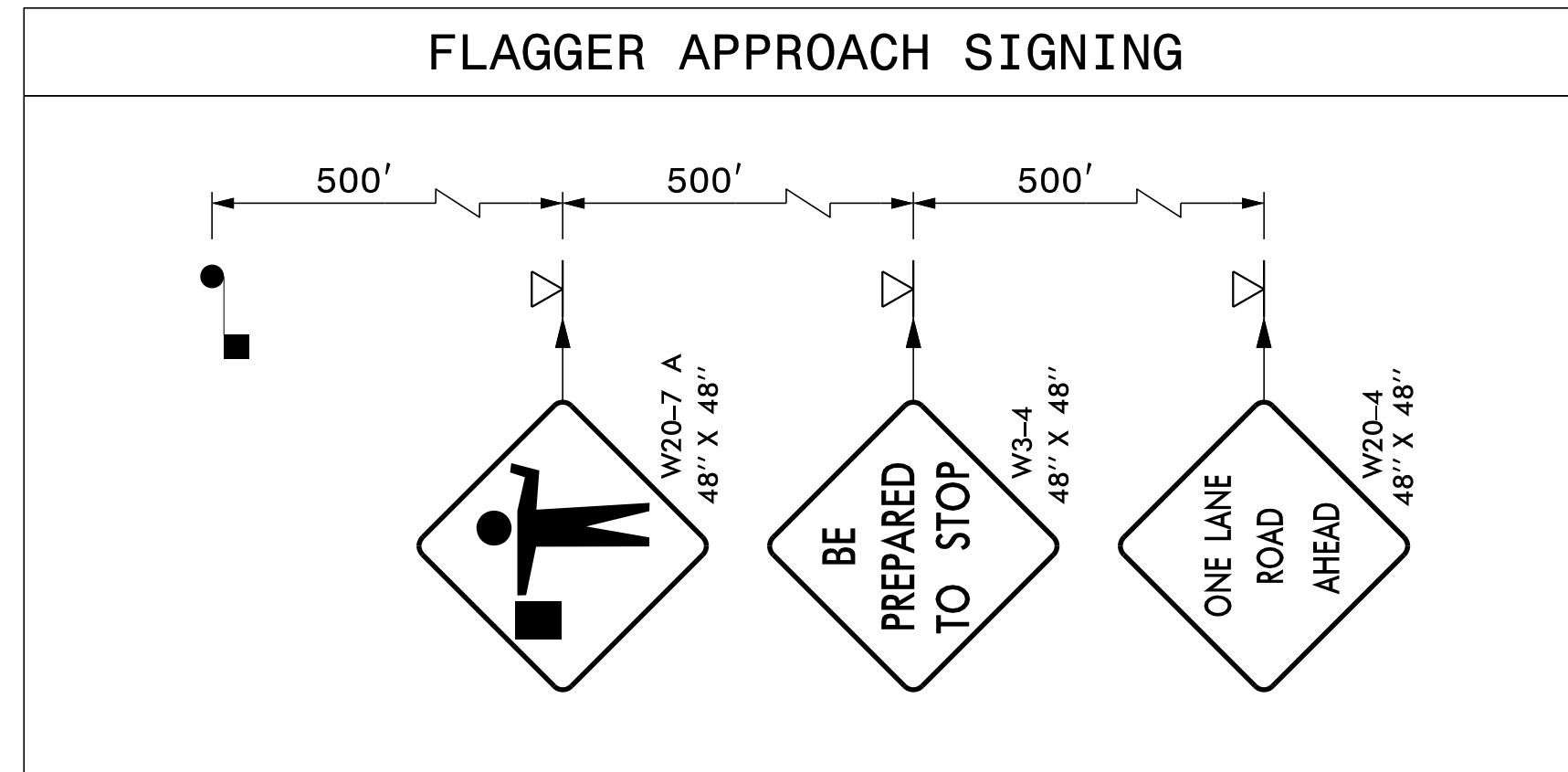

NOTE: ALL ROADWAYS HAVE 55 MPH (STATUTORY) SPEED LIMIT.
FIELD ADJUST SIGN SPACING AS NECESSARY BASED ON
APPROACH ROADWAY CONDITIONS.

PROVIDE TASK LIGHTING AT EACH FLAGGER LOCATION.

NOTE: SEE "FLAGGER APPROACH SIGNING"
FOR PORTABLE SIGN PLACEMENT

PROVIDE TASK LIGHTING AT
EACH FLAGGER LOCATION

NOTE: SEE "FLAGGER APPROACH SIGNING"
FOR PORTABLE SIGN PLACEMENT

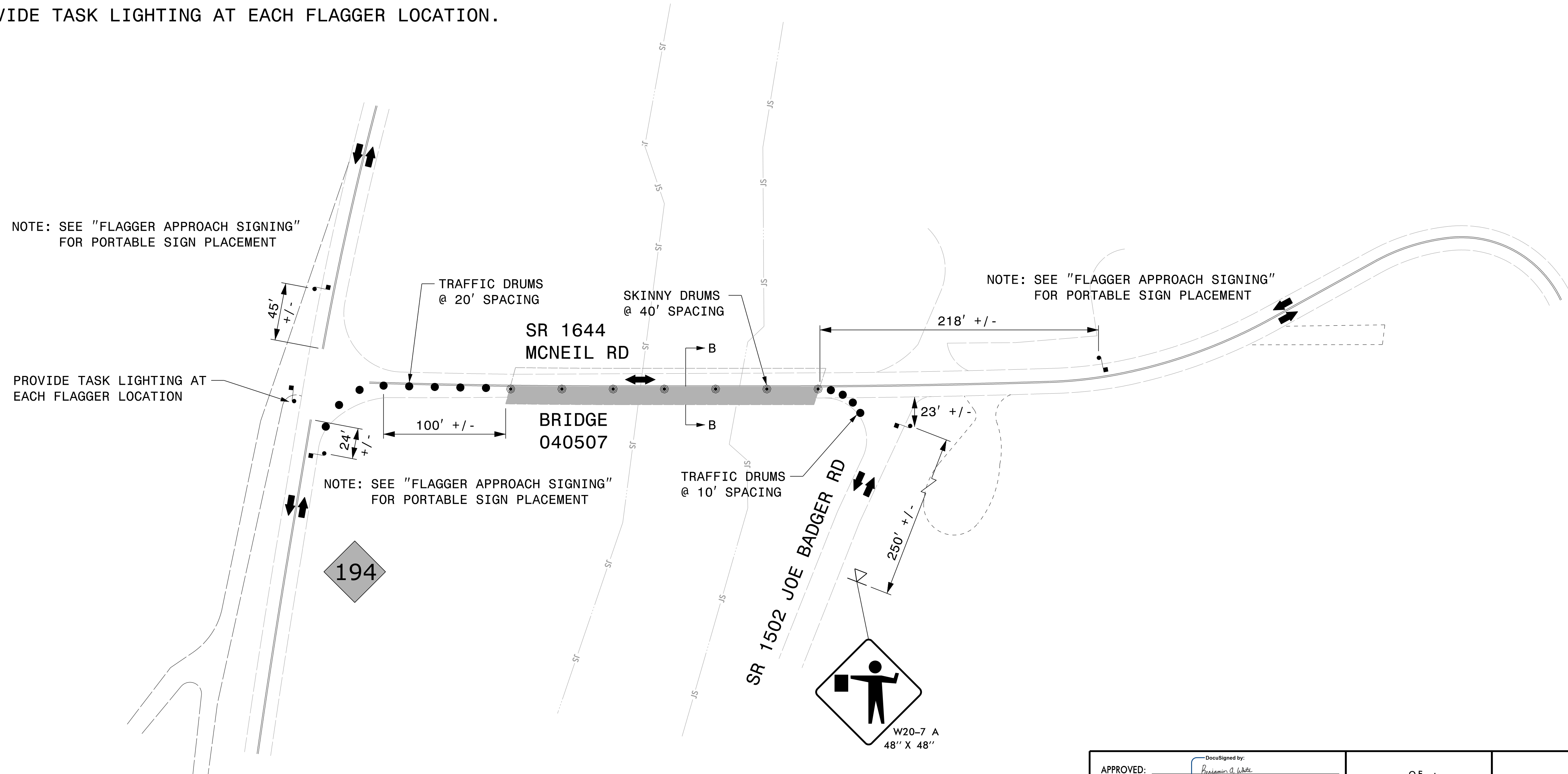

12/19/2024
pw:\gfn\pw.bentley.com\gfn\pw-01\Documents\Projects\63639\5-Working\Task 017 - 15BPR.133.3 - Ashe\TrafficControl\15BPR.133.3_TC_TMP\ldgm
User:bwht



APPROVED: *Benjamin A. White*
DATE: 12/19/2024

SEAL

DOCUMENT NOT CONSIDERED FINAL
UNLESS ALL SIGNATURES COMPLETED

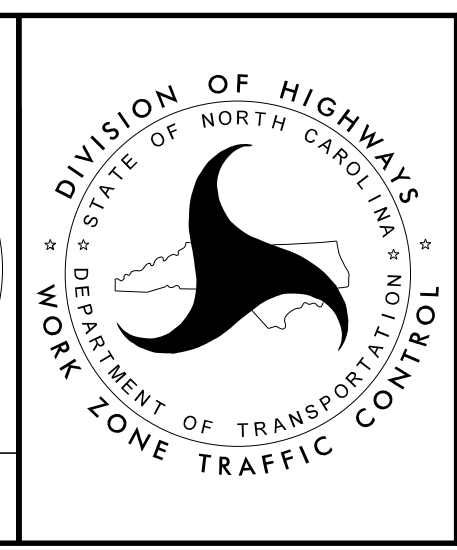

DIVISION OF HIGHWAYS
STATE OF NORTH CAROLINA
DEPARTMENT OF TRANSPORTATION
WORK ZONE TRAFFIC CONTROL

BRIDGE 040507
PHASE 2 DETAIL