

STATE OF NORTH CAROLINA  
DIVISION OF HIGHWAYS

**TRANSPORTATION MANAGEMENT PLAN**

**ALAMANCE COUNTY**  
LOCATION: US 70 (SOUTH CHURCH ST) AT SR 1158  
(HUFFMAN MILL RD) IN BURLINGTON

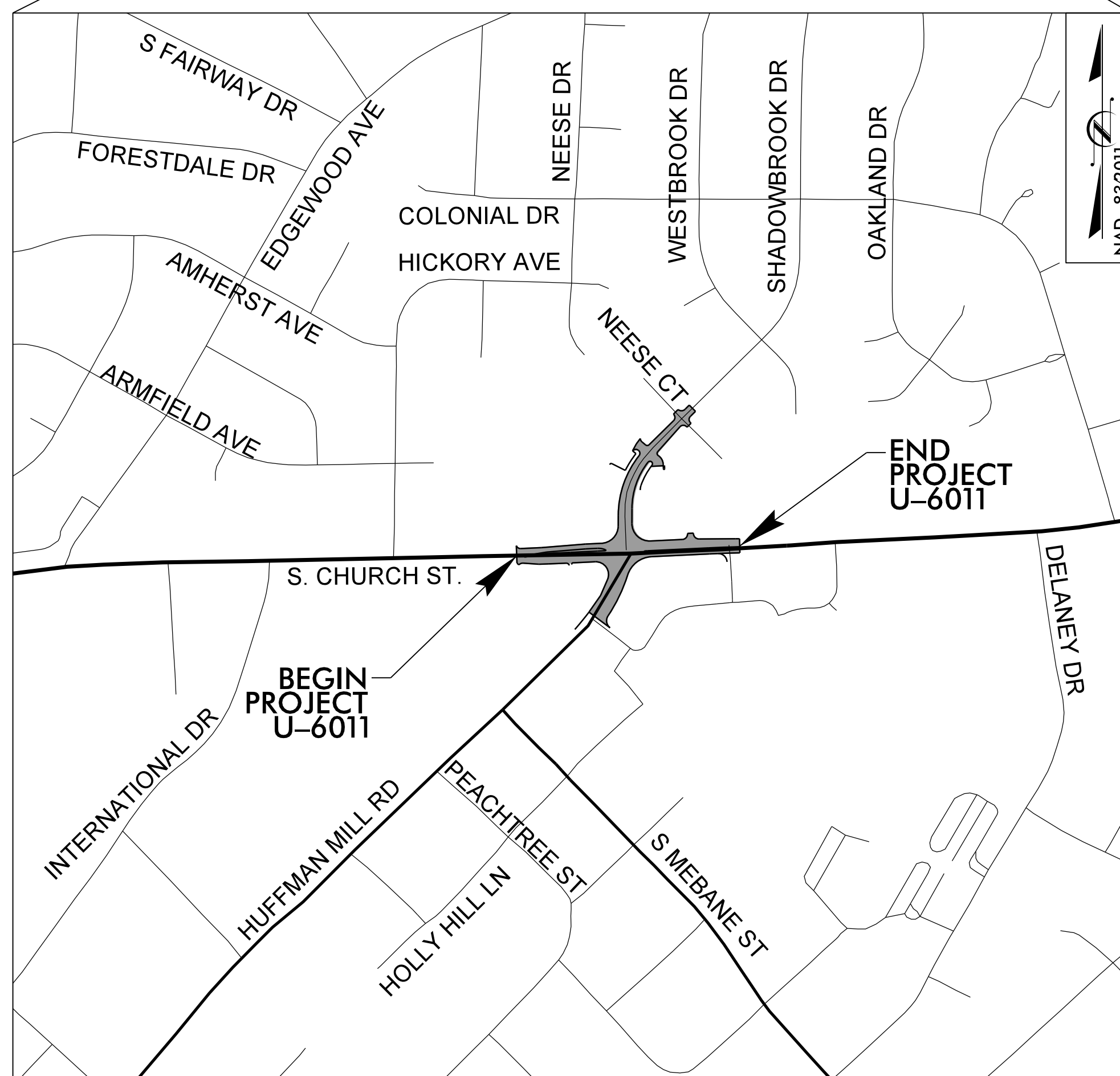
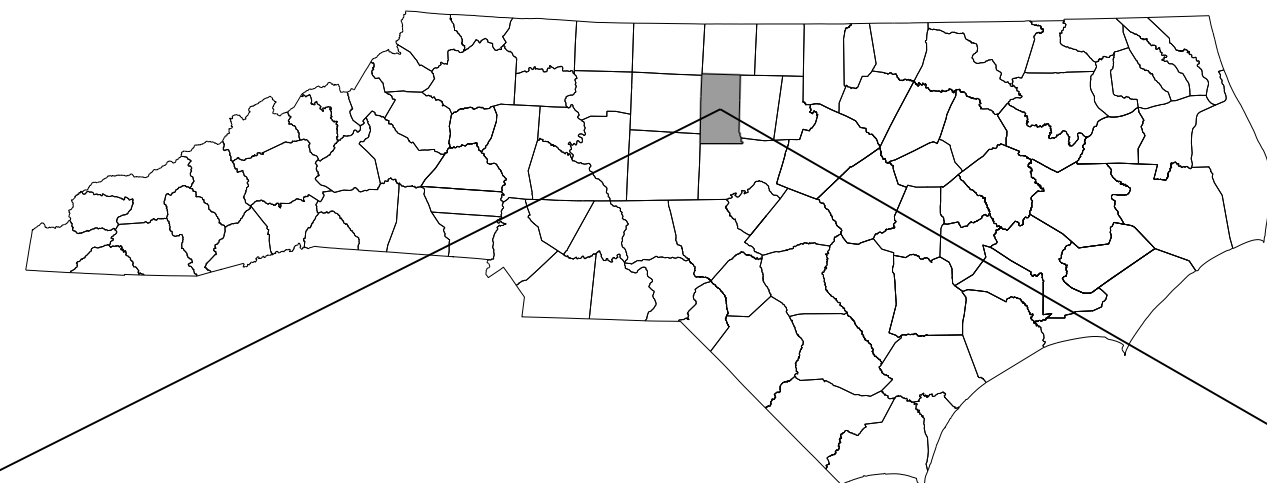

**INDEX OF SHEETS**

SHEET NO.	TITLE
TMP-1	TITLE SHEET, VICINITY MAP AND INDEX OF SHEETS
TMP-1A	LIST OF APPLICABLE ROADWAY STANDARD DRAWINGS AND LEGEND
TMP-1B	GENERAL NOTES
TMP-2	TRAFFIC CONTROL PHASING
TMP-3 & TMP-4	PHASE IA DETAILS
TMP-5 & TMP-6	PHASE IB DETAILS
TMP-7 & TMP-8	PHASE II DETAILS
TMP-9 & TMP-10	PHASE III DETAILS

SHEET NO.  
TMP-1

**U-6011**

**TIP PROJECT:**

DOCUMENT NOT CONSIDERED FINAL  
UNLESS ALL SIGNATURES COMPLETED

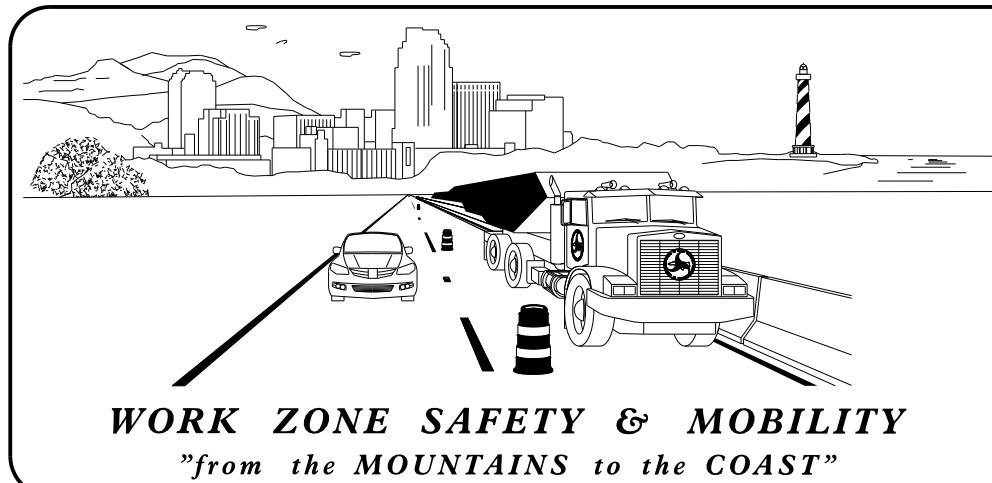

PLANS PREPARED BY:

AYMAN I. ALQUDWAH, P.E.  
PROJECT ENGINEER

DAVID GARRETT  
PROJECT DESIGN ENGINEER

NCDOT CONTACT:

CHRIS SMITHERMAN, P.E.



PLANS PREPARED BY:  
**PARSONS**  
5540 CENTERVIEW DR., SUITE 217  
RALEIGH, NORTH CAROLINA 27606  
NC LICENSE NO: F-0246  
FOR NORTH CAROLINA DEPT. OF TRANSPORTATION

APPROVED: \_\_\_\_\_  
DATE: 1/16/2025

SEAL

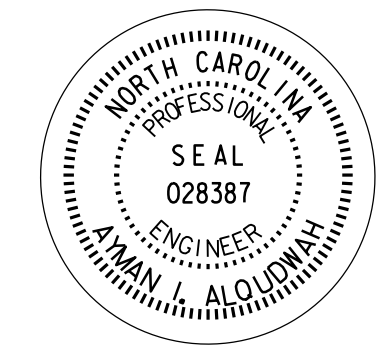

# ROADWAY STANDARD DRAWINGS

THE FOLLOWING ROADWAY STANDARDS AS APPEAR IN "ROADWAY STANDARD DRAWINGS" CONTRACTS STANDARDS AND DEVELOPMENT UNIT - N. C. DEPARTMENT OF TRANSPORTATION- RALEIGH, N. C., DATED JANUARY 16, 2024 ARE APPLICABLE TO THIS PROJECT AND BY REFERENCE HEREBY ARE CONSIDERED A PART OF THESE PLANS:

STD. NO.	TITLE
1101.01	WORK ZONE ADVANCE WARNING SIGNS
1101.02	TEMPORARY LANE CLOSURES
1101.04	TEMPORARY SHOULDER CLOSURES
1101.11	TRAFFIC CONTROL DESIGN TABLES
1110.01	STATIONARY WORK ZONE SIGNS
1110.02	PORTABLE WORK ZONE SIGNS
1115.01	FLASHING ARROW BOARDS
1130.01	DRUMS
1145.01	BARRICADES - TYPE III
1150.01	FLAGGERS
1165.01	TRUCK MOUNTED ATTENUATOR
1205.01	PAVEMENT MARKINGS - LINE TYPES AND OFFSETS
1205.02	PAVEMENT MARKINGS - TWO-LANE AND MULTI-LANE ROADWAYS
1205.04	PAVEMENT MARKINGS - INTERSECTIONS
1205.05	PAVEMENT MARKINGS - TURN LANES
1205.06	PAVEMENT MARKINGS - LANE DROPS
1205.07	PAVEMENT MARKINGS - PEDESTRIAN CROSSWALKS
1205.08	PAVEMENT MARKINGS - SYMBOLS AND WORD MESSAGES
1205.09	PAVEMENT MARKINGS - PAINTED ISLANDS
1250.01	RAISED PAVEMENT MARKERS - INSTALLATION SPACING
1251.01	RAISED PAVEMENT MARKERS - PERMANENT AND TEMPORARY
1261.01	GUARDRAIL AND BARRIER DELINEATORS - INSTALLATION SPACING
1261.02	GUARDRAIL AND BARRIER DELINEATORS - TYPES AND MOUNTING
1262.01	GUARDRAIL END DELINEATION

## LEGEND

### GENERAL

- DIRECTION OF TRAFFIC FLOW
- DIRECTION OF PEDESTRIAN TRAFFIC FLOW
- EXIST. PVMT.
- NORTH ARROW
- PROPOSED PVMT.

WORK AREA

REMOVAL

### SIGNALS

- EXISTING
- PROPOSED
- TEMP

### PAVEMENT MARKINGS

- EXISTING LINES
- TEMPORARY LINES

### TRAFFIC CONTROL DEVICES

- BARRICADE (TYPE III)
- DRUM
- PEDESTRIAN BARRICADE

### TEMPORARY SIGNING

- PORTABLE SIGN
- STATIONARY SIGN
- STATIONARY OR PORTABLE SIGN

### PAVEMENT MARKERS

- CRYSTAL / CRYSTAL
- CRYSTAL / RED
- YELLOW / YELLOW

### PAVEMENT MARKING SYMBOLS

- PAVEMENT MARKING SYMBOLS

### TEMPORARY PAVEMENT MARKING

SYMBOL	DESCRIPTION	PAY ITEM
<u>PAVEMENT MARKING LINES</u>		
P2	WHITE SOLID LANE LINE	PAINT (4")
P3	10 FT WHITE SKIP	
P4	3 FT - 9 FT/SP WHITE MINISKIP	
P5	2 FT 6 FT/ SP WHITE MINISKIP	
P10	YELLOW EDGE LINE	
P13	DOUBLE YELLOW	PAINT (8")
P14	2 FT 6 FT/ SP YELLOW MINISKIP	
P40	WHITE GORE LINE	
P41	WHITE DIAGONAL	
P42	YELLOW DIAGONAL	
P43	WHITE SOLID LANE LINE	
P44	3 FT 9 FT/SP WHITE MINISKIP	PAINT (24")
P46	WHITE CROSSWALK LINE	
P61	WHITE STOPBAR	PAINT CHARACTER
<u>PAVEMENT MARKING CHARACTERS</u>		
P100	ALPHANUMERIC CHARACTER	PAINT SYMBOL
<u>PAVEMENT MARKING SYMBOLS</u>		
P70	LEFT TURN ARROW	
P71	RIGHT TURN ARROW	
P72	STRAIGHT ARROW	
P74	COMBO. RIGHT/STRAIGHT ARROW	
P103	24" YIELD LINE TRIANGLE	

NOTE: FOR EACH PAINT PAVEMENT MARKING ITEM, REFER TO GENERAL NOTE (R) FOR NUMBER OF APPLICATIONS.

7/2/99  
24-JAN-2025 13:12  
J:\U-6011\TrafficControl\TrafficControl\TCP\U-6011\_TC\_TMP\_01A.dgn  
\$\$\$\$\$USERNAME\$\$\$\$\$

PLANS PREPARED BY  
**PARSONS**  
5540 CENTERVIEW DRIVE, SUITE 301  
RALEIGH, NORTH CAROLINA 27606  
NC LICENSE NO. P-12046  
FOR NORTH CAROLINA DEPT. OF TRANSPORTATION

APPROVED:   
DATE: 1/24/2025  
SEAL

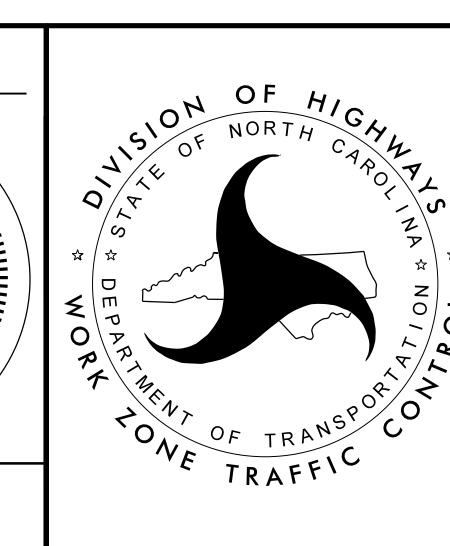

ROADWAY STANDARD DRAWINGS & LEGEND

DOCUMENT NOT CONSIDERED FINAL UNLESS ALL SIGNATURES COMPLETED

## GENERAL NOTES

CHANGES MAY BE REQUIRED WHEN PHYSICAL DIMENSIONS IN THE DETAIL DRAWINGS, STANDARD DETAILS, AND ROADWAY DETAILS ARE NOT ATTAINABLE TO MEET FIELD CONDITIONS OR RESULT IN DUPLICATE OR UNDESIRE OVERLAPPING OF DEVICES. MODIFICATION MAY INCLUDE: MOVING, SUPPLEMENTING, COVERING, OR REMOVAL OF DEVICES AS DIRECTED BY THE ENGINEER.

THE FOLLOWING GENERAL NOTES APPLY AT ALL TIMES FOR THE DURATION OF THE CONSTRUCTION PROJECT EXCEPT WHEN OTHERWISE NOTED IN THE PLAN OR DIRECTED BY THE ENGINEER.

### TIME RESTRICTIONS

A) DO NOT CLOSE LANES AS FOLLOWS:

ROAD NAME	DAY AND TIME RESTRICTIONS
S CHURCH STREET (-L-)	MONDAY-THURSDAY 7:00AM to 7:00PM
SHADOWBROOK DRIVE (-Y1-)	FRIDAY 7:00AM to 8:00PM
HUFFMAN MILL DRIVE (-Y1-)	SATURDAY 11:00AM to 7:00PM
	SUNDAY 11:00AM to 7:00PM

B) DO NOT CLOSE OR NARROW TRAVEL LANES DURING HOLIDAYS AND SPECIAL EVENTS AS FOLLOWS:

ROAD NAME
S CHURCH STREET (-L-)
SHADOWBROOK DRIVE (-Y1-)
HUFFMAN MILL DRIVE (-Y1-)

HOLIDAY

- FOR ANY UNEXPECTED OCCURRENCE THAT CREATES UNUSUALLY HIGH TRAFFIC VOLUMES, AS DIRECTED BY THE ENGINEER.
- FOR NEW YEAR'S, BETWEEN THE HOURS OF 6:00 A.M. DECEMBER 31st TO 8:00 P.M. JANUARY 2ND. IF NEW YEAR'S DAY IS ON A FRIDAY, SATURDAY, SUNDAY OR MONDAY, THEN UNTIL 8:00 P.M. THE FOLLOWING TUESDAY.
- FOR EASTER, BETWEEN THE HOURS OF 6:00 A.M. THURSDAY AND 8:00 P.M. MONDAY.
- FOR MEMORIAL DAY, BETWEEN THE HOURS OF 6:00 A.M. FRIDAY TO 8:00 P.M. TUESDAY.
- FOR INDEPENDENCE DAY, BETWEEN THE HOURS OF 6:00 A.M. THE DAY BEFORE INDEPENDENCE DAY AND 8:00 P.M. THE DAY AFTER INDEPENDENCE DAY. IF INDEPENDENCE DAY IS ON A FRIDAY, SATURDAY, SUNDAY OR MONDAY, THEN BETWEEN THE HOURS OF 6:00 A.M. THE THURSDAY BEFORE INDEPENDENCE DAY AND 8:00 P.M. THE TUESDAY AFTER INDEPENDENCE DAY.
- FOR LABOR DAY, BETWEEN THE HOURS OF 6:00 A.M. FRIDAY AND 8:00 P.M. TUESDAY.
- FOR THANKSGIVING DAY, BETWEEN THE HOURS OF 6:00 A.M. TUESDAY TO 8:00 P.M. MONDAY.
- FOR CHRISTMAS, BETWEEN THE HOURS OF 6:00 A.M. THE FRIDAY BEFORE THE WEEK OF CHRISTMAS DAY AND 8:00 P.M. THE FOLLOWING TUESDAY AFTER THE WEEK OF CHRISTMAS.

C) DO NOT CONDUCT ANY HAULING OPERATIONS AGAINST THE FLOW OF TRAFFIC OF AN OPEN TRAVELWAY UNLESS THE HAULING OPERATION IS PROTECTED BY BARRIER OR GUARDRAIL OR AS DIRECTED BY THE ENGINEER.

### LANE AND SHOULDER CLOSURE REQUIREMENTS

- D) REMOVE LANE CLOSURE DEVICES FROM THE LANE WHEN WORK IS NOT BEING PERFORMED BEHIND THE LANE CLOSURE OR WHEN A LANE CLOSURE IS NO LONGER NEEDED OR AS DIRECTED BY THE ENGINEER.
- E) WHEN PERSONNEL AND/OR EQUIPMENT ARE WORKING WITHIN 15 FT OF AN OPEN TRAVEL LANE, CLOSE THE NEAREST OPEN SHOULDER USING ROADWAY STANDARD DRAWING NO. 1101.04 UNLESS THE WORK AREA IS PROTECTED BY BARRIER OR GUARDRAIL OR A LANE CLOSURE IS INSTALLED.
- F) WHEN PERSONNEL AND/OR EQUIPMENT ARE WORKING ON THE SHOULDER ADJACENT TO AN UNDIVIDED FACILITY AND WITHIN 5 FT OF AN OPEN TRAVEL LANE, CLOSE THE NEAREST OPEN TRAVEL LANE USING ROADWAY STANDARD DRAWING NO. 1101.02 UNLESS THE WORK AREA IS PROTECTED BY BARRIER OR GUARDRAIL.
- G) WHEN PERSONNEL AND/OR EQUIPMENT ARE WORKING ON THE SHOULDER ADJACENT TO A DIVIDED FACILITY AND WITHIN 10 FT OF AN OPEN TRAVEL LANE, CLOSE THE NEAREST OPEN TRAVEL LANE USING ROADWAY STANDARD DRAWING NO. 1101.02 UNLESS THE WORK AREA IS PROTECTED BY BARRIER OR GUARDRAIL.
- H) DO NOT WORK SIMULTANEOUSLY WITHIN 15 FT ON BOTH SIDES OF AN OPEN TRAVELWAY, RAMP, OR LOOP WITHIN THE SAME LOCATION UNLESS PROTECTED WITH GUARDRAIL OR BARRIER.

### PAVEMENT EDGE DROP OFF REQUIREMENTS

- I) BACKFILL AT A 6:1 SLOPE UP TO THE EDGE AND ELEVATION OF EXISTING PAVEMENT IN AREAS ADJACENT TO AN OPENED TRAVEL LANE THAT HAS AN EDGE OF PAVEMENT DROP-OFF AS FOLLOWS:  
  
BACKFILL DROP-OFFS THAT EXCEED 2 INCHES ON ROADWAYS WITH POSTED SPEED LIMITS OF 45 MPH OR GREATER.  
  
BACKFILL DROP-OFFS THAT EXCEED 3 INCHES ON ROADWAYS WITH POSTED SPEED LIMITS LESS THAN 45 MPH.  
  
BACKFILL WITH SUITABLE COMPACTED MATERIAL, AS APPROVED BY THE ENGINEER, AT NO EXPENSE TO THE DEPARTMENT.
- J) DO NOT EXCEED A DIFFERENCE OF 2 INCHES IN ELEVATION BETWEEN OPEN LANES OF TRAFFIC FOR NOMINAL LIFTS OF 1.5 INCHES. INSTALL ADVANCE WARNING "UNEVEN LANES" SIGNS (W8-11) 350 FT IN ADVANCE AND A MINIMUM OF EVERY HALF MILE THROUGHOUT THE UNEVEN AREA.

### TRAFFIC PATTERN ALTERATIONS

- K) NOTIFY THE ENGINEER TWENTY ONE (21) CALENDAR DAYS PRIOR TO ANY TRAFFIC PATTERN ALTERATION.

### SIGNING

- L) INSTALL ADVANCE WORK ZONE WARNING SIGNS WHEN WORK IS WITHIN 40 FT FROM THE EDGE OF TRAVEL LANE AND NO MORE THAN THREE (3) DAYS PRIOR TO THE BEGINNING OF CONSTRUCTION.
- M) ENSURE ALL NECESSARY SIGNING IS IN PLACE PRIOR TO ALTERING ANY TRAFFIC PATTERN.
- N) INSTALL BLACK ON ORANGE "DIP" SIGNS (W8-2) AND/OR "BUMP" SIGNS (W8-1) 350 ft IN ADVANCE OF THE UNEVEN AREA, OR AS DIRECTED BY THE ENGINEER.

### TRAFFIC CONTROL DEVICES

- O) WHEN LANE CLOSURES ARE NOT IN EFFECT SPACE CHANNELIZING DEVICES IN WORK AREAS NO GREATER IN FEET THAN TWICE THE POSTED SPEED LIMIT (MPH) EXCEPT, 10 FT ON-CENTER IN RADII, AND 3 FT OFF THE EDGE OF AN OPEN TRAVELWAY. REFER TO STANDARD SPECIFICATIONS FOR ROADS AND STRUCTURES SECTIONS 1130 (DRUMS), 1135 (CONES) AND 1180 (SKINNY DRUMS) FOR ADDITIONAL REQUIREMENTS.
- P) PLACE ADDITIONAL SETS OF THREE CHANNELIZING DEVICES (DRUMS) PERPENDICULAR TO THE EDGE OF TRAVELWAY ON 500 FT CENTERS WHEN UNOPENED LANES ARE CLOSED TO TRAFFIC.

### PAVEMENT MARKINGS AND MARKERS

- Q) INSTALL TEMPORARY PAVEMENT MARKINGS AND TEMPORARY PAVEMENT MARKERS ON INTERIM LAYERS OF PAVEMENT AS FOLLOWS:
- | ROAD NAME | MARKING | MARKER    |
|-----------|---------|-----------|
| ALL ROADS | PAINT   | TEMPORARY |
- R) PLACE ONE APPLICATION OF PAINT FOR TEMPORARY TRAFFIC PATTERNS. PLACE A SECOND APPLICATION OF PAINT SIX (6) MONTHS AFTER THE INITIAL APPLICATION AND EVERY SIX MONTHS AS DIRECTED BY THE ENGINEER.

- S) TIE PROPOSED PAVEMENT MARKING LINES TO EXISTING PAVEMENT MARKING LINES.
- T) REMOVE/REPLACE ANY CONFLICTING/DAMAGED PAVEMENT MARKINGS AND MARKERS BY THE END OF EACH DAY'S OPERATION.
- U) ALL CURB RAMP LOCATIONS SHALL BE DERIVED FROM STATIONING SHOWN ON PAVEMENT MARKING PLANS OR AS DIRECTED BY THE ENGINEER IN COORDINATION WITH THE SIGNING AND DELINEATION UNIT.
- V) CONTRACTOR SHALL MAINTAIN SIDEWALK ACCESS AT ALL TIMES AS STATED IN THE PHASING. CONTRACTOR SHALL BE RESPONSIBLE TO PROVIDE TEMPORARY SIDEWALKS (CONCRETE, ASPHALT, OR OTHER SUITABLE MATERIAL AS APPROVED BY THE ENGINEER) AT ALL LOCATIONS WHERE THE OPEN PEDESTRIAN TRAVELWAY HAS BEEN REMOVED FOR CONSTRUCTION OPERATIONS (UTILITIES, DRAINAGE, ETC.).

### MISCELLANEOUS

- W) REPLACE MARKINGS AND RETURN TRAFFIC TO THE CURRENT TRAFFIC PATTERN AT THE END OF EACH WORK PERIOD UNLESS OTHERWISE NOTED IN THE PHASING OR DIRECTED BY THE ENGINEER.
- X) COMPLETE ANY PROPOSED WIDENING IN SUCH A MANNER THAT PONDING OF WATER WILL NOT OCCUR IN THE TRAVEL LANE.
- Y) MAINTAIN VEHICULAR ACCESS TO ALL RESIDENCES AND BUSINESSES DURING THE LIFE OF THE CONTRACT UNLESS OTHERWISE NOTED IN THE PHASING OR DIRECTED BY THE ENGINEER.
- Z) WEDGING OPERATIONS SHOULD BE DONE IN SUCH A MANNER THAT SMOOTH TRANSITIONS ARE PROVIDED AT THE END OF EACH DAY BETWEEN TRAVEL LANES AND AT TIE-INS WITH EXISTING PAVEMENT.

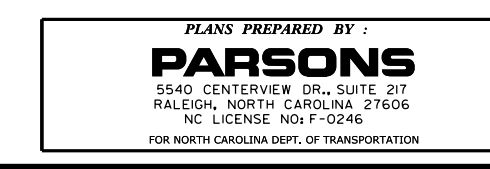

APPROVED: *Dyann M. Hurd*  
DATE: 2/25/2025

SEAL

DOCUMENT NOT CONSIDERED FINAL UNLESS ALL SIGNATURES COMPLETED

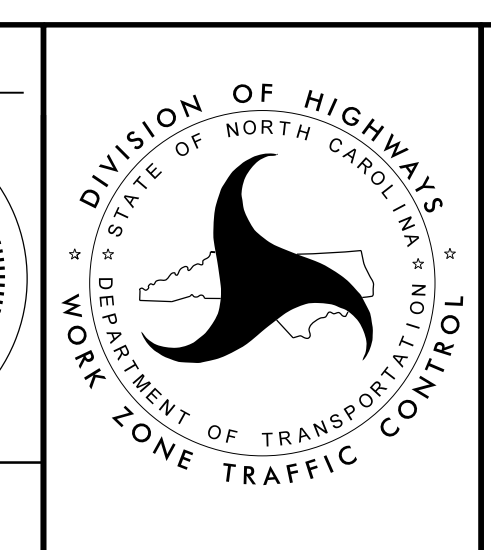

## GENERAL NOTES

7/2/99  
24-FEB-2025 15:08  
J:\U-6011\TrafficControl\TrafficControl\TCP\U-6011\TC\_TMP\_01B.dgn  
\$\$\$\$\$USERNAME\$\$\$\$\$

# PHASING

## PHASE IA

STEP 1: INSTALL TEMPORARY SIGNALS.

STEP 2: INSTALL ADVANCE WORK ZONE WARNING SIGNS ACCORDING TO RSD 1101.01 (SHEET 3 OF 3).

STEP 3: USING RSD 1101.02 (SHEET 7 OF 19) AS NEEDED CONSTRUCT THE FOLLOWING UP TO THE EDGE AND ELEVATION OF EXISTING EDGE OF TRAVEL NOT INCLUDING THE FINAL LAYER OF SURFACE COURSE AS SHOWN ON TMP-3 & TMP-4:

- \* -L- FROM STA. 10+01 +/- LT. TO STA. 14+76 +/- LT. (PROP. PAV'T, C&G, SUP, BUS PAD AND DRAINAGE)
- \* -L- FROM STA. 15+45 +/- LT. TO STA. 19+97 +/- LT. (PROP. PAV'T, C&G, SIDEWALK AND DRAINAGE)
- \* -L- FROM STA. 10+08 +/- RT. TO STA. 14+11/- RT. (PROP. PAV'T, C&G, SIDEWALK, SUP, GUARDRAIL AND DRAINAGE)
- \* -Y1- FROM STA. 20+35 +/- LT. TO STA. 26+53 +/- LT. (PROP. PAV'T, C&G, SIDEWALK, SUP AND DRAINAGE)
- \* -Y1- FROM STA. 26+93 +/- LT. TO STA. 38+42 +/- LT. (SIDEWALK ONLY)
- \* -Y1- FROM STA. 16+44 +/- RT. TO STA. 18+00 +/- RT. (PROP. PAV'T, C&G, GUARDRAIL AND RETAINING WALL)
- \* -Y1- FROM STA. 20+31 +/- RT. TO STA. 26+44 +/- RT. (TEMPORARY SIDEWALK, TEMPORARY WHEEL CHAIR RAMPS AND PEDESTRIAN DETOUR SIGNING)
- \* PLACE ALL TEMPORARY CROSSWALK PAVEMENT MARKING LINES AT THE INTERSECTION OF -L- US 70 (S. CHURCH ST) AND -Y1- SR 1158 (HUFFMAN MILL RD) AND THE INTERSECTION OF -Y1- SHADOWBROOK DRIVE AND NEESE CT. AS SHOWN ON TMP-3 & TMP-4 AND OPEN TO PEDESTRIAN TRAFFIC.
- \* AT THE CONCLUSION OF PHASE 1A, REMOVE TEMPORARY SIDEWALK, TEMPORARY WHEEL CHAIR RAMPS AND PEDESTRIAN DETOUR SIGNING.

USING RSD 1101.02 (SHEET 7 OF 19) AS NEEDED INSTALL THE 15" RCP AT STA. 20+81 +/- -Y1- LT & RT, THE 18" RCP AT STA. 18+73 +/- -L- LT & RT AND THE 18" RCP AT STA. 12+28 +/- -L- LT WITH OPEN CUT CONSTRUCTION DURING OFF PEAK NIGHT TIME HOURS ONLY. USE STEEL PLATE COVERS AS NEEDED TO COVER OVER ALL AREAS THAT REMAIN INCOMPLETE UNTIL PAVING OPERATIONS ARE COMPLETE. REMOVE THE EXISTING CONCRETE ISLAND FROM 15+70 +/- -L- TO STA. 19+98 +/- -L- RT., MAKE PAVEMENT REPAIRS AND PLACE TEMPORARY PAVEMENT MARKINGS AS NEEDED DURING OFF PEAK NIGHT TIME HOURS ONLY AS SHOWN ON TMP-3:

## PHASE IB

STEP 1: INSTALL TEMPORARY SIGNALS.

STEP 2: INSTALL ADVANCE WORK ZONE WARNING SIGNS ACCORDING TO RSD 1101.01 (SHEET 3 OF 3).

STEP 3: USING RSD 1101.02 (SHEET 7 OF 19) AS NEEDED CONSTRUCT THE FOLLOWING UP TO THE EDGE AND ELEVATION OF EXISTING EDGE OF TRAVEL NOT INCLUDING THE FINAL LAYER OF SURFACE COURSE AS SHOWN ON TMP-3 & TMP-4:

- \* -Y1- FROM STA. 15+37 +/- LT. TO STA. 19+14 +/- LT. (PROP. PAV'T, C&G, SIDEWALK, SUP AND DRAINAGE)
- \* -Y1- FROM STA. 20+20 +/- RT. TO STA. 27+03 +/- RT. (PROP. PAV'T, C&G, SIDEWALK, DRAINAGE, PAV'T REMOVAL AND REMOVAL OF TEMPORARY SIDEWALK, TEMPORARY WHEEL CHAIR RAMPS AND PEDESTRIAN DETOUR SIGNING)
- \* PLACE ADDITIONAL TEMPORARY CROSSWALK PAVEMENT MARKING LINES AT THE INTERSECTION OF -L- US 70 (S. CHURCH ST) AND -Y1- SR 1158 (HUFFMAN MILL RD) AS SHOWN ON TMP-5.

USING RSD 1101.02 (SHEET 7 OF 19) AS NEEDED CONTINUE INSTALLATION OF THE 15" RCP AT STA. 20+81 +/- -Y1- LT & RT, THE 18" RCP AT STA. 18+73 +/- -L- LT & RT AND THE 18" RCP AT STA. 12+28 +/- -L- LT WITH OPEN CUT CONSTRUCTION DURING OFF PEAK NIGHT TIME HOURS ONLY. USE STEEL PLATE COVERS AS NEEDED TO COVER OVER ALL AREAS THAT REMAIN INCOMPLETE UNTIL PAVING OPERATIONS ARE COMPLETE.

## PHASE II

STEP 1: MAKE ADJUSTMENTS TO TEMPORARY SIGNALS.

STEP 2: USING RSD 1101.02 (SHEET 7 OF 19) AS NEEDED CONSTRUCT THE FOLLOWING UP TO THE EDGE AND ELEVATION OF EXISTING EDGE OF TRAVEL NOT INCLUDING THE FINAL LAYER OF SURFACE COURSE AS SHOWN ON TMP-5:

- \* -L- FROM STA. 10+35 +/- RT TO STA. 14+06 +/- LT (CENTER MEDIAN)
- \* -L- FROM STA. 15+81 +/- RT TO STA. 20+15 +/- RT (CENTER MEDIAN)
- \* -L- FROM STA. 14+13 +/- RT. TO STA. 14+41 +/- RT. (ISLAND)
- \* -Y1- FROM STA. 18+00 +/- RT. TO STA. 19+55 +/- -L- RT. (PROP. PAV'T, C&G, SIDEWALK AND DRAINAGE)

STEP 3: USING RSD 1101.02 (SHEET 7 OF 19) AS NEEDED INSTALL TEMPORARY PAVEMENT MARKINGS AS SHOWN ON TMP-6 & TMP-7:

## PHASE III

STEP 1: INSTALL PROPOSED SIGNALS.

STEP 2: USING RSD 1101.02 (SHEET 7 OF 19) AS NEEDED PLACE THE FINAL LAYER OF SURFACE COURSE AS SHOWN ON TMP-9 & TMP-10:

- \* -L- FROM STA. 10+00 +/- TO STA. 20+15 +/-
- \* -Y1- FROM STA. 16+44 +/- TO STA. 27+33 +/-

STEP 3: PLACE FINAL PAVEMENT MARKINGS AS SHOWN IN THE PAVEMENT MARKING PLANS.

STEP 4: UPON APPROVAL OF ENGINEER, REMOVE TEMPORARY TRAFFIC CONTROL DEVICES AND OPEN ALL ROADS AND ALL LANES TO TRAFFIC.

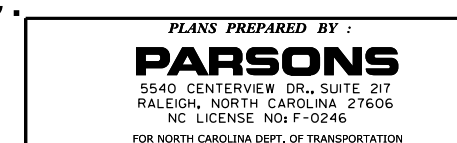

APPROVED: *Ayman Aljoudi*  
EBF730CTRE0177A

DATE: 5/7/2024

SEAL

DOCUMENT NOT CONSIDERED FINAL  
UNLESS ALL SIGNATURES COMPLETED

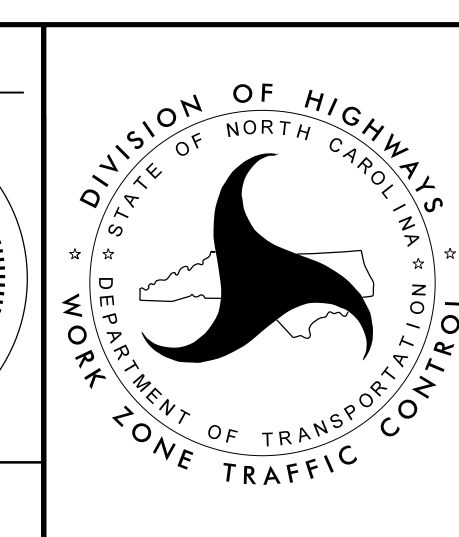

# PHASING

7/2/99  
07-MAY-2024 07:38  
J:\U-6011\TrafficControl\TCP\U-6011\_TC\_TMP\_02.dgn  
\$\$\$\$\$USERNAME\$\$\$\$\$

7/2/99

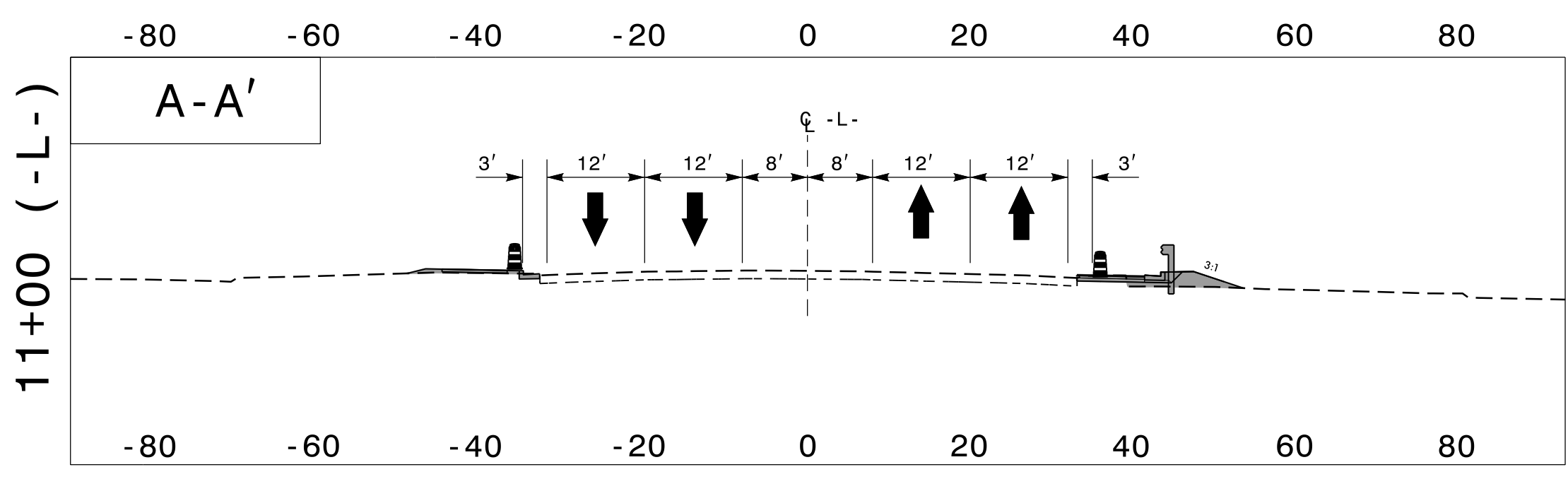
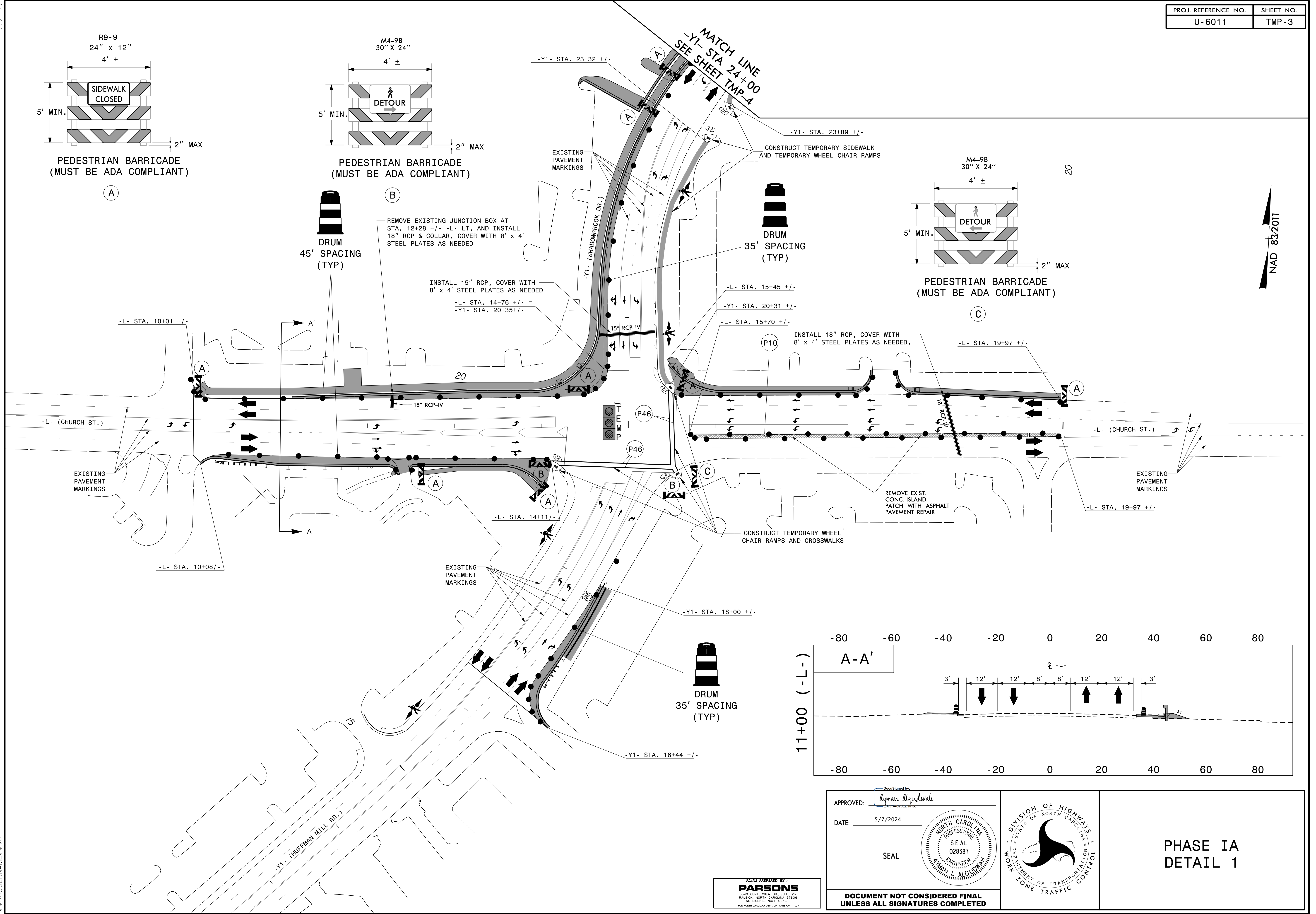
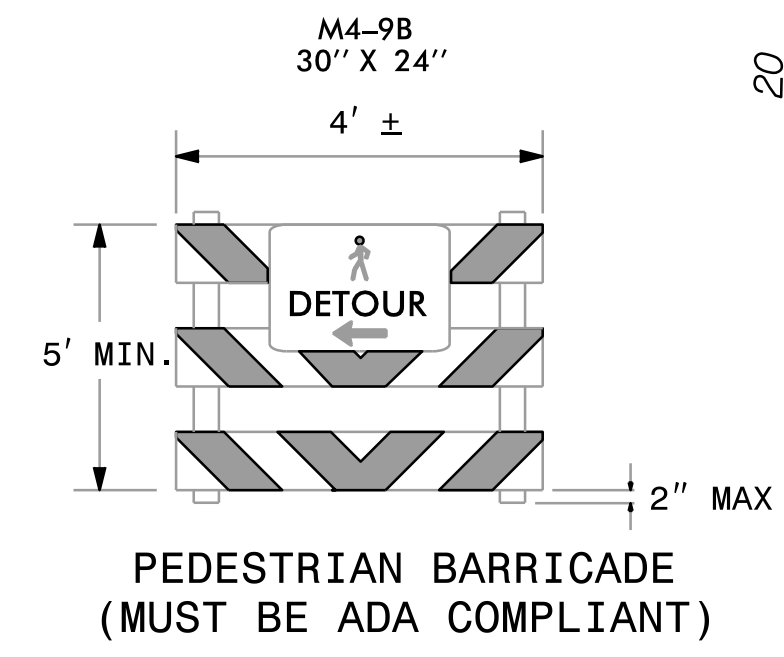
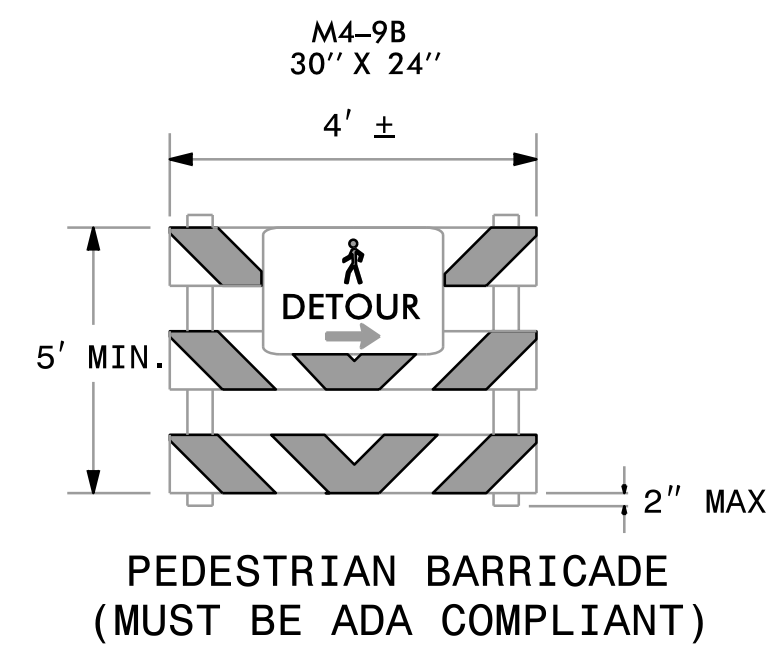
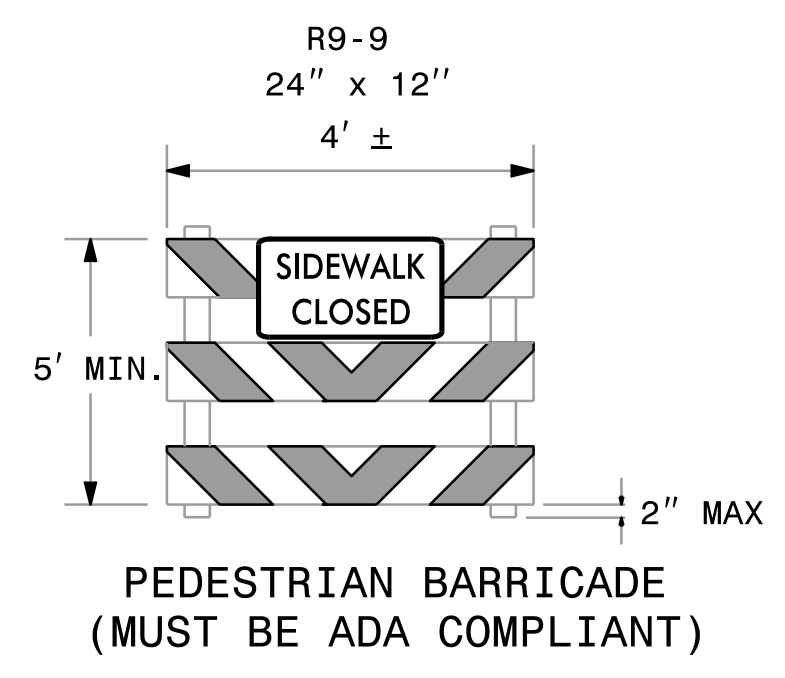

NAD 83/2011

07-MAY-2024 07:38  
J:\U-6011\TrafficControl\TCP\U-6011\_TC\_TMP\_03.dgn  
\$\$\$\$\$USERNAME\$\$\$\$\$

PLANS PREPARED BY  
**PARSONS**  
5500 CENTERVILLE RD., SUITE 201  
RALEIGH, NORTH CAROLINA 27606  
NC LICENSE NO. T-10246  
FOR NORTH CAROLINA DEPT. OF TRANSPORTATION

APPROVED: *Almar Aljoudi*  
DATE: 5/7/2024  
SEAL

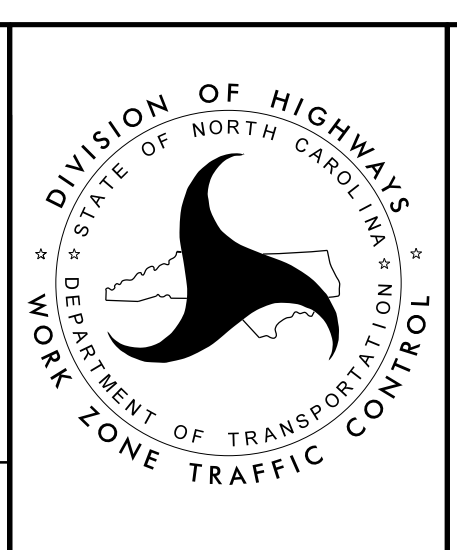

PHASE IA  
DETAIL 1

DOCUMENT NOT CONSIDERED FINAL  
UNLESS ALL SIGNATURES COMPLETED

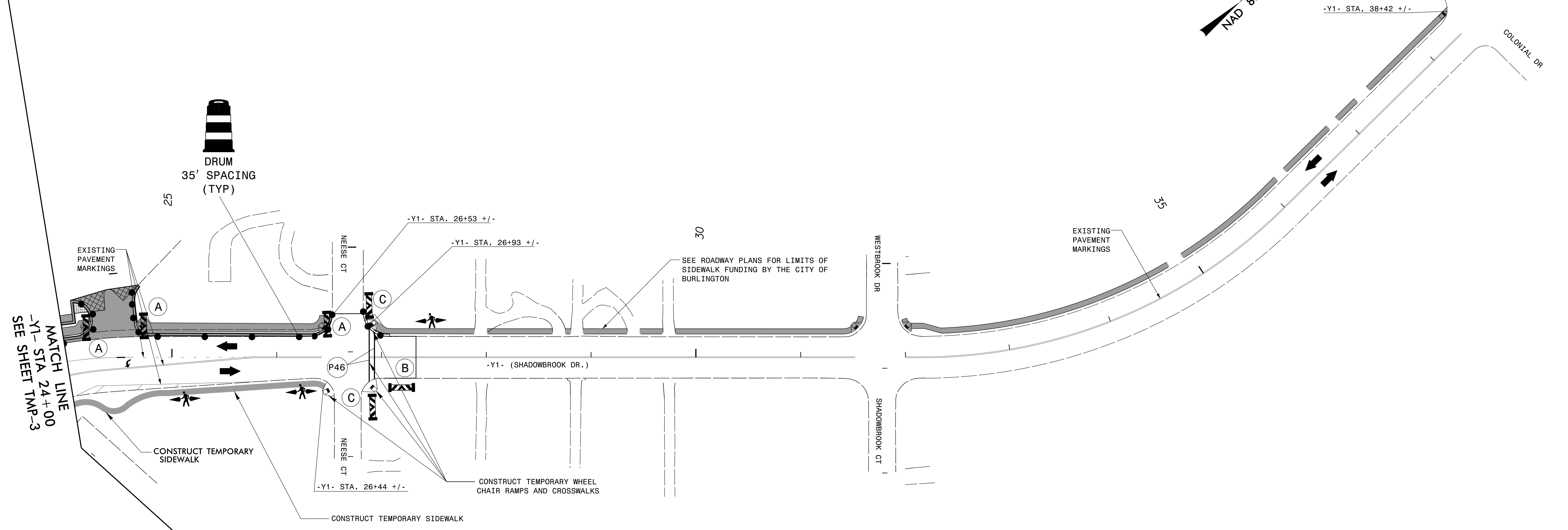
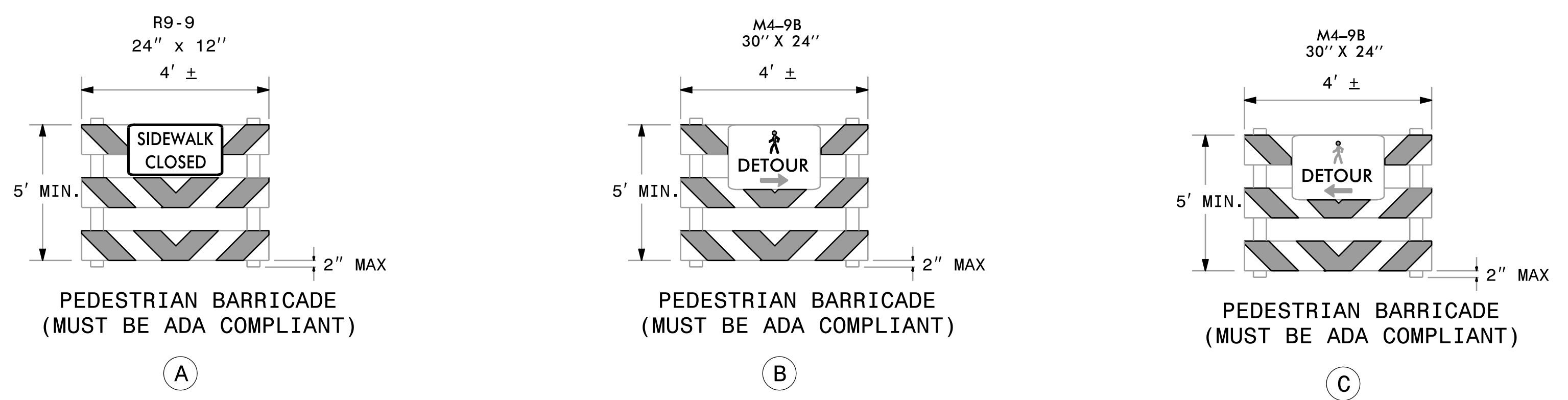

07-MAY-2024 07:38  
 J:\U-6011\TrafficControl\TCP\U-6011\_TC\_TMP\_04.dgn  
 \$\$\$USERNAME\$\$\$

PLANS PREPARED BY  
**PARSONS**  
5500 CENTERVILLE DRIVE, SUITE 201  
 RALEIGH, NORTH CAROLINA 27606  
 NC LICENSE NO. F-10246  
 FOR NORTH CAROLINA DEPT. OF TRANSPORTATION

APPROVED: *Iman Aloudwan*  
DocuSigned by:  
Iman Aloudwan  
E8F5A2C8D167A  
 DATE: 5/7/2024  
 SEAL

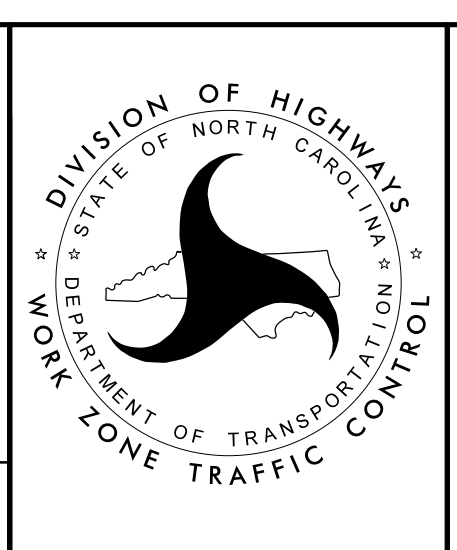

PHASE IA  
 DETAIL 2

DOCUMENT NOT CONSIDERED FINAL  
 UNLESS ALL SIGNATURES COMPLETED

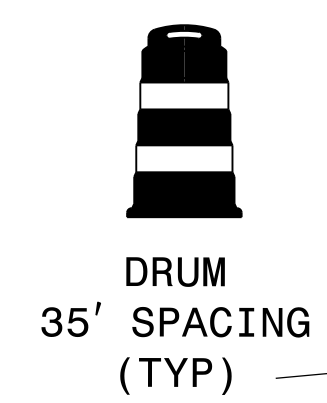
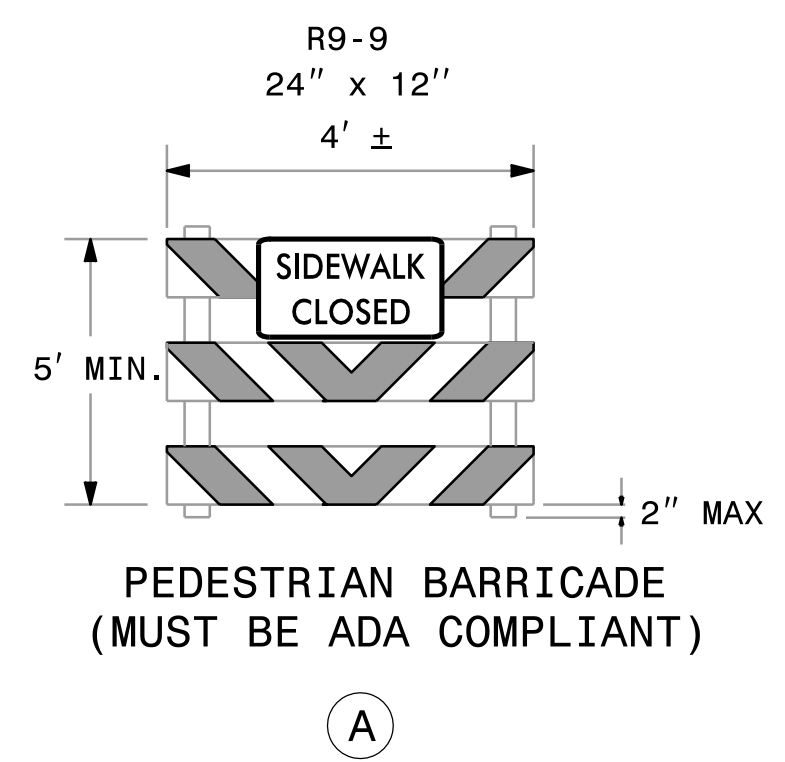

REMOVE EXISTING JUNCTION BOX AT STA. 12+28 +/- -L- LT. AND INSTALL 18" RCP & COLLAR, COVER WITH 8' x 4' STEEL PLATES AS NEEDED

INSTALL 15" RCP, COVER WITH 8' x 4' STEEL PLATES AS NEEDED

REMOVE TEMPORARY SIDEWALK AND TEMPORARY WHEEL CHAIR RAMPS

INSTALL 18" RCP, COVER WITH 8' x 4' STEEL PLATES AS NEEDED.

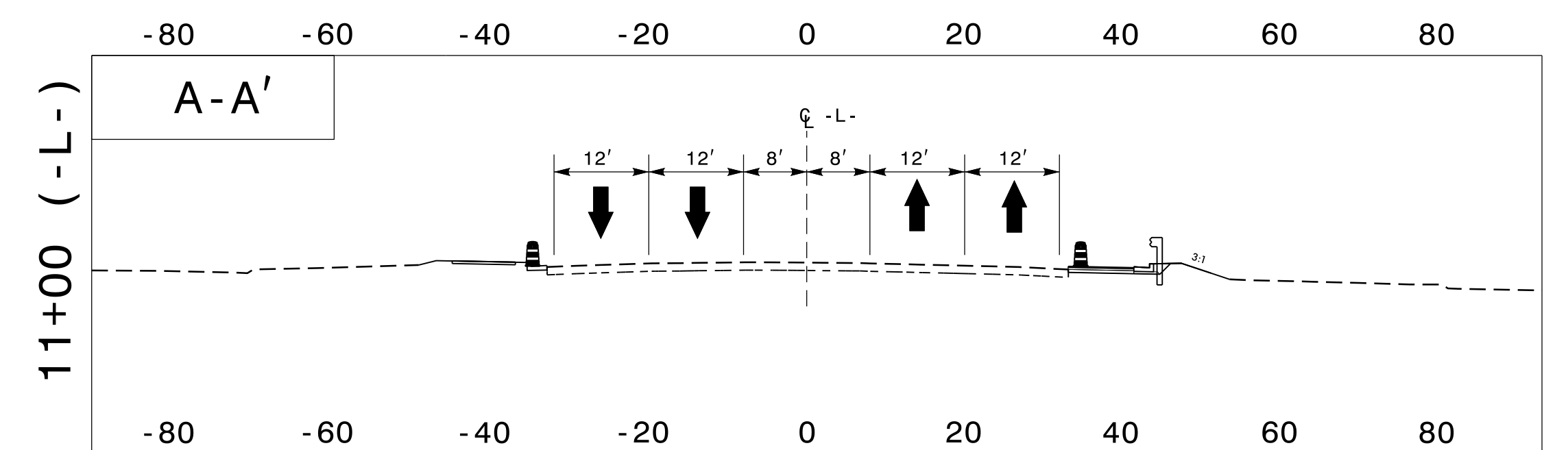
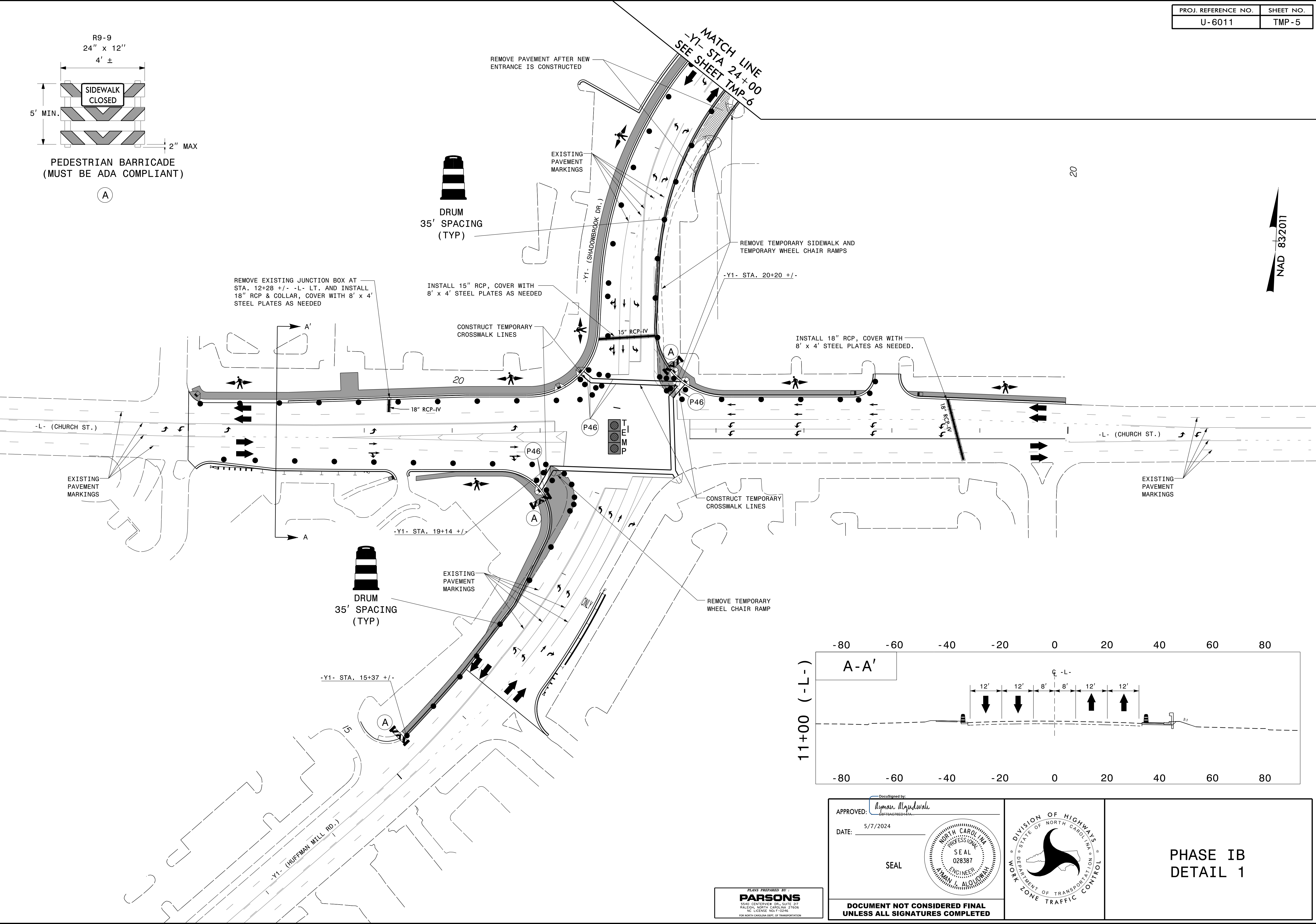

07-MAY-2024 07:39  
 J:\U-6011\TrafficControl\TCP\U-6011\_TC\_TMP\_05.dgn  
 \$\$\$USERNAME\$\$\$

PLANS PREPARED BY  
**PARSONS**  
5500 COSTLETT RD. SUITE 201  
 RALEIGH, NORTH CAROLINA 27606  
 NC LICENSE NO. F-10246  
 FOR NORTH CAROLINA DEPT. OF TRANSPORTATION

APPROVED: *Alman Aljoudi*  
 DATE: 5/7/2024  
 SEAL  
 NORTH CAROLINA  
 PROFESSIONAL  
 SEAL  
 028387  
 ENGINEER  
 ALMAN ALJOUADI

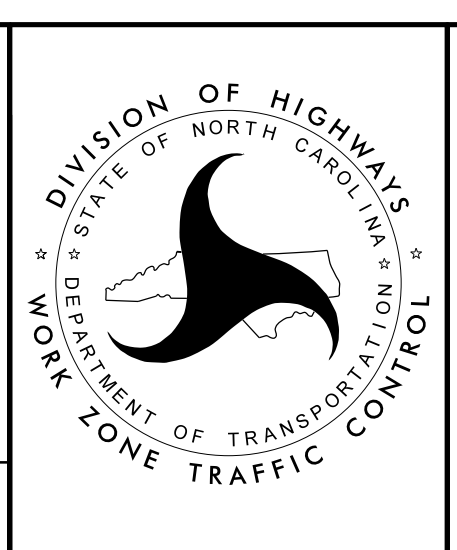

**PHASE I B  
 DETAIL 1**

**DOCUMENT NOT CONSIDERED FINAL  
 UNLESS ALL SIGNATURES COMPLETED**

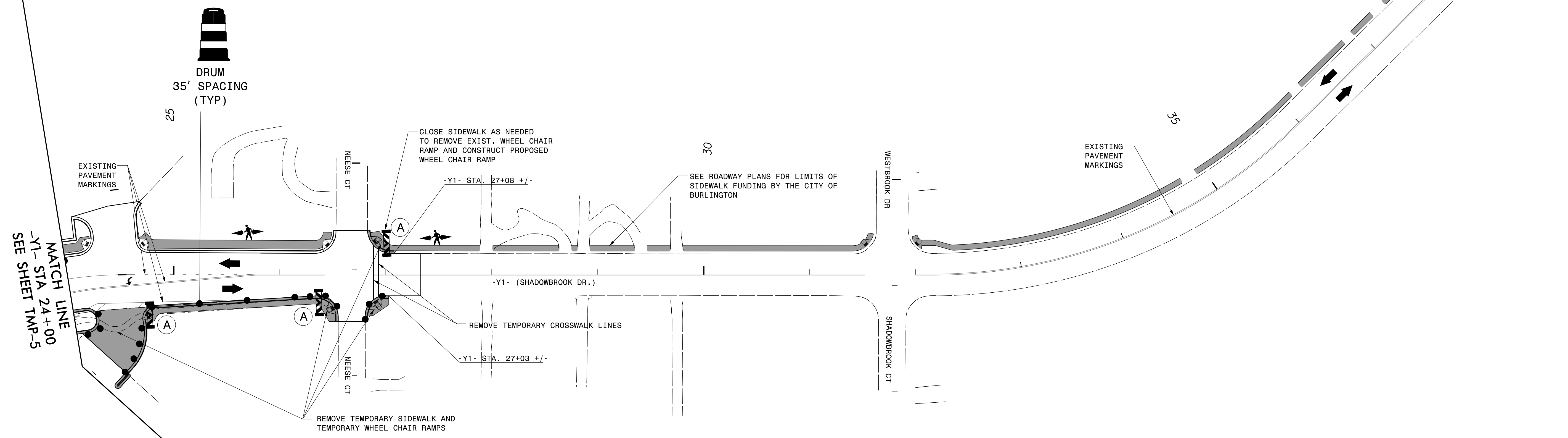
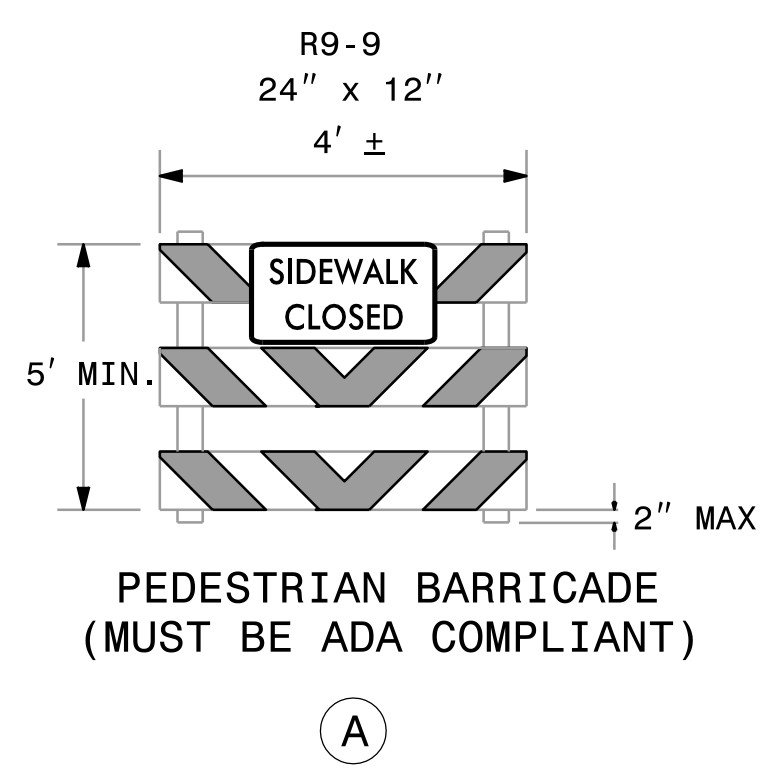

7/2/99

07-MAY-2024 07:39 J:\U-6011\TrafficControl\TCP\U-6011\_TC\_TMP\_06.dgn \$\$\$USERNAME\$\$\$

PLANS PREPARED BY  
**PARSONS**  
5500 CENTERVILLE RD SUITE 201  
 RALEIGH, NORTH CAROLINA 27606  
 NC LICENSE NO. F-10246  
 FOR NORTH CAROLINA DEPT. OF TRANSPORTATION

APPROVED: *Arman Majumdar*  
6073ACR00147A

DATE: 5/7/2024

SEAL

**DOCUMENT NOT CONSIDERED FINAL  
 UNLESS ALL SIGNATURES COMPLETED**

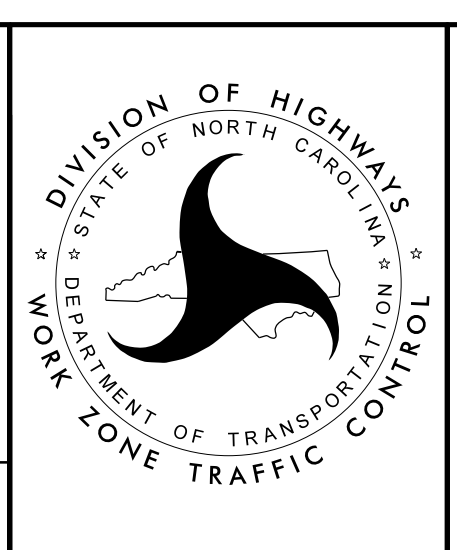

PHASE 1B  
 DETAIL 2



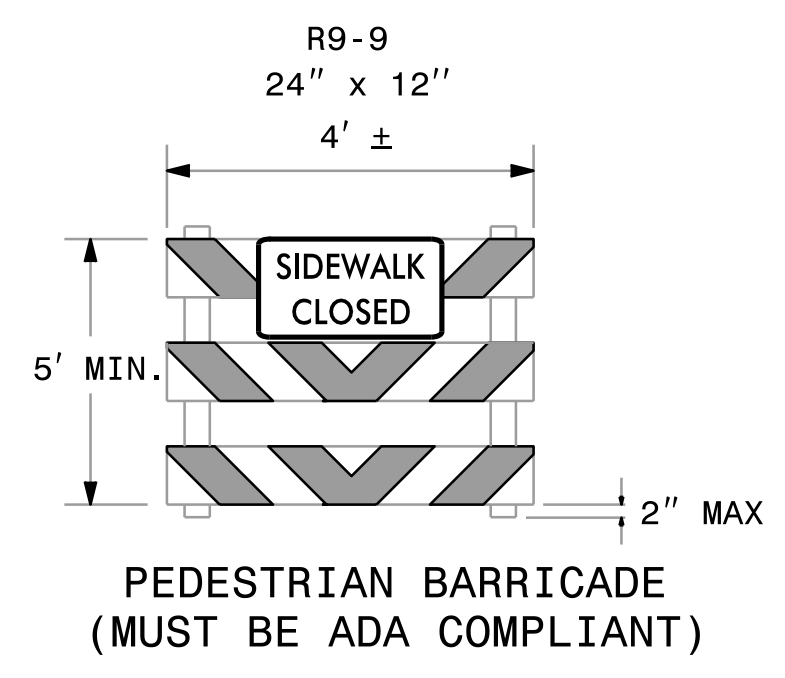

(A)

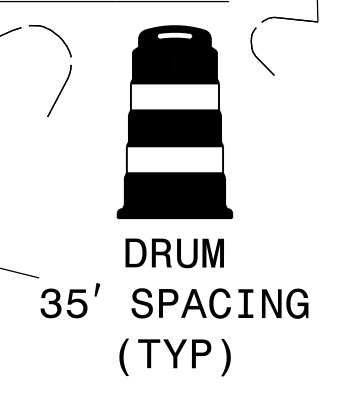
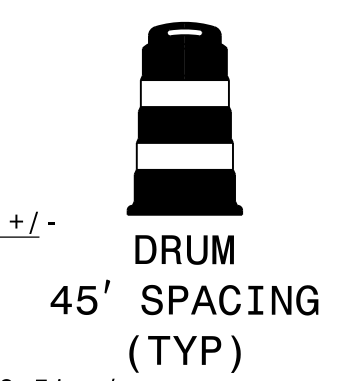
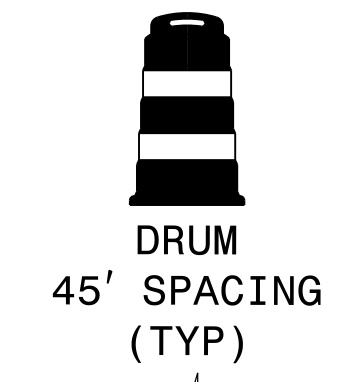

7/2/99  
07-MAY-2024 07:39  
J:\U-6011\TrafficControl\TCP-U-6011\_TC\_TMP\_07.dgn  
\$\$\$\$\$USERNAME\$\$\$\$\$

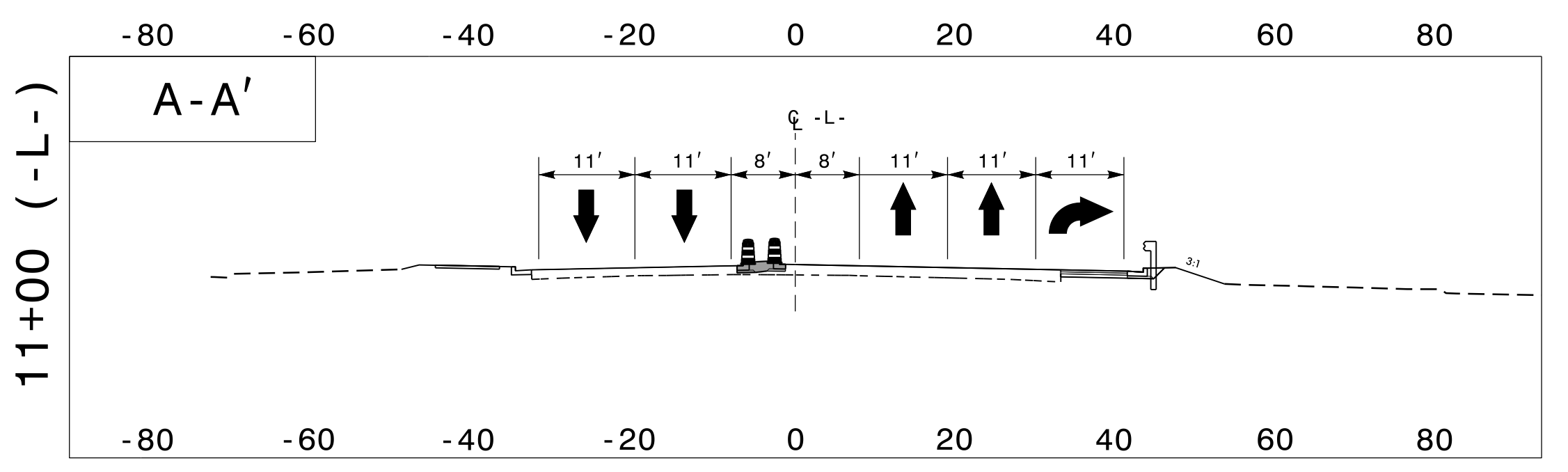
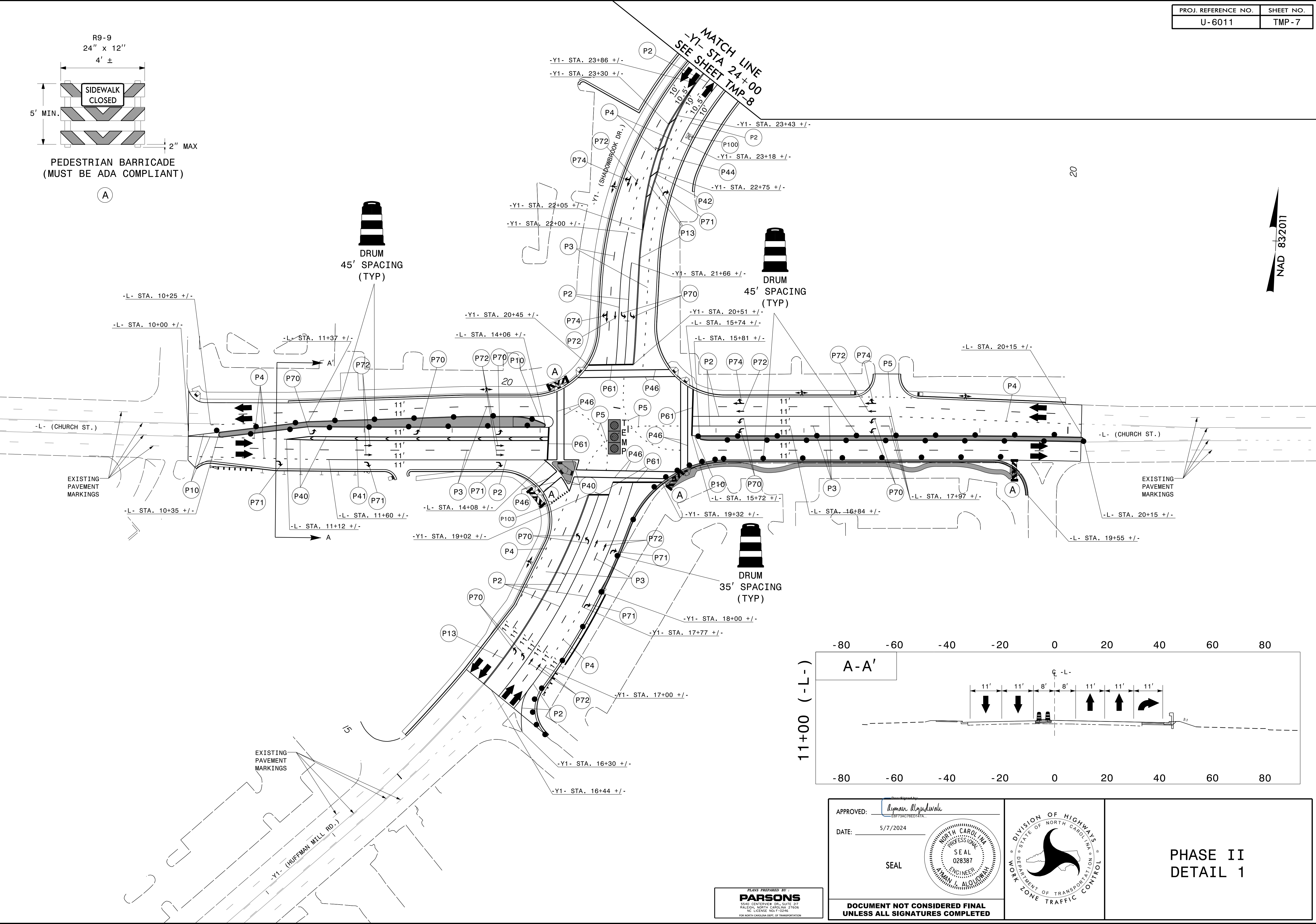

APPROVED: *Alman Aljudani*  
DATE: 5/7/2024  
SEAL  
NORTH CAROLINA PROFESSIONAL ENGINEER  
ALMAN ALJUDANI  
028387

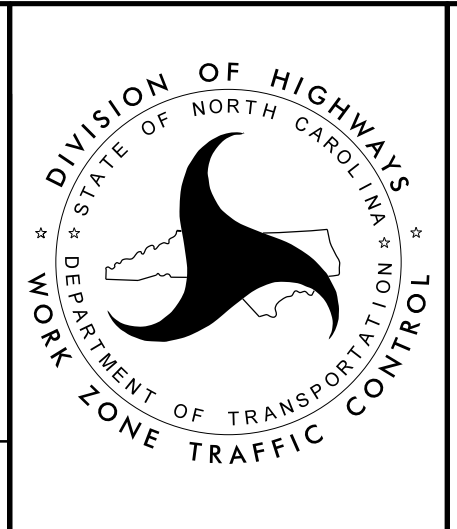

PHASE II  
DETAIL 1

PLANS PREPARED BY  
**PARSONS**  
5500 CENTREVILLE RD., SUITE 201  
RALEIGH, NORTH CAROLINA 27606  
NC LICENSE NO. P-10246  
FOR NORTH CAROLINA DEPT. OF TRANSPORTATION

DOCUMENT NOT CONSIDERED FINAL  
UNLESS ALL SIGNATURES COMPLETED

7/2/99

07-MAY-2024 07:39  
J:\U-6011\TrafficControl\TCP\U-6011\_TC\_TMP\_08.dgn  
\$\$\$\$\$USERNAME\$\$\$\$\$

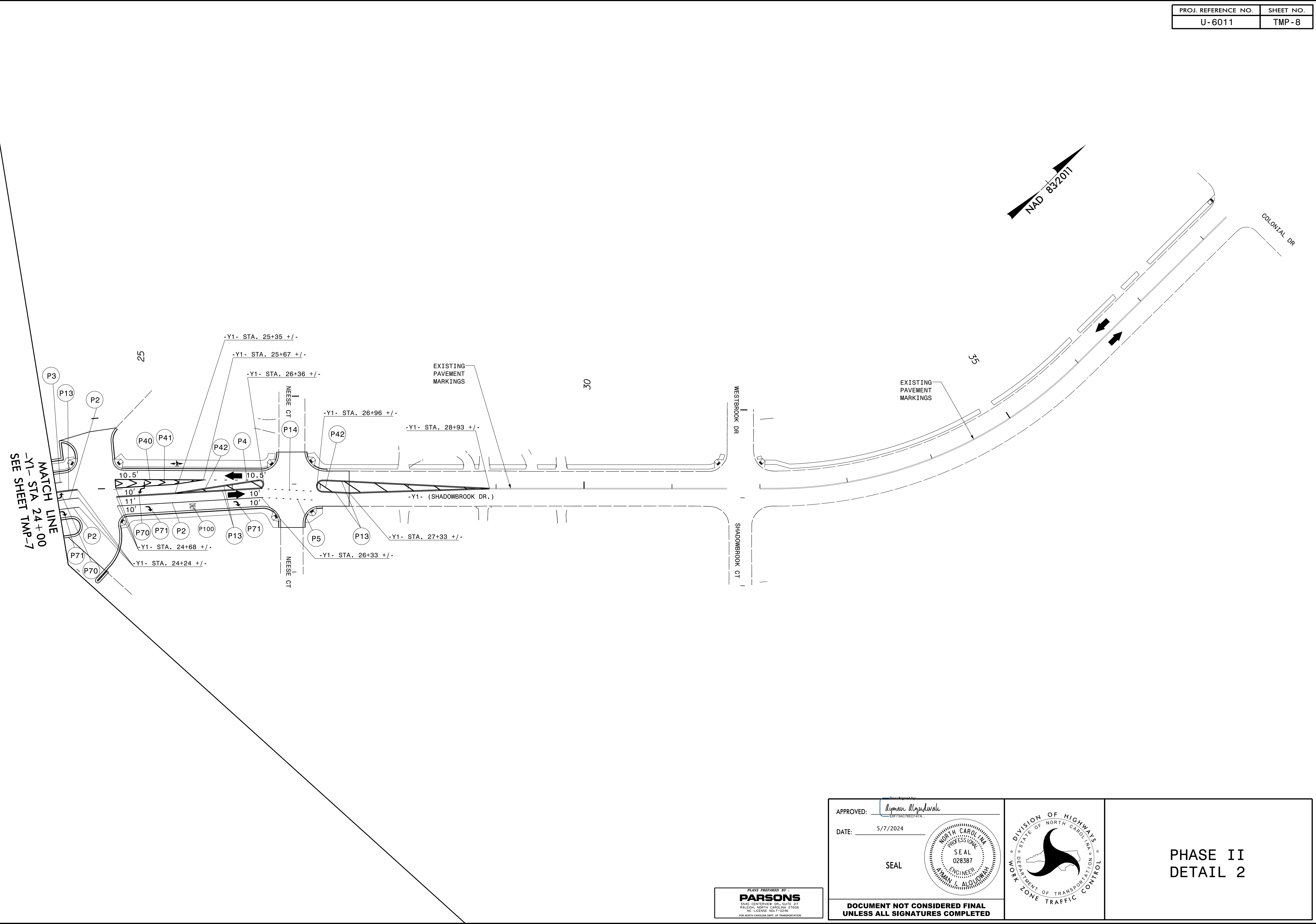

PLANS PREPARED BY  
**PARSONS**  
2500 CENTERVILLE RD SUITE 201  
RALEIGH, NORTH CAROLINA 27606  
NC LICENSE NO. P-10246  
FOR NORTH CAROLINA DEPT. OF TRANSPORTATION

APPROVED: *Ayman Aljoudi*  
DATE: 5/7/2024  
SEAL  
DOCUMENT NOT CONSIDERED FINAL  
UNLESS ALL SIGNATURES COMPLETED

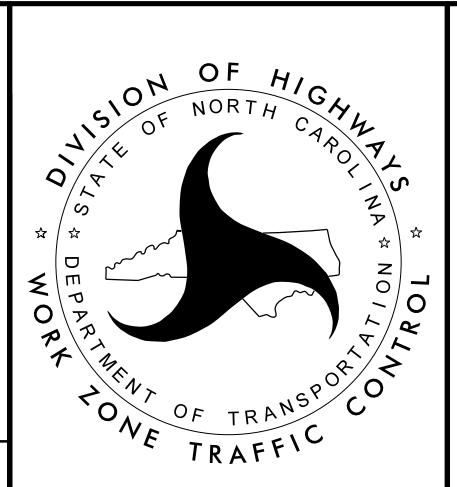
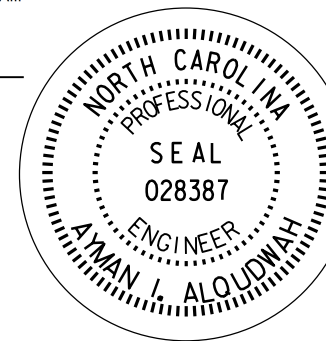

**PHASE II  
DETAIL 2**

PROJ. REFERENCE NO.	SHEET NO.
U-6011	TMP-9

7/2/99

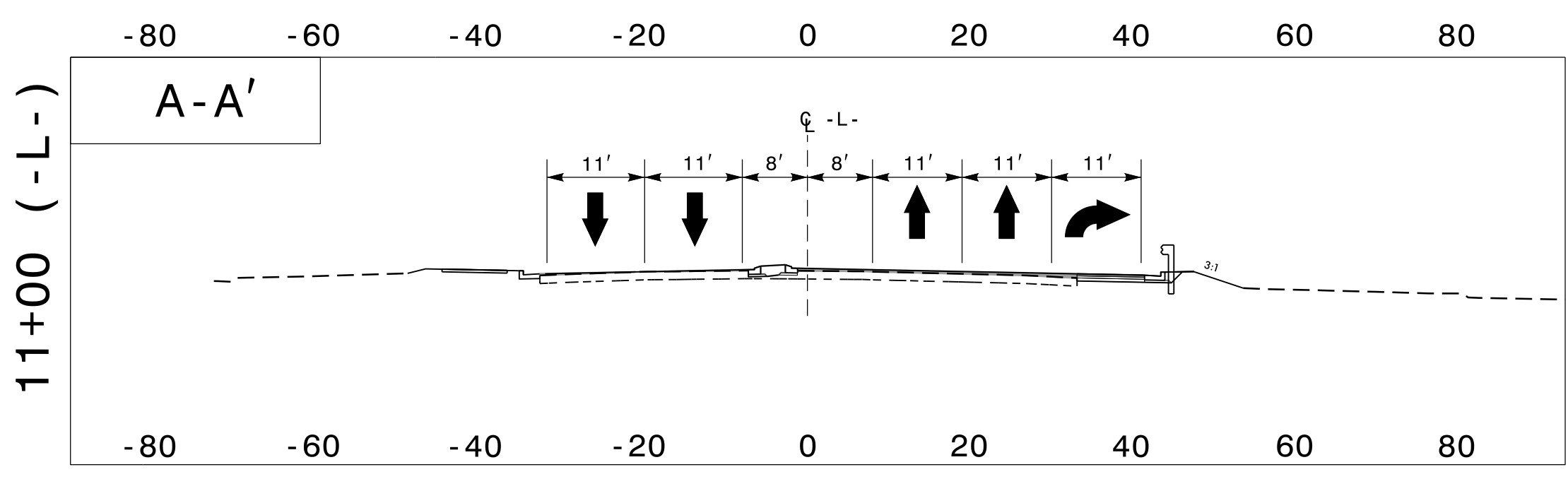
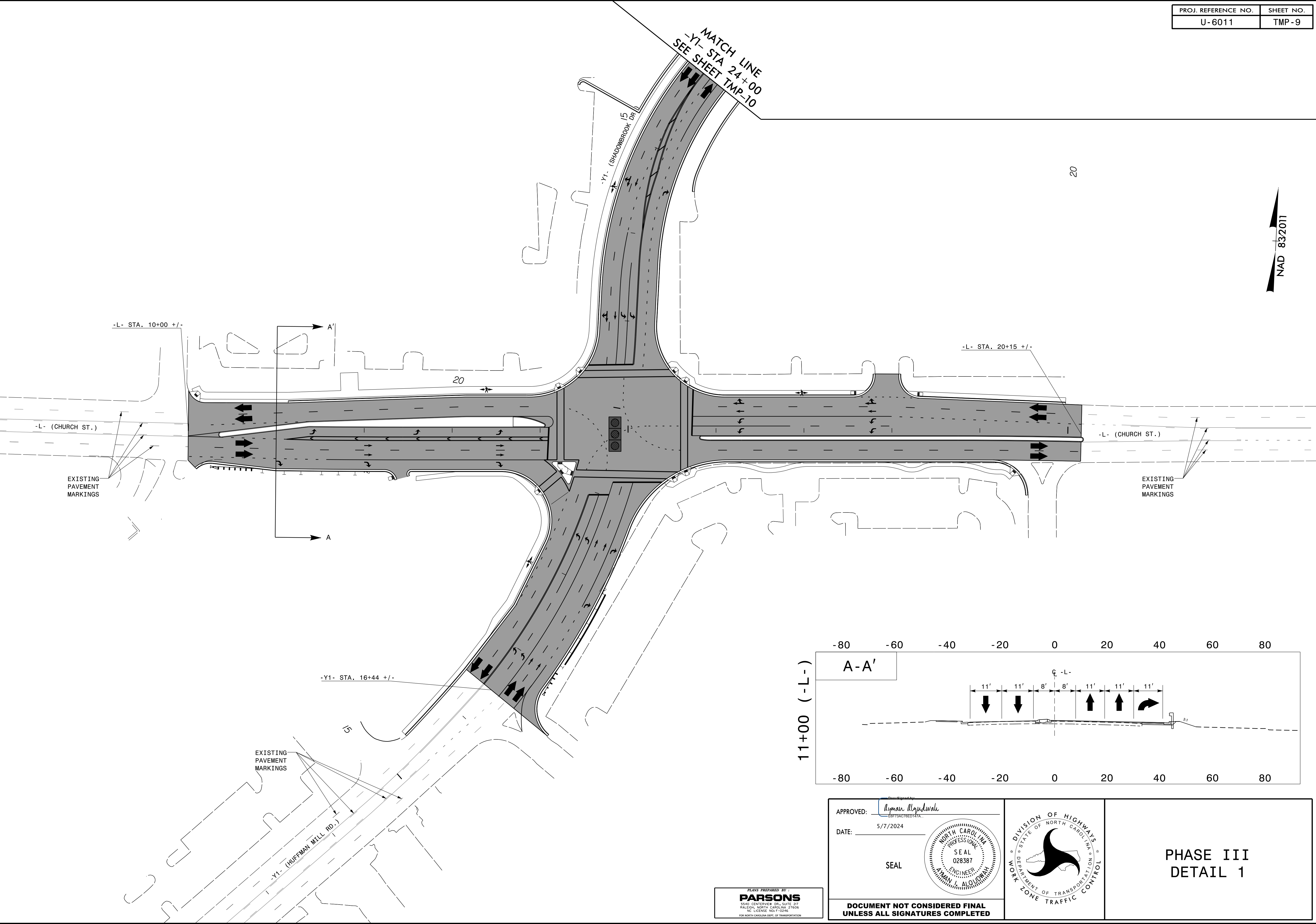

07-MAY-2024 07:39  
 J:\U-6011\TrafficControl\TCP\U-6011\_TC\_TMP\_09.dgn  
 \$\$\$USERNAME\$\$\$

PLANS PREPARED BY  
**PARSONS**  
5500 CENTERVILLE RD., SUITE 201  
 RALEIGH, NORTH CAROLINA 27606  
 NC LICENSE NO. F-10246  
 FOR NORTH CAROLINA DEPT. OF TRANSPORTATION

APPROVED: *Lyman Alford*  
REGISTERED PROFESSIONAL ENGINEER  
 DATE: 5/7/2024  
 SEAL  
**DOCUMENT NOT CONSIDERED FINAL  
 UNLESS ALL SIGNATURES COMPLETED**

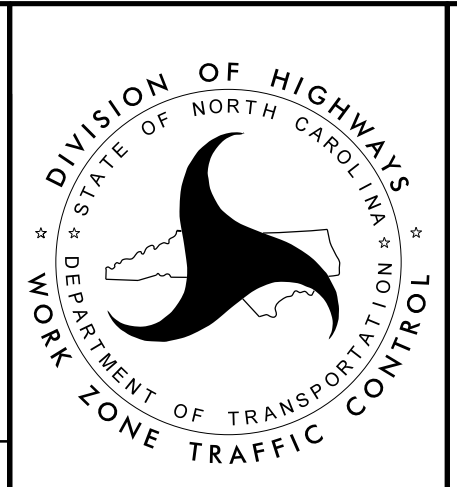

**PHASE III  
 DETAIL 1**

PROJ. REFERENCE NO.	SHEET NO.
U-6011	TMP-10

7/2/99

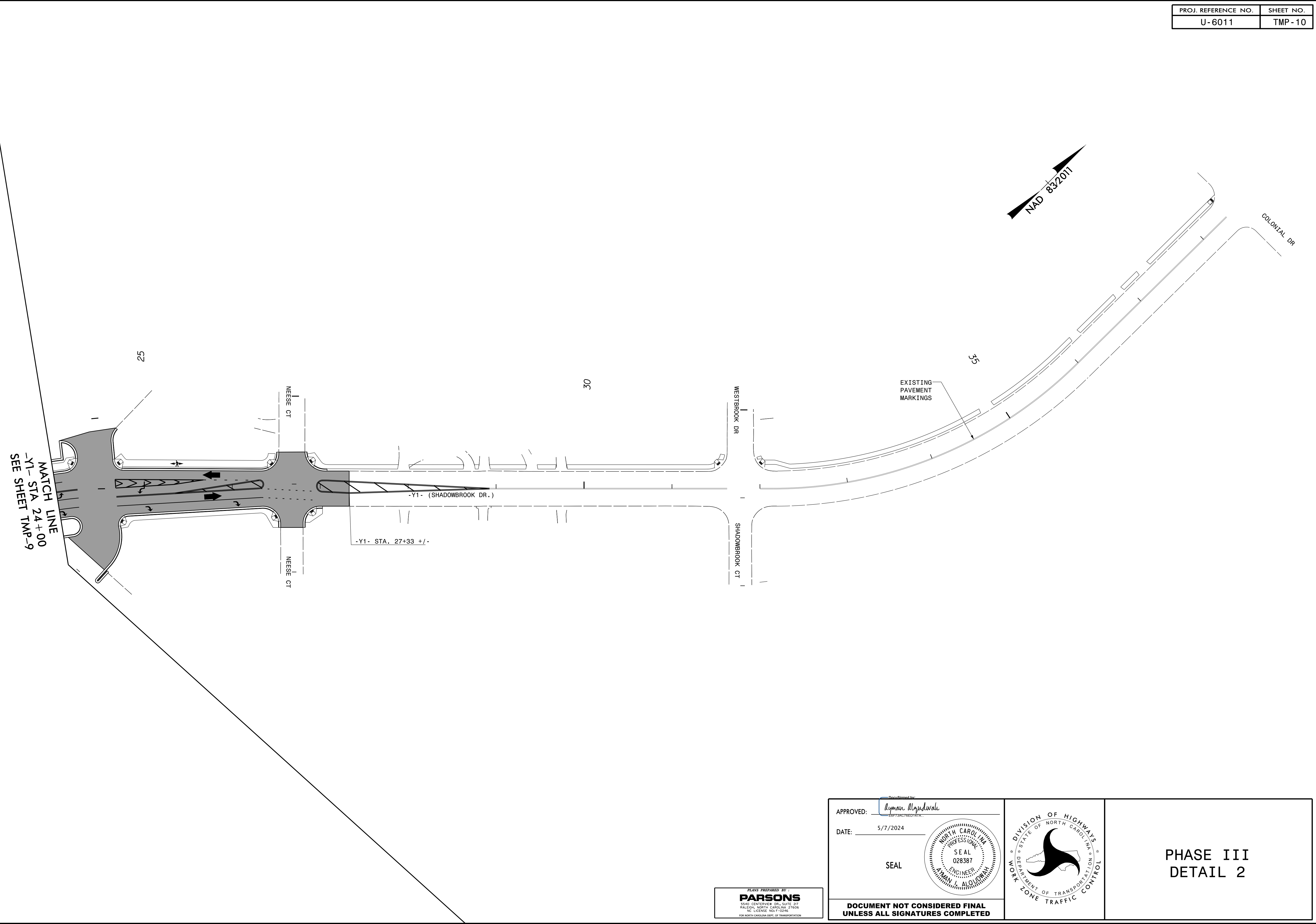

07-MAY-2024 07:40  
 J:\U-6011\TrafficControl\TCP\U-6011\_TC\_TMP\_10.dgn  
 \$\$\$USERNAME\$\$\$

PLANS PREPARED BY  
**PARSONS**  
 2500 CENTERVILLE DRIVE, SUITE 201  
 RALEIGH, NORTH CAROLINA 27606  
 NC LICENSE NO. F-10246  
 FOR NORTH CAROLINA DEPT. OF TRANSPORTATION

APPROVED: *Hyman Aljoudawi*  
 DATE: 5/7/2024

SEAL

DOCUMENT NOT CONSIDERED FINAL  
 UNLESS ALL SIGNATURES COMPLETED

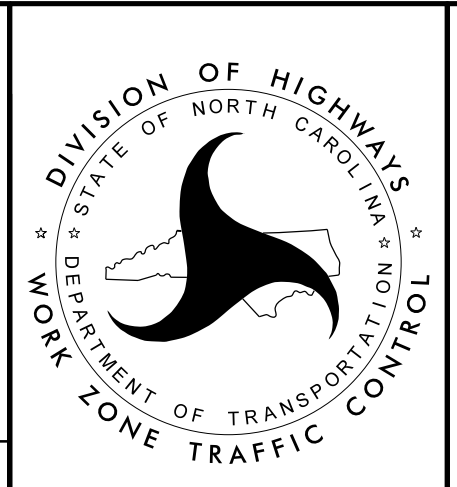
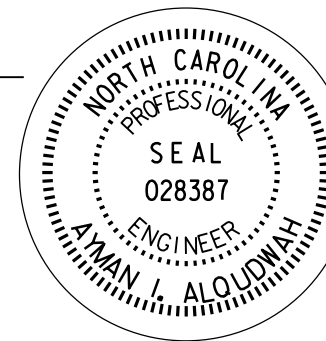

PHASE III  
 DETAIL 2