

See Sheet 1A For Index of Sheets
See Sheet 1B For Conventional Symbols

STATE OF NORTH CAROLINA
DIVISION OF HIGHWAYS

ALAMANCE COUNTY

**LOCATION: US 70 (SOUTH CHURCH ST) AT SR 1158
(HUFFMAN MILL RD) IN BURLINGTON**

**TYPE OF WORK: GRADING, DRAINAGE, PAVING, SIGNALS
AND RETAINING WALLS**

STATE	STATE PROJECT REFERENCE NO.	SHEET NO.	TOTAL SHEETS
N.C.	U-6011	1	
STATE PROJ. NO.	F.A. PROJ. NO.	DESCRIPTION	
47146.1.1		PE	
47146.2.1		ROW	
47146.2.2		UTIL RELO.	
47146.3.1		CONST	

TIP PROJECT: U-6011

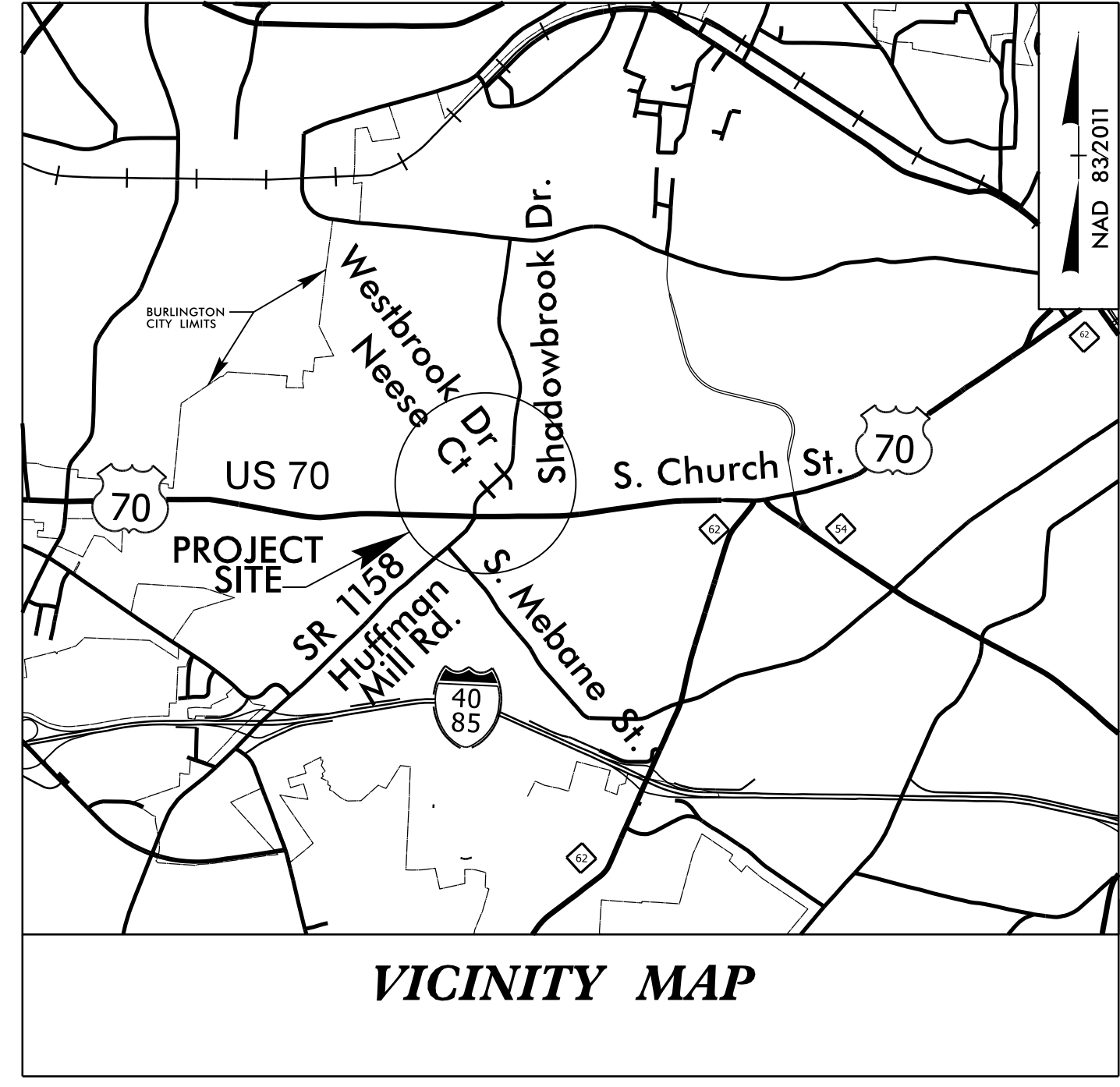

VICINITY MAP

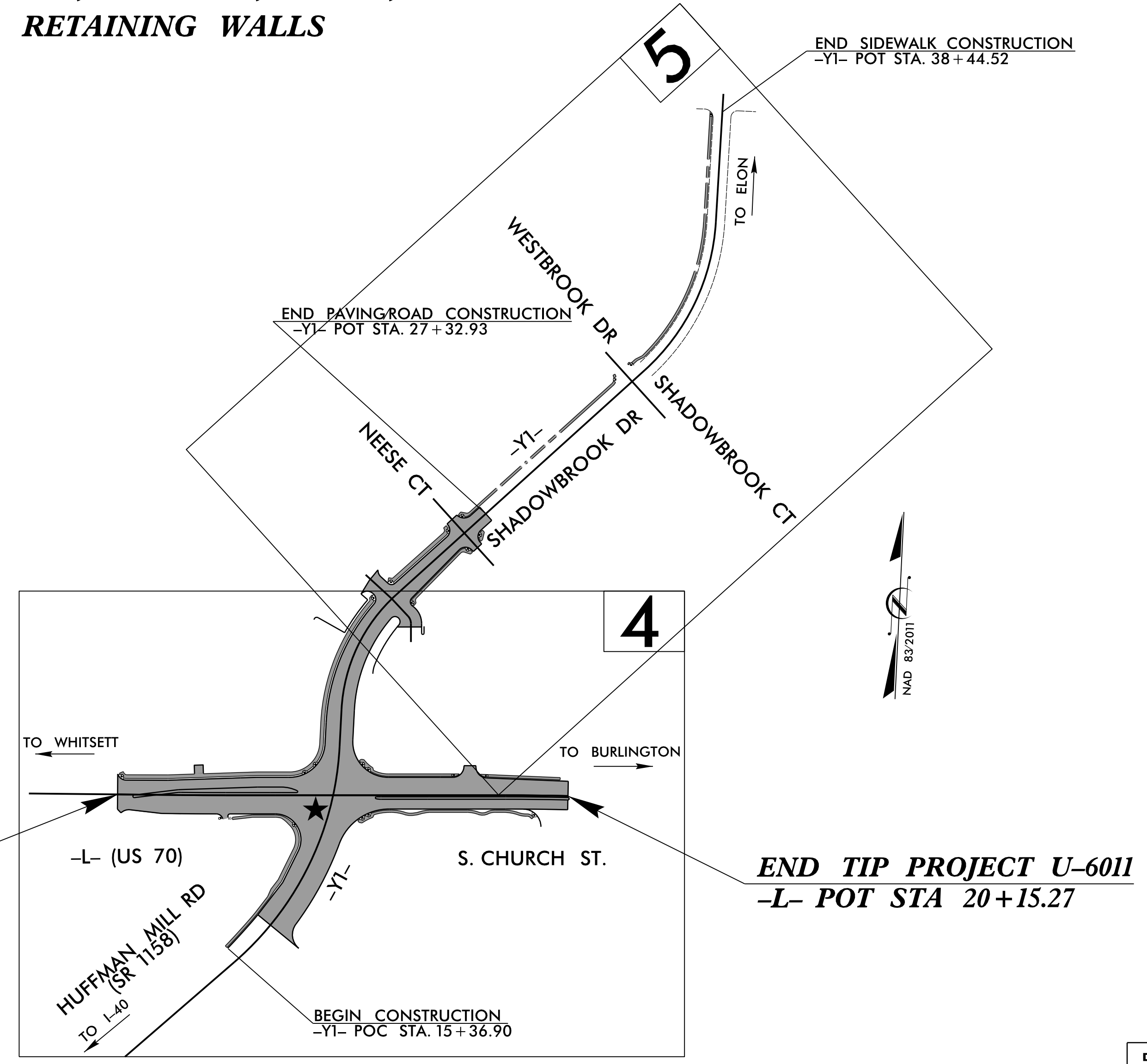

BEGIN TIP PROJECT U-6011
-L- POT STA 10+00.00

END TIP PROJECT U-6011
-L- POT STA 20+15.27

★ DENOTES SIGNAL

THIS PROJECT IS LOCATED WITHIN THE MUNICIPAL BOUNDARIES OF THE CITY OF BURLINGTON.

DOCUMENT NOT CONSIDERED FINAL
UNLESS ALL SIGNATURES COMPLETED

CONTRACT: C205066

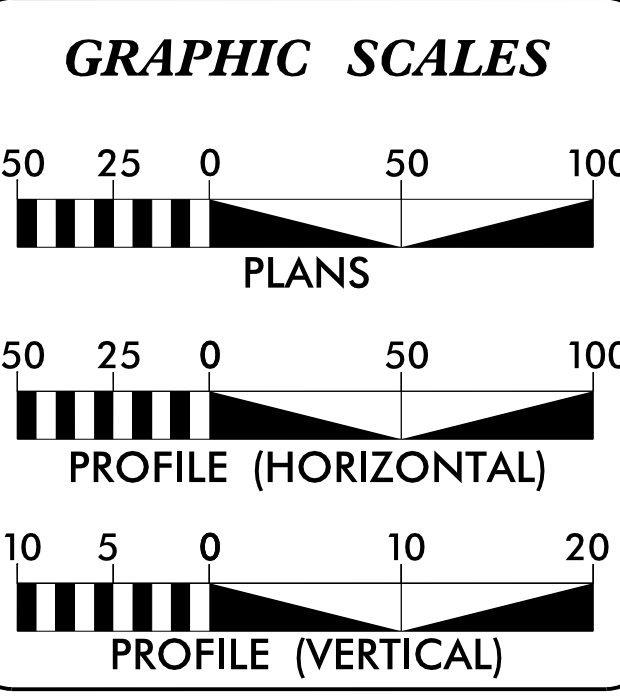

DESIGN DATA

ADT 2025 =	24,800
ADT 2039 =	26,200
K =	13 %
D =	50 %
T =	3 % *
V =	50 MPH
* TTST = 2% + DUALS 1%	
FUNC CLASS =	URBAN ARTERIAL

PROJECT LENGTH

LENGTH OF ROADWAY TIP PROJECT U-6011	=	0.192 MILES
TOTAL LENGTH OF TIP PROJECT U-6011	=	0.192 MILES

Prepared In the Office of:

PARSONS SUNGATE DESIGN GROUP, P.A.

2024 STANDARD SPECIFICATIONS

RIGHT OF WAY DATE:
OCTOBER 12, 2021

LETTING DATE:
APRIL 15, 2025

AYMAN I. ALQUDWAH, PE
PROJECT ENGINEER

DAVID GARRETT
PROJECT DESIGN ENGINEER

BRIAN KETNER, PE
NCDOT CONTACT

HYDRAULICS ENGINEER

ROADWAY DESIGN ENGINEER

Signed by: *Josh Dalton* P.E. 1/23/2025

Signed by: *Ayman Alqudwah* P.E. 1/23/2025

