

PROJECT REFERENCE NO.	SHEET NO.
U-4405B	EC-19/CONST.13
RW SHEET NO.	
ROADWAY DESIGN ENGINEER	HYDRAULICS ENGINEER

-L-
 Pts Sta 139+95.56 PI Sta 144+71.01
 $\Theta_s = 1^{\circ} 43' 07.9''$ $\Delta = 19^{\circ} 18' 58.8''$ (RT)
 $L_s = 150.00'$ $D = 2^{\circ} 17' 30.6''$
 $LT = 100.00'$ $L = 842.83'$
 $ST = 50.00'$ $T = 425.45'$
 $R = 2,500.00'$
 $SE = 0.03$

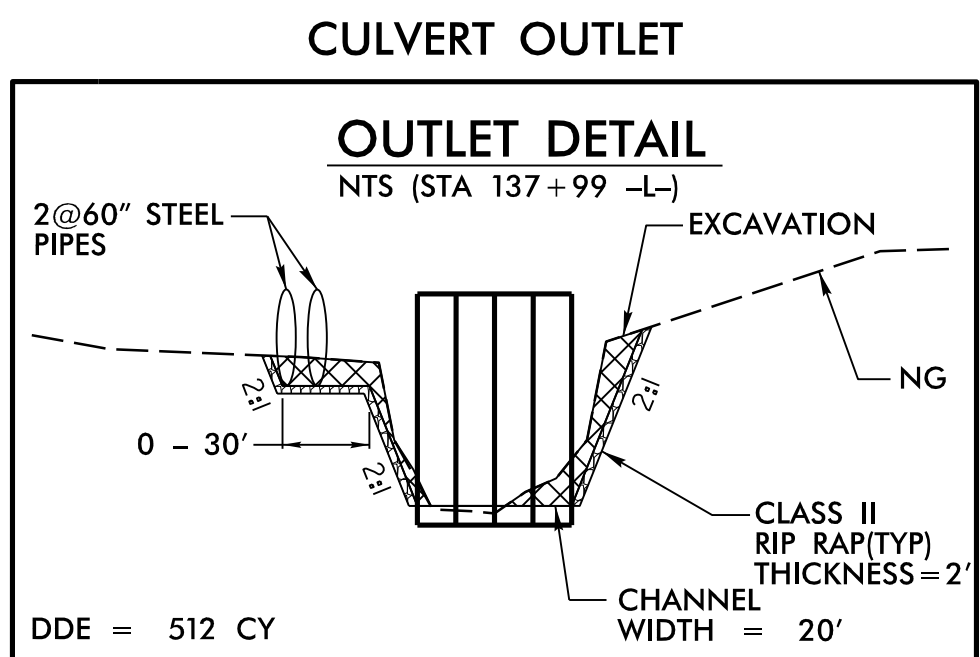

INSTALL FABRIC INSERT INLET PROTECTION DEVICE IN LIEU OF ROCK INLET SEDIMENT TRAP TYPE 'C' AS DIRECTED TO AVOID PONDING OF RUNOFF IN ROADWAY OPEN TO PUBLIC TRAFFIC

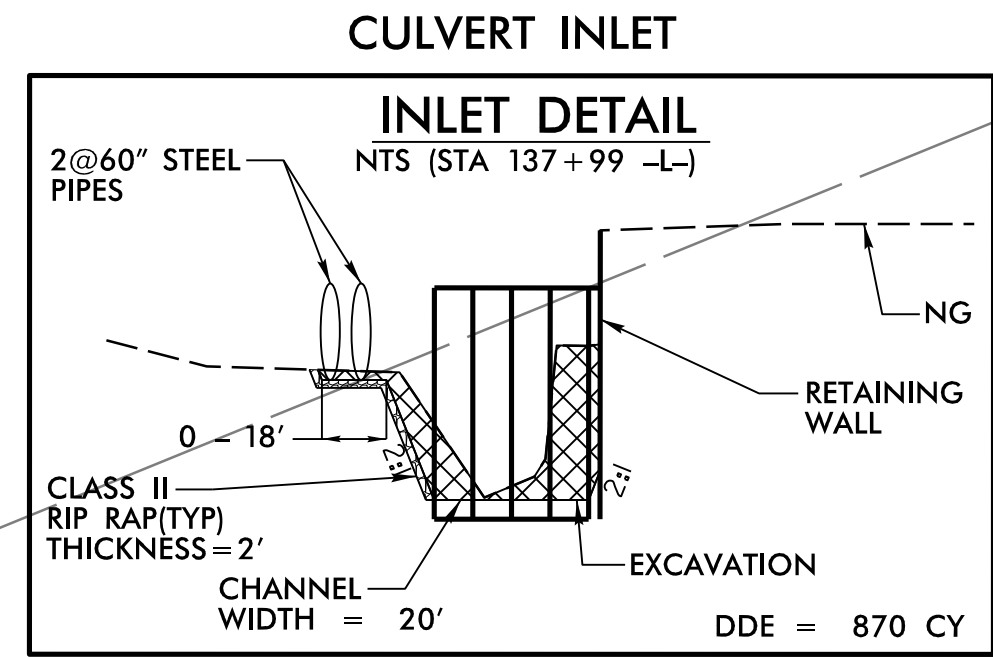
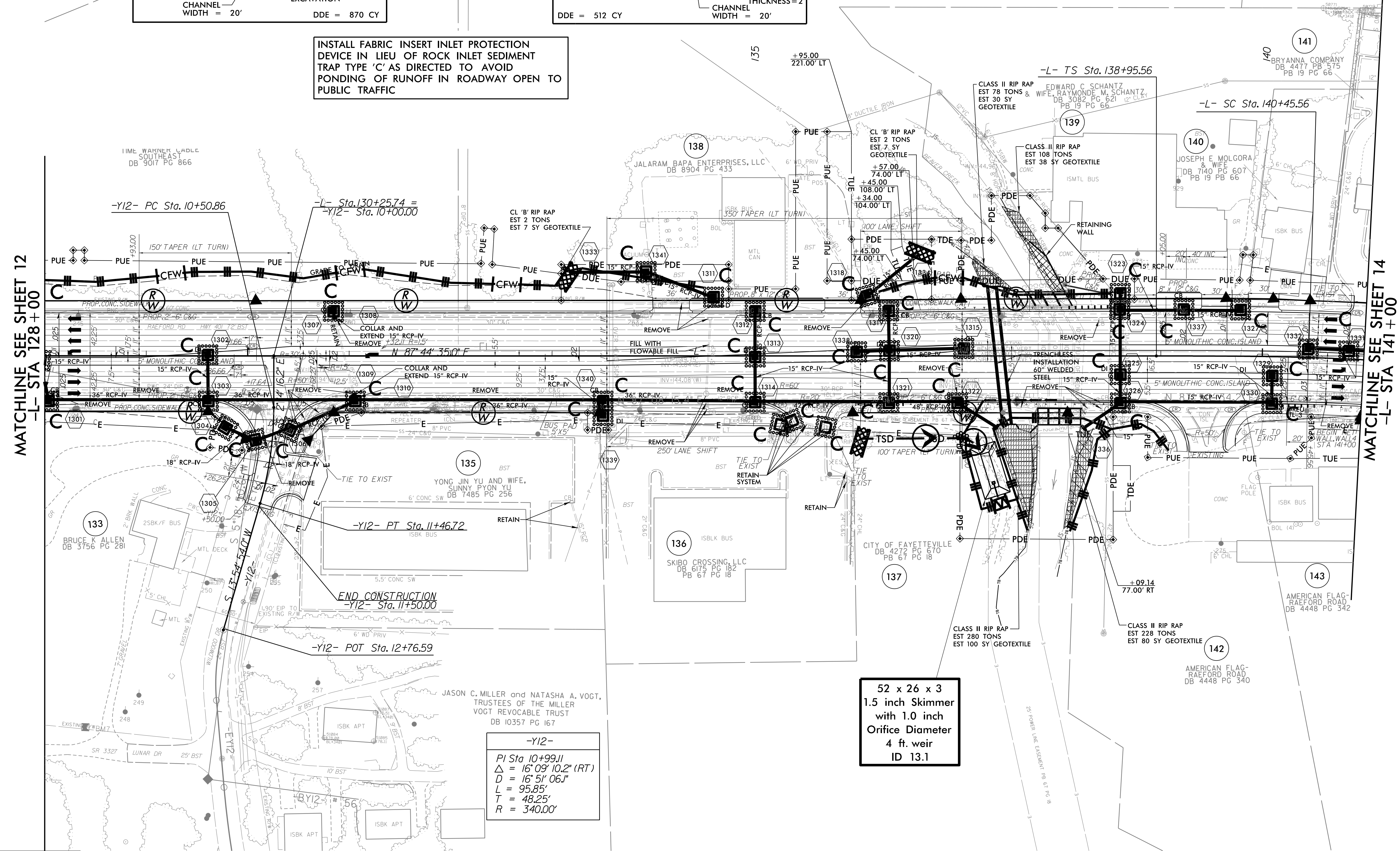
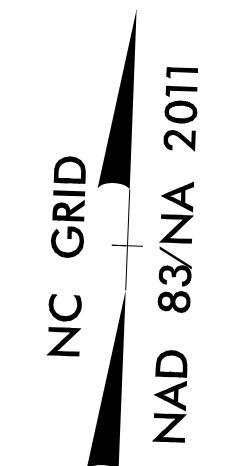

MATCHLINE SEE SHEET 12 -L- STA 128+00

MATCHLINE SEE SHEET 14 -L- STA 141+00

-Y12-
 PI Sta 10+99.11
 $\Delta = 16^{\circ} 09' 10.2''$ (RT)
 $D = 16^{\circ} 51' 06.1''$
 $L = 95.85'$
 $T = 48.25'$
 $R = 340.00'$

52 x 26 x 3
 1.5 inch Skimmer
 with 1.0 inch
 Orifice Diameter
 4 ft. weir
 ID 13.1

NOTE: SEE SHEET 37 FOR -L- PROFILE
 SEE SHEET 47 FOR -Y12- PROFILE

REVISIONS

10/8/2024 10:44:05_REU_EC_psh_13_Final.dgn 8/17/99

** A DESIGN EXCEPTION FOR LANE WIDTH IS REQUIRED FOR -L- STA. 38+95.00 TO -L- 319+95.00