

PROJECT REFERENCE NO.	SHEET NO.
U-4405B	EC-13/CONST.18
RW SHEET NO.	
ROADWAY DESIGN ENGINEER	HYDRAULICS ENGINEER

CLEARING AND GRUBBING  
EROSION CONTROL FOR  
CONSTRUCTION SHEET 18

INSTALL FABRIC INSERT INLET PROTECTION  
DEVICE IN LIEU OF ROCK INLET SEDIMENT  
TRAP TYPE 'C' AS DIRECTED TO AVOID  
PONDING OF RUNOFF IN ROADWAY OPEN TO  
PUBLIC TRAFFIC

NOTE:  
PLACE TEMPORARY ROCK SEDIMENT DAMS TYPE - B  
AND TEMPORARY ROCK SILT CHECKS TYPE - A AT  
DRAINAGE OUTLETS.

NC GRID  
NAD 83/NA 2011

MATCHLINE SEE SHEET 17  
-L- STA 193+00

MATCHLINE SEE SHEET 19  
-L- STA 205+00

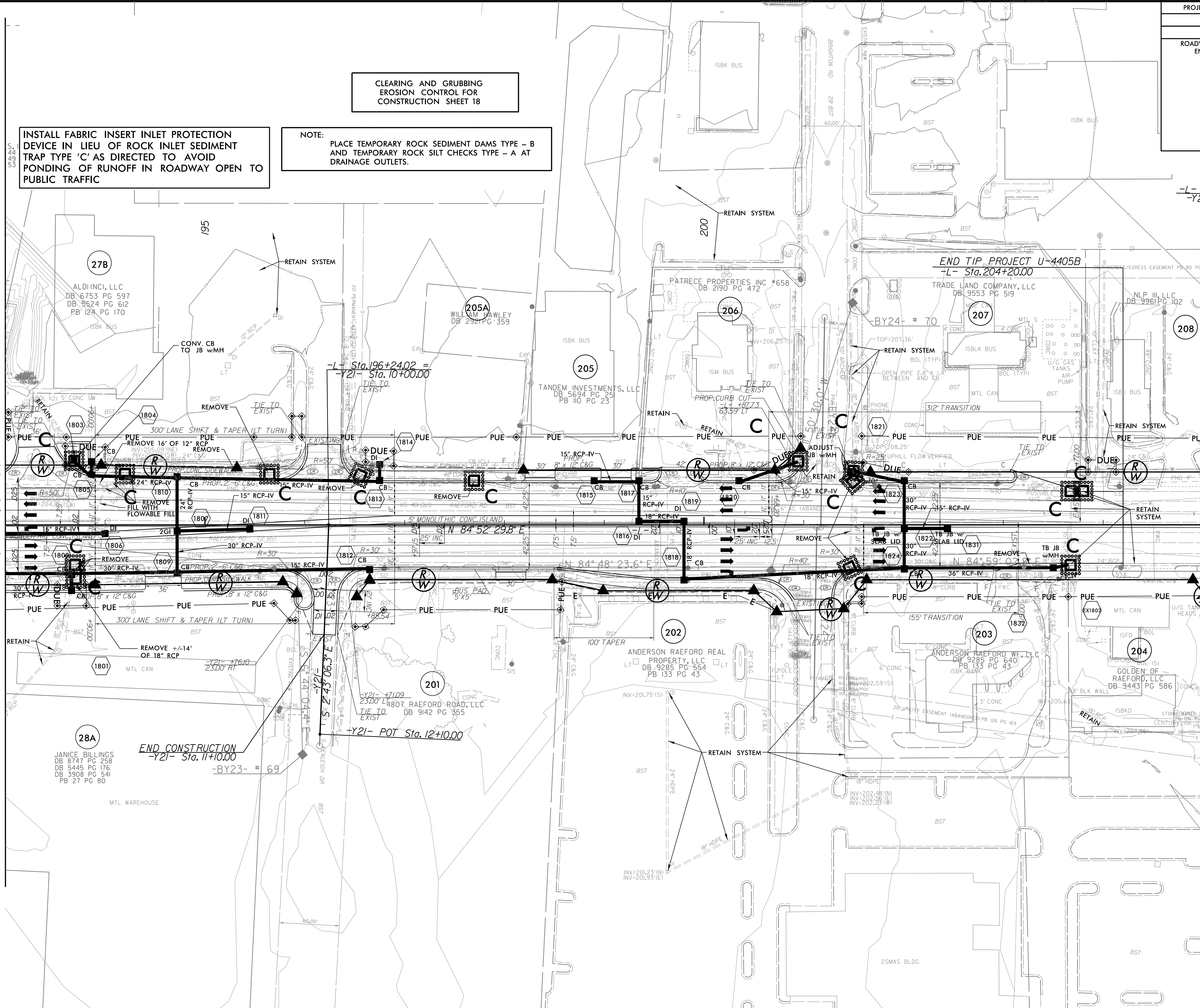

REVISIONS

★ PROPOSED SIGNAL

■ PROP CONC SIDEWALK

\*\* A DESIGN EXCEPTION FOR LANE WIDTH IS  
REQUIRED FOR -L- STA. 38+95.00 TO -L- 319+95.00

NOTE: SEE SHEET 39 FOR -L- PROFILE  
SEE SHEET 48 FOR -Y21- PROFILE

8/17/99

10/8/2024  
U-4405B\_REU\_EC\_psh\_18\_CG.dgn  
18/08/2024