

PLAN OF WING (W3)

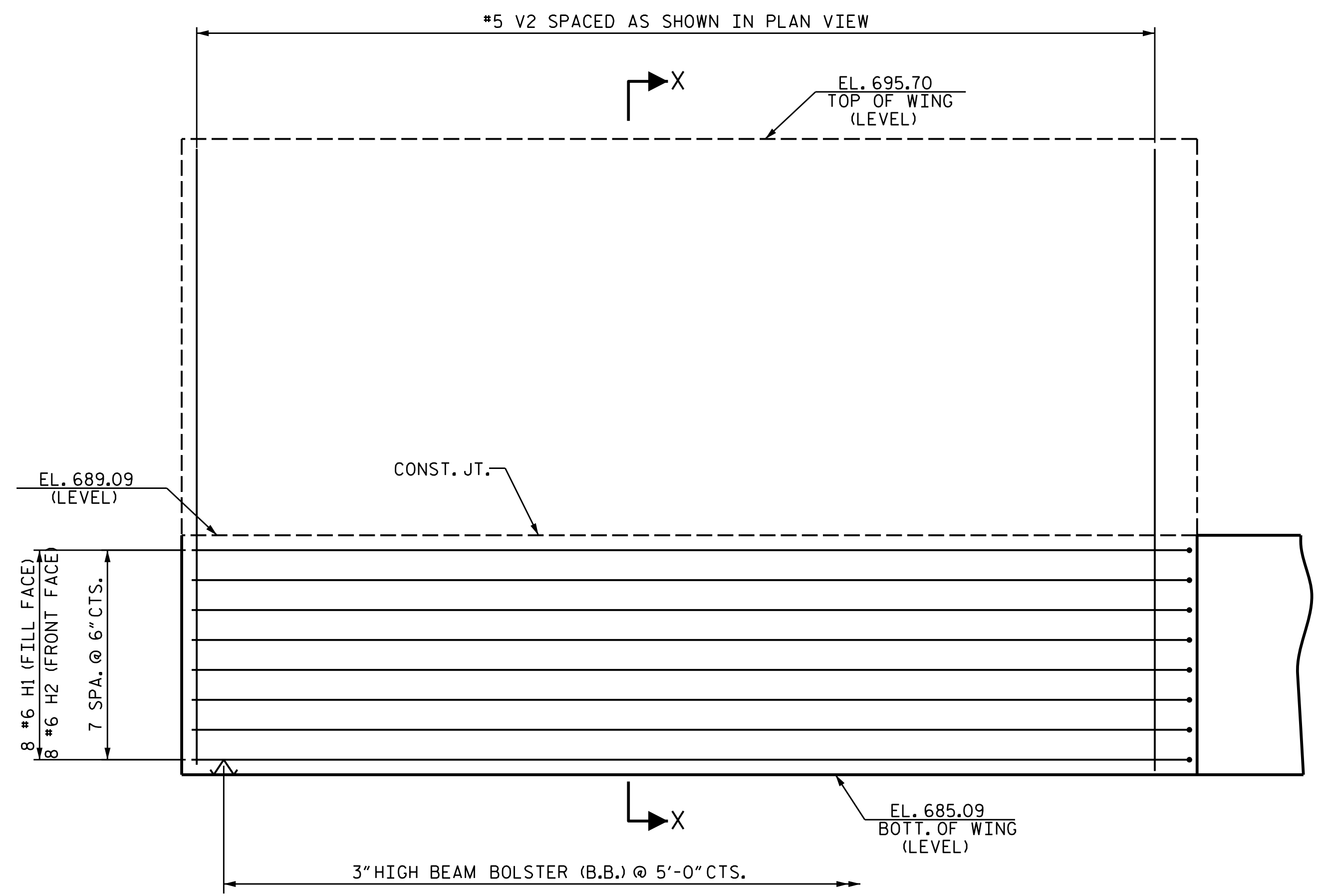

ELEVATION OF WING (W3)

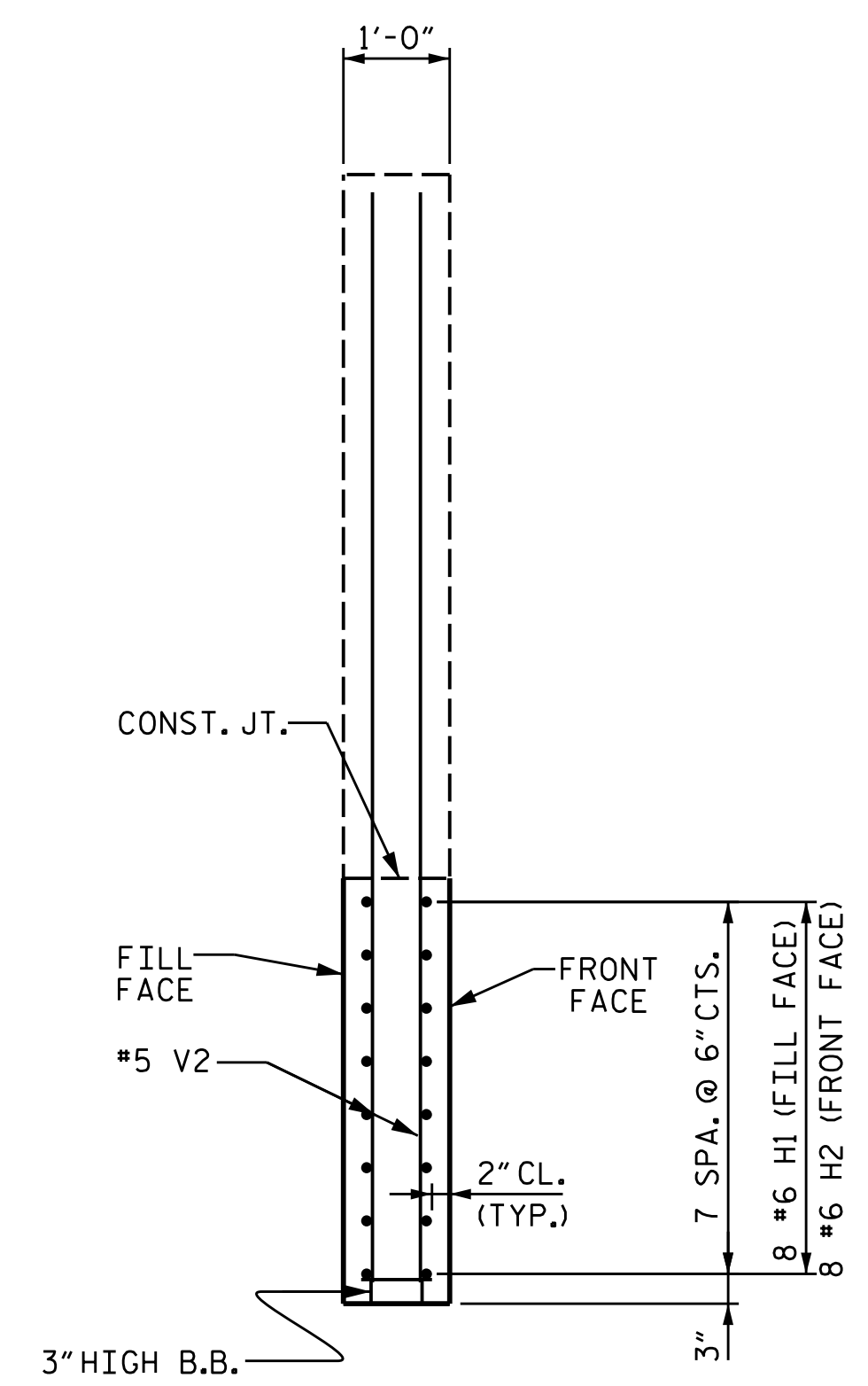

SECTION X-X

NOTE: FOR UPPER PART OF WING DETAILS AND REINFORCING STEEL, SEE "SUPERSTRUCTURE PLAN OF SPANS DETAILS".

PROJECT NO. B-5845

CLEVELAND COUNTY

STATION: 22+56.00-L-

SHEET 2 OF 4

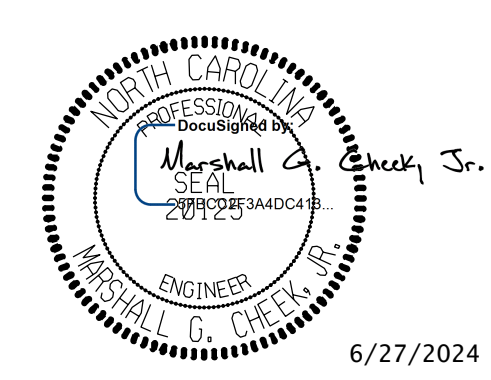

STATE OF NORTH CAROLINA
DEPARTMENT OF TRANSPORTATION
RALEIGH
SUBSTRUCTURE
INTEGRAL
END BENT 2
WING DETAILS

DOCUMENT NOT CONSIDERED FINAL
UNLESS ALL SIGNATURES COMPLETED
TGS ENGINEERS
201 W. MARION ST STE 200
SHELBY, NC 28150
PH (704) 476-0003
CORP. LICENSE NO.: C-0275

REVISIONS					
NO.	BY:	DATE:	NO.	BY:	DATE:
1			3		
2			4		

SHEET NO.
S-35
TOTAL SHEETS
40

DRAWN BY : NMW DATE : 9/21
CHECKED BY : MGC DATE : 5/22
DESIGN ENGINEER OF RECORD : ZCS DATE : 3/23