

Cleveland County
Bridge #25

PROJECT REFERENCE NO. B-5845	SHEET NO. EC-06/CONST.4
ROADWAY DESIGN ENGINEER	HYDRAULICS ENGINEER
TGS ENGINEERS 201 W. MARION ST. STE 200 SHELBY, NC 28150 PH (704) 476-0003 CORP. LICENSE NO.: C-0275	

For Slopes Excavated Greater Than 10 feet
Install Matting for Erosion Control on
Entire Slope as Work Allows.

Place Matting for Erosion Control
on Slopes Adjacent to Permitted
Wetlands as Work Allows.

IN LIEU OF ROCK INLET SEDIMENT TRAP TYPE C,
UTILIZE FABRIC INSERT INLET PROTECTION
DEVICES IN AREAS WHERE WATER MAY
POND ON ROAD OPEN TO LIVE TRAFFIC.

NAD 83/2011

PLACE COIR FIBER MATTING ON
EXPOSED SOIL UNDER BRIDGE WHICH
WILL NOT BE PLATED WITH STONE.

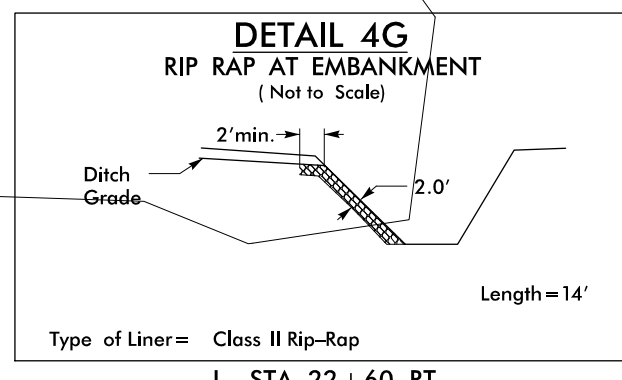
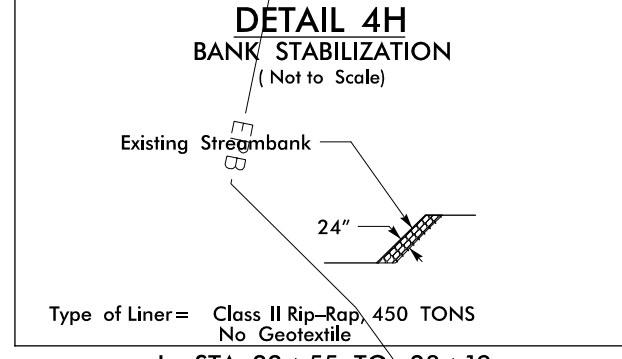
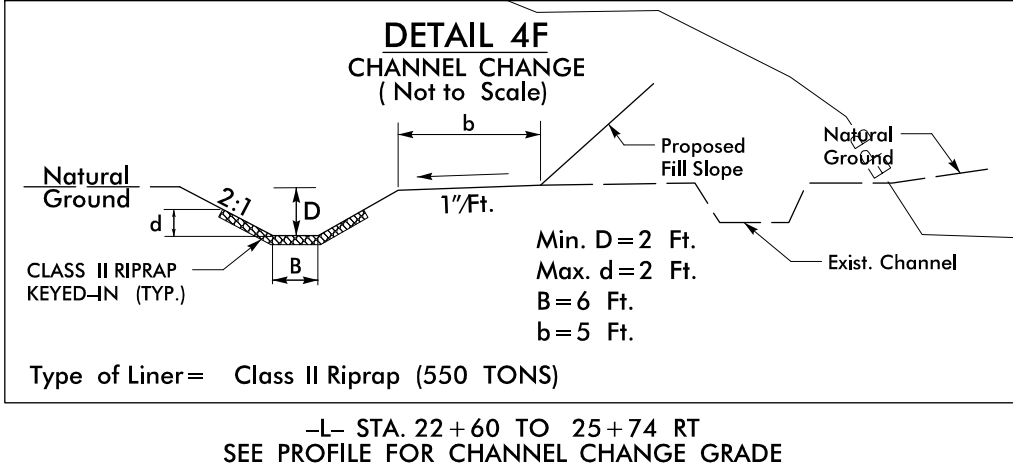
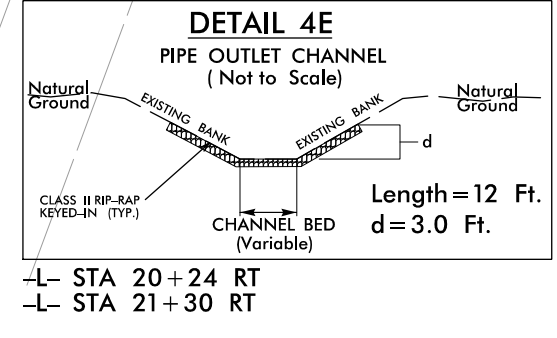
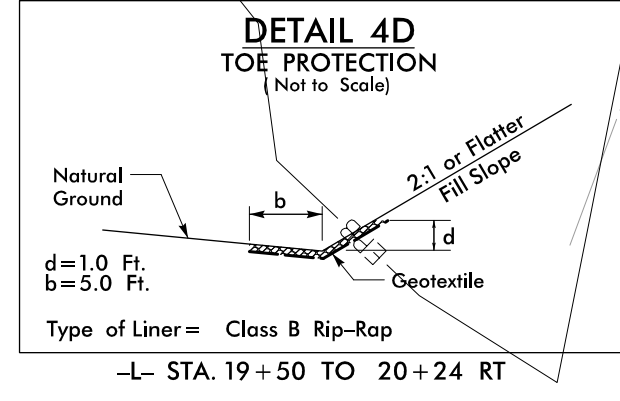
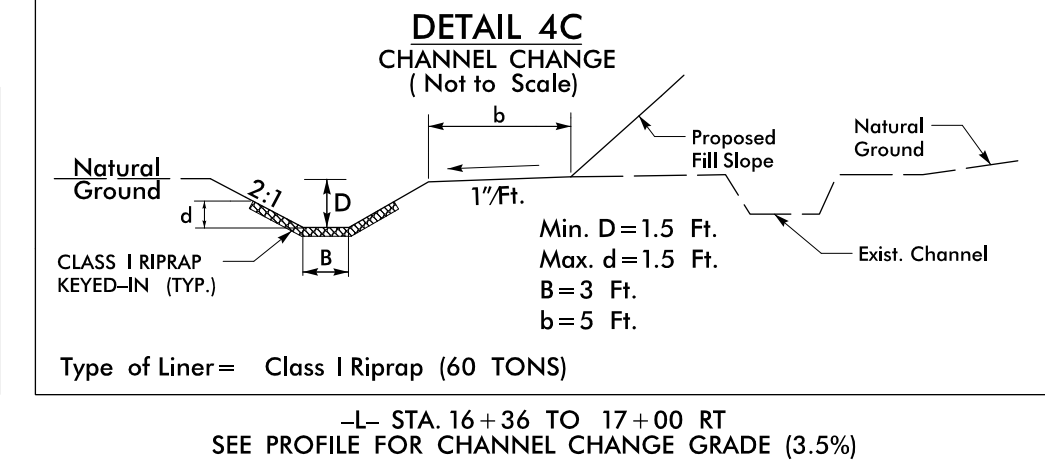
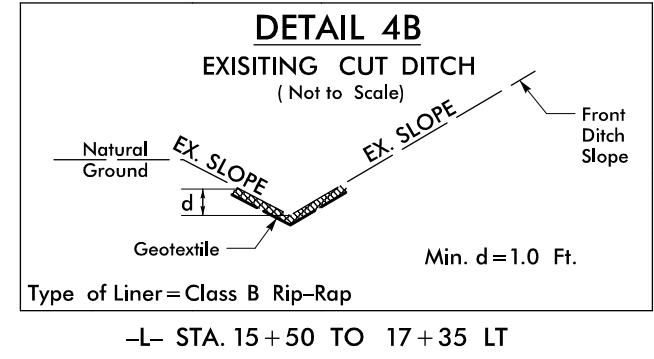
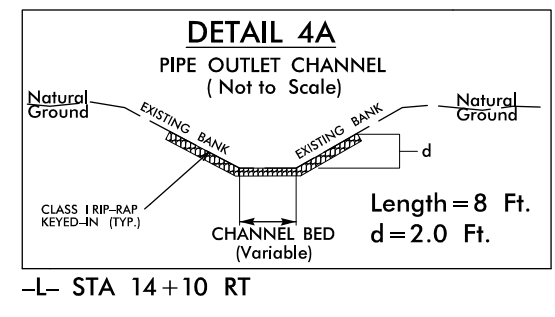
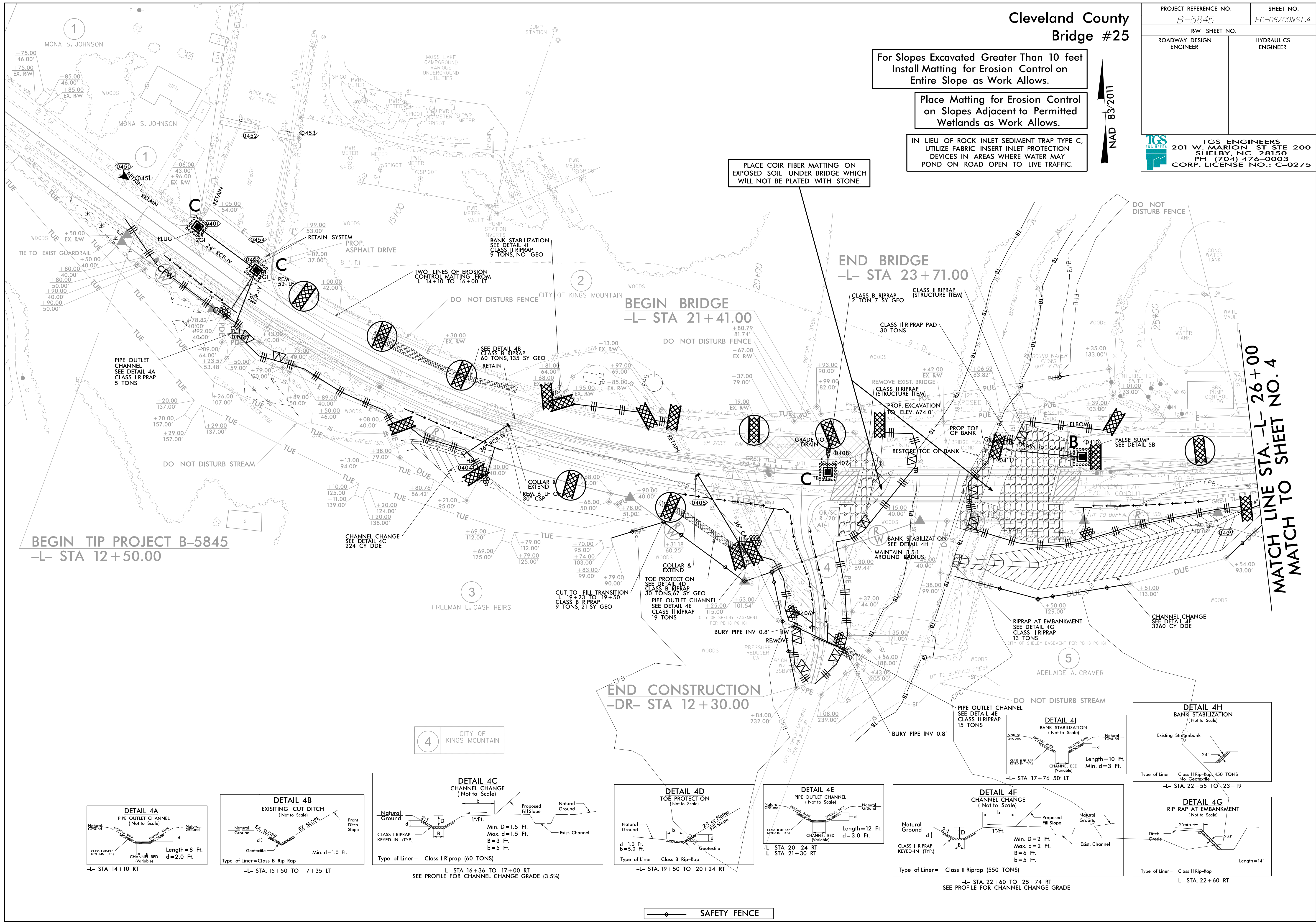

SAFETY FENCE

MATCH LINE STA. -L- 26+00
MATCH TO SHEET NO. 4