

UTILITIES BY OTHERS

BM*6 ELEVATION = 445.84'
 N 728.259 E 1.955.699
 BL STATION 84+67.9, 331.0' LEFT
 L STATION 91+56.97, 375.34' LEFT
 RAILROAD SPIKE IN 13'OAK

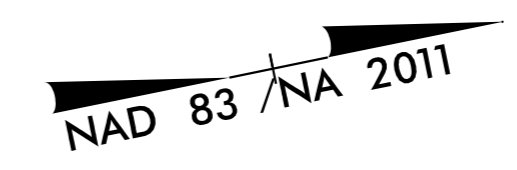

NOTE:
 ALL PROPOSED UTILITY WORK SHOWN ON THIS SHEET WILL BE DONE BY OTHERS. NO PAYMENT WILL BE MADE TO THE CONTRACTOR FOR PROPOSED UTILITY WORK SHOWN ON THIS SHEET.

WYWUSA SPE LLC
 DB 2391 PG 836
 PB 2022 PG 37
 PB 2001 PG 223

WYWUSA SPE LLC
 DB 2391 PG 836
 PB 2022 PG 37
 PB 2001 PG 223

WYWUSA SPE LLC
 DB 2391 PG 836
 PB 2022 PG 37
 PB 2001 PG 223

WYWUSA SPE LLC
 DB 2391 PG 836
 PB 2022 PG 37
 PB 2001 PG 223

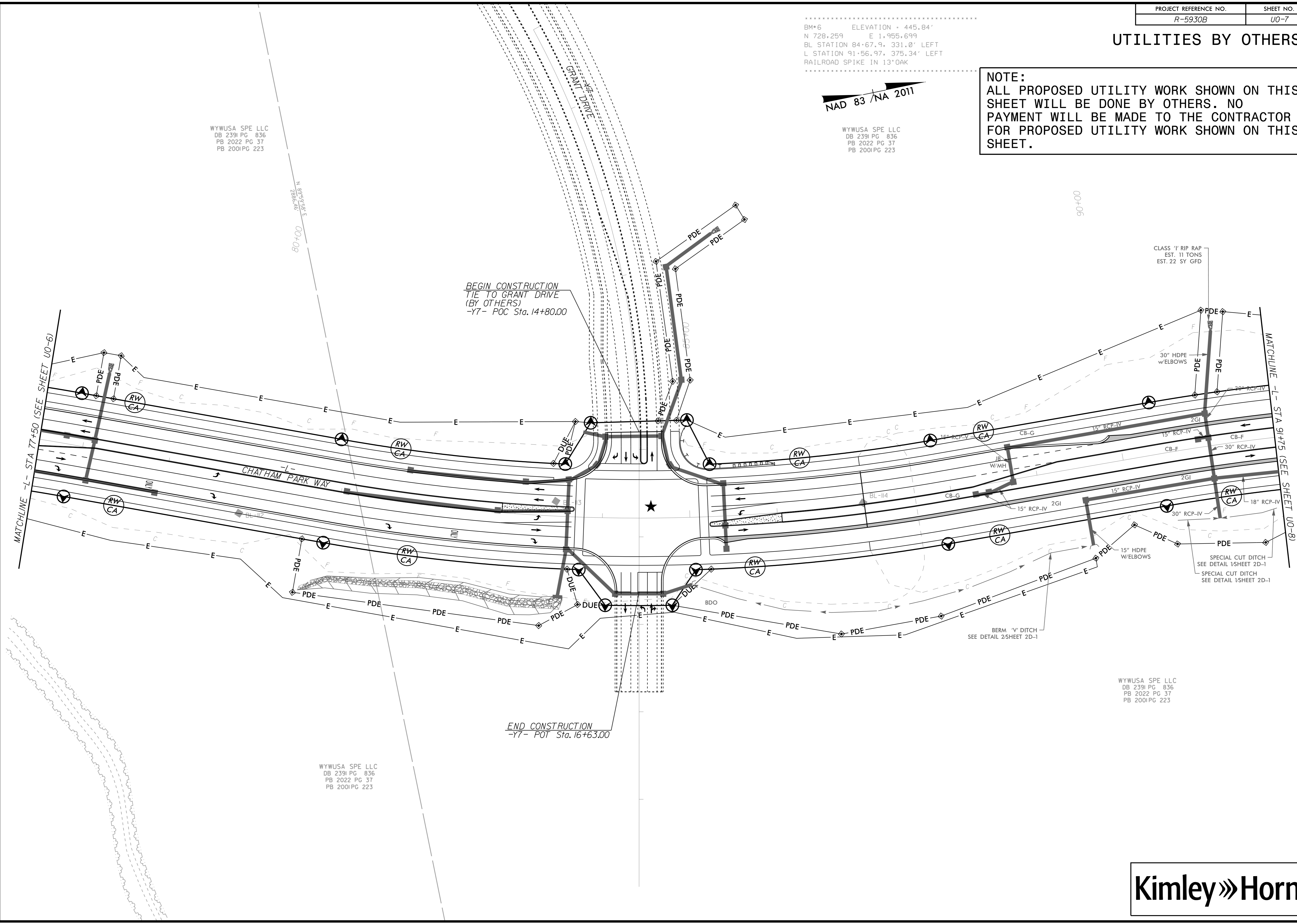

K:\RAL_Roadway\01036532 - R-5930 North CPW Utilities\BOP\Pro\AR-5930_u0-7.dgn

12/9/2024

