

SURVEY CONTROL SHEET

W/ EXISTING CENTERLINE ALIGNMENTS PRIOR TO CONSTRUCTION

PROJECT REFERENCE NO. R-5930	SHEET NO. RW02C-3
Location and Surveys	
NV5	
<small>NVS ENGINEERS & CONSULTANTS, INC. 6750 TRYON ROAD CARY, NC 27518 P: 919.851.1912 www.NV5.com NC License # F-1333 Formerly C&A/C Engineers & Consultants</small>	
PROJECT SURVEYOR	
DOCUMENT NOT CONSIDERED FINAL UNLESS ALL SIGNATURES COMPLETED	

REVISIONS

MATCHLINE RW02C-2

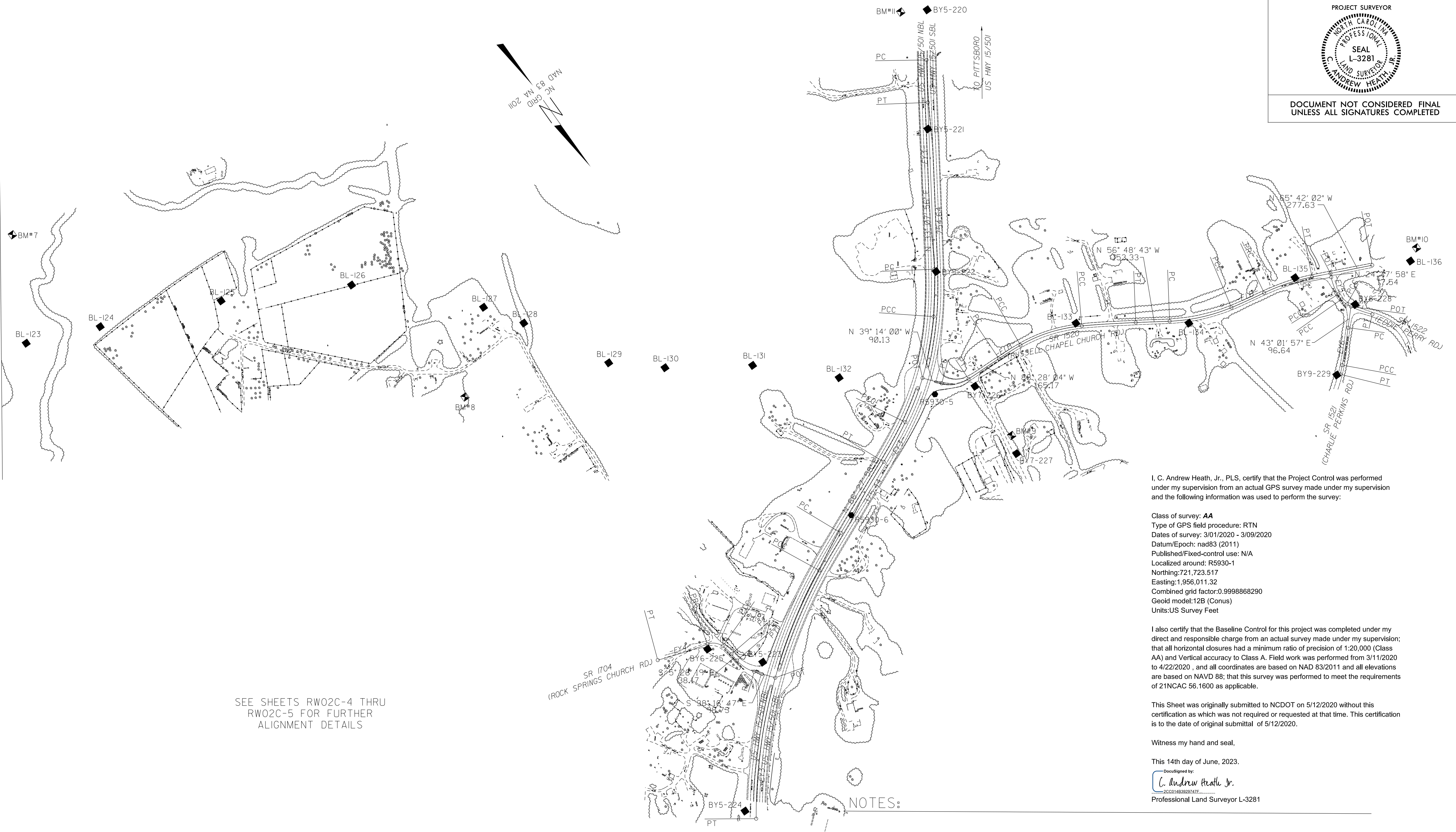

SEE SHEETS RW02C-4 THRU RW02C-5 FOR FURTHER ALIGNMENT DETAILS

I, C. Andrew Heath, Jr., PLS, certify that the Project Control was performed under my supervision from an actual GPS survey made under my supervision and the following information was used to perform the survey:

Class of survey: **AA**
 Type of GPS field procedure: RTN
 Dates of survey: 3/01/2020 - 3/09/2020
 Datum/Epoch: nad83 (2011)
 Published/Fixed-control use: N/A
 Localized around: R5930-1
 Northing: 721,723.517
 Easting: 1,956,011.32
 Combined grid factor: 0.9998868290
 Geoid model: 12B (Conus)
 Units: US Survey Feet

I also certify that the Baseline Control for this project was completed under my direct and responsible charge from an actual survey made under my supervision; that all horizontal closures had a minimum ratio of precision of 1:20,000 (Class AA) and Vertical accuracy to Class A. Field work was performed from 3/11/2020 to 4/22/2020, and all coordinates are based on NAD 83/2011 and all elevations are based on NAVD 88; that this survey was performed to meet the requirements of 21NCAC 56.1600 as applicable.

This Sheet was originally submitted to NCDOT on 5/12/2020 without this certification as which was not required or requested at that time. This certification is to the date of original submittal of 5/12/2020.

Witness my hand and seal,

This 14th day of June, 2023.

DocuSigned by:

 202301483828747E
 Professional Land Surveyor L-3281

NOTES:

- PROJECT CONTROL WAS ESTABLISHED USING GNSS, THE GLOBAL NAVIGATION SATELLITE SYSTEM.
- THE SURVEY CONTROL DATA FOR THIS PROJECT HAS BEEN COMPILED FROM VARIOUS SOURCES. IF FURTHER INFORMATION REGARDING PROJECT CONTROL IS NEEDED, PLEASE CONTACT THE LOCATION AND SURVEYS UNIT.