

T.I.P.: BR-0100

CONTRACT: C204883

I:\21\2024  
4:\30\0678R\BR-0100\BR-0100\_Traffic\Signing\CA00\Signing\_Layout\Plans\BR-0100\_sgn\_tsh.dgn  
USEB04421

STATE OF NORTH CAROLINA  
DEPARTMENT OF TRANSPORTATION

SIGNING PLAN  
RUTHERFORD COUNTY

LOCATION: BRIDGE No. 40 ON NC 226 OVER NORTH FORK  
FIRST BROAD CREEK

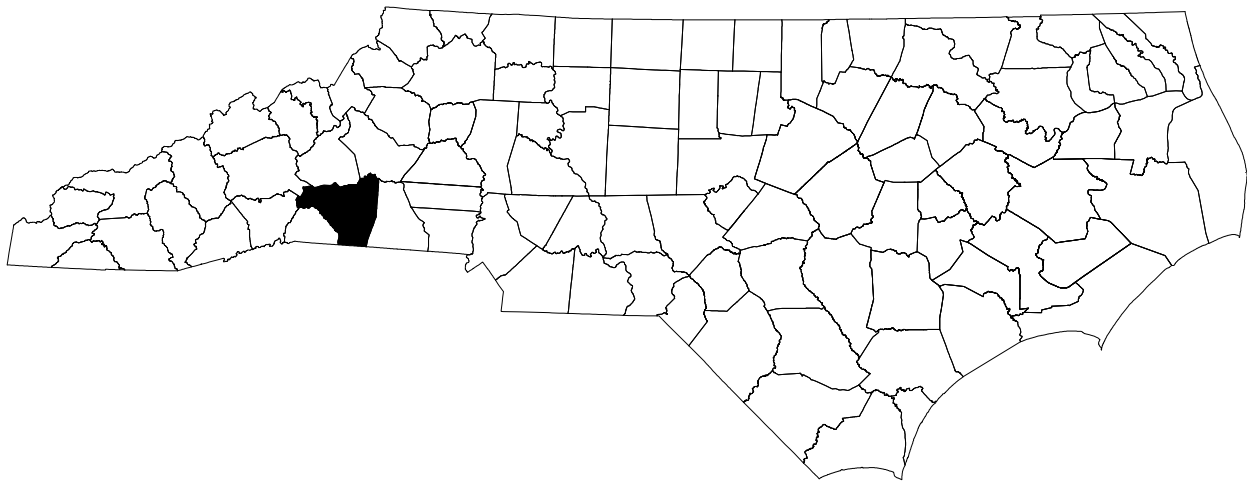

INDEX

SHEET NO.	DESCRIPTION
SIGN-1	TITLE SHEET, GENERAL NOTES & ROADWAY STANDARD DRAWINGS
SIGN-2	EXISTING SIGNING PLAN SHEET
SIGN-3	PROPOSED SIGNING PLAN SHEET

ROADWAY STANDARD DRAWING

THE FOLLOWING ROADWAY STANDARDS AS APPEAR IN "ROADWAY STANDARD DRAWINGS" - N.C. DEPARTMENT OF TRANSPORTATION - RALEIGH, N.C., DATED JANUARY 2024 ARE APPLICABLE TO THIS PROJECT AND BY REFERENCE HEREBY ARE CONSIDERED A PART OF THESE PLANS:

STD. NO.	TITLE
904.10	ORIENTATION OF GROUND MOUNTED SIGNS
904.50	MOUNTING OF TYPE 'D', 'E' AND 'F' SIGNS ON 'U' CHANNEL POSTS

GENERAL NOTES

- . SIGNS FURNISHED BY STATE
- . CONFIRM IN WRITING AT LEAST 4 MONTHS IN ADVANCE, THE ACTUAL DATE THE DEPARTMENT FURNISHED SIGNS WILL BE REQUIRED.
- . ALL TYPE 'D' SIGNS SHALL BE MOUNTED ON TWO U-CHANNEL POSTS UNLESS OTHERWISE INDICATED ON THE PLANS.
- . IF REMOVAL OR RELOCATION OF SIGNS ON PRIVATE STREET (NON-STATE MAINTAINED) IS REQUIRED DUE TO CONSTRUCTION, THE CONTRACTOR SHALL INFORM THE ENGINEER. THE WORK WILL BE COMPLETED BY OTHERS.
- . WHEN NOT STATIONED OR DIMENSIONED ON PLANS, ALL 'E' AND 'F' SIGNS SHALL BE FIELD LOCATED BY THE ENGINEER
- . ALL EXISTING SIGNS ON "U" CHANNEL POST WITHIN THE PROJECT LIMITS SHALL BE REMOVED AND DISPOSED OF UNLESS OTHERWISE NOTED ON PLANS.
- . WHEN EXISTING SIGNS ARE REMOVED AND INSTALLED ON NEW SUPPORTS, THE RE-ERECTION SHALL IMMEDIATELY FOLLOW THE REMOVAL.
- . THE BACKGROUND FOR TYPE E & F SIGNS SHALL BE TYPE C REFLECTIVE SHEETING.
- . SEE ROADWAY PLANS FOR GUARD/GUIDE RAIL DETAILS.

SUMMARY OF QUANTITIES

ITEM NO.		ITEM DESCRIPTION	QUANTITY	UNIT
DESC. NO.	SECT. NO.			
4072000000	903	SUPPORTS, 3 LB STEEL U-CHANNEL	90	LF
4102000000	904	SIGN ERECTION, TYPE E	4	EA
4116100000	904	SIGN ERECTION, RELOCATE SIGN TYPE D	2	EA
4155000000	907	DISPOSAL OF SIGN SYSTEM, U-CHANNEL	4	EA
4192000000	907	DISPOSAL OF SUPPORT, U-CHANNEL	2	EA
4237000000	907	STOCKPILE SIGN, TYPE D	2	EA



WSP USA Inc.  
434 FAYETTEVILLE STREET  
SUITE 1500  
RALEIGH, NC 27601  
NC LIC. NO. F-0165

PLAN PREPARED BY:

ERIC W BOWMAN, PE SR. TRANSPORTATION DESIGNER  
SAYMA AFREEN TRANSPORATION DESIGNER

TIP NO.	SHEET NO.
BR - 0100	SIGN - 1
APPROVED: <div>Signed by: Eric W Bowman DADA2D5C9B0246F...</div>	
DATE: 12/17/2024	
SEAL <div>Professional Engineer Seal Eric W. Bowman 043754</div>	
DOCUMENT NOT CONSIDERED FINAL UNLESS ALL SIGNATURES COMPLETED	

TIP NO.	SHEET NO.
BR-0100	SIGN-2
APPROVED: <div>Signed by: Eric W Bowman</div>	
DATE: 12/17/2024	
SEAL	
<div>Professional Engineer Seal: Eric W. Bowman, No. 043754, State of North Carolina</div>	
DOCUMENT NOT CONSIDERED FINAL UNLESS ALL SIGNATURES COMPLETED	

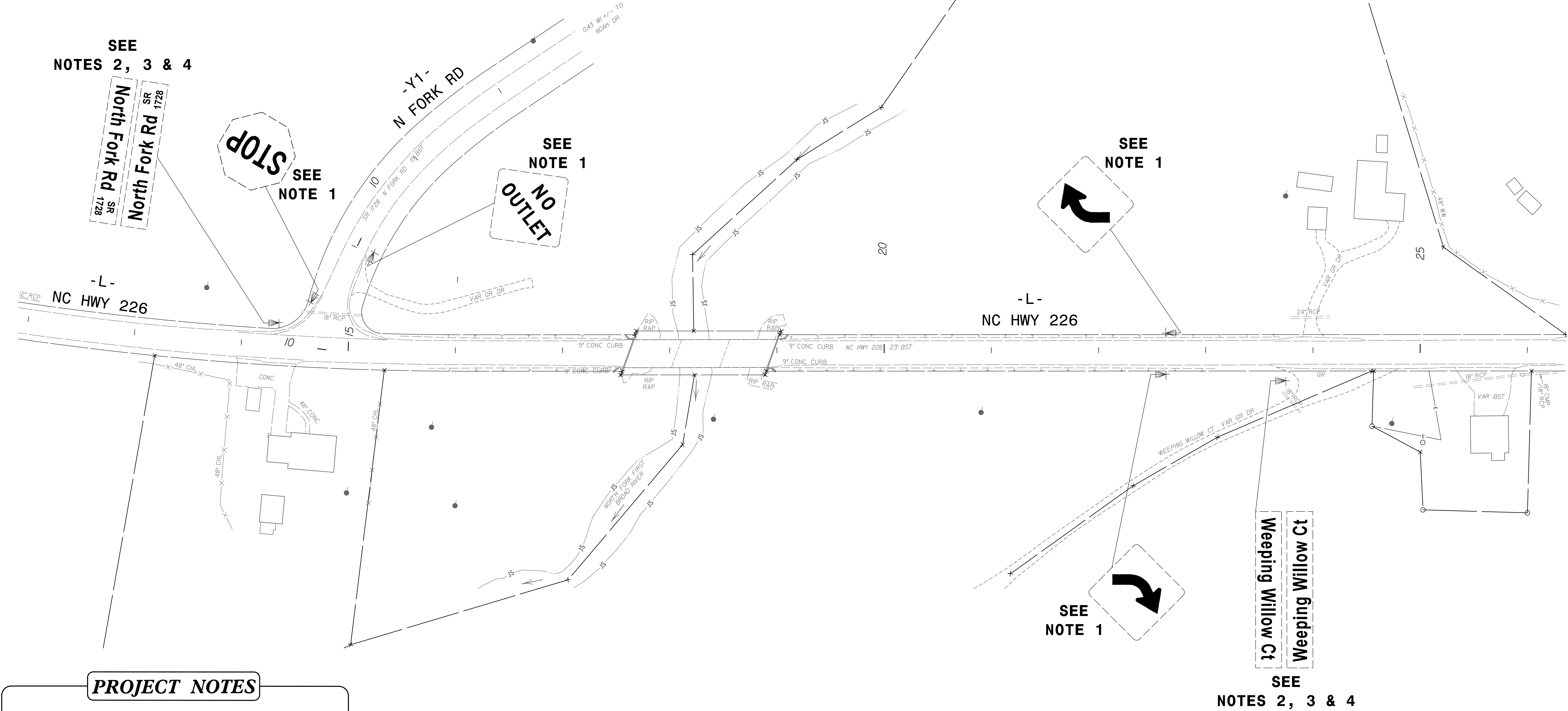

I:\21\2024\12\17\2024\BR-0100\BR-0100-Traffic\Signing\NCADD\Signing Layout Plans\BR-0100\_sgn\_psh\_existing.dgn  
Z:\0000678R\BR-0100\BR-0100-Traffic\Signing\NCADD\Signing Layout Plans\BR-0100\_sgn\_psh\_existing.dgn  
USEB04421

EXISTING SIGNING  
PLAN SHEET

TIP NO.  
BR-0100

SHEET NO.  
SIGN-3

Signed by:  
*Eric W Bowman*  
DADA2D3CB80246F

APPROVED:



DATE: 12/17/2024

SEAL

SEAL  
043754  
ENGINEER  
ERIC W. BOWMAN

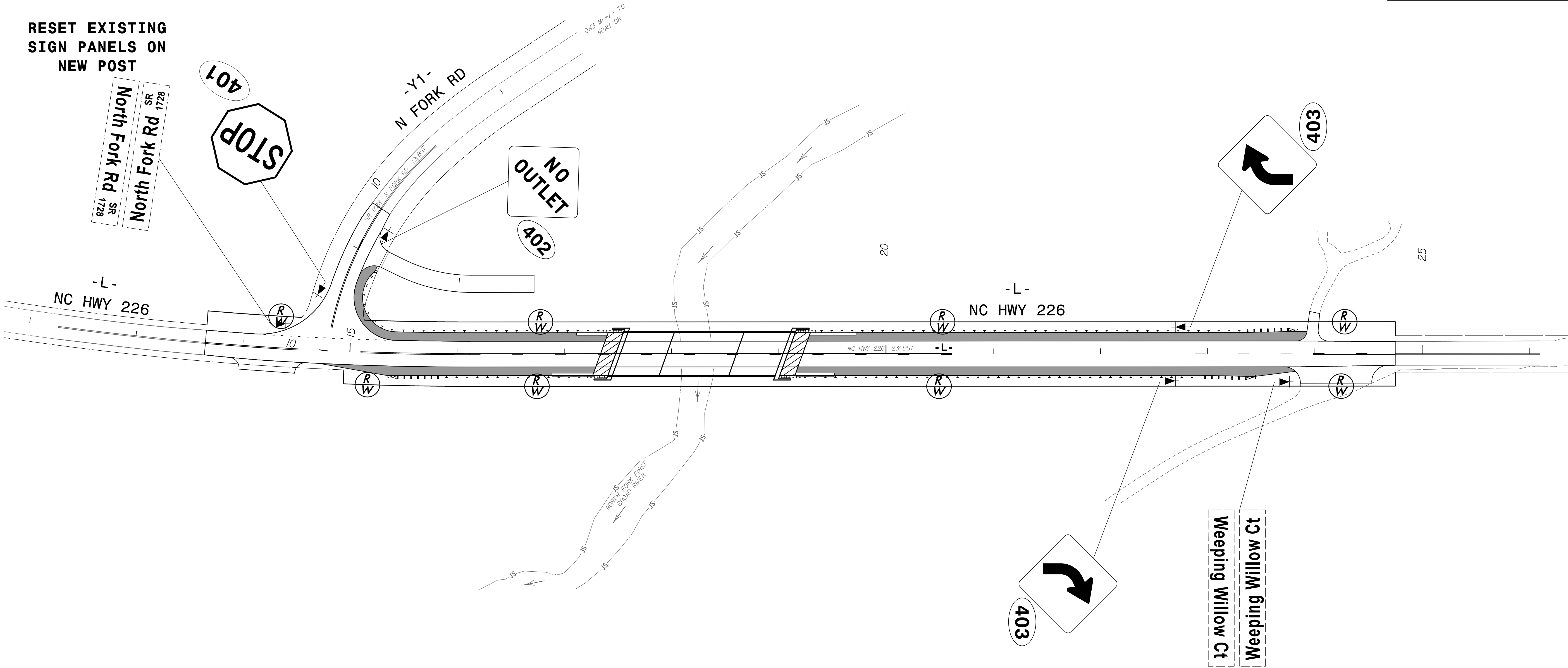
DOCUMENT NOT CONSIDERED FINAL  
UNLESS ALL SIGNATURES COMPLETED

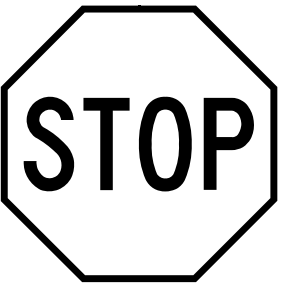

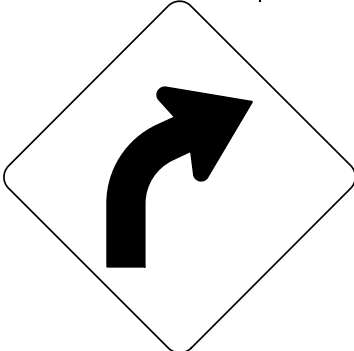
401 QUANTITY REQ'D 1	402 QUANTITY REQ'D 1	403 QUANTITY REQ'D 2
 30" X 30" R1-1	 30" X 30" W14-2	 30" X 30" W1-2R
ONE "U" POST PER SIGN	ONE "U" POST PER SIGN	ONE "U" POST PER SIGN

PROPOSED SIGNING  
PLAN SHEET

I:\21\2024  
Z:\3000678R\BR-0100\BR-0100\Traffic\Signing\CAADD\Signing Layout Plans\BR-0100\_sgn\_psh\_proposed.dgn  
USEB04421