

TIP PROJECT: BR-0100

See Sheet 1A For Index of Sheets
See Sheet 1B For Conventional Plan Sheet Symbols

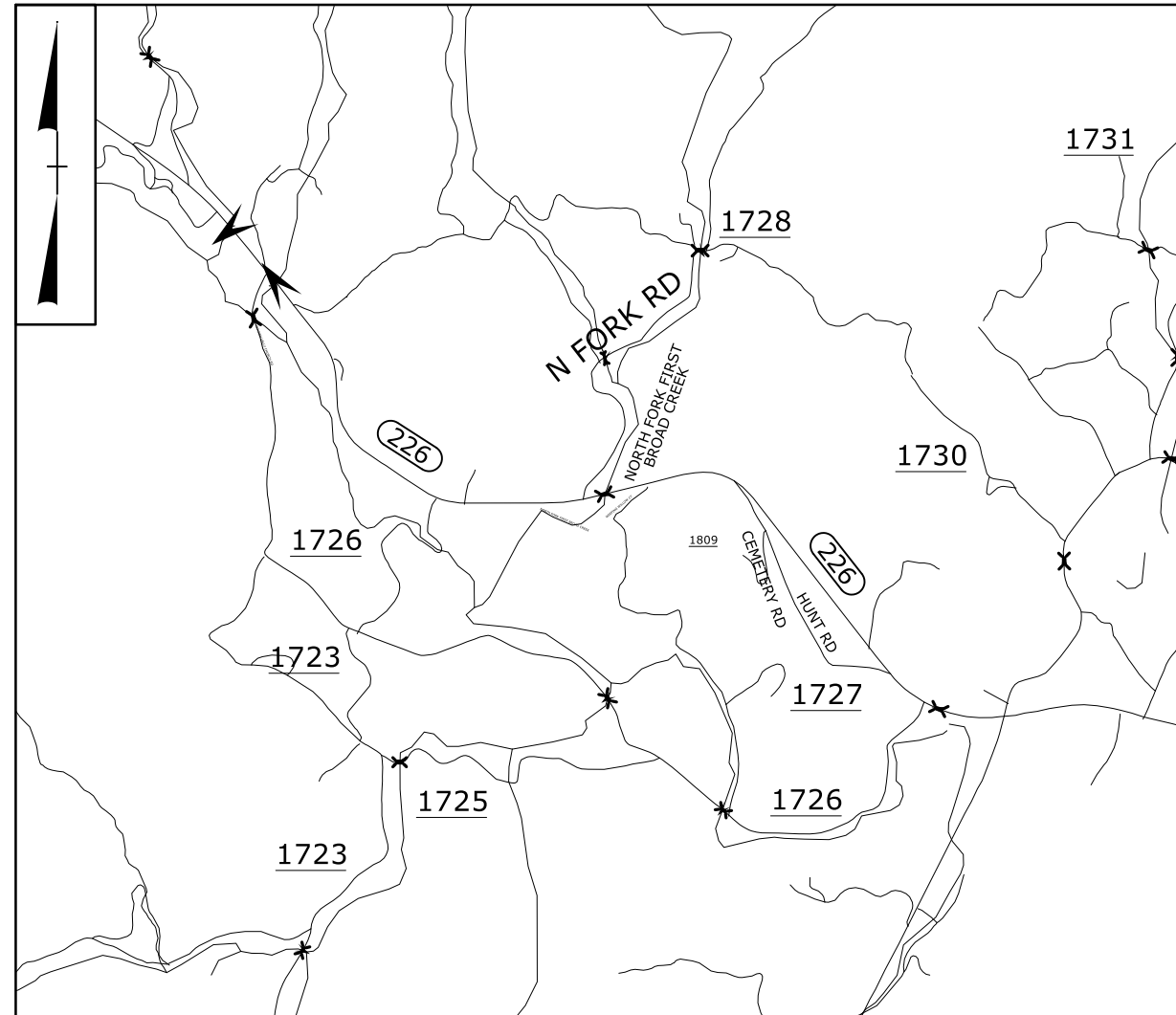

VICINITY MAP
NOT TO SCALE

STATE OF NORTH CAROLINA
DIVISION OF HIGHWAYS
PLAN FOR PROPOSED
HIGHWAY EROSION CONTROL
RUTHERFORD COUNTY

LOCATION: BRIDGE No. 40 ON NC 226 OVER NORTH FORK
FIRST BROAD CREEK

TYPE OF WORK: GRADING, PAVING, DRAINAGE, AND STRUCTURE

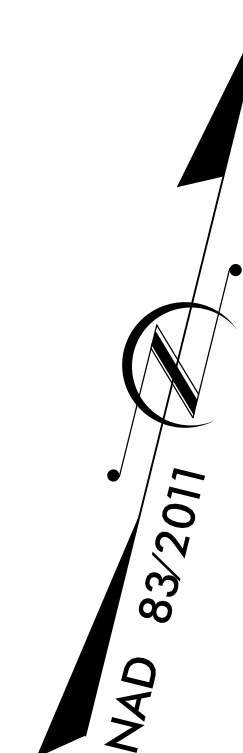

STATE	STATE PROJECT REFERENCE NO.	SHEET NO.	TOTAL SHEETS
N.C.	BR-0100	EC-1	12
STATE PROJ. NO.	F.A. PROJ. NO.	DESCRIPTION	
67100.1.1	N/A	PE	

HIGH QUALITY WATER(S) EXIST ON THIS PROJECT
High Quality Water Zone(s) Exist From Begin To End
Refer To E. C. Special Provisions for Special Considerations.

CLEARING ON THIS PROJECT SHALL BE PERFORMED TO THE LIMITS ESTABLISHED BY METHOD II .

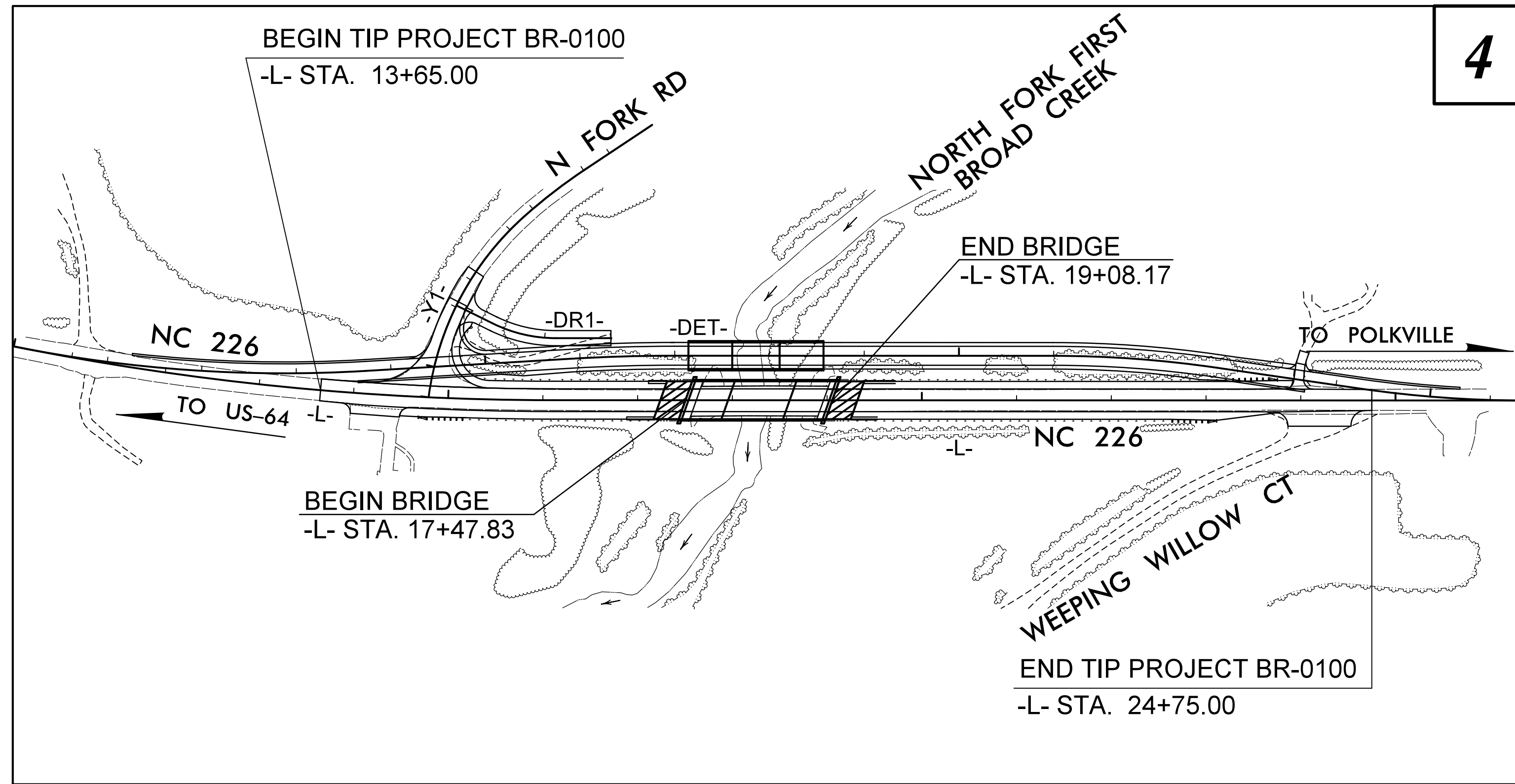

4

THIS PROJECT CONTAINS EROSION CONTROL PLANS FOR CLEARING AND GRUBBING PHASE OF CONSTRUCTION.

ENVIRONMENTALLY SENSITIVE AREA(S) EXIST ON THIS PROJECT

Refer To E. C. Special Provisions for Special Considerations.

THIS PROJECT HAS BEEN DESIGNED TO SENSITIVE WATERSHED STANDARDS.

GRAPHIC SCALE

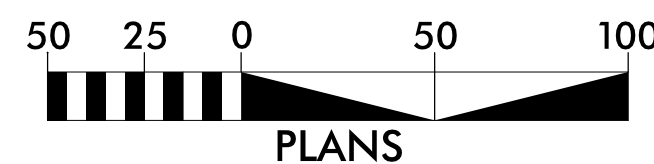

THESE EROSION AND SEDIMENT CONTROL PLANS COMPLY WITH THE REGULATIONS SET FORTH BY THE NCG-010000 GENERAL CONSTRUCTION PERMIT ISSUED BY THE NORTH CAROLINA DEPARTMENT OF ENVIRONMENTAL QUALITY DIVISION OF ENERGY, MINERAL, AND LAND RESOURCES.



Prepared In the Office of:

WSP

434 FAYETTEVILLE STREET
SUITE 1500
RALEIGH, NC 27601

LICENSE NO. F-0165

Designed by:

Victoria Fyfe

NAME

4319

LEVEL III CERTIFICATION NO.

Roadway Standard Drawings

The "Roadway Standard Drawings"- Roadway Design Unit - N. C. Department of Transportation - Raleigh, N. C., dated January 2024 and the latest revision thereto are applicable to this project and by reference hereby are considered a part of these plans.