

-L- CURVE DATA

PI Sta 44+91.99	PI Sta 49+59.79
$\Delta = 2' 06' 47.1''$ (RT)	$\Delta = 2' 02' 07.7''$ (LT)
$D = 0' 45' 00.0''$	$D = 0' 45' 00.0''$
$L = 281.75'$	$L = 271.40'$
$T = 140.89'$	$T = 135.71'$
$R = 7,639.44'$	$R = 7,639.44'$

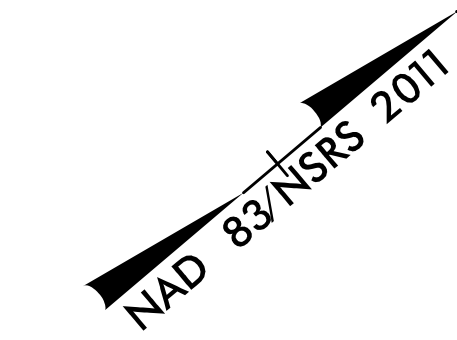
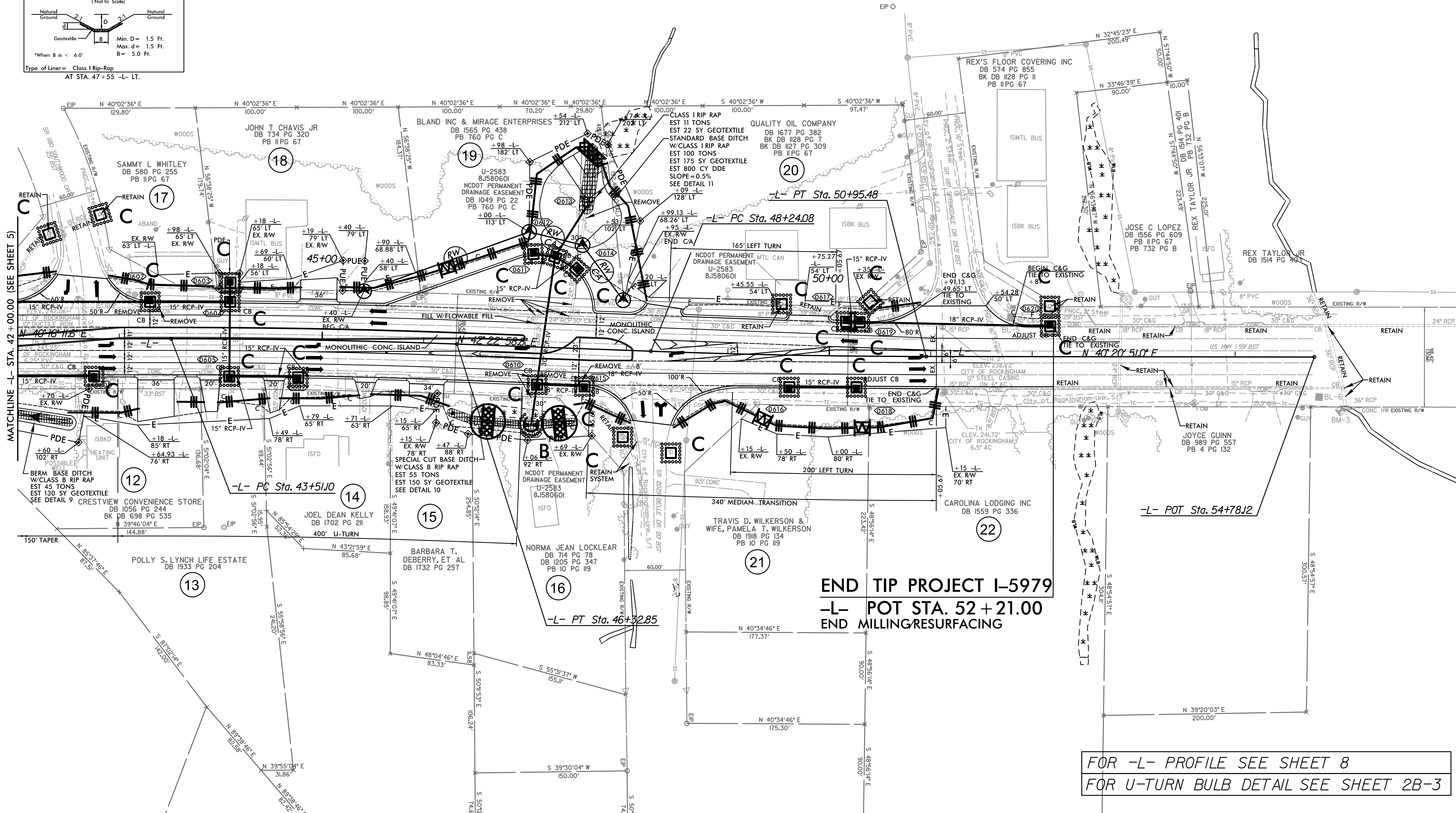
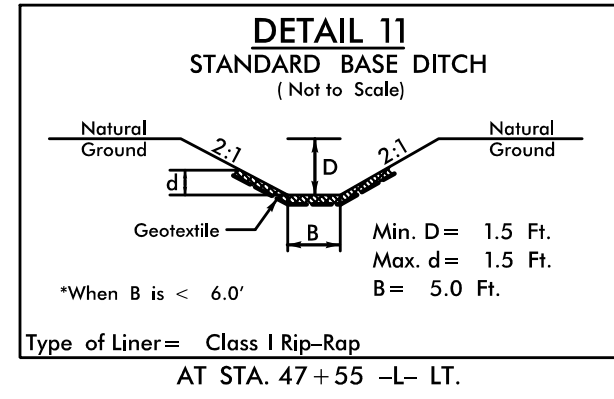
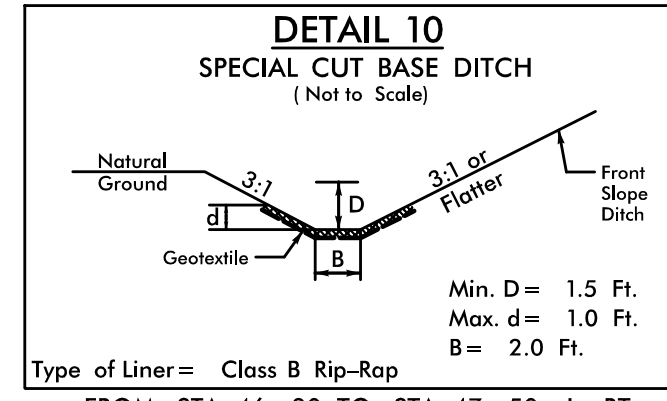
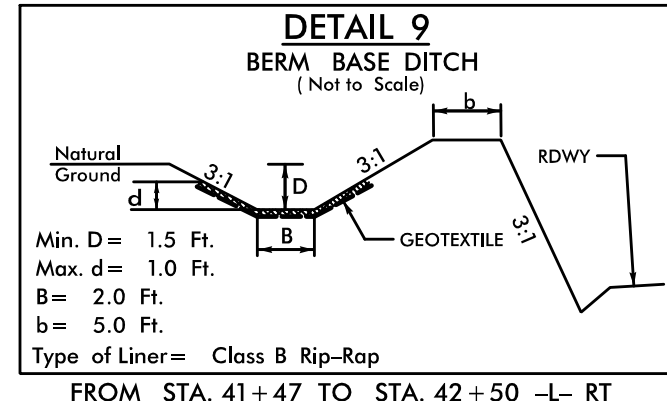

PROJECT REFERENCE NO. I-5979	SHEET NO. EC-09/CONST.06
RW SHEET NO.	HYDRAULICS ENGINEER
ROADWAY DESIGN ENGINEER	

Prepared by
vhb
VHB Engineering NC, P.C. (C-3705)
900 Lake Campus Drive, Suite 500
Raleigh, NC 27606

END TIP PROJECT I-5979
-L- POT STA. 52+21.00
END MILLING/RESURFACING

FOR -L- PROFILE SEE SHEET 8
FOR U-TURN BULB DETAIL SEE SHEET 2B-3