

USE FOR LIGHTING CONSTRUCTION ONLY

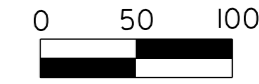

DOCUMENT NOT CONSIDERED FINAL UNLESS ALL SIGNATURES COMPLETED

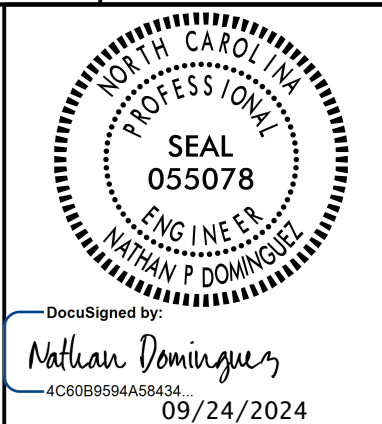
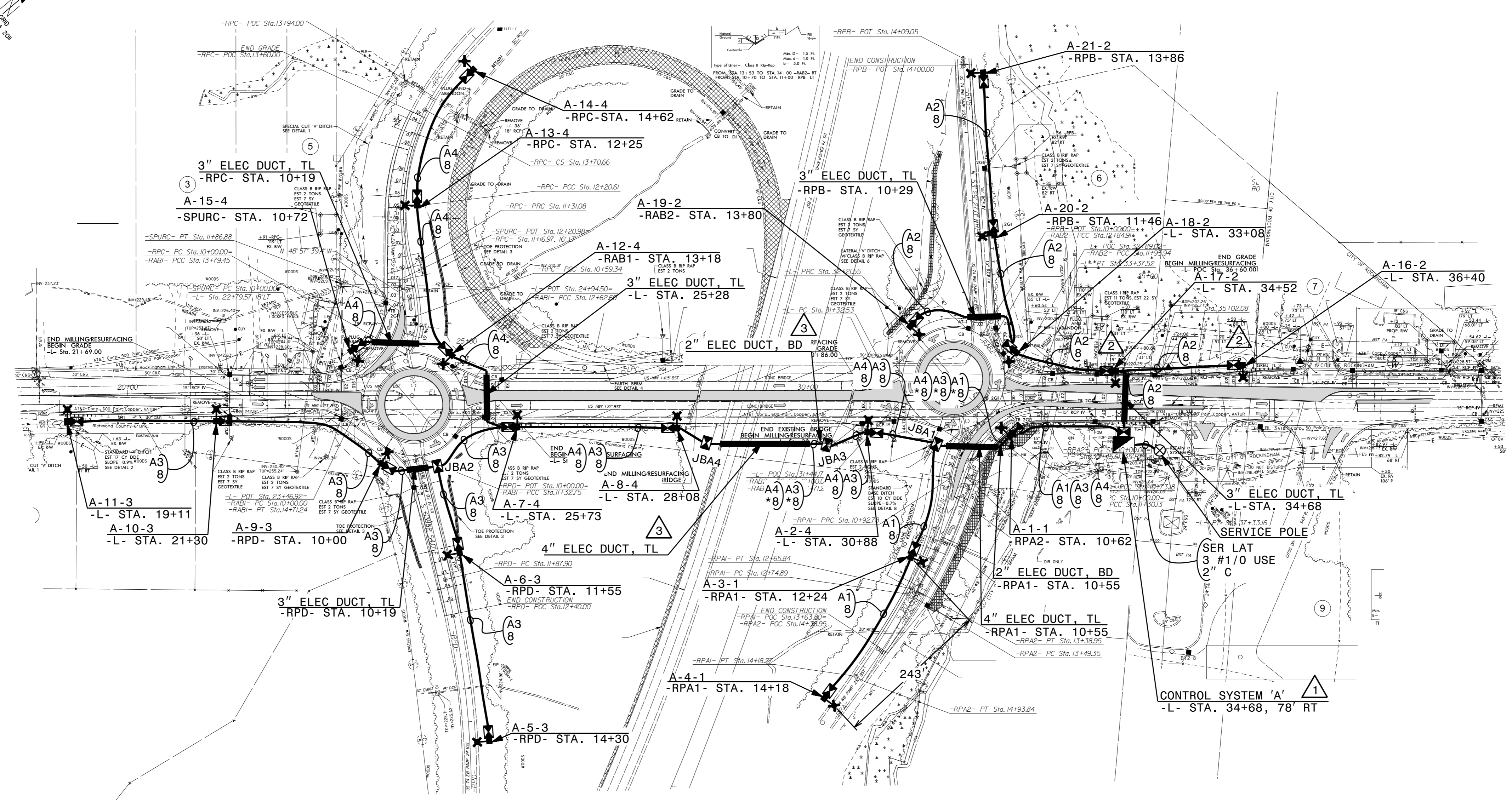

LOAD SCHEDULE
QUADRANT 'A' IN FRONT OF PARKING LOT
1Ø, 3W, 240/480 VAC CONTROL SYSTEM "A"

CIRCUIT ID	SINGLE ARM 1 @ 285W MAX. LED	AMPS @ 480V	KW LOAD	BREAKER SIZE (AMPS)
A1	A-1, A-3, A-4	1.9	0.9	50
A2	A-16, A-17, A-18 A-19, A-20, A-21	3.6	1.7	50
A3	A-5, A-6, A-9 A-10, A-11	3.0	1.4	50
A4	A-2, A-7, A-8 A12, A-13, A-14, A-15	4.2	2.0	50
SPARE	--	--	--	50
TOTAL	21 ON 21 SA POLES	12.7	6.0	

SEE SHEET 'E-1' FOR LEGEND & Δ NOTES

2			
1			
Rev.	Date	Description	Approved
NORTH CAROLINA DEPARTMENT OF TRANSPORTATION ROADWAY DESIGN LIGHTING/ELECTRICAL SECTION LIGHTING LAYOUT I -74/US-1 INTERCHANGE ROUNDABOUTS RICHMOND COUNTY			
Drawn By:	SAM	Approved By:	RGH
Dwg No.:			

20-MAR-2024 09:33 R:\Lighting\15979\Lighting Design\Electrical\15979_LE_PSH_E2.dgn