

5/28/99

SCALE: 1" = 50' (HORZ.)
1" = 5' (VERT.)

-FSS1-

PROJECT REFERENCE NO.	SHEET NO.
U-5536	UC-17
DESIGNED BY: PRJ	
DRAWN BY: SSM	
CHECKED BY: MAP	
APPROVED BY:	
REVISED:	
NORTH CAROLINA DEPARTMENT OF TRANSPORTATION	
UTILITIES ENGINEERING SEC. UTILITY CONSTRUCTION PLANS ONLY	
PHONE: (919) 707-6690 FAX: (919) 250-4151	

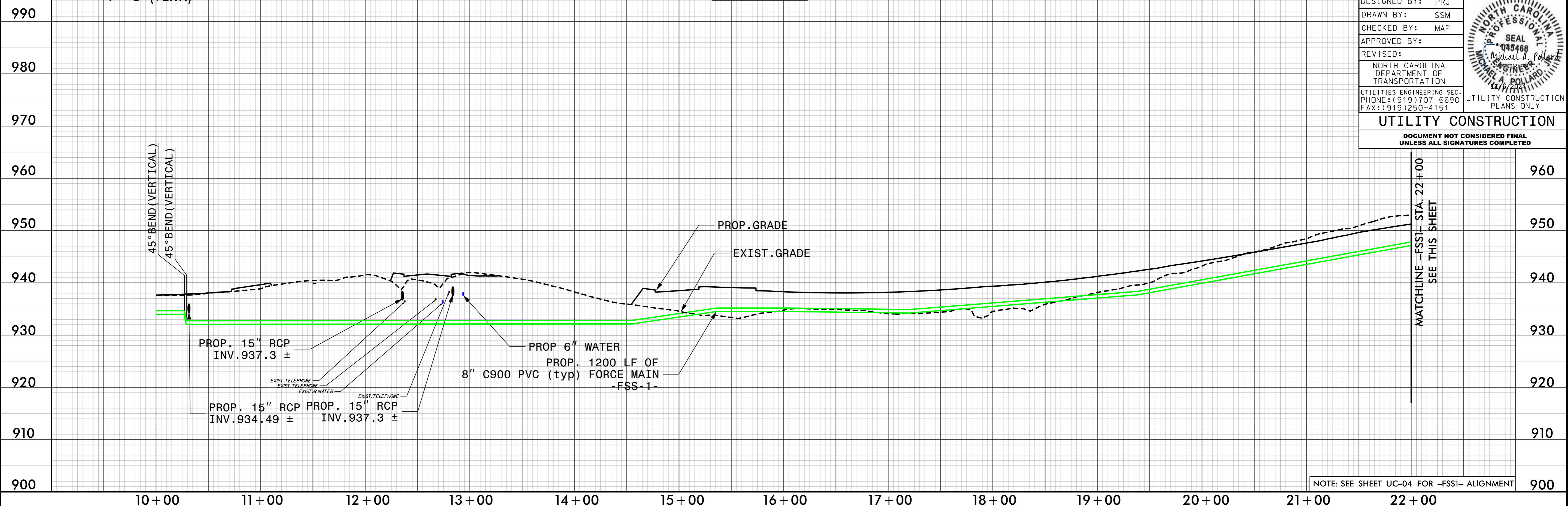

NOTE: SEE SHEET UC-04 FOR -FSS1- ALIGNMENT

SCALE: 1" = 50' (HORZ.)
1" = 5' (VERT.)

-FSS1-

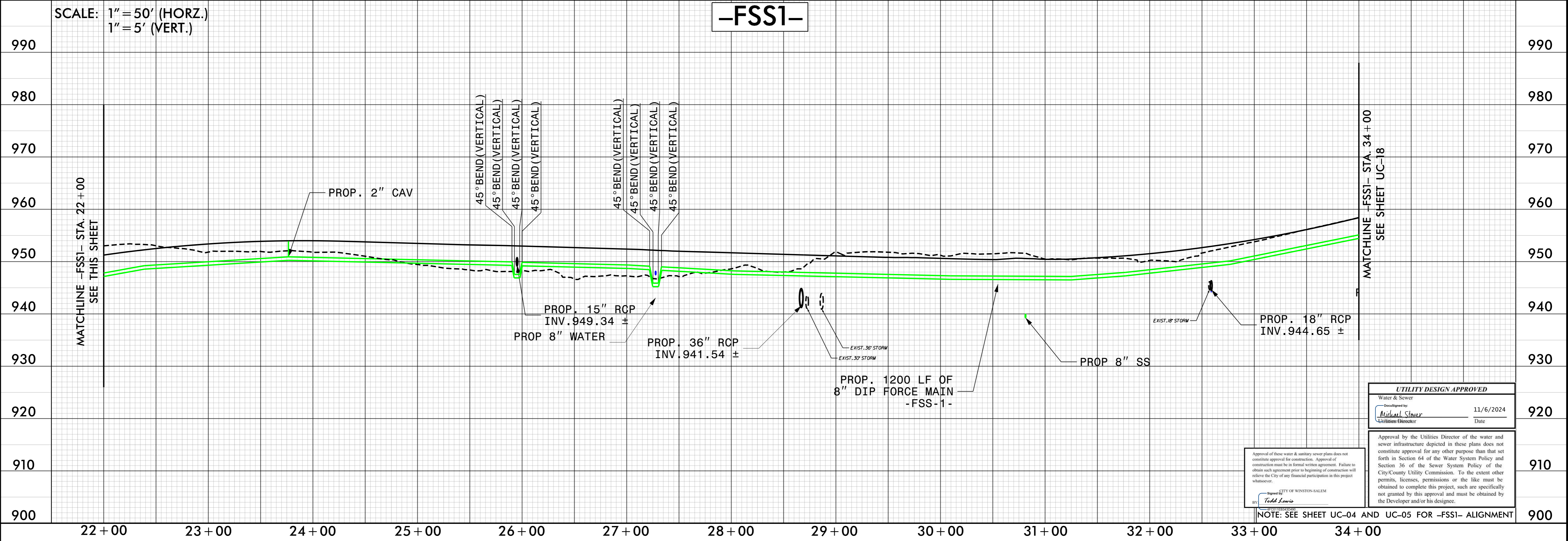

Approval of these water & sanitary sewer plans does not constitute approval for construction. Approval of construction must be in formal written agreement. Failure to obtain such agreement prior to beginning of construction will relieve the City of any financial participation in this project whatsoever.

UTILITY DESIGN APPROVED
Water & Sewer
Designed by: Michael Stover
Date: 11/6/2024
Utilities Director

Approval by the Utilities Director of the water and sewer infrastructure depicted in these plans does not constitute approval for any other purpose than that set forth in Section 64 of the Water System Policy and Section 36 of the Sewer System Policy of the City/County Utility Commission. To the extent other permits, licenses, permissions or the like must be obtained to complete this project, such are specifically not granted by this approval and must be obtained by the Developer and/or his designee.

CITY OF WINSTON-SALEM
Todd Lewis

NOTE: SEE SHEET UC-04 AND UC-05 FOR -FSS1- ALIGNMENT

-SYSTEM-NU5E536-ut_UC17_psh.dgn