

TYPE III BARRICADE(S)

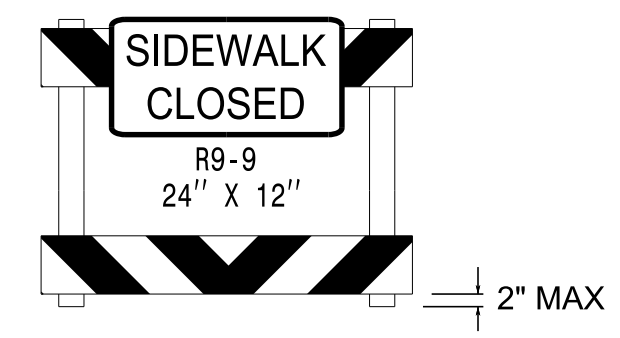

PEDESTRIAN BARRICADE
MUST BE ADA-COMPLIANT

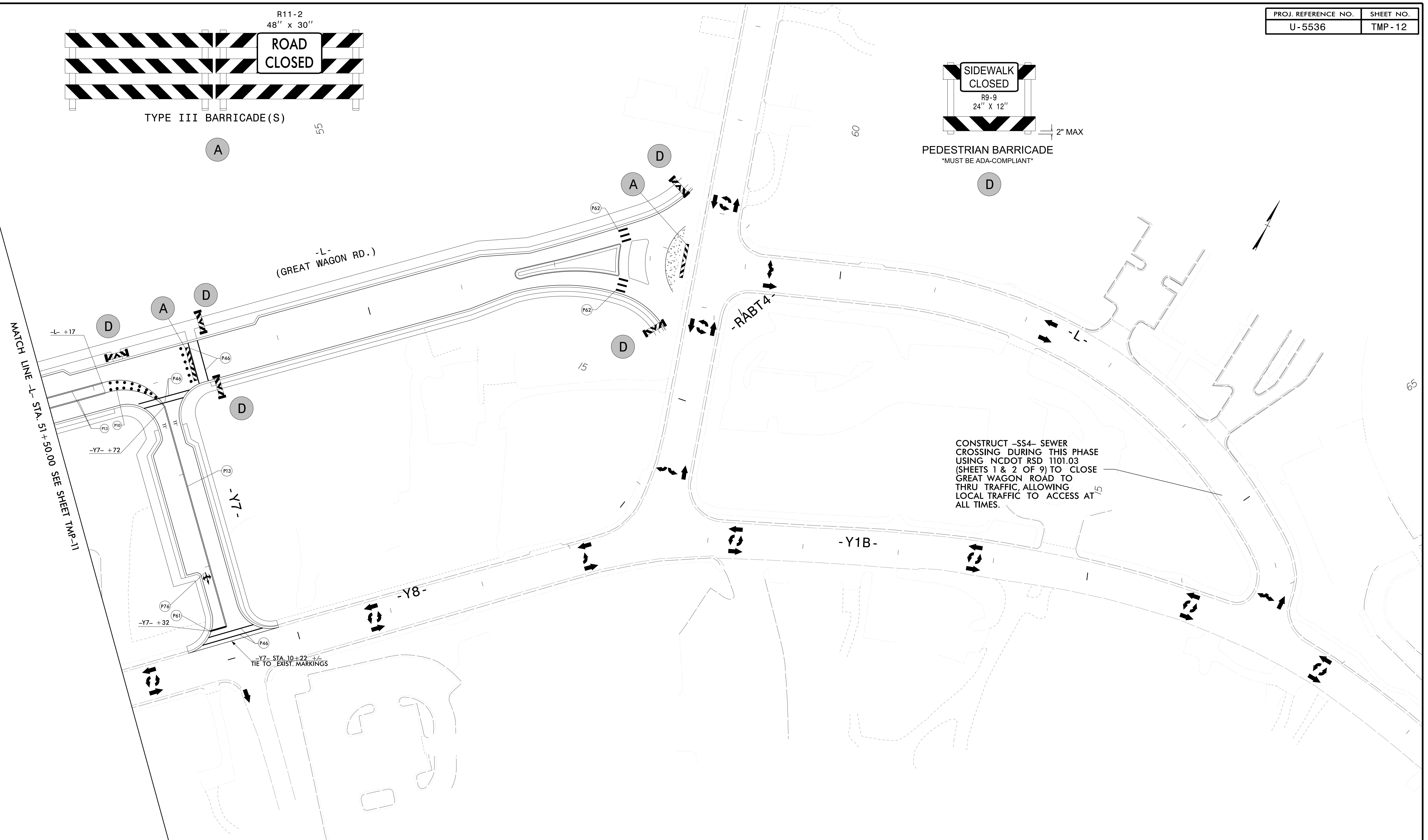

MATCH LINE -L- STA. 51+50.00 SEE SHEET TMP-11

11/22/2024
pw:\cdmsmith-az02-pw.bentley.com:pw-p\in\documents\117240\23192\10 Transportation\117240\23192\10 Client Folder Structure\U5536\Traffic\TrafficControl\TCP\U5536_TC_TMP12.dgn
User:CONRADAM

CDM Smith
 CDM Smith Inc.
 5400 Glenwood Avenue
 Suite 400
 Raleigh, NC 27612-3228
 NC COA No. F-1255

APPROVED: *Aden M. Conrad*
00DC0FFA0F09A4D...

DATE: 12/19/2024

SEAL

SEAL
 NORTH CAROLINA
 PROFESSIONAL
 ENGINEER
 ADAM M. CONRAD
 043767

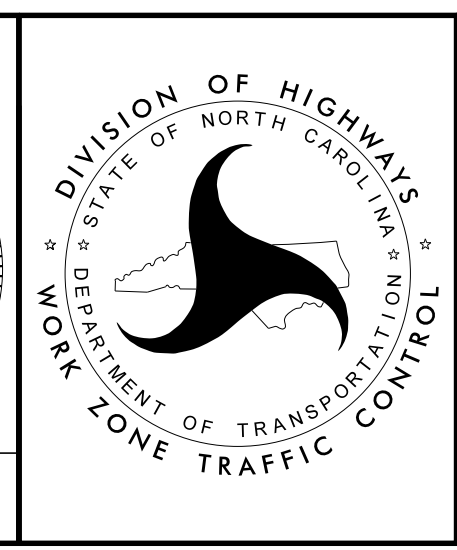

PHASE 2 - STEP 1

DOCUMENT NOT CONSIDERED FINAL
UNLESS ALL SIGNATURES COMPLETED