

Location and Surveys

PROJECT SURVEYOR

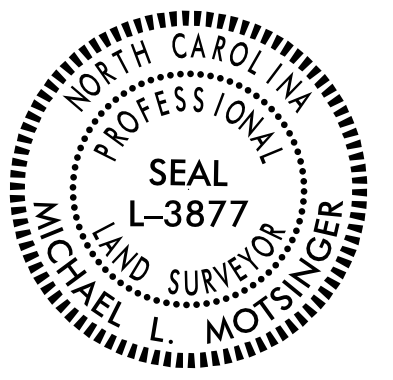

DOCUMENT NOT CONSIDERED FINAL UNLESS ALL SIGNATURES COMPLETED

I, Michael L. Motsinger, certify that the right of way and permanent easement monumentation for this project shown herein was completed under my direct and responsible charge from an actual survey made under my supervision; that all horizontal closures had a minimum ratio of precision of 1:10,000 (Class A). Field work was performed from April 2023 to October 2024, and all coordinates are based on NAD83/2011; That this survey was performed to meet the requirements of 21NCAC 56.1600 as applicable.

This 7th day of November, 2024.

DocuSigned by:  
  
 Professional Land Surveyor L-3877

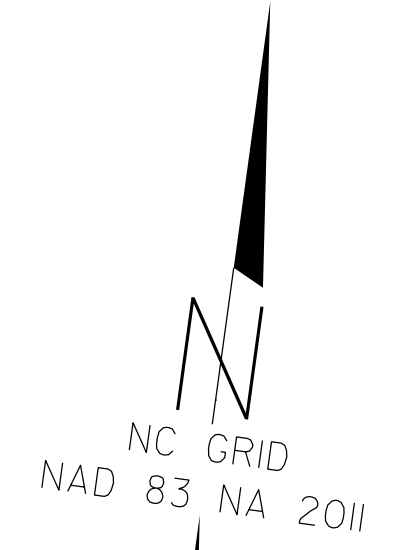

MATCHLINE -L- STA. 55 + 71 SEE SHET RW05



REVISIONS

07 NOV 2024 09:21  
 S:\Users\m103\OneDrive\Working\Projects\241106\U5536\B-red\Control Sheets\Revisions\_241106\U5536\_LS\_RW06.dgn  
 bevington AT LS-328608

NOTES:

1. IF FURTHER INFORMATION REGARDING PROJECT CONTROL IS NEEDED PLEASE CONTACT THE LOCATION AND SURVEYS UNIT.
2. PROJECT CONTROL WAS ESTABLISHED USING GNSS, THE GLOBAL NAVIGATION SATELLITE SYSTEM.
3. RIGHT OF WAY MONUMENTATION ESTABLISHED \_\_\_\_ TO \_\_\_\_.