

NOTE: UTILIZE FABRIC INSERT INLET PROTECTION IN LIEU OF TYPE C INLET PROTECTION WHERE WATER MIGHT POND ON ROADWAY USED BY PUBLIC TRAFFIC.

Place Matting for Erosion Control on Slope as Work Allows.
-Y- Sta. 15+69 to Sta. 17+13 LT
-Y- Sta. 17+50 to Sta. 18+86 LT
-Y- Sta. 15+17 to Sta. 16+49 RT
-Y- Sta. 16+92 to Sta. 18+31 RT

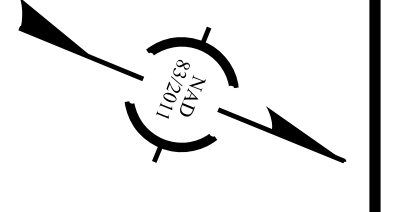
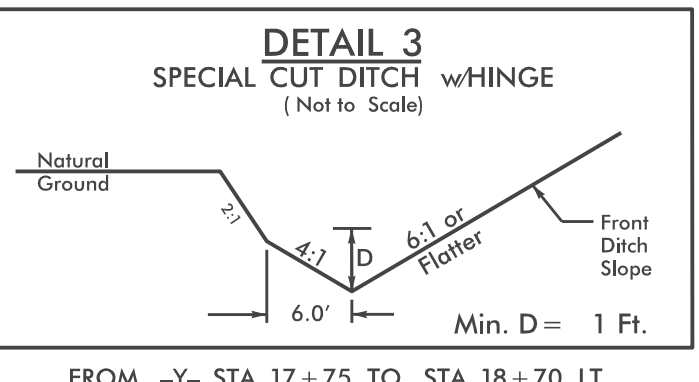
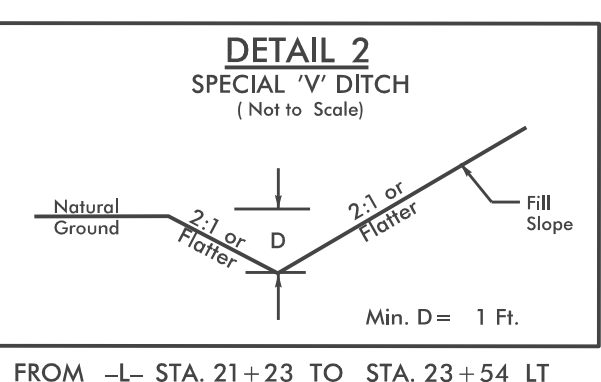
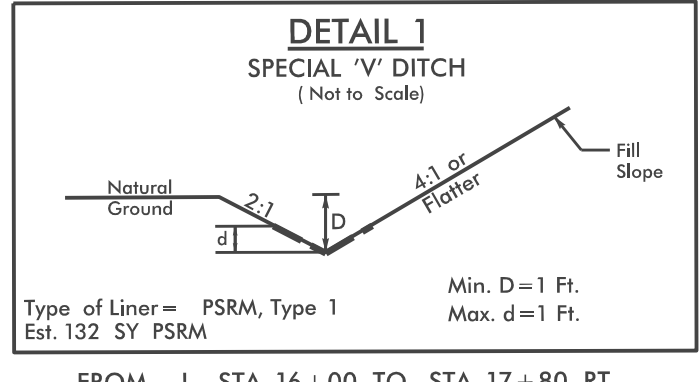
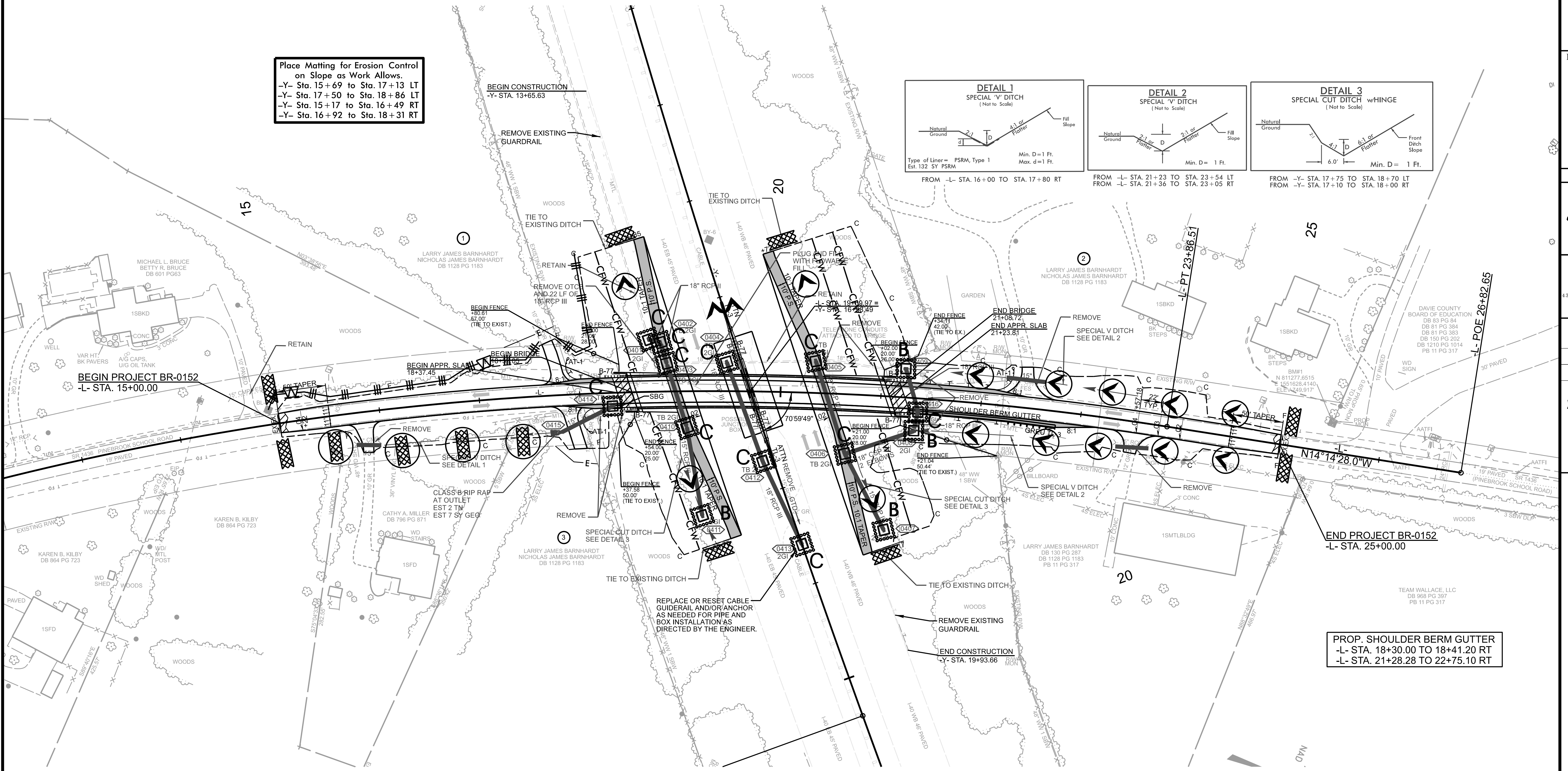

PROP. SHOULDER BERM GUTTER
-L- STA. 18+30.00 TO 18+41.20 RT
-L- STA. 21+28.28 TO 22+75.10 RT