

STATE	STATE PROJECT REFERENCE NO.	SHEET NO.	TOTAL SHEETS
N.C.	BR-0086	EC-1	
STATE PROJ. NO.	F.A. PROJ. NO.	DESCRIPTION	

**TIP PROJECT: BR-0086**

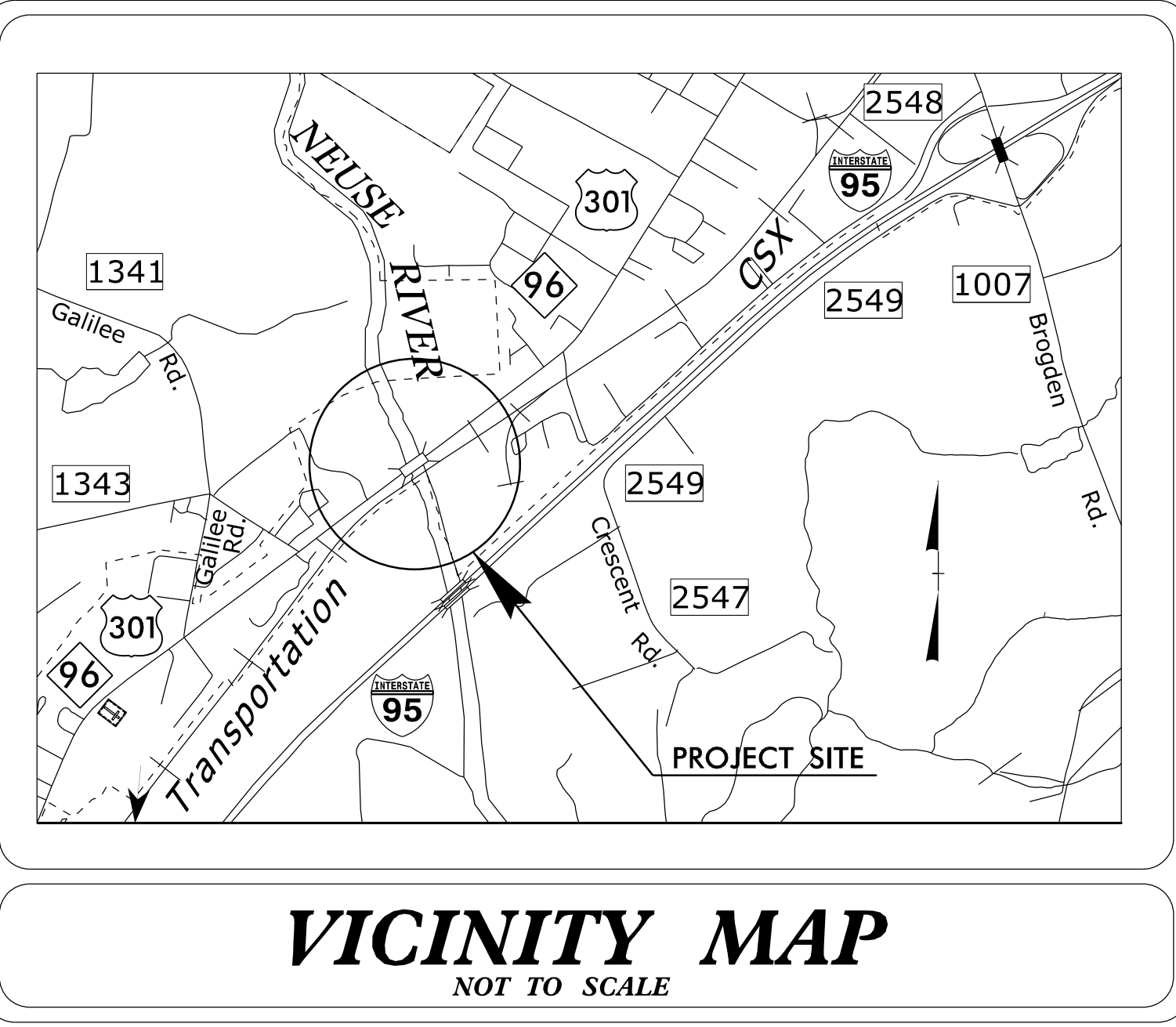

**VICINITY MAP**  
NOT TO SCALE

STATE OF NORTH CAROLINA  
DIVISION OF HIGHWAYS  
PLAN FOR PROPOSED  
HIGHWAY EROSION CONTROL  
**JOHNSTON COUNTY**

**LOCATION: REPLACE BRIDGE No. 500070 ON US 301  
OVER NEUSE RIVER**

**TYPE OF WORK: GRADING, PAVING, DRAINAGE AND STRUCTURE**

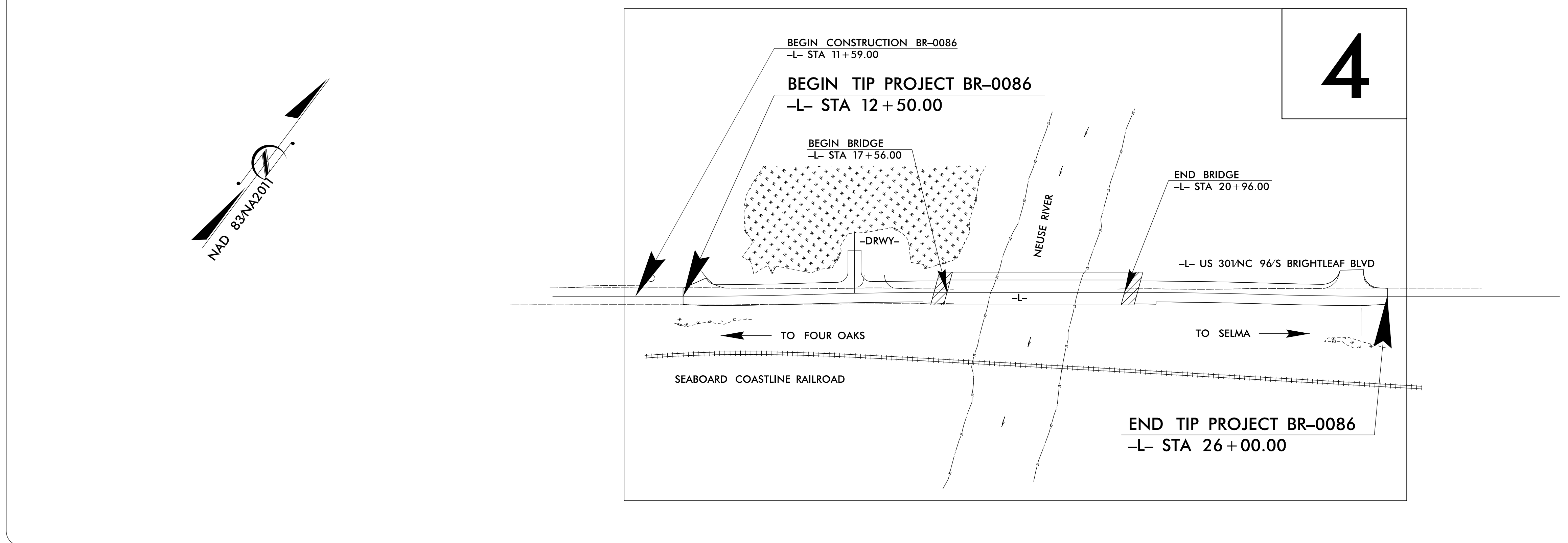

THIS PROJECT CONTAINS EROSION CONTROL PLANS FOR CLEARING AND GRUBBING PHASE OF CONSTRUCTION.

ENVIRONMENTALLY SENSITIVE AREA(S) EXIST ON THIS PROJECT  
*Refer To E. C. Special Provisions for Special Considerations.*

THIS PROJECT HAS BEEN DESIGNED TO SENSITIVE WATERSHED STANDARDS.

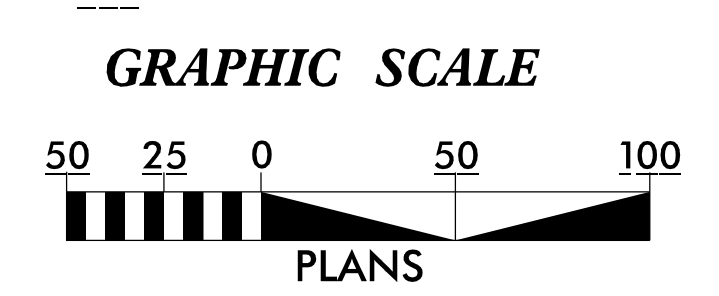

THESE EROSION AND SEDIMENT CONTROL PLANS COMPLY WITH THE REGULATIONS SET FORTH BY THE NCG-010000 GENERAL STORMWATER CONSTRUCTION PERMIT ISSUED BY THE NORTH CAROLINA DEPARTMENT OF ENVIRONMENTAL QUALITY DIVISION OF ENERGY, MINING AND LAND RESOURCES.

Prepared in the Office of:  
**ROADSIDE ENVIRONMENTAL UNIT**  
1 South Wilmington St.  
Raleigh, NC 27611  
**2024 STANDARD SPECIFICATIONS**

Designed by:  
**Noelle Ring** **3456**  
NAME LEVEL III CERTIFICATION NO.

**Roadway Standard Drawings**  
The "Roadway Standard Drawings"- Roadway Design Unit - N. C. Department of Transportation - Raleigh, N. C., dated January 2024 and the latest revision thereto are applicable to this project and by reference hereby are considered a part of these plans.

20-JUL-2024 11:22  
RALEIGH\HOME\PROJECTS\BR0086\_EC-1.dgn  
m.ring