

5/28/99

PROJECT REFERENCE NO. <i>BR-0086</i>	SHEET NO. 5
ROADWAY DESIGN ENGINEER <i>[Signature]</i>	HYDRAULICS ENGINEER <i>[Signature]</i>
SEAL 040314 11/06/2024	SEAL 022000 11/06/2024

**DOCUMENT NOT CONSIDERED FINAL
UNLESS ALL SIGNATURES COMPLETED**

BRIDGE HYDRAULIC DATA

DESIGN DISCHARGE = 23300 CFS
 DESIGN FREQUENCY = 50 YRS
 DESIGN HW ELEVATION = 119.6 FT
 BASE DISCHARGE = 29200 CFS
 BASE FREQUENCY = 100 YRS
 BASE HW ELEVATION = 121.3 FT
 OVERTOPPING DISCHARGE = 55600 CFS
 OVERTOPPING FREQUENCY = 500+ YRS
 OVERTOPPING ELEVATION = 129.8 FT

DATE OF SURVEY 12-6-2021
 W.S. ELEVATION AT DATE OF SURVEY = 98.2 FT

-L-

BM*2 RR SPIKE IN BASE OF 14" POPLAR
-L- STA 20+37.01 50.65' RT
ELEVATION 124.49'

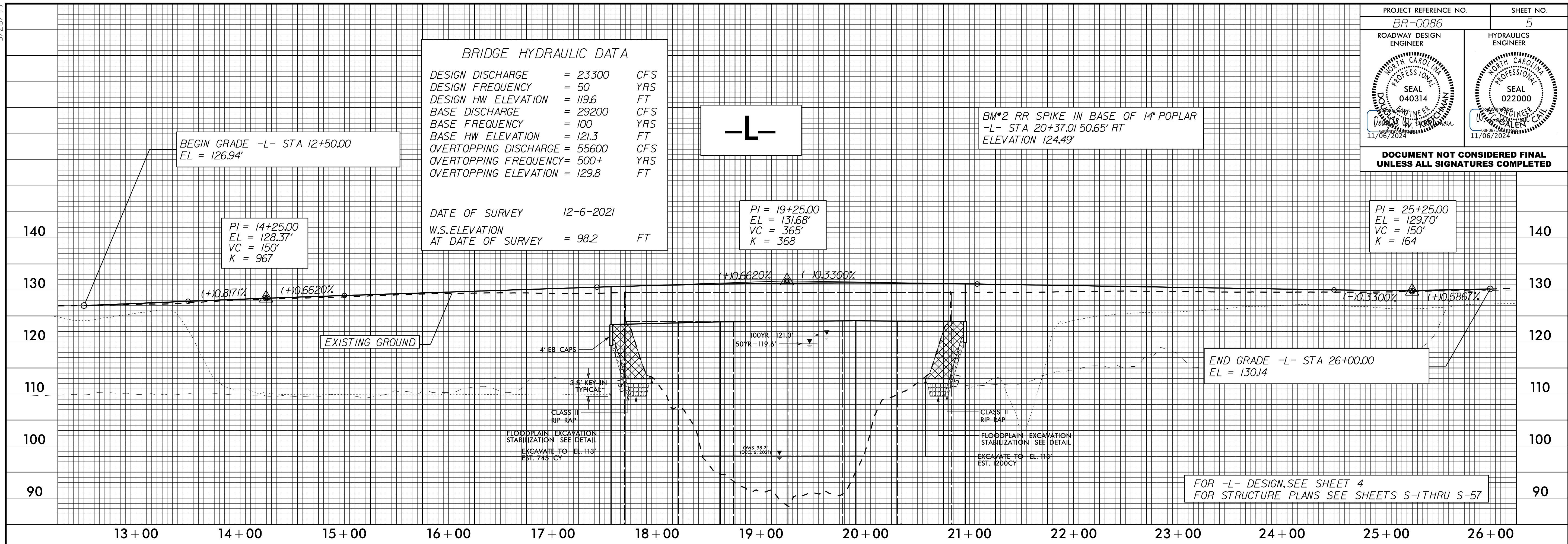

-DRWY-

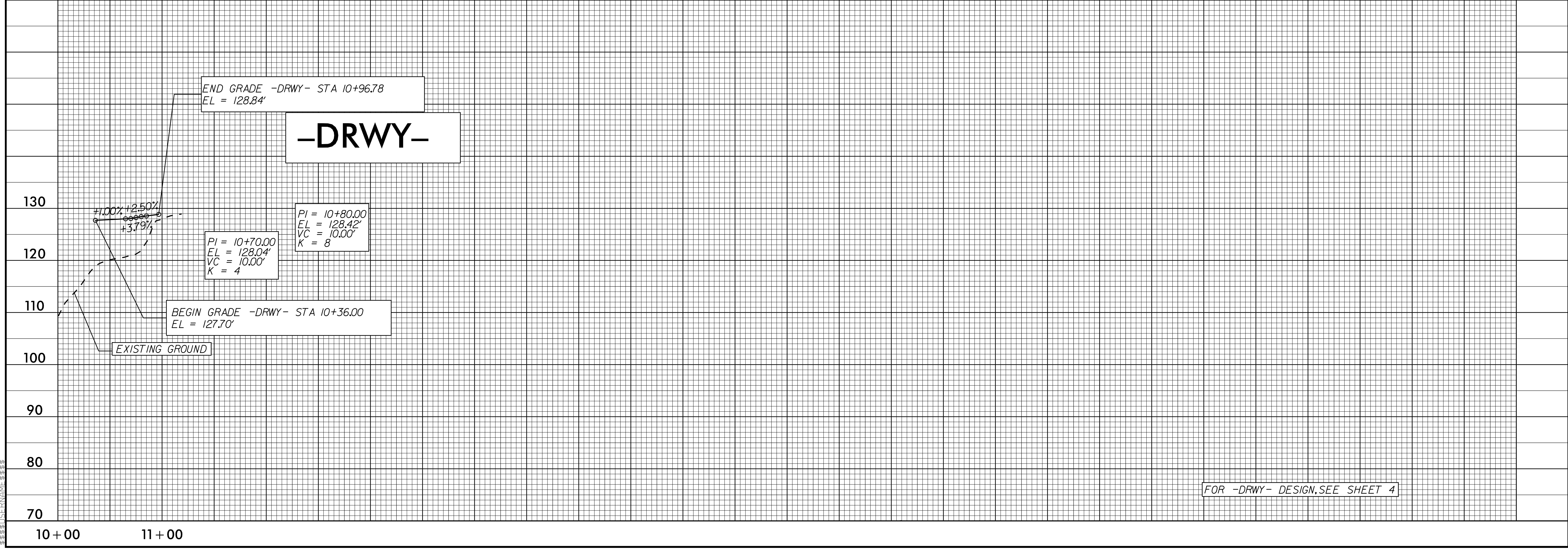

14-OCT-2024 13:47
F:\Projects\BR0086_Rdy_pf15.dgn