

8/17/99
20-DEC-2024 11:22
C:\Users\jex\Documents\OneDrive - State of North Carolina\Desktop\new_plans_for_luis_near_batcave.dwg
micor AT DWG-330163

REVISIONS

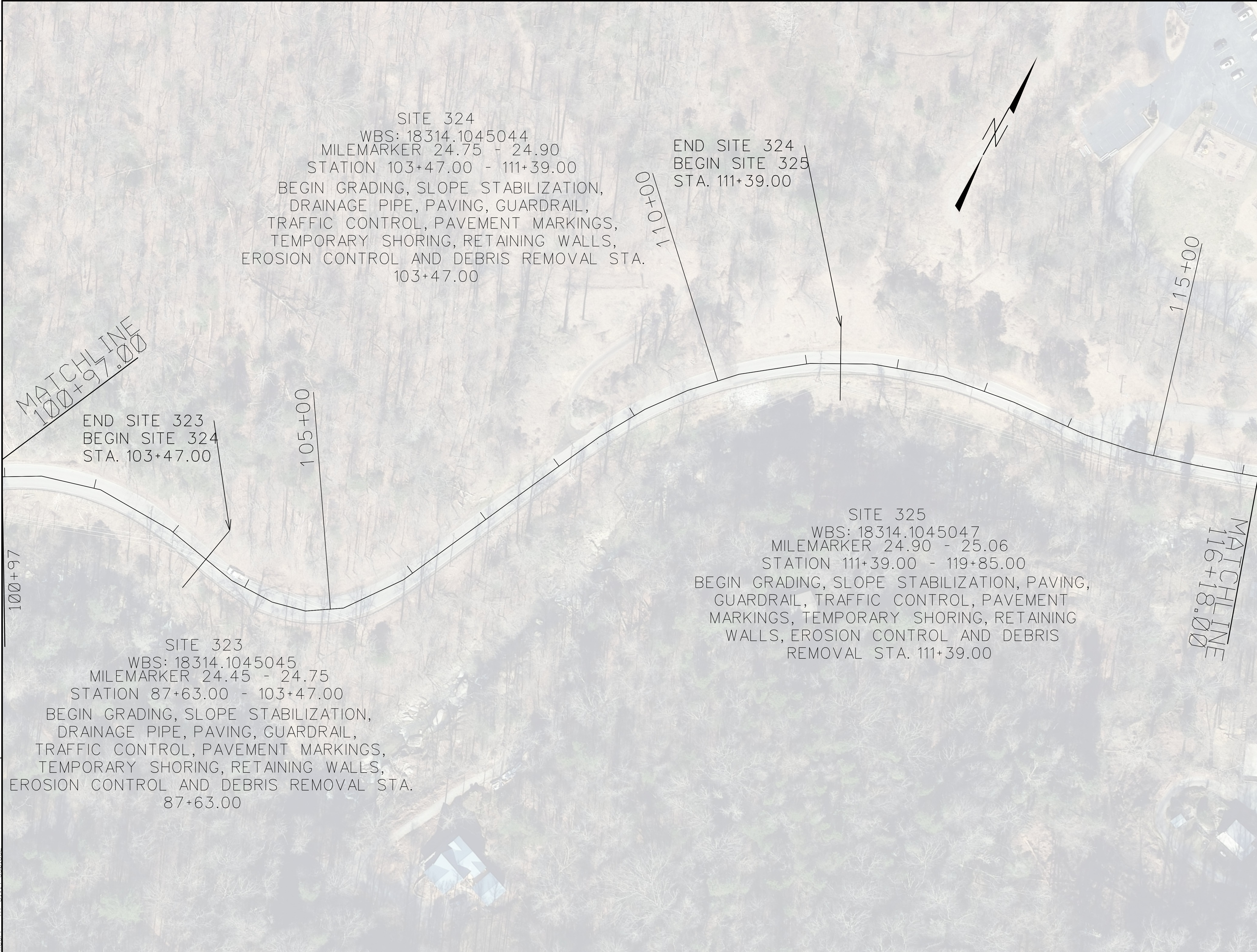

SITE 324
WBS: 18314.1045044
MILEMARKER 24.75 - 24.90
STATION 103+47.00 - 111+39.00
BEGIN GRADING, SLOPE STABILIZATION,
DRAINAGE PIPE, PAVING, GUARDRAIL,
TRAFFIC CONTROL, PAVEMENT MARKINGS,
TEMPORARY SHORING, RETAINING WALLS,
EROSION CONTROL AND DEBRIS REMOVAL STA.
103+47.00

END SITE 324
BEGIN SITE 325
STA. 111+39.00

END SITE 323
BEGIN SITE 324
STA. 103+47.00

SITE 325
WBS: 18314.1045047
MILEMARKER 24.90 - 25.06
STATION 111+39.00 - 119+85.00
BEGIN GRADING, SLOPE STABILIZATION, PAVING,
GUARDRAIL, TRAFFIC CONTROL, PAVEMENT
MARKINGS, TEMPORARY SHORING, RETAINING
WALLS, EROSION CONTROL AND DEBRIS
REMOVAL STA. 111+39.00

SITE 323
WBS: 18314.1045045
MILEMARKER 24.45 - 24.75
STATION 87+63.00 - 103+47.00
BEGIN GRADING, SLOPE STABILIZATION,
DRAINAGE PIPE, PAVING, GUARDRAIL,
TRAFFIC CONTROL, PAVEMENT MARKINGS,
TEMPORARY SHORING, RETAINING WALLS,
EROSION CONTROL AND DEBRIS REMOVAL STA.
87+63.00

MATCHLINE
100+97.00

MATCHLINE
116+18.00

