

STATE	STATE PROJECT REFERENCE NO.	SHEET NO.	TOTAL SHEETS
N.C.	U-3422	RW01	36

**TIP PROJECT: U-3422**

STATE OF NORTH CAROLINA  
 DIVISION OF HIGHWAYS

SURVEY CONTROL, EXISTING CENTERLINES,  
 RIGHT OF WAY, EASEMENTS AND PROPERTY TIES

**CUMBERLAND COUNTY**

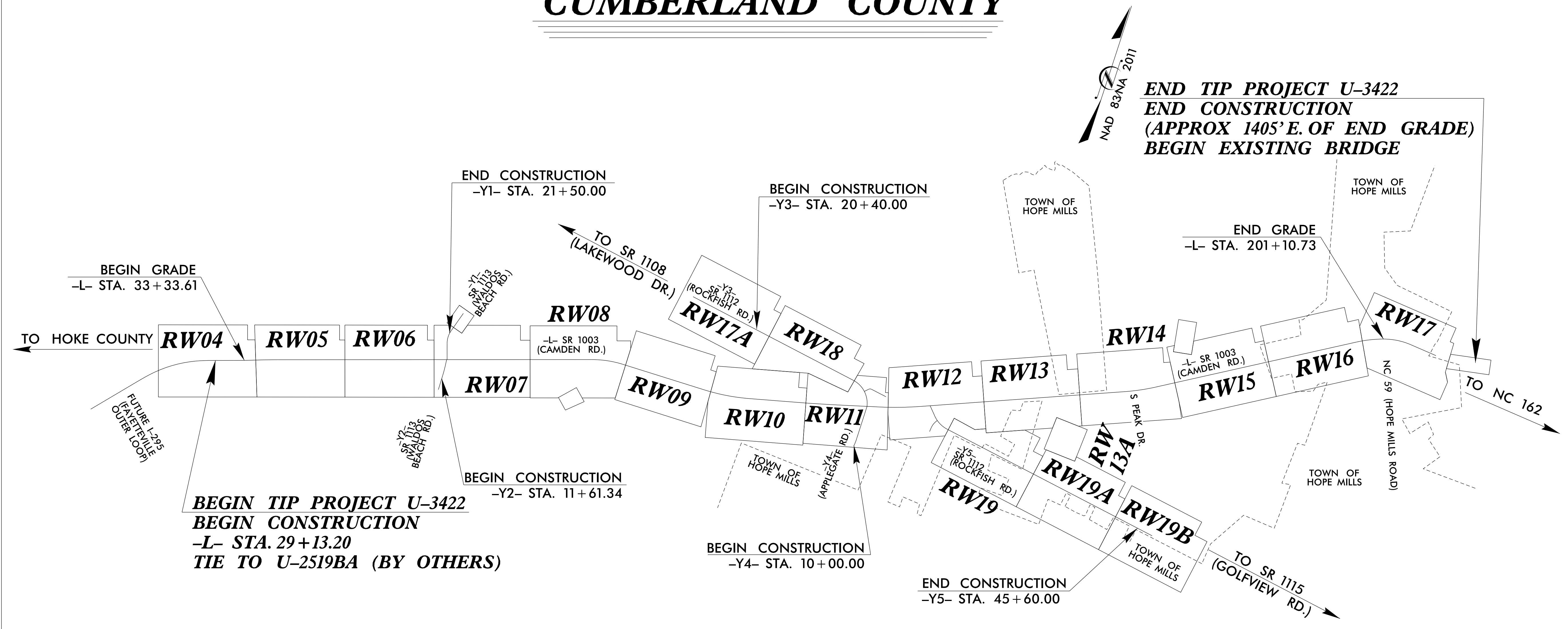

**END TIP PROJECT U-3422  
 END CONSTRUCTION  
 (APPROX 1405' E. OF END GRADE)  
 BEGIN EXISTING BRIDGE**

BEGIN GRADE  
 -L- STA. 33+33.61

END CONSTRUCTION  
 -Y1- STA. 21+50.00

BEGIN CONSTRUCTION  
 -Y3- STA. 20+40.00

END GRADE  
 -L- STA. 201+10.73

TO HOKE COUNTY

FUTURE L-295  
 (PAVEMENT IN  
 OUTER LOOP)

**BEGIN TIP PROJECT U-3422  
 BEGIN CONSTRUCTION  
 -L- STA. 29+13.20  
 TIE TO U-2519BA (BY OTHERS)**

BEGIN CONSTRUCTION  
 -Y2- STA. 11+61.34

BEGIN CONSTRUCTION  
 -Y4- STA. 10+00.00

END CONSTRUCTION  
 -Y5- STA. 45+60.00

TO NC 162

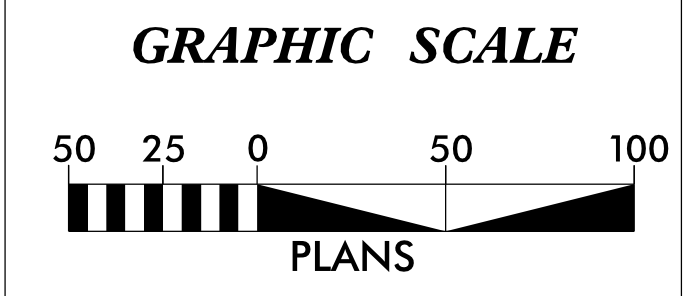

**DATUM DESCRIPTION**

THE LOCALIZED COORDINATE SYSTEM DEVELOPED FOR THIS PROJECT IS BASED ON THE STATE PLANE COORDINATES ESTABLISHED BY NCGS FOR MONUMENT "BREEZE" WITH NAD 83/NSRS NC STATE PLANE GRID COORDINATES OF NORTHING: 455401.4875 (ft) EASTING: 2024426.7025 (ft) ELEVATION: 218.08 (ft) THE AVERAGE COMBINED GRID FACTOR USED ON THIS PROJECT (GROUND TO GRID) IS: 0.999880000 THE N.C. LAMBERT GRID BEARING AND LOCALIZED HORIZONTAL GROUND DISTANCE FROM "BREEZE" TO -L- STATION 10+00.00 IS S 68-28'56" W 33918.41(ft) ALL LINEAR DIMENSIONS ARE LOCALIZED HORIZONTAL DISTANCES VERTICAL DATUM USED IS NAVD 88/GEOID12NC

Prepared in the Office of:

JoynerKeeny, PLLC  
 1051 N. Winstead Avenue  
 Rocky Mount, NC 27804  
 252-977-3124  
 North Carolina Firm Number P-0551

2024 STANDARD SPECIFICATIONS

**RIGHT OF WAY DATE:** 07/30/2021

**LETTING DATE:** 10/17/2024

PROFESSIONAL LAND SURVEYOR

DocuSigned by:  
 Karen E. Stone  
 82435A975745452...

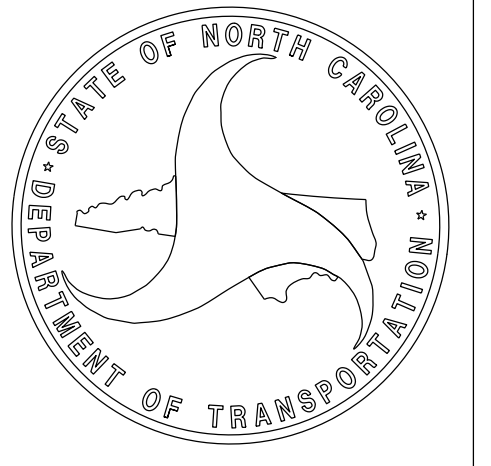

21-OCT-2024 14:35  
 Z:\CAD\2017\170155F\_NCDOT\_U3422\_RW Staking\_Cumberland\DCN\NCDOT\_REDLINE FROM 241021\U3422\_Is\_rw01.dgn  
 jmatthews AT JKA-042