

STATE OF NORTH CAROLINA
DIVISION OF HIGHWAYS

CABARRUS COUNTY

INDEX OF SHEETS

DESCRIPTION	SHEET NO.
INDEX OF SHEETS & CROSS-SECTION SUMMARY	X-1
-L-	X-2 TO X-8
-LPC-	X-9 TO X-11
-Y-	X-12 TO X-13
-Y2-	X-14 TO X-15

CROSS-SECTION SUMMARY

Station	Uncl. Exc.	Embt	Station	Uncl. Exc.	Embt	Station	Uncl. Exc.	Embt	Station	Uncl. Exc.	Embt
L	(cu. yd.)	(cu. yd.)	LPC	(cu. yd.)	(cu. yd.)	Y	(cu. yd.)	(cu. yd.)	Y2	(cu. yd.)	(cu. yd.)
17+00.00	0	0	11+00.00	0	0	17+00.00	0	0	10+00.00	0	0
17+50.00	6	125	11+50.00	0	1965	17+50.00	129	81	10+50.00	5	15
18+00.00	3	373	12+00.00	0	1774	18+00.00	153	99	11+00.00	17	2
18+50.00	0	795	12+50.00	0	1134	18+50.00	267	86	11+19.75	9	0
19+00.00	0	1276	13+00.00	0	706	19+00.00	189	56			
19+50.00	0	1511	13+50.00	1	360	19+50.00	558	43			
19+75.44	0	706	14+00.00	8	110	20+00.00	999	61			
	BRIDGE					20+50.00	520	81			
21+50.94	0	0				21+00.00	120	81			
22+00.00	0	2199				21+40.00	0	0			
22+50.00	0	2317									
23+00.00	0	1285									
23+50.00	0	1002									
24+00.00	0	757									
24+50.00	0	301									
25+00.00	7	59									
25+50.00	23	13									
25+85.00	11	0									

APPROXIMATE QUANTITIES ONLY. UNCLASSIFIED EXCAVATION, FINE GRADING, CLEARING AND GRADING, REMOVAL OF EXISTING PAVEMENT, AND BREAKING OF EXISTING PAVEMENT WILL BE PAID FOR AT THE LUMP SUM PRICE FOR "GRADING".

NOTE: EMBANKMENT COLUMN DOES NOT INCLUDE BACKFILL FOR UNDERCUT.

6/23/16

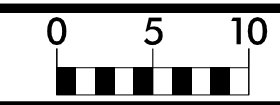

PROJ. REFERENCE NO.	SHEET NO.
B-5372	X-2

150 140 130 120 110 100 90 80 70 60 50 40 30 20 10 0 10 20 30 40 50 60 70 80 90 100 110 120 130 140 150

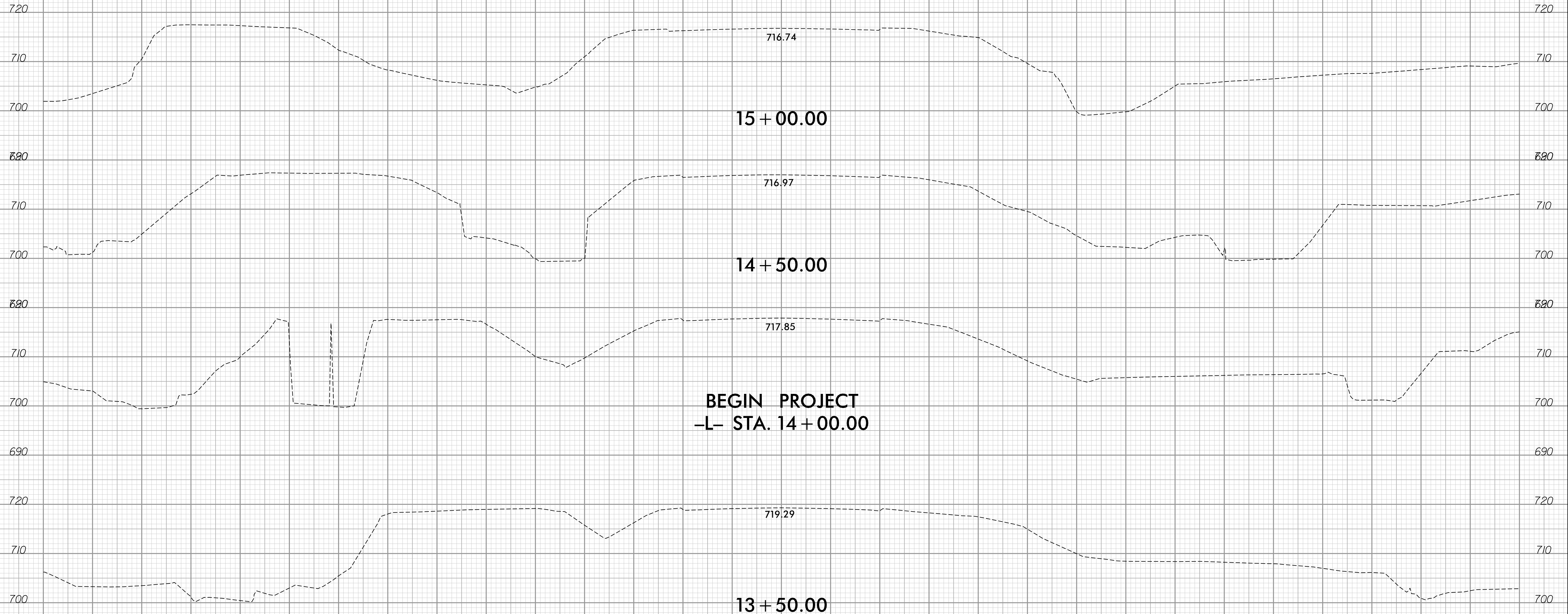

BEGIN PROJECT
-L- STA. 14 + 00.00

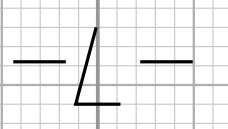

8/13/2024 14:21:16 PM
 ..\Xsec\B5372.rdy_xpl.dgn
 User:jdconner

150 140 130 120 110 100 90 80 70 60 50 40 30 20 10 0 10 20 30 40 50 60 70 80 90 100 110 120 130 140 150

6/23/16

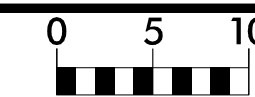

PROJ. REFERENCE NO.	SHEET NO.
B-5372	X-3

150 140 130 120 110 100 90 80 70 60 50 40 30 20 10 0 10 20 30 40 50 60 70 80 90 100 110 120 130 140 150

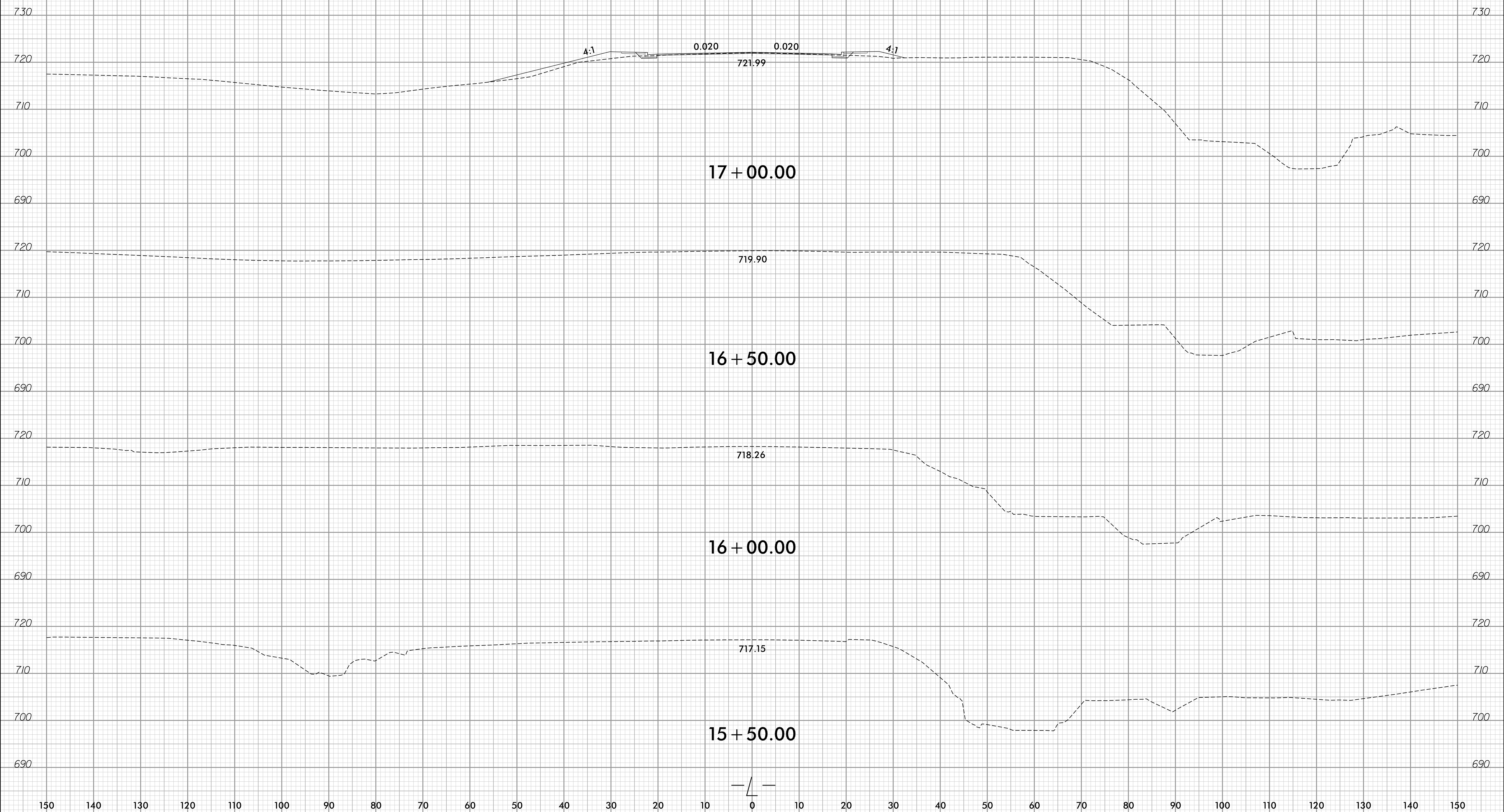

8/13/2024 1:42:16 PM
 \\Xsc\B5372\rdy_xpl.dgn
 User:rdconser

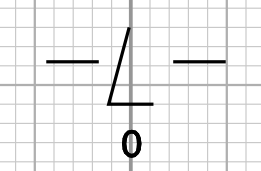

6/23/16

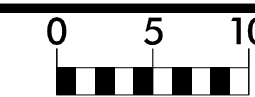

PROJ. REFERENCE NO.	SHEET NO.
B-5372	X-4

150 140 130 120 110 100 90 80 70 60 50 40 30 20 10 0 10 20 30 40 50 60 70 80 90 100 110 120 130 140 150

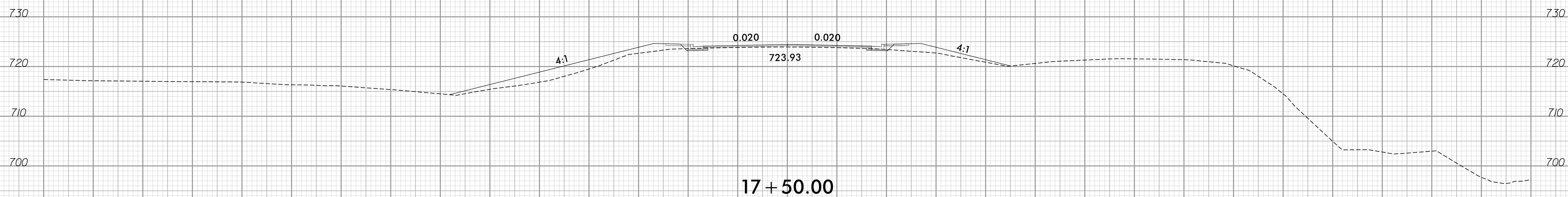
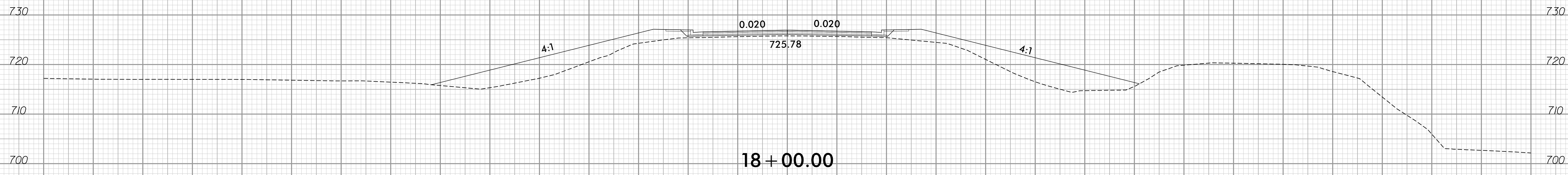
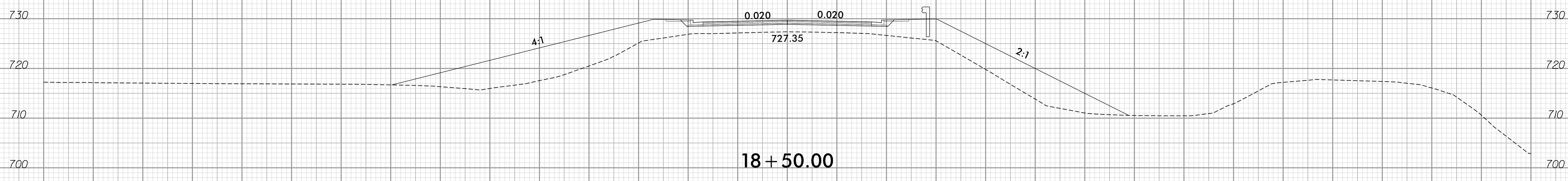
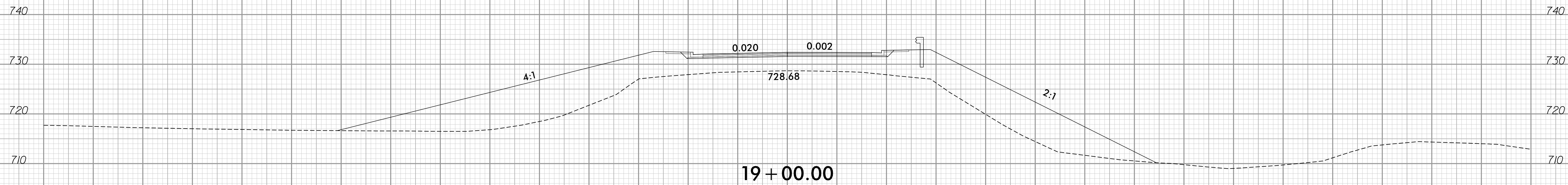

150 140 130 120 110 100 90 80 70 60 50 40 30 20 10 0 10 20 30 40 50 60 70 80 90 100 110 120 130 140 150

8/13/2024 1:42:16 PM
 \\Xsc\B5372\rdy_xpl.dgn
 User:rdconser

6/22/16

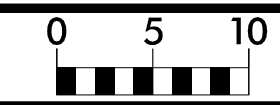

PROJ. REFERENCE NO.
B-5372

SHEET NO.
X-5

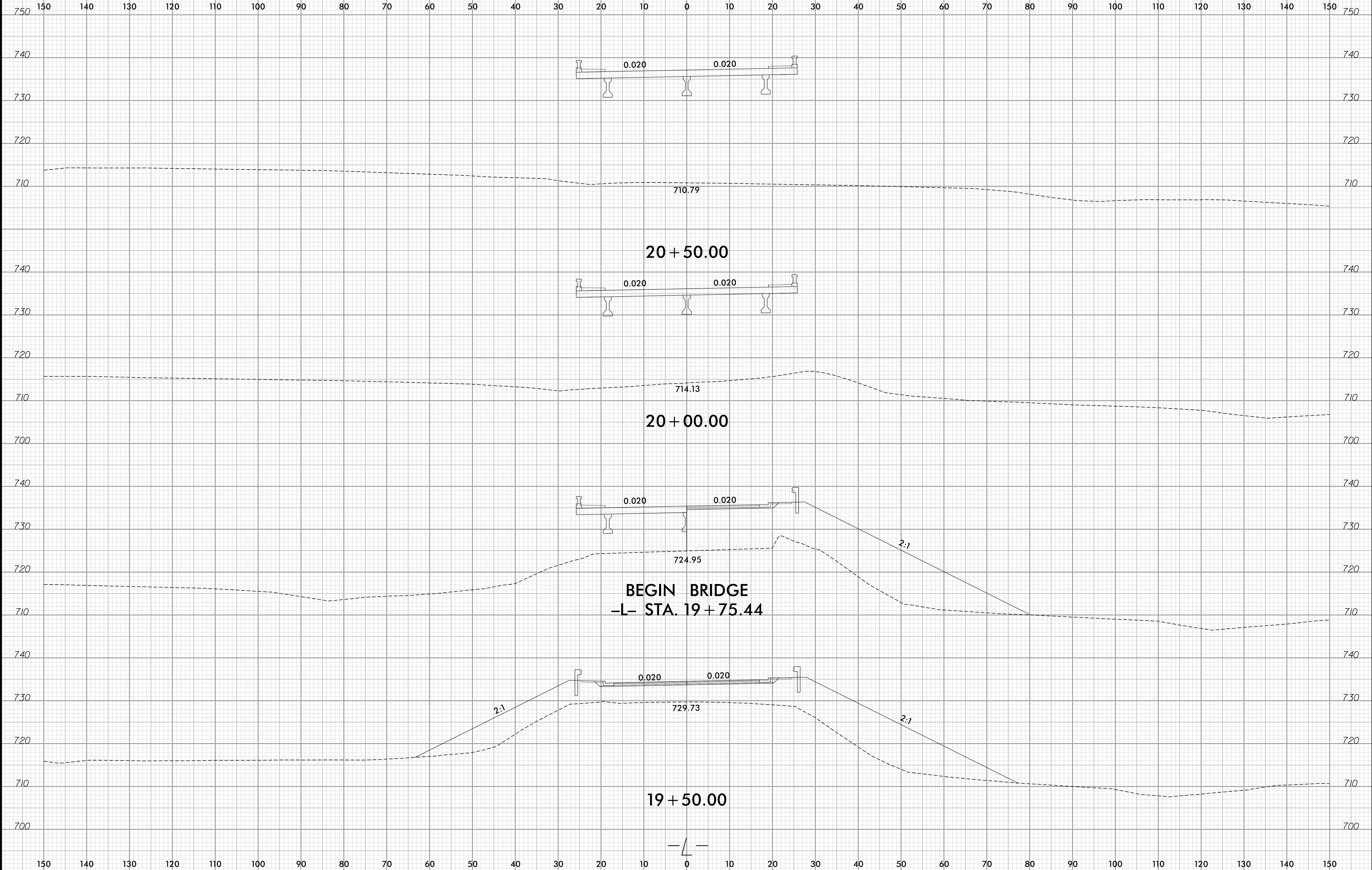

8/13/2024 14:21:16 PM
 \\Xsc\B5372\rdy_xpl.dgn
 User:rdconser

6/23/16

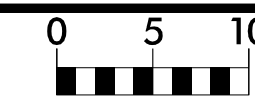

PROJ. REFERENCE NO.	SHEET NO.
B-5372	X-6

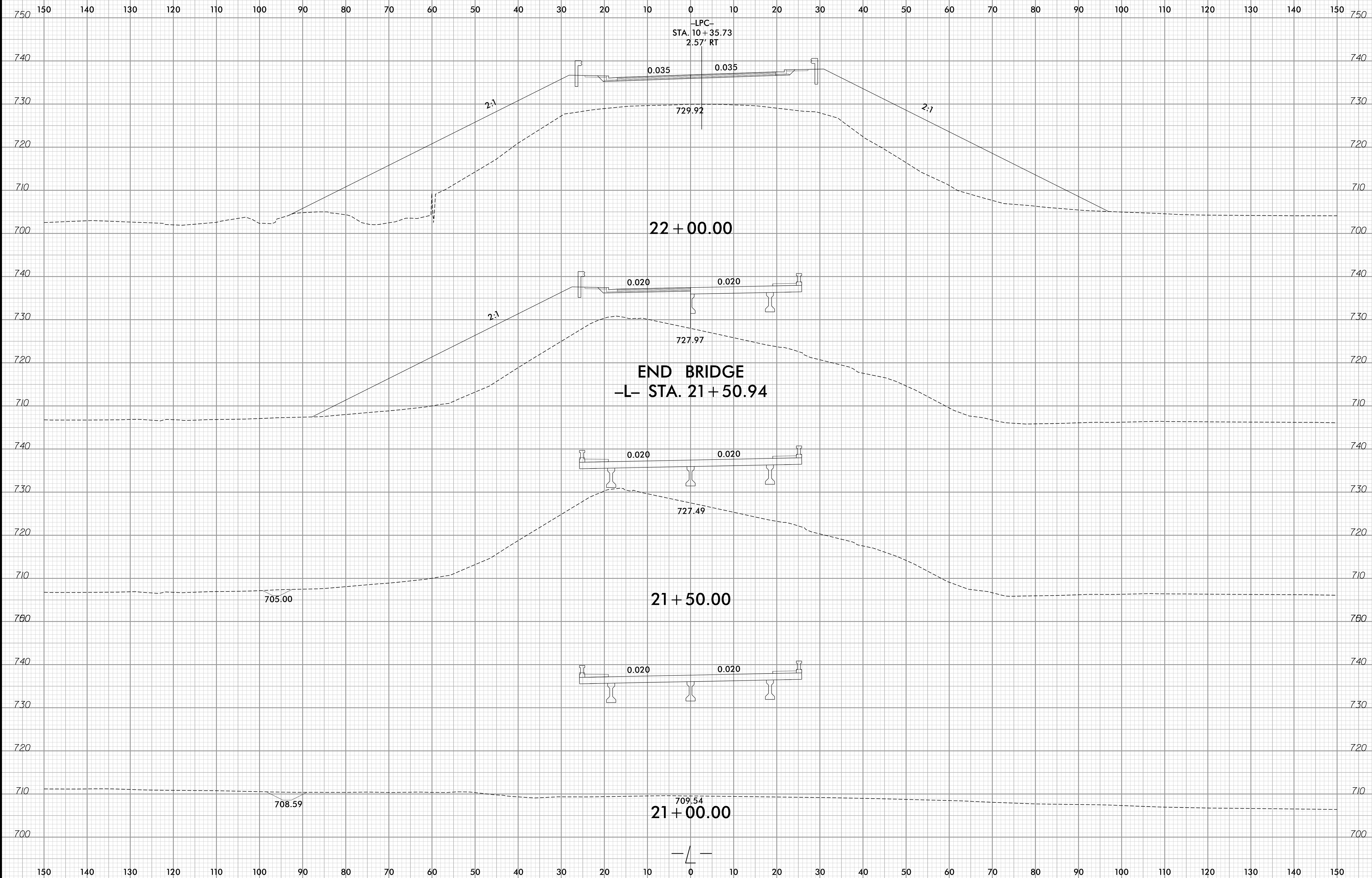

8/13/2024 14:21:16 PM
User: jldc@esri.com

6/23/16

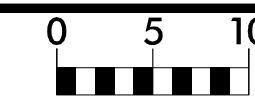

PROJ. REFERENCE NO. B-5372	SHEET NO. X-7
-------------------------------	------------------

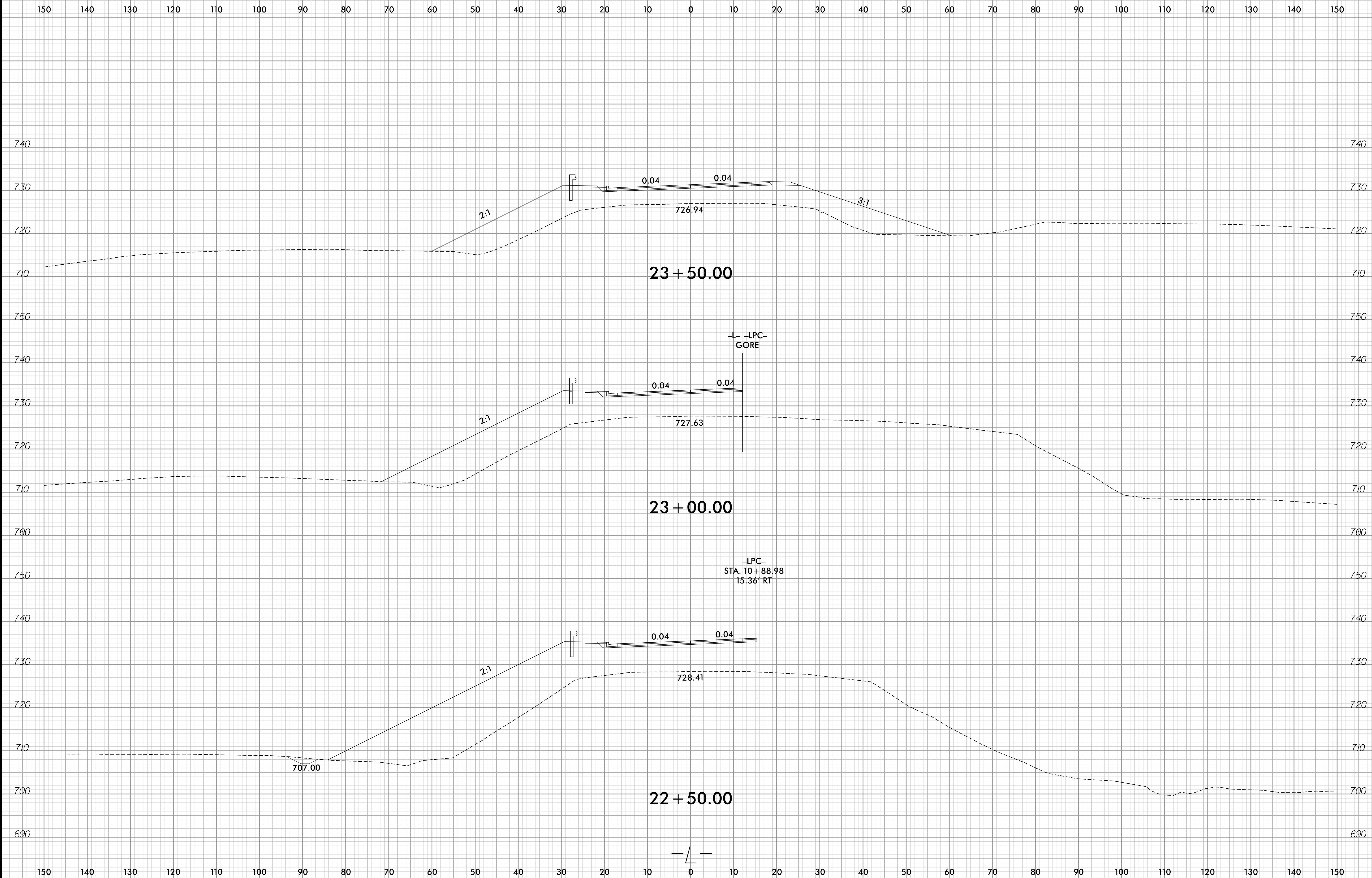

8/13/2024 1:42:16 PM
User: jldc@conser

6/23/16

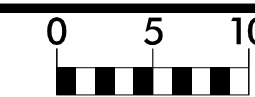

PROJ. REFERENCE NO.	SHEET NO.
B-5372	X-8

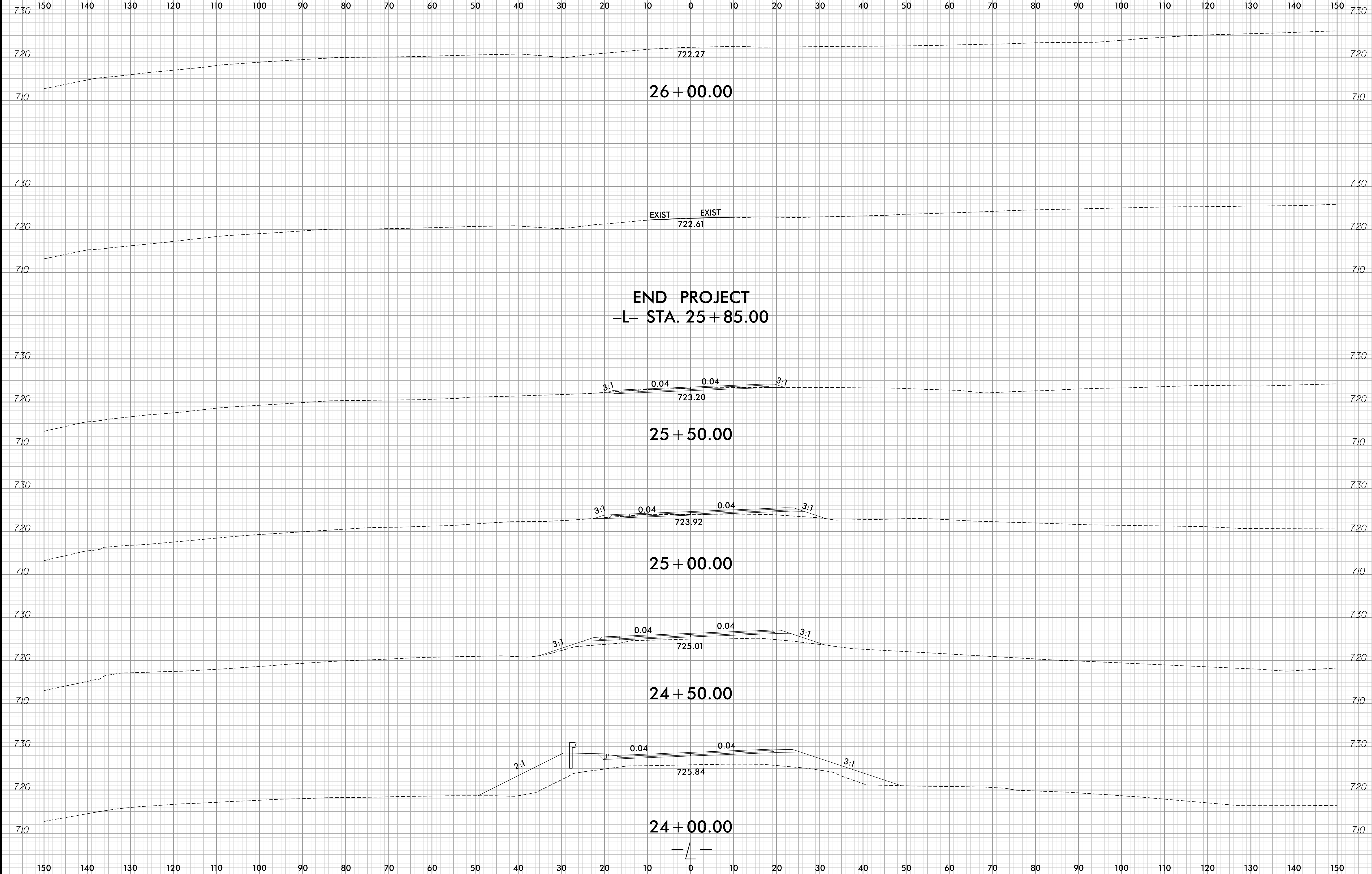

8/13/2024 14:21:16 PM
 \\Xsc\B5372\rdy\xp1.dgn
 User:rdconser

6/22/16

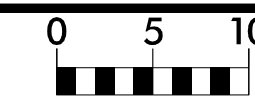

PROJ. REFERENCE NO.
B-5372

SHEET NO.
X-9

150 140 130 120 110 100 90 80 70 60 50 40 30 20 10 0 10 20 30 40 50 60 70 80 90 100 110 120 130 140 150

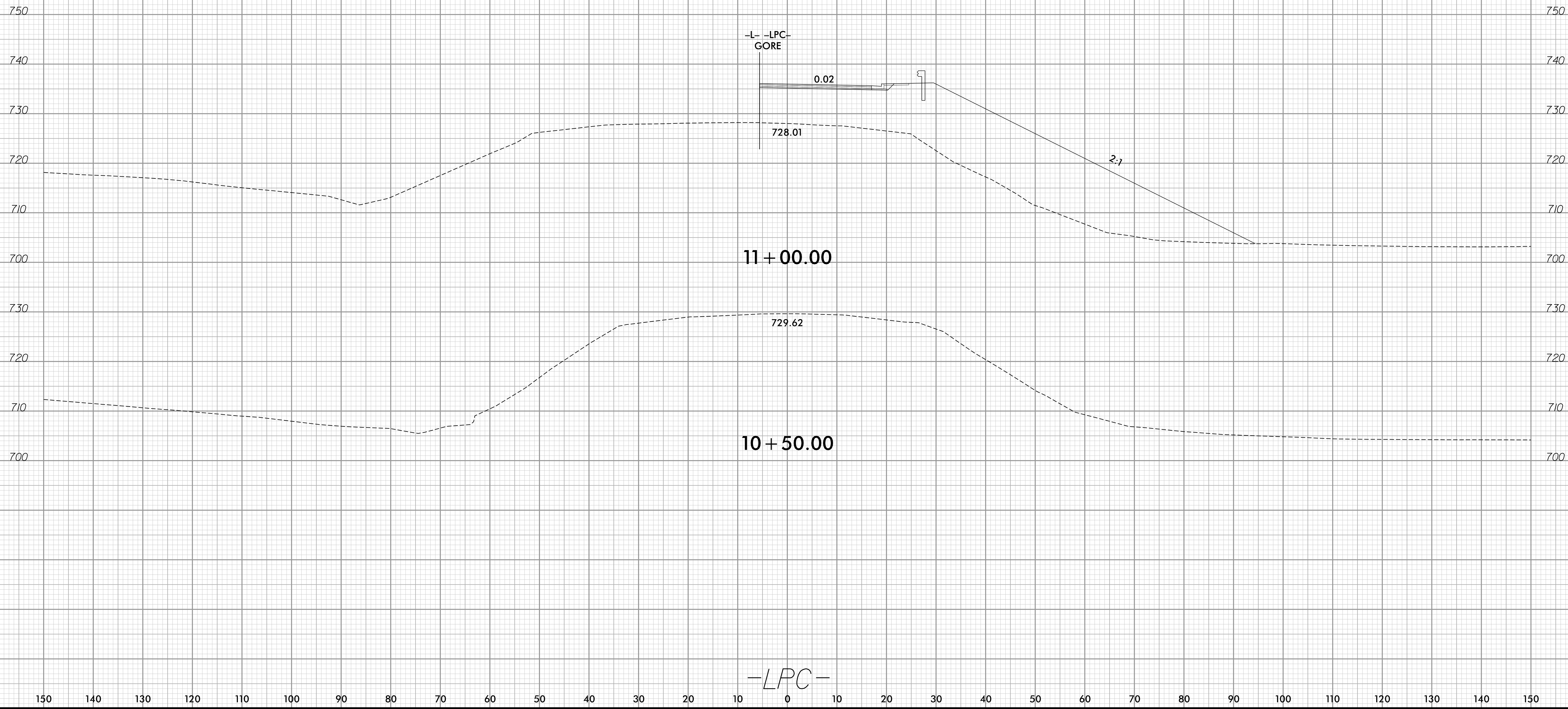

8/12/2024 4:57:28 PM
 ..\Xsec\B5372\rdy_xpl_LPC.dgn
 User:rlccorser

6/23/16

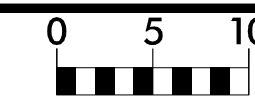

PROJ. REFERENCE NO.	SHEET NO.
B-5372	X-10

150 140 130 120 110 100 90 80 70 60 50 40 30 20 10 0 10 20 30 40 50 60 70 80 90 100 110 120 130 140 150

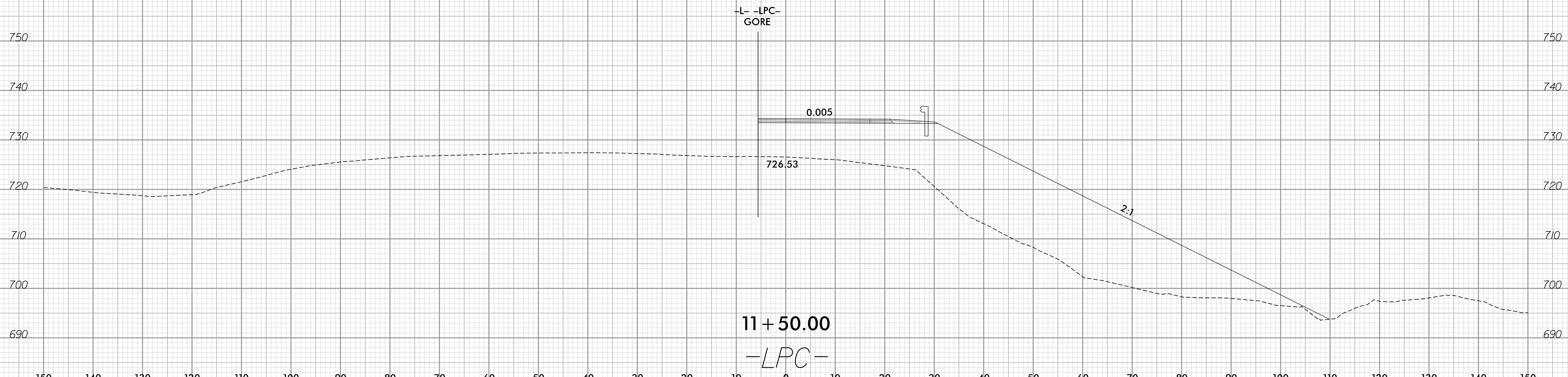
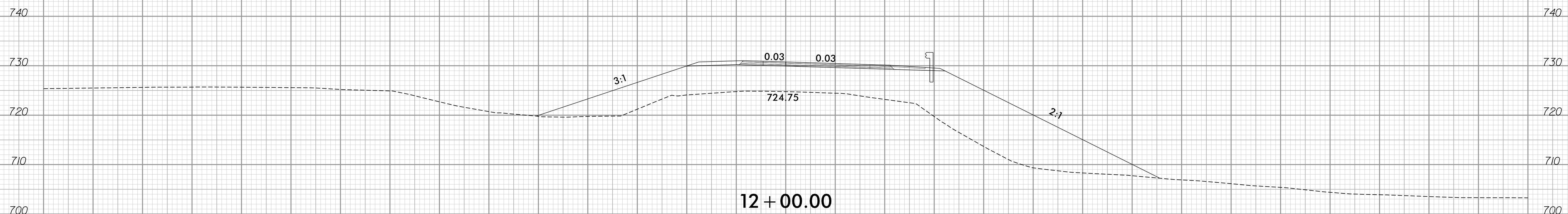
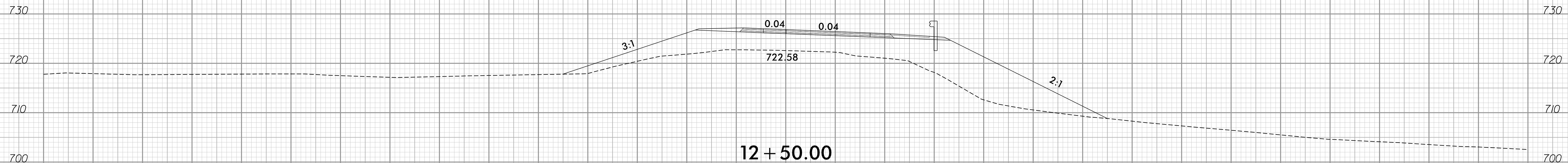

150 140 130 120 110 100 90 80 70 60 50 40 30 20 10 0 10 20 30 40 50 60 70 80 90 100 110 120 130 140 150

8/12/2024 4:57:28 PM
 ..\Xsec\B5372\rdy_xpl_LPC.dgn
 User:rlcconser

6/23/16

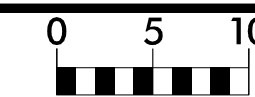

PROJ. REFERENCE NO.	SHEET NO.
B-5372	X-11

150 140 130 120 110 100 90 80 70 60 50 40 30 20 10 0 10 20 30 40 50 60 70 80 90 100 110 120 130 140 150

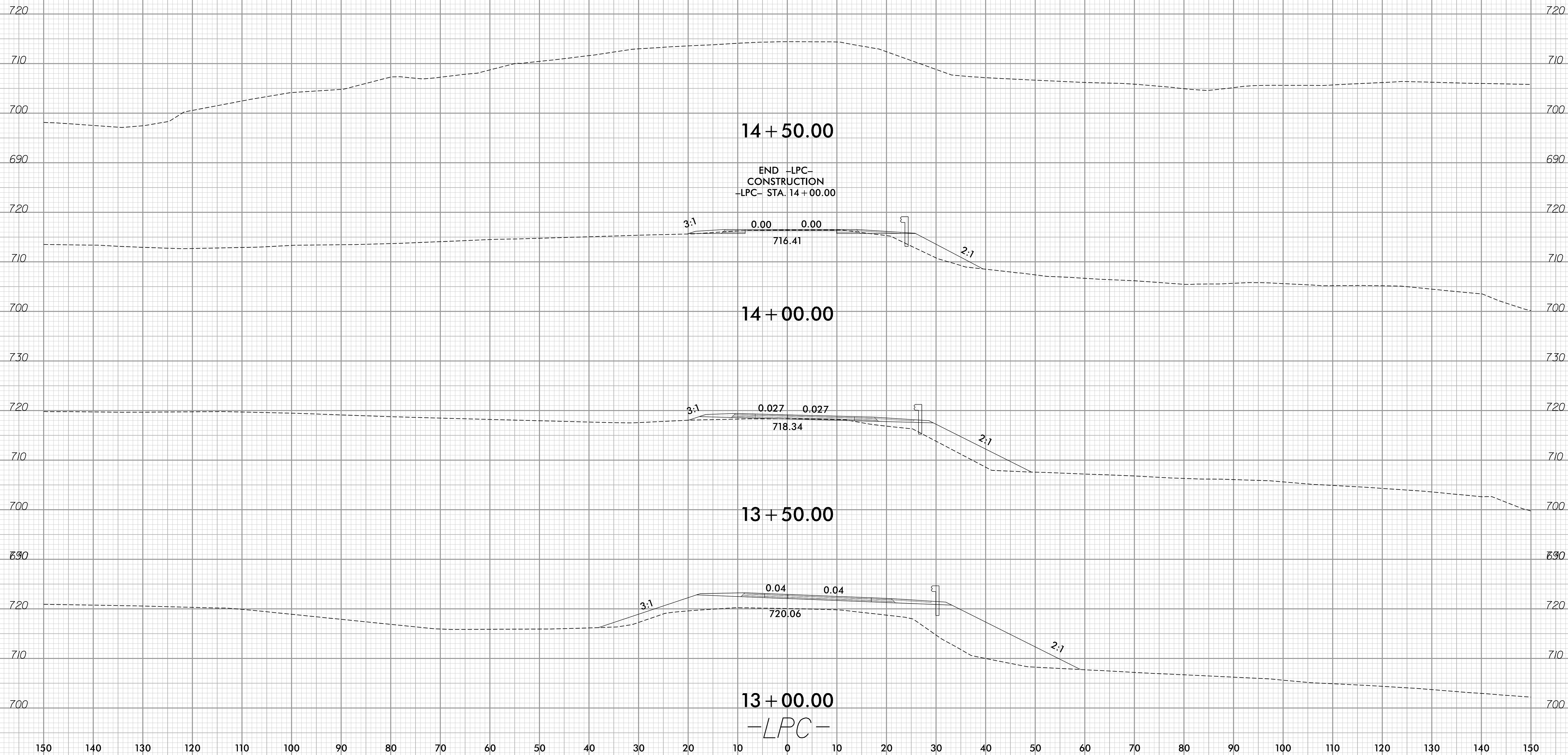

8/12/2024 4:57:28 PM
 ..\Xsec\B5372\rdy_xpl_LPC.dgn
 User:jdconner

6/23/16

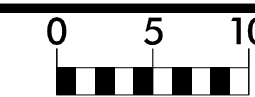

PROJ. REFERENCE NO.
B-5372

SHEET NO.
X-12

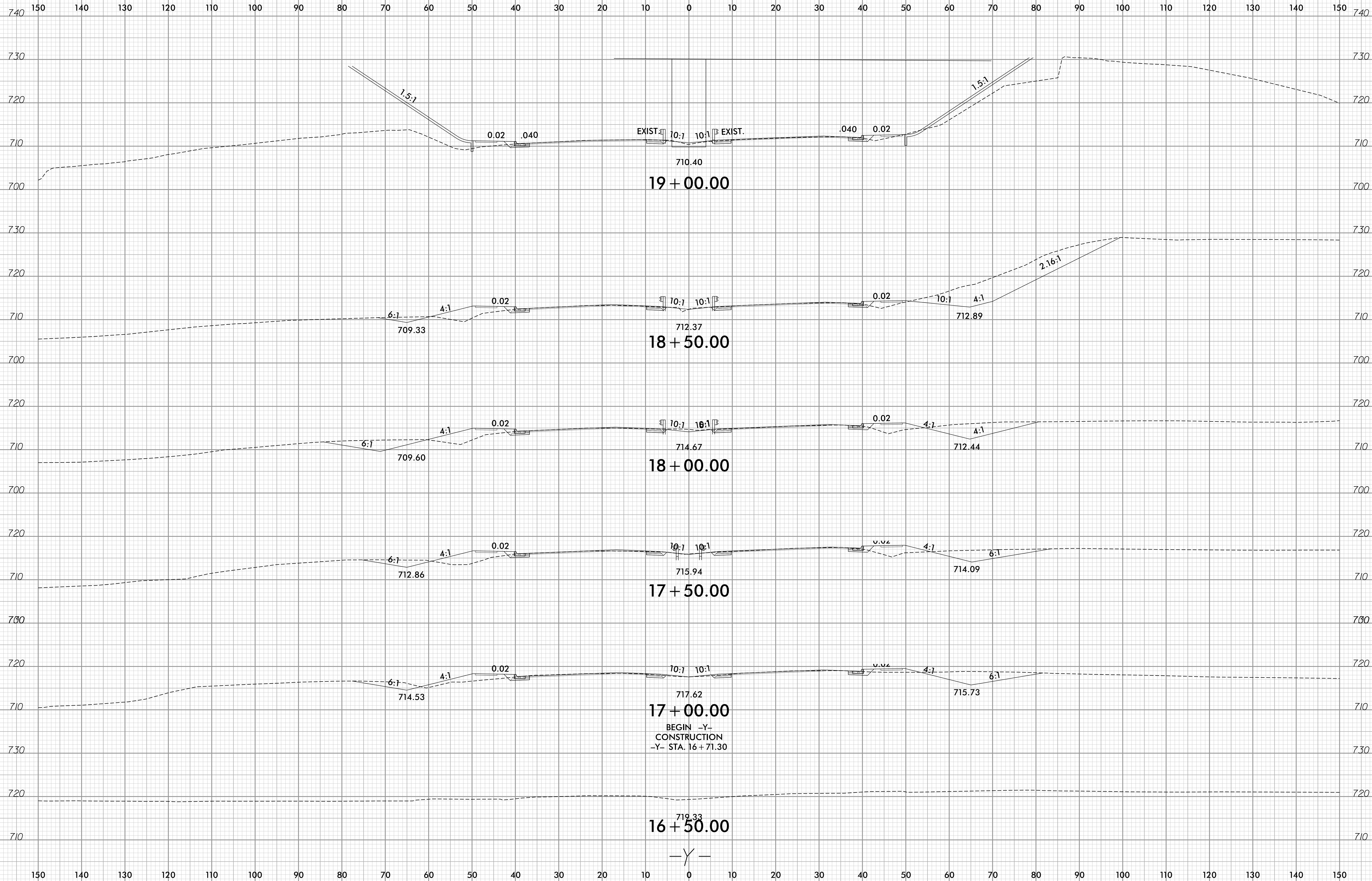

8/12/2024 4:58:47 PM
..X:\sc\B5372\rdy_xpl_Y.dgn
User:rdy

6/23/16

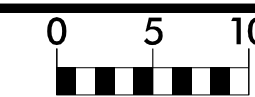

PROJ. REFERENCE NO.
B-5372

SHEET NO.
X-13

150 140 130 120 110 100 90 80 70 60 50 40 30 20 10 0 10 20 30 40 50 60 70 80 90 100 110 120 130 140 150

END -Y-
CONSTRUCTION
-Y- STA. 21+59.64

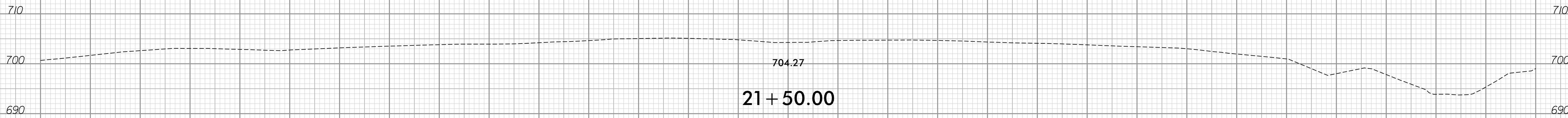

21 + 50.00

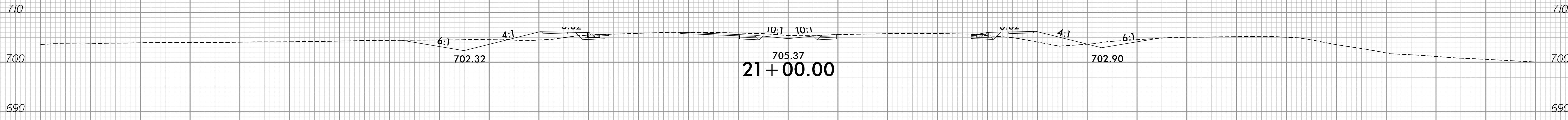

21 + 00.00

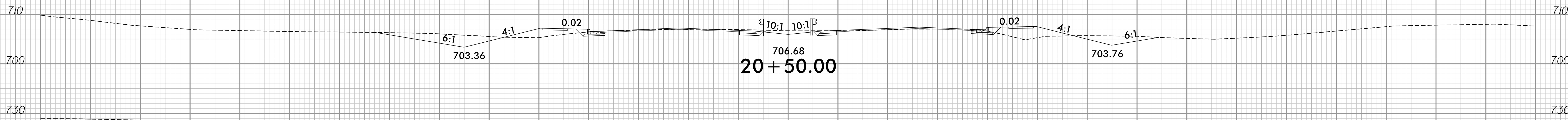

20 + 50.00

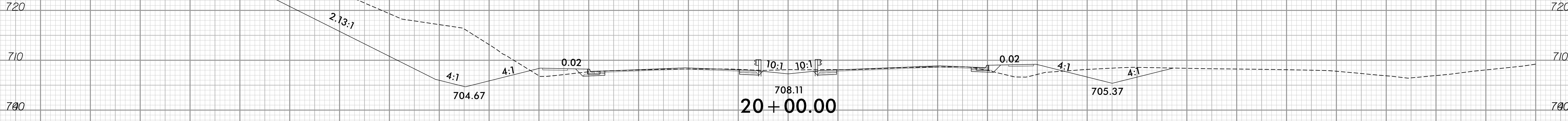

20 + 00.00

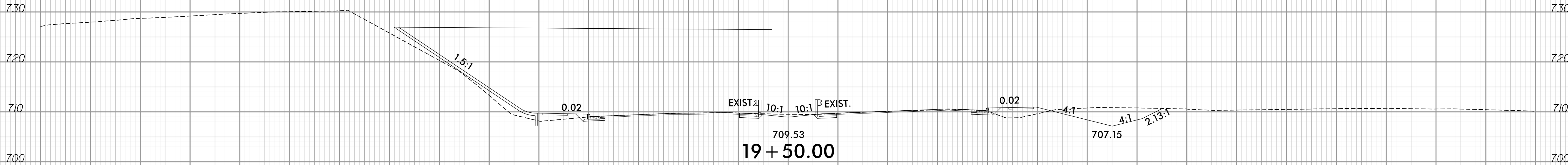

19 + 50.00

-Y-

150 140 130 120 110 100 90 80 70 60 50 40 30 20 10 0 10 20 30 40 50 60 70 80 90 100 110 120 130 140 150

8/12/2024 4:58:47 PM
..\\Xsec\B5372\rdy_xpl_Y.dgn
User:rdy

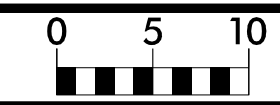

PROJ. REFERENCE NO.
B-5372

SHEET NO.
X-14

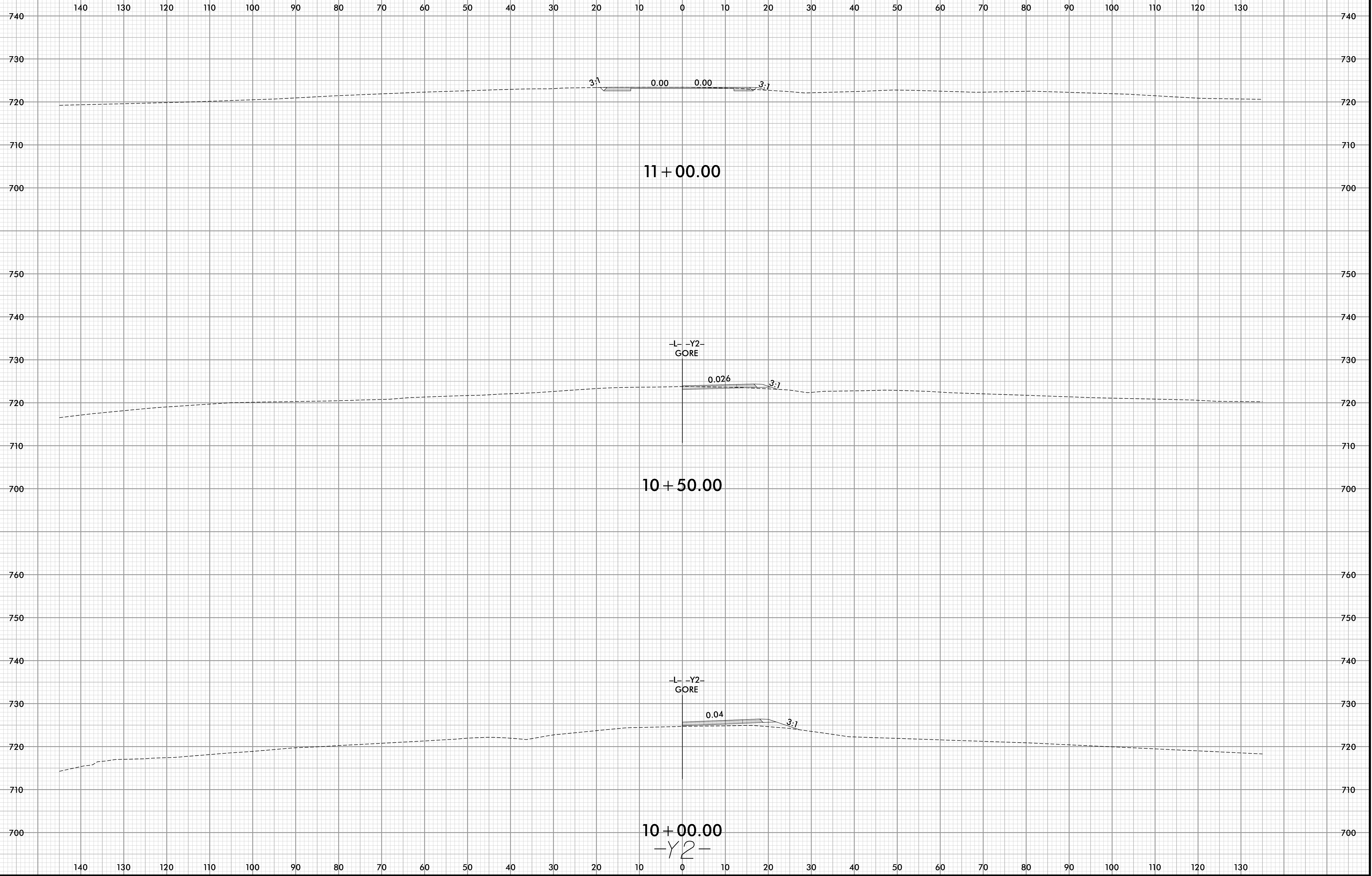

8/12/2024 5:01:10 PM
\\Xsc\B5372\rdy\xp1\Y2.dgn
User:jdconner

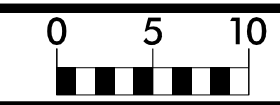

PROJ. REFERENCE NO.
B-5372

SHEET NO.
X-15

140 130 120 110 100 90 80 70 60 50 40 30 20 10 0 10 20 30 40 50 60 70 80 90 100 110 120 130

740

740

END -Y2-
CONSTRUCTION
-Y2- STA. 11+19.75

730

730

3:1

EXIST

EXIST

3:1

720

720

11+19.75

710

710

-Y2-

700

700

140 130 120 110 100 90 80 70 60 50 40 30 20 10 0 10 20 30 40 50 60 70 80 90 100 110 120 130

8/12/2024 5:01:10 PM
\\Xsc\B5372\rdy_xpl_Y2.dgn
User:rdy