

CULVERT CONSTRUCTION SEQUENCE STA. 22+40 -L-

PHASE II

1. WHILE MAINTAINING A TEMPORARY CONNECTION OF THE STREAM FLOW TO THE EXISTING PIPE, JACK AND BORE THE PROPOSED 72" WELDED STEEL PIPE.
2. CONSTRUCT UPSTREAM AND DOWNSTREAM CHANNEL IMPROVEMENTS.
3. ESTABLISH PUMP AROUND OPERATION, THEN RE-DIRECT FLOW FROM TEMPORARY CHANNEL TO PERMANENT CHANNEL. UTILIZE SPECIAL STILLING BASINS AS NEEDED.
4. FILL EXISTING 66" RCP WITH FLOWABLE FILL AND FILL IN ALL REMNANT CHANNELS.

NOTES: UTILIZE SPECIAL STILLING BASIN(S) AS NEEDED DURING CULVERT CONSTRUCTION.

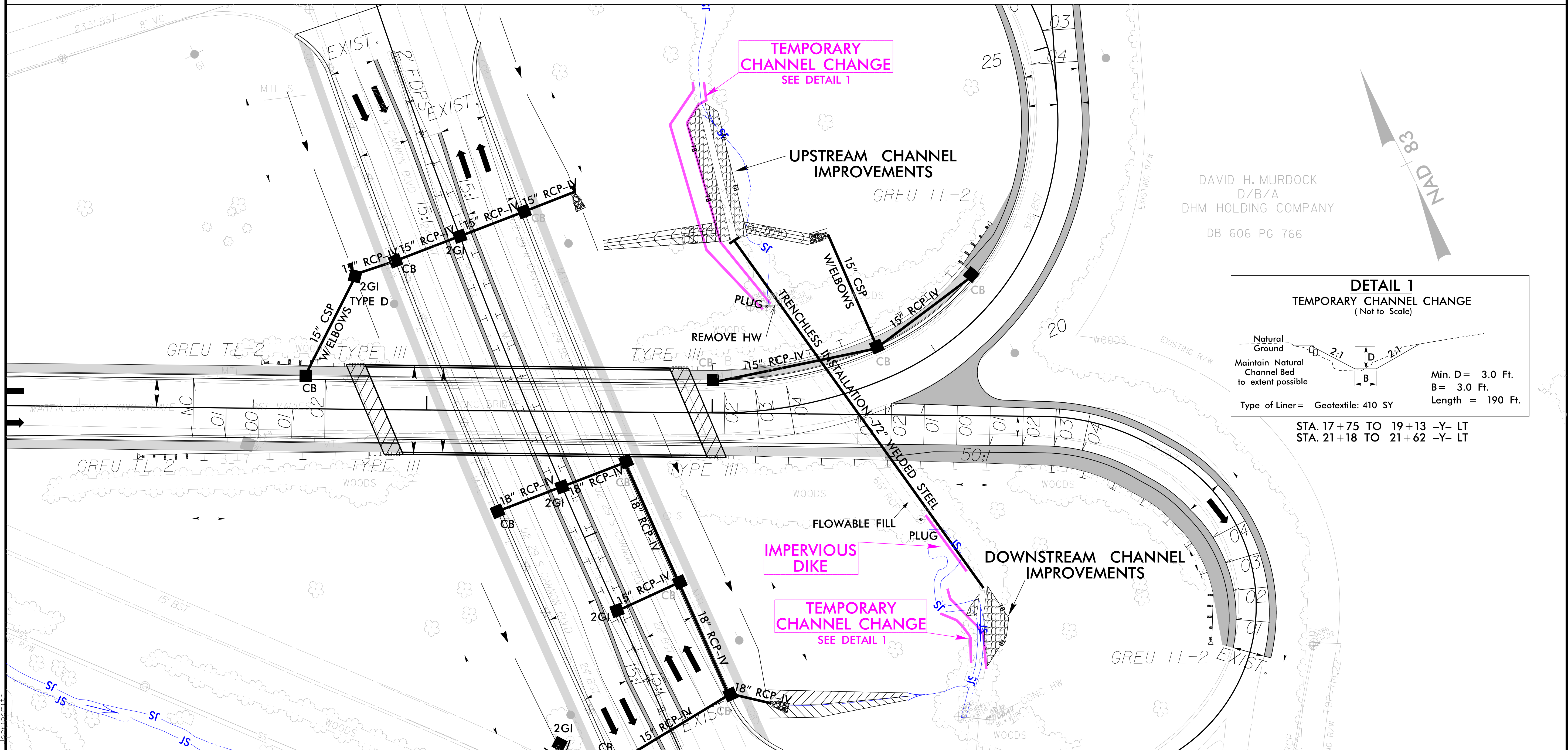

DAVID H. MURDOCK
D/B/A
DHM HOLDING COMPANY
DB 606 PG 766

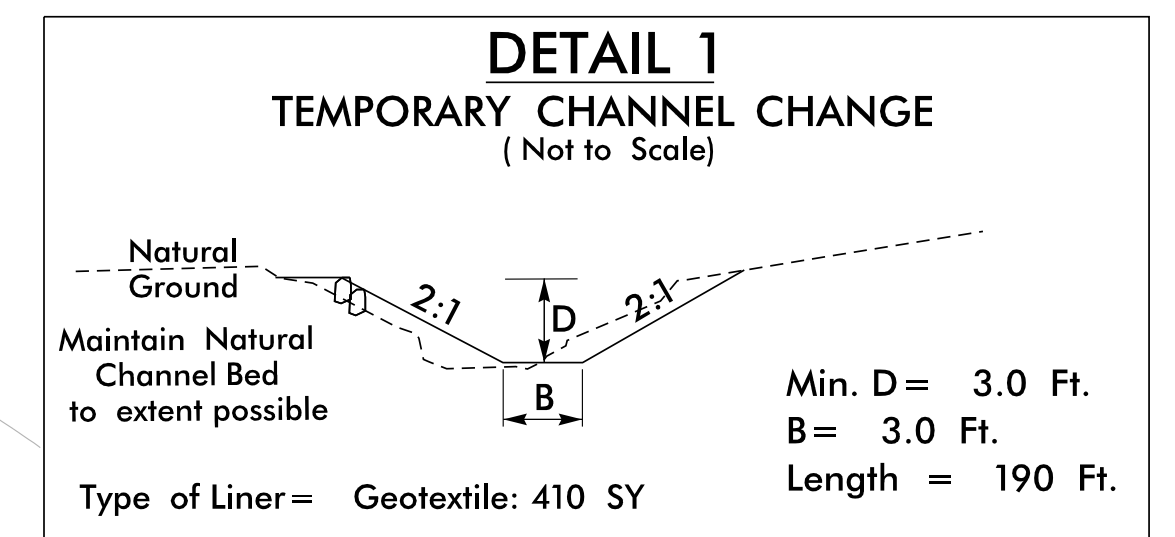

STA. 17+75 TO 19+13 -Y- LT
STA. 21+18 TO 21+62 -Y- LT