

PROJECT REFERENCE NO.		SHEET NO.	
B-5372		EC-4A/CONST.04	
ROADWAY DESIGN ENGINEER		HYDRAULICS ENGINEER	

# CULVERT CONSTRUCTION SEQUENCE STA. 22+40 -L-

## PHASE I

1. INSTALL TEMPORARY CHANNEL CHANGE AT INLET END AND OUTLET END OF EXISTING 66" RCP.
2. INSTALL IMPERVIOUS DIKE.

NOTES: UTILIZE SPECIAL STILLING BASIN(S) AS NEEDED DURING CULVERT CONSTRUCTION.

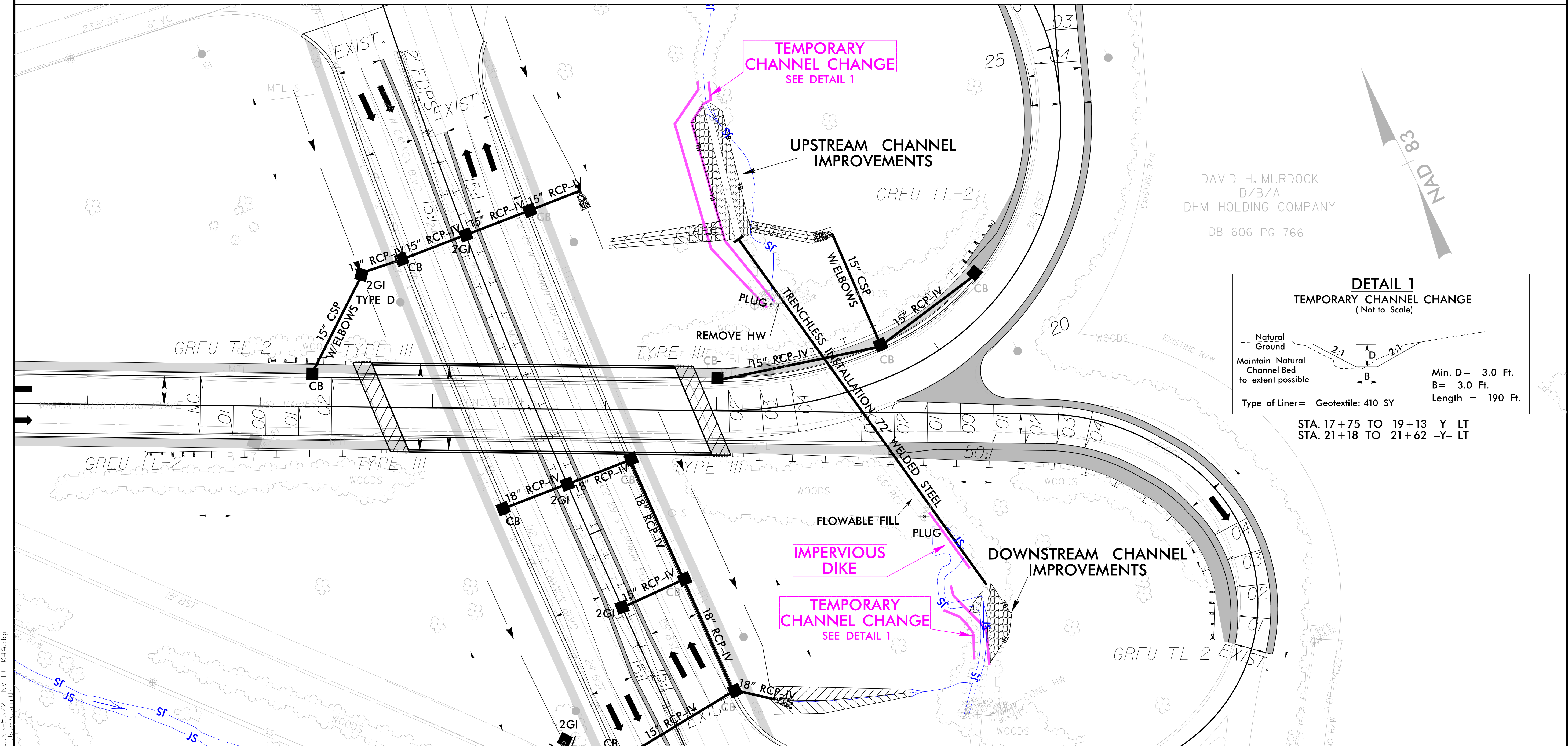

DAVID H. MURDOCK  
D/B/A  
DHM HOLDING COMPANY  
DB 606 PG 766

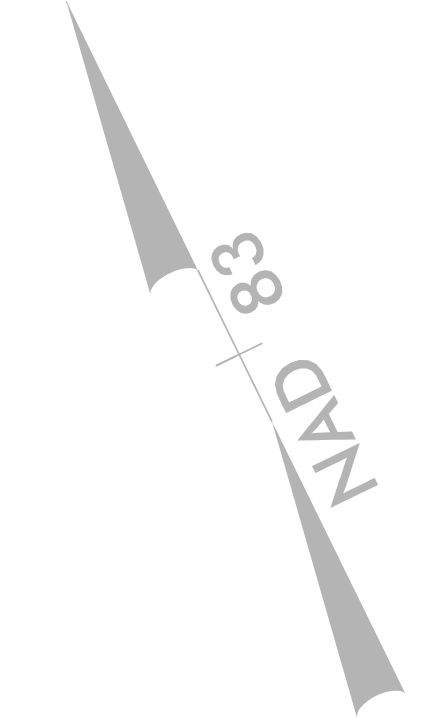

**DETAIL 1**  
TEMPORARY CHANNEL CHANGE  
(Not to Scale)

STA. 17+75 TO 19+13 -Y- LT  
STA. 21+18 TO 21+62 -Y- LT