

09/28/2024

TIP PROJECT: B-5372

CONTRACT: C204384

See Sheet 1A For Index of Sheets  
See Sheet 1B For Conventional Plan Sheet Symbols

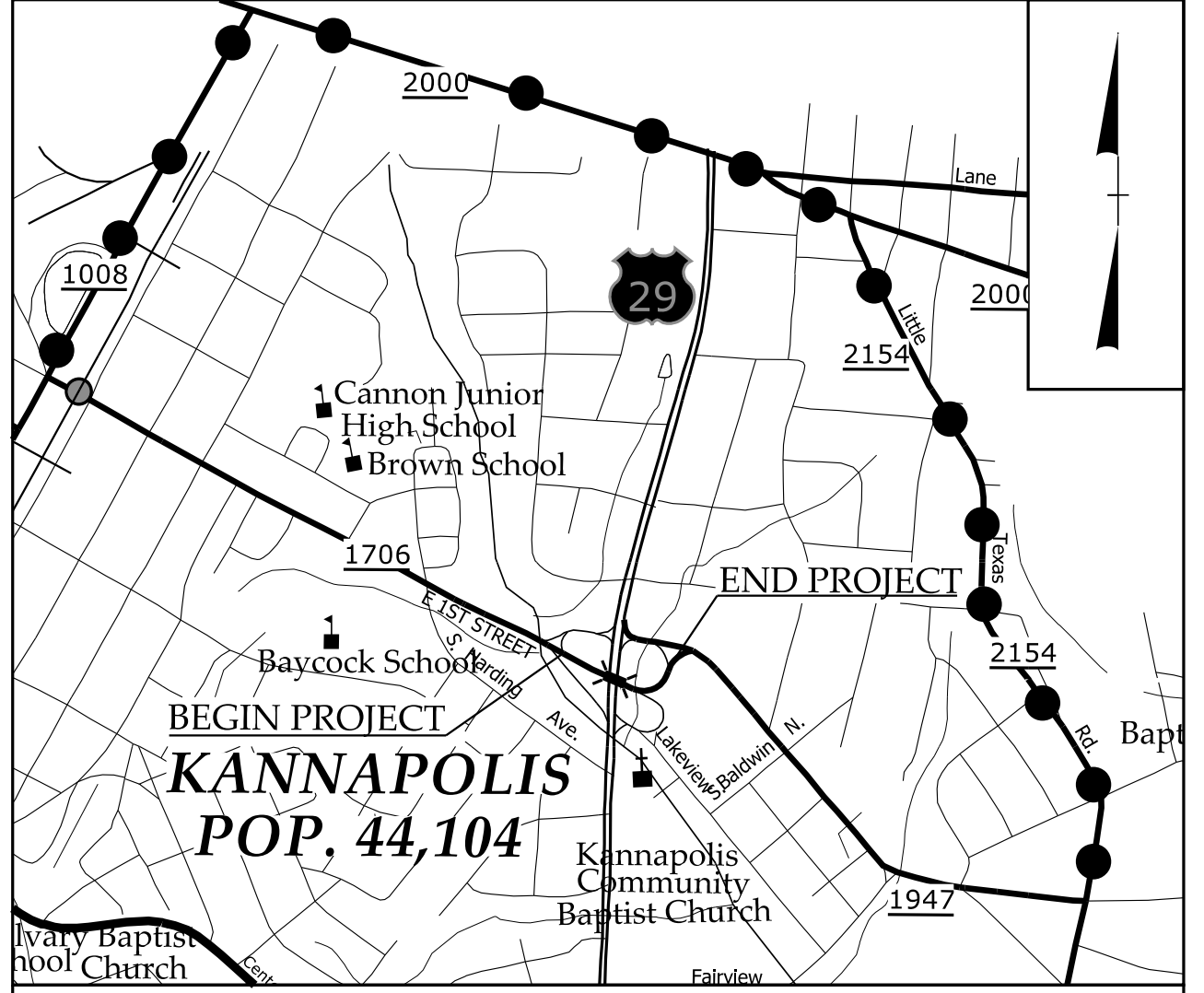

VICINITY MAP (N.T.S.)  
OFF-SITE DETOUR

# STATE OF NORTH CAROLINA DIVISION OF HIGHWAYS CABARRUS COUNTY

LOCATION: REPLACE BRIDGE NO. 120109 ON SR 1706 (MARTIN LUTHER KING JR. AVE.)  
OVER US 29 (N. CANNON BLVD.)  
TYPE OF WORK: GRADING, DRAINAGE, PAVING AND STRUCTURE

STATE	STATE PROJECT REFERENCE NO.	SHEET NO.	TOTAL SHEETS
N.C.	B-5372	1	
STATE PROJ. NO.	F.A. PROJ. NO.	DESCRIPTION	
46087.1.1		P.E.	
46087.2.1		ROW/UTILITY	
46087.3.1		CONST.	

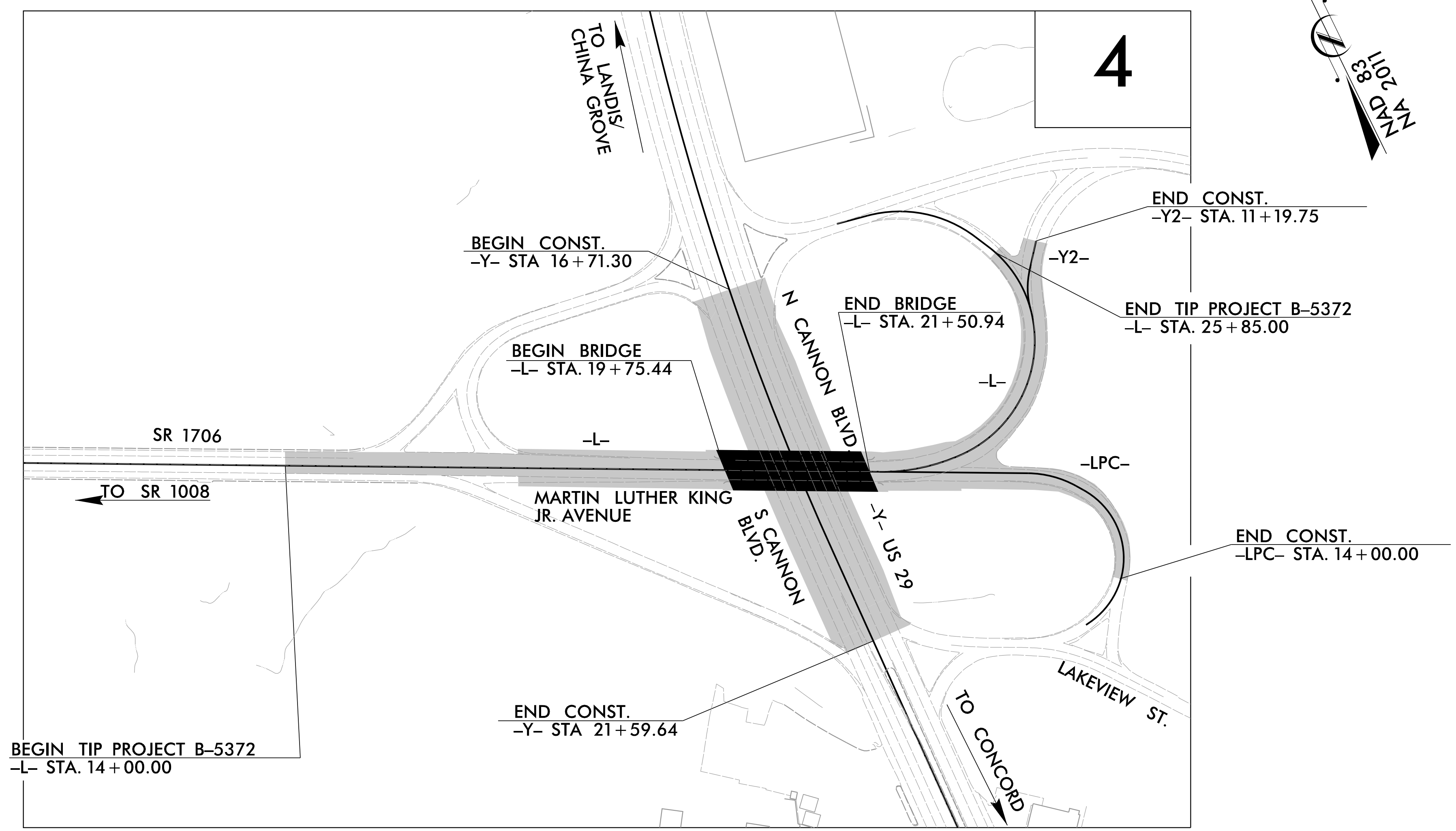

DOCUMENT NOT CONSIDERED FINAL  
UNLESS ALL SIGNATURES COMPLETED

### GRAPHIC SCALES

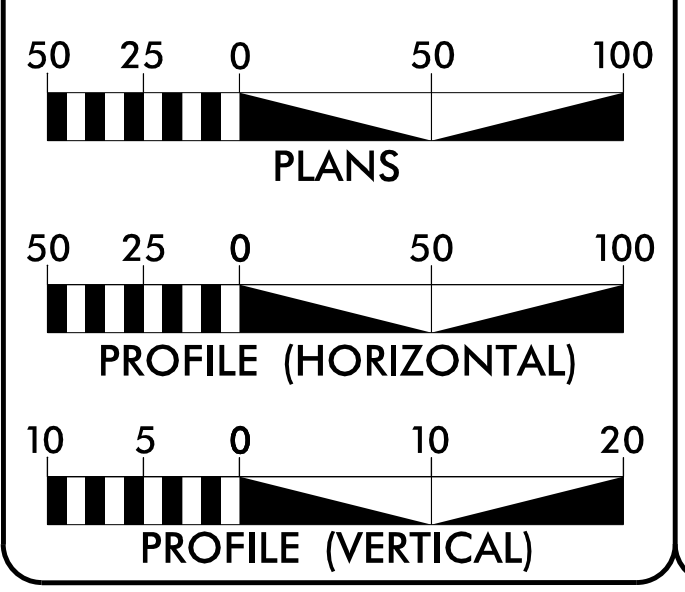

### DESIGN DATA

ADT 2024 = 3,936  
 ADT 2044 = 6,016  
 K = 11%  
 D = 55%  
 T = 5% \*  
 V = 40 MPH  
 \* TTST = 1% DUAL = 4%  
 FUNC CLASS = MINOR COLLECTOR  
 SUB-REGIONAL TIER

### PROJECT LENGTH

LENGTH OF ROADWAY TIP PROJECT B-5372 = 0.191 MILES  
 LENGTH OF STRUCTURE TIP PROJECT B-5372 = 0.033 MILES  
 TOTAL LENGTH OF TIP PROJECT B-5372 = 0.224 MILES

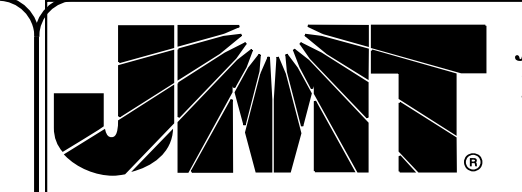

Johnson, Mirmiran, & Thompson Inc.  
 2550 West Tyvola Road, Suite 120,  
 Charlotte, NC, 28217  
 License No: C-3097

2024 STANDARD SPECIFICATIONS

RIGHT OF WAY DATE:  
 MARCH 21, 2024

LETTING DATE:  
 DECEMBER 17, 2024

REECE M. SCHULER, P.E., P.L.S.  
 PROJECT ENGINEER

ALEX FITZPATRICK  
 PROJECT DESIGN ENGINEER

DAVID STUTTS, P.E.  
 NCDOT CONTACT

### HYDRAULICS ENGINEER

DocuSigned by:  
 Reece M. Schuler  
 SIGNATURE:  
 P.E. 10/28/2024

### ROADWAY DESIGN ENGINEER

DocuSigned by:  
 Reece M. Schuler  
 SIGNATURE:  
 P.E. 10/28/2024

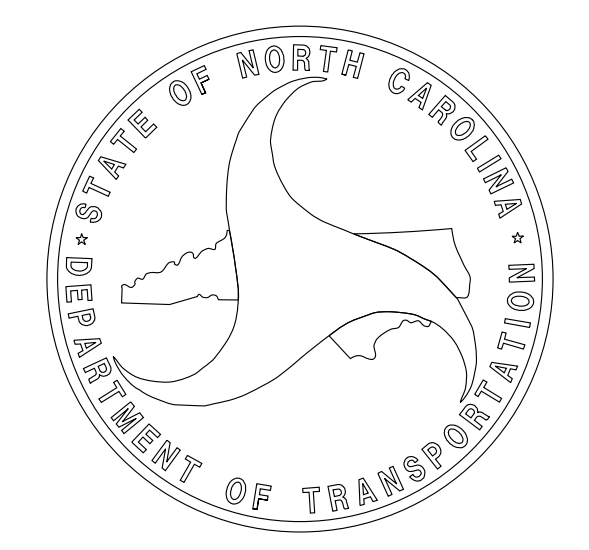
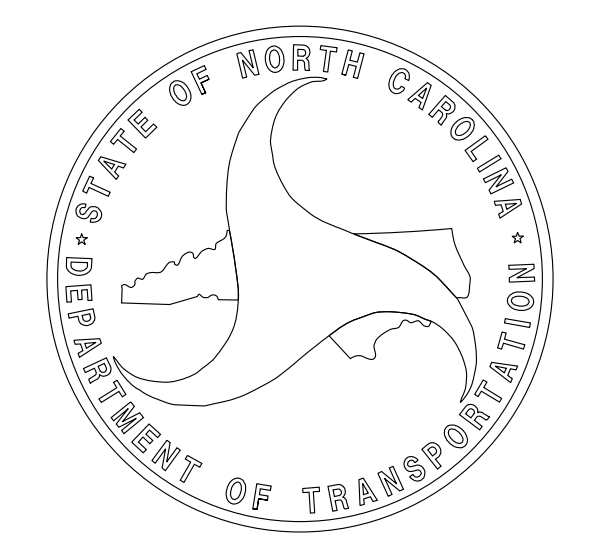
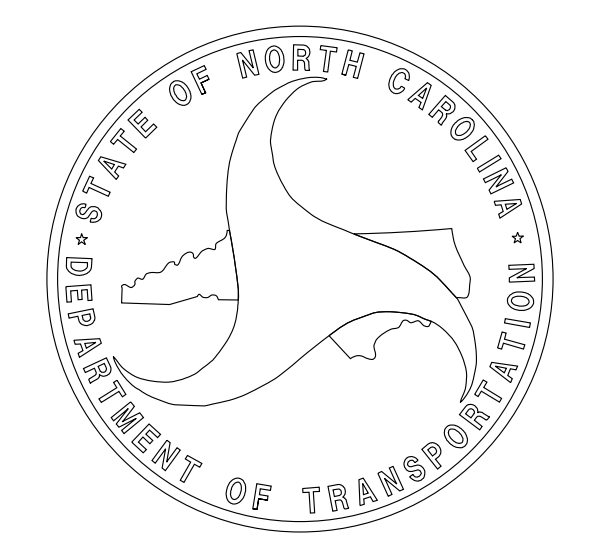
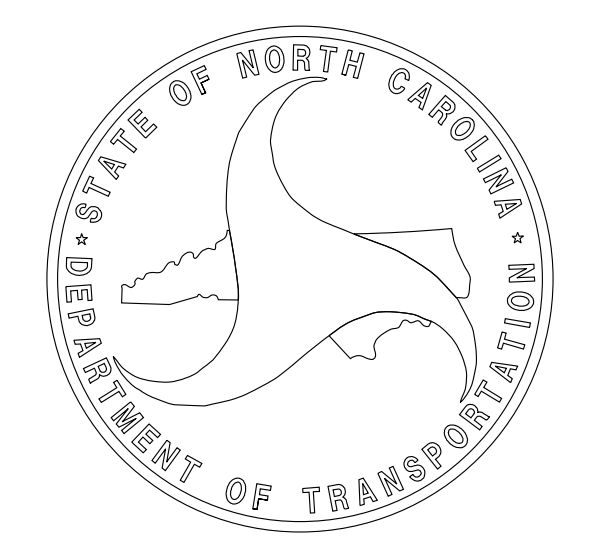

10/28/2024 10:02:01 AM  
...Sheets\_B-5372\_rdy\_tsh.dgn  
User:amfitzpatrick