

09.08/99

TIP PROJECT: W-5601EY

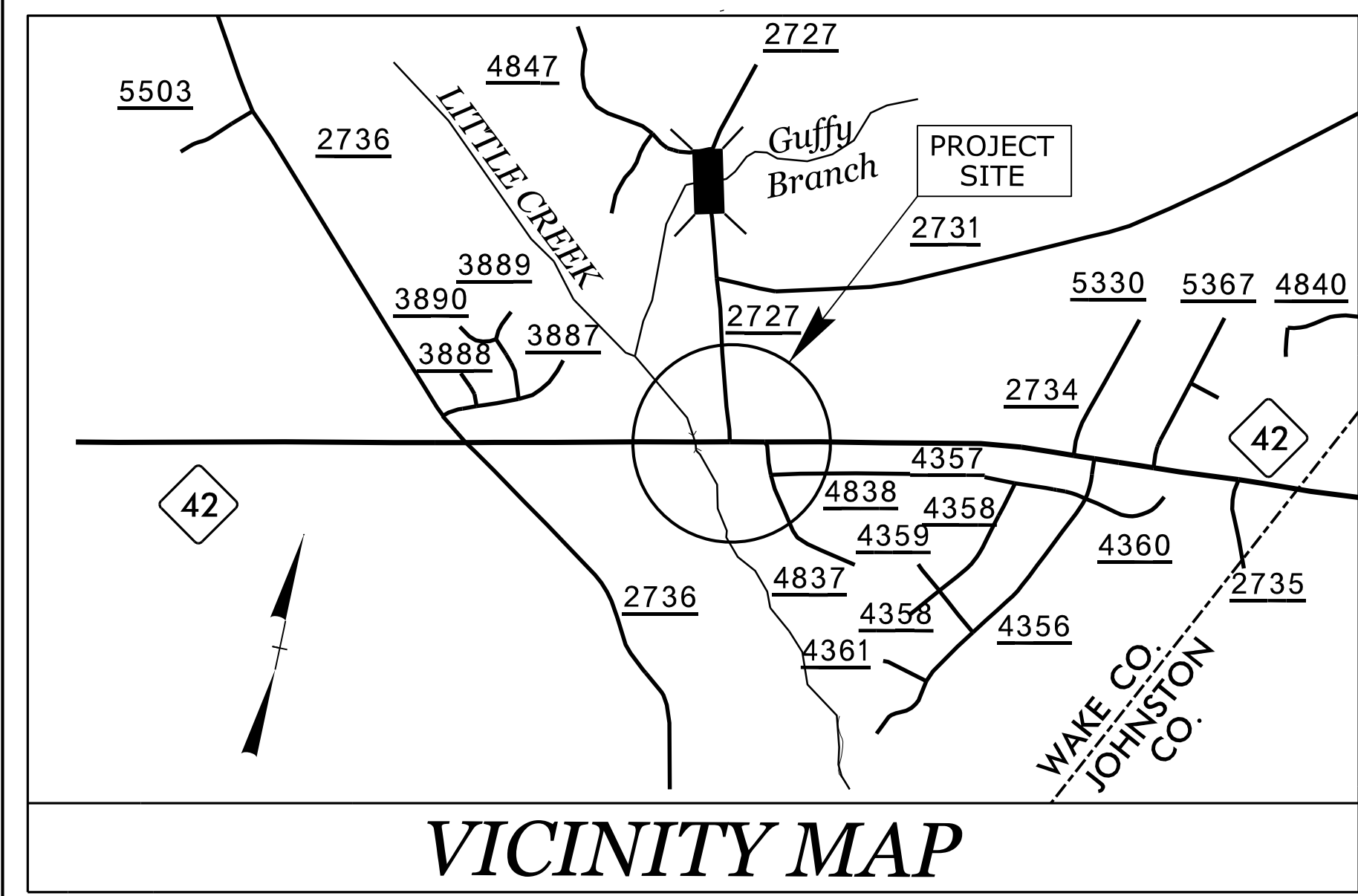

VICINITY MAP

STATE OF NORTH CAROLINA
DIVISION OF HIGHWAYS

**UTILITIES BY OTHERS PLANS
WAKE COUNTY**

**LOCATION: CONSTRUCT AN EASTBOUND LEFT TURN
LANE ON NC 42 AT THE SR 2727 (SAULS RD.)
INTERSECTION.**

**TYPE OF WORK: AERIAL POWER, AERIAL AND
BURIED COMMUNICATION RELOCATIONS.**

T.I.P. NO.	SHEET NO.
W-5601EY	UO-1

NOTE:
ALL UTILITY WORK SHOWN ON THIS SHEET WILL BE DONE BY OTHERS. NO PAYMENT WILL BE MADE TO THE CONTRACTOR FOR UTILITY WORK SHOWN ON THIS SHEET.

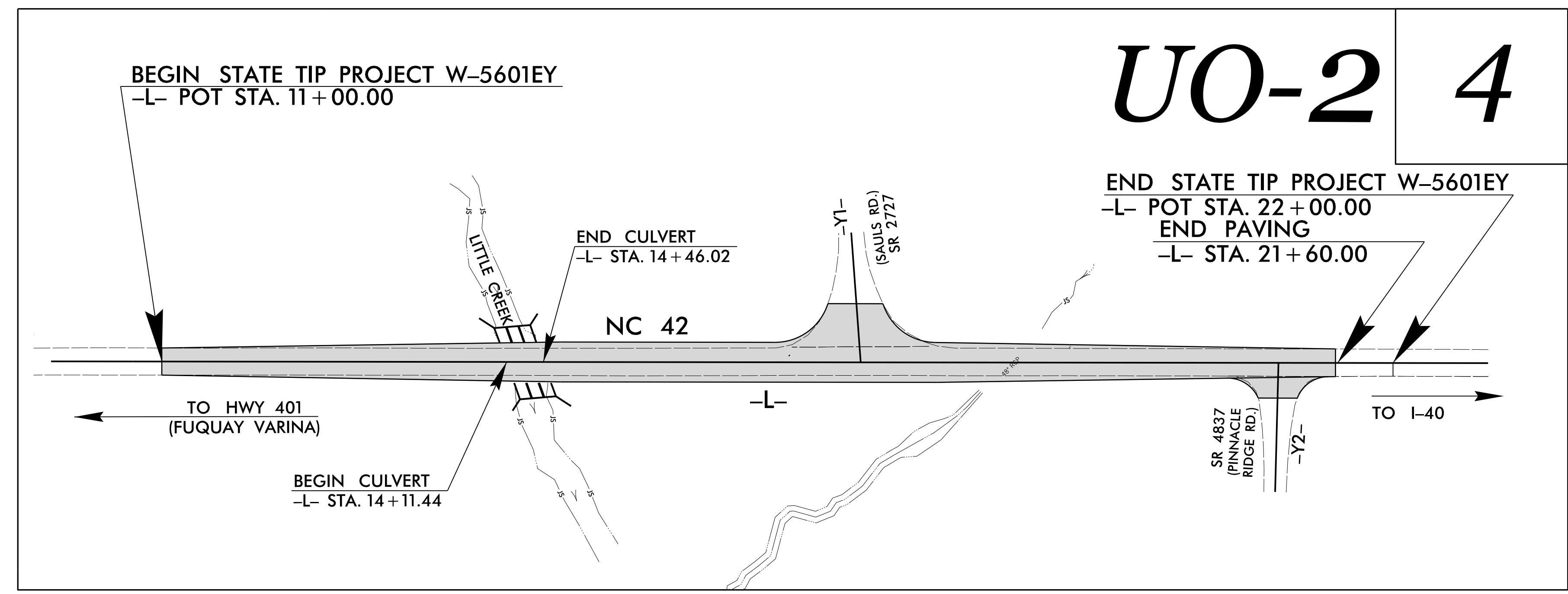
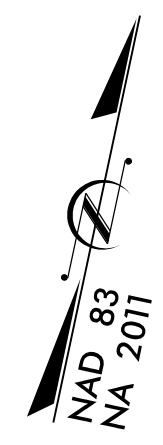

UO-2 4

13-DEC-2021 10:00 AM \\2013\Z213335_05 NCDOT W-5601EY\Utility\290_001\W5601EY_UT_TSH_U001.PSH.dgn \$\$\$SERVNAME\$\$\$

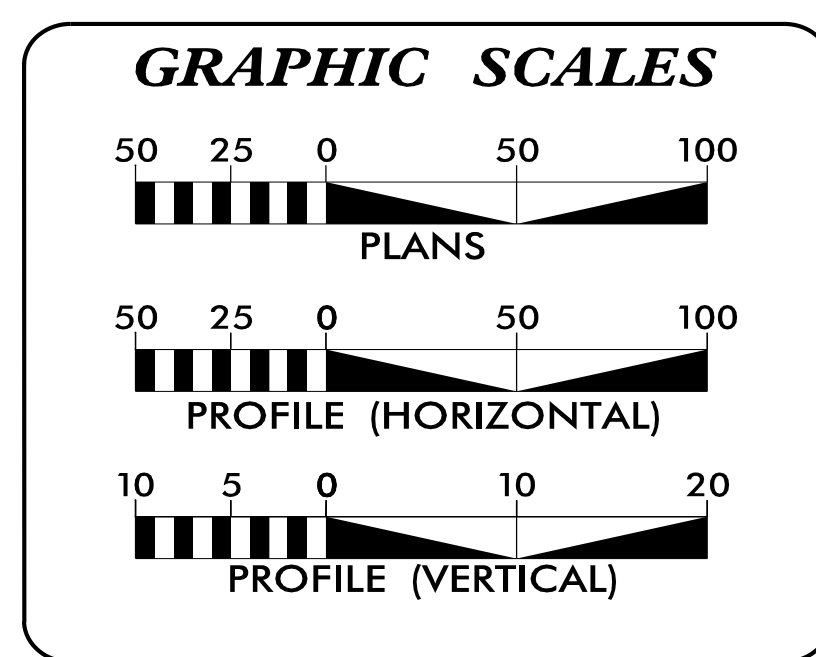

INDEX OF SHEETS

SHEET NO.:	DESCRIPTION:
UO-1	TITLE SHEET
UO-2	UBO PLAN SHEET

- UTILITY OWNERS WITH CONFLICTS**
- (A) DUKE ENERGY - POWER
 - (B) CHARTER /SPECTRUM - COMMUNICATIONS
 - (C) AT&T - COMMUNICATIONS
 - (D) AT&T TRANSMISSION - COMMUNICATIONS

PREPARED IN THE OFFICE OF:

KCI ASSOCIATES OF N.C.
CIVIL ENGINEERS
ENVIRONMENTAL - CEI
LAND SURVEYING
SUBSURFACE UTILITY ENGINEERING
4505 FALLS OF NEUSE RD SUITE 400
RALEIGH, NORTH CAROLINA 27609
(919) 783-9214
WWW.KCI.COM

JOHN FAISON UTILITY PROJECT MANAGER
DANIEL ALLEN PROJECT UTILITY COORDINATOR

**DIVISION OF HIGHWAYS
DIVISION 5**

**PROJECT DELIVERY UNIT
2612 DUKE STREET
DURHAM, NC 27704**

BEN UPSHAW, PE TEAM LEAD
S. REID DAVIDSON, PE DDC ENGINEER
DON PROPER DIV.5 UTILITY ENGINEER
MONROE BROWN DIV.5 UTILITY COORDINATOR

UTILITIES BY OTHERS

ALL PROPOSED UTILITY WORK SHOWN ON THIS SHEET WILL BE DONE BY OTHERS. NO PAYMENT WILL BE MADE TO THE CONTRACTOR FOR PROPOSED UTILITY WORK SHOWN ON THIS SHEET.

5/14/99
 10
 15
 16
 15 DEC 2015 15:14:15
 C:\Users\james.290\OneDrive\Documents\290_003_W5601EY_UT_RDY4_U002_PSH.dgn
 05 NICD015 DEC 2015 15:14:15
 C:\Users\james.290\OneDrive\Documents\290_003_W5601EY_UT_RDY4_U002_PSH.dgn

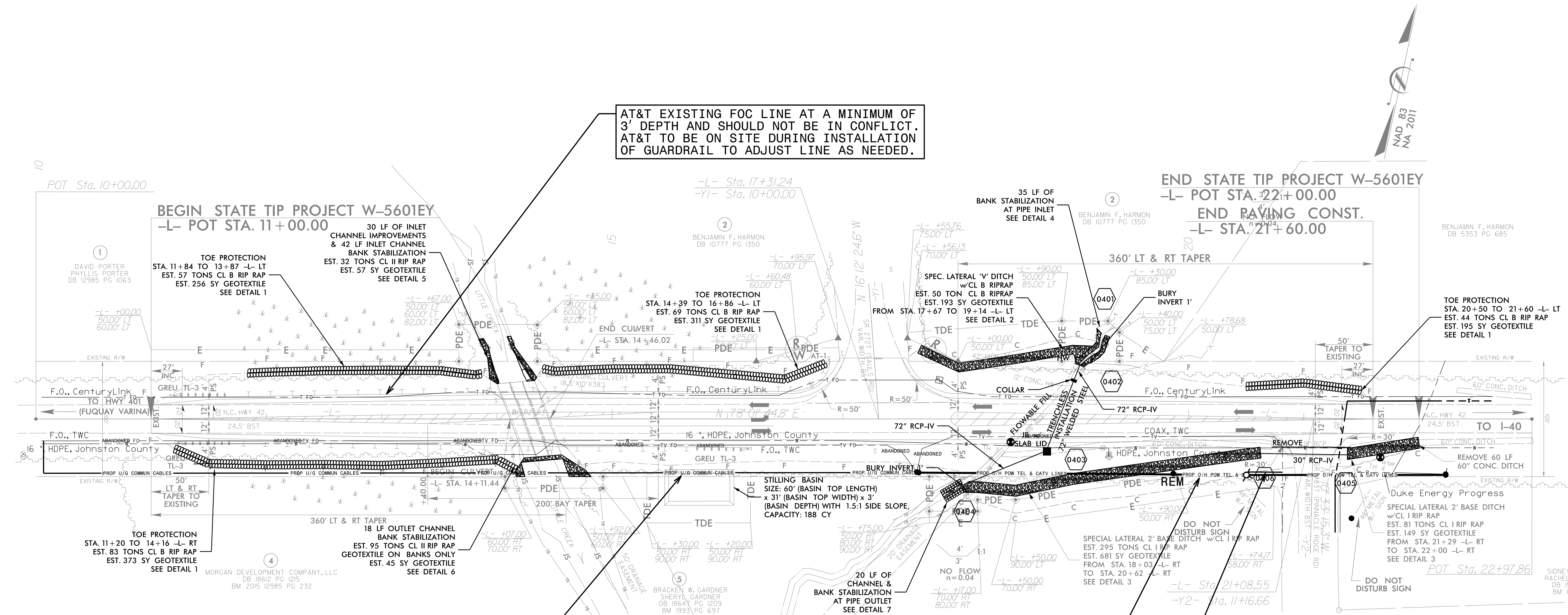

AT&T EXISTING FOC LINE AT A MINIMUM OF 3' DEPTH AND SHOULD NOT BE IN CONFLICT. AT&T TO BE ON SITE DURING INSTALLATION OF GUARDRAIL TO ADJUST LINE AS NEEDED.

PROPOSED CHARTER BURIED FOC LINE AT MINIMUM 10' DEPTH TO AVOID PROPOSED BASIN

PROPOSED DUKE ENERGY, AT&T, & CHARTER JOINT USE AERIAL FACILITIES

PROPOSED BURIED CHARTER FOC TO TIE INTO EXISTING

