

09.08/99

TIP PROJECT: W-5601EX

STATE OF NORTH CAROLINA
DIVISION OF HIGHWAYS

T.I.P. NO.	SHEET NO.
W-5601EX	UO-1

NOTE:
ALL UTILITY WORK SHOWN ON THIS SHEET WILL BE DONE BY OTHERS. NO PAYMENT WILL BE MADE TO THE CONTRACTOR FOR UTILITY WORK SHOWN ON THIS SHEET.

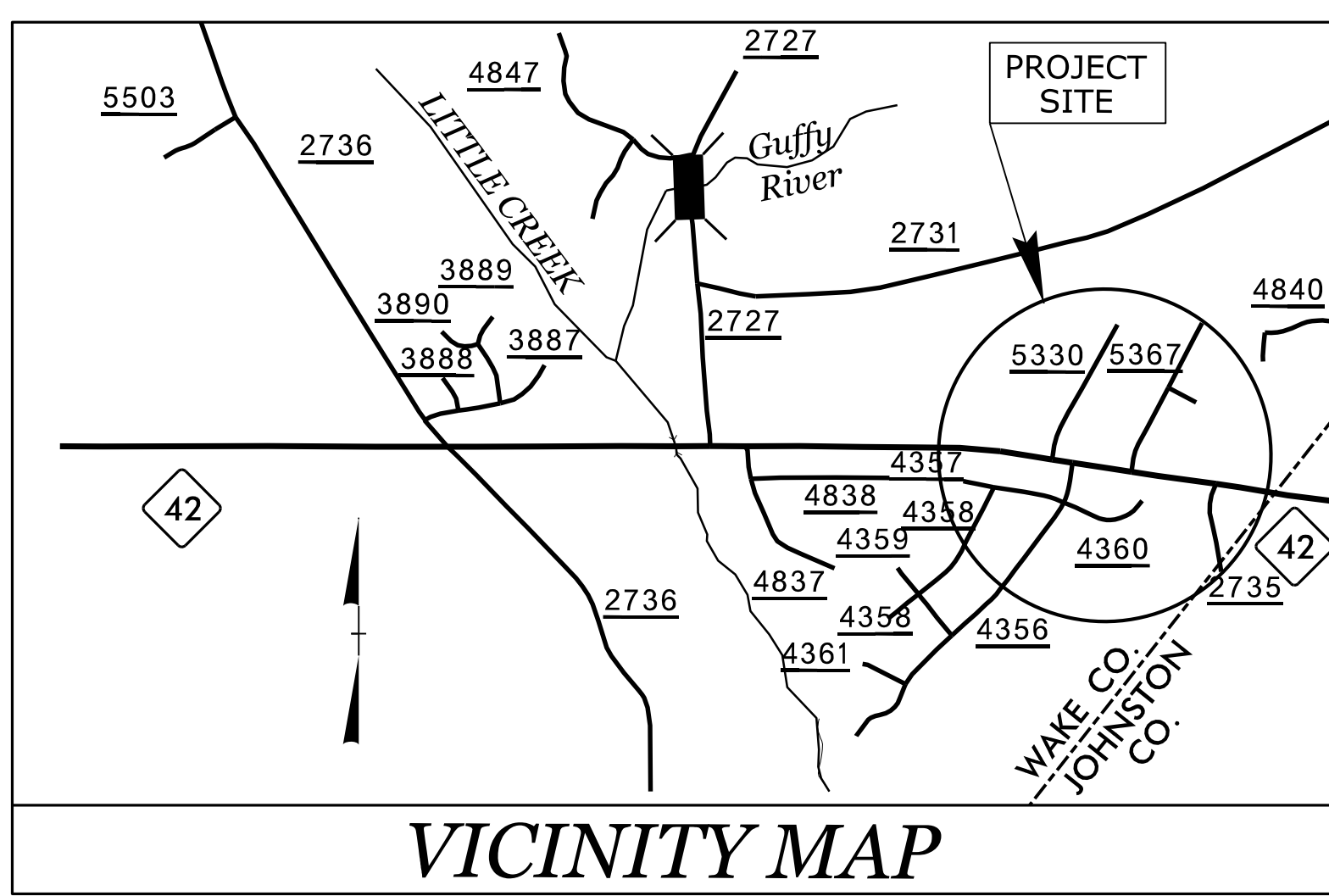

**UTILITIES BY OTHERS PLANS
WAKE COUNTY**

LOCATION: WIDEN NC 42 FOR CENTER TURN LANE FROM WEST OF MARY HOBBY (SR 2734) TO EAST OF WINTERTON DRIVE (SR 5367)

TYPE OF WORK: AERIAL POWER & COMMUNICATIONS RELOCATIONS

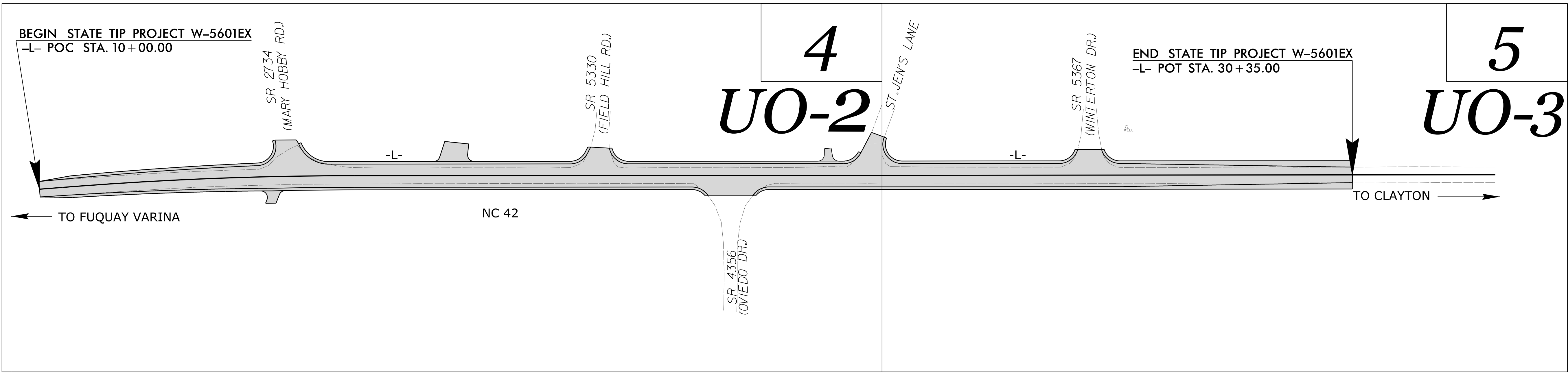
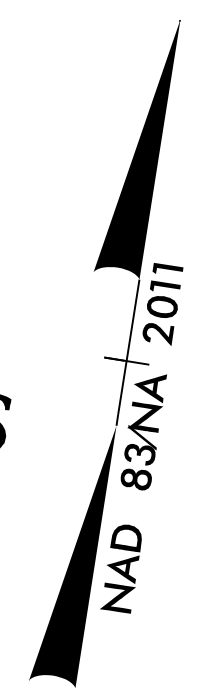

21-MAY-2021 14:26
M:\2021\2213335_04 NCDOT W-5601EX\Utility\res\290_001.W-5601EX_UT_TSH_U001_PSH.dgn
\$\$\$\$\$SERVNAME\$\$\$\$\$

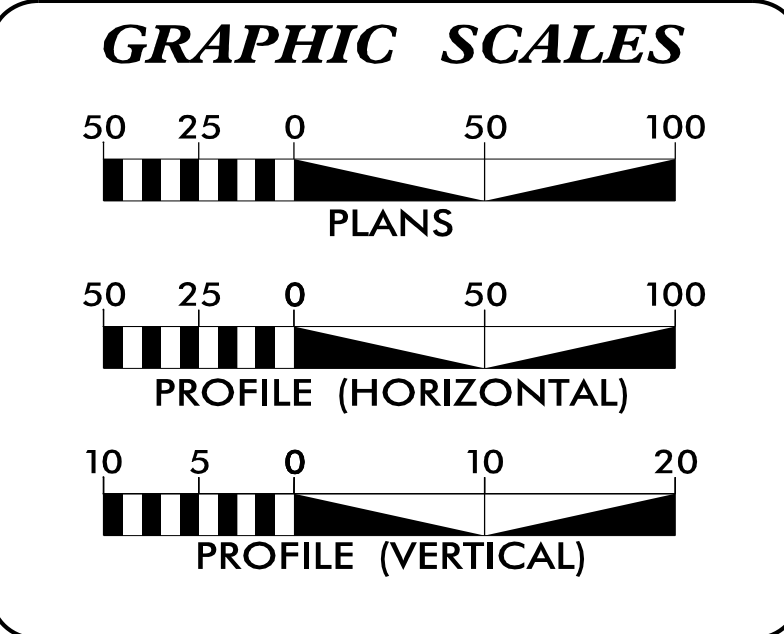

INDEX OF SHEETS

SHEET NO.:	DESCRIPTION:
UO-1	TITLE SHEET
UO-2 THRU UO-3	UBO PLAN SHEETS

UTILITY OWNERS WITH CONFLICTS

(A) DUKE ENERGY - POWER (DISTRIBUTION)
(B) CHARTER /SPECTRUM - COMMUNICATIONS
(C) AT&T - COMMUNICATIONS

PREPARED IN THE OFFICE OF:

KCI
ASSOCIATES OF N.C.

CIVIL ENGINEERS
ENVIRONMENTAL - CEI
LAND SURVEYING
SUBSURFACE UTILITY
ENGINEERING

4505 FALLS OF NEUSE RD
SUITE 400
RALEIGH, NORTH CAROLINA 27609
(919) 783-9214
WWW.KCI.COM

JOHN FAISON UTILITY PROJECT MANAGER
DANIEL ALLEN PROJECT UTILITY COORDINATOR

DIVISION OF HIGHWAYS
DIVISION 5

PROJECT DELIVERY UNIT
2612 DUKE STREET
DURHAM, NC 27704

BEN UPSHAW, PE TEAM LEAD
S. REID DAVIDSON, PE DDC ENGINEER
DON PROPER DIV. 5 UTILITY ENGINEER
MONROE BROWN DIV. 5 UTILITY COORDINATOR

UTILITIES BY OTHERS

ALL PROPOSED UTILITY WORK SHOWN ON THIS SHEET WILL BE DONE BY OTHERS. NO PAYMENT WILL BE MADE TO THE CONTRACTOR FOR PROPOSED UTILITY WORK SHOWN ON THIS SHEET.

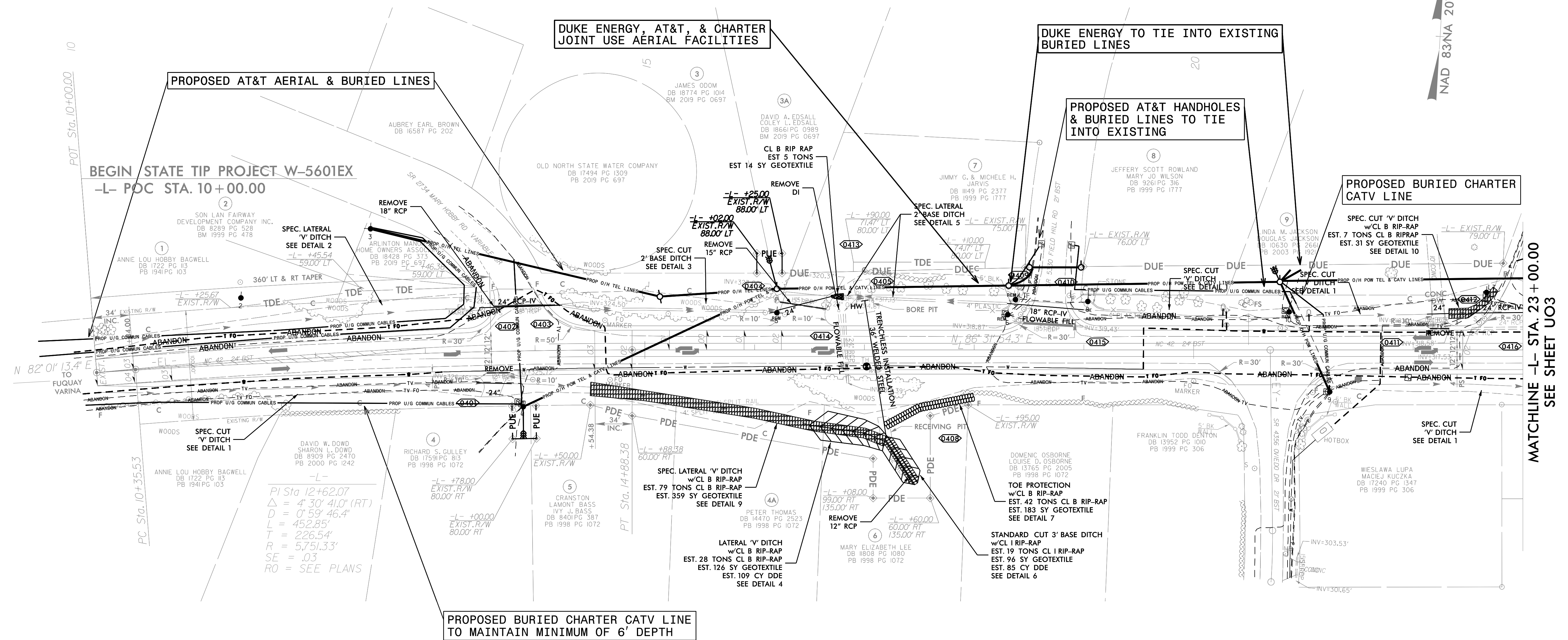

PROPOSED AT&T AERIAL & BURIED LINES

DUKE ENERGY, AT&T, & CHARTER JOINT USE AERIAL FACILITIES

DUKE ENERGY TO TIE INTO EXISTING BURIED LINES

PROPOSED AT&T HANDHOLES & BURIED LINES TO TIE INTO EXISTING

PROPOSED BURIED CHARTER CATV LINE

BEGIN STATE TIP PROJECT W-5601EX
-L- POC STA. 10+00.00

PROPOSED BURIED CHARTER CATV LINE TO MAINTAIN MINIMUM OF 6' DEPTH

MATCHLINE -L- STA. 23+00.00
SEE SHEET UO3

PC Sta. 12+62.07
 $\Delta = 4' 30" 41.0" (RT)$
 $D = 0' 59" 46.4"$
 $L = 452.85'$
 $T = 226.54'$
 $R = 5,751.33'$
 $SE = .03$
 $RO = \text{SEE PLANS}$

CIVIL ENGINEERS
ENVIRONMENTAL - CEI
LAND SURVEYING
SUBSURFACE UTILITY ENGINEERING

KCI
 ASSOCIATES OF N.C.

4505 FALLS OF NEUSE RD
 SUITE 400
 RALEIGH, NORTH CAROLINA 27609
 (919) 783-9214
 WWW.KCI.COM

5/14/99
 NCDOT W-5601EX UO-2
 15:17 titles 290_003_W-5601EX_UT_RDY4_UO02_PSH.dgn
 \$\$\$\$\$\$

UTILITIES BY OTHERS

ALL PROPOSED UTILITY WORK SHOWN ON THIS SHEET WILL BE DONE BY OTHERS. NO PAYMENT WILL BE MADE TO THE CONTRACTOR FOR PROPOSED UTILITY WORK SHOWN ON THIS SHEET.

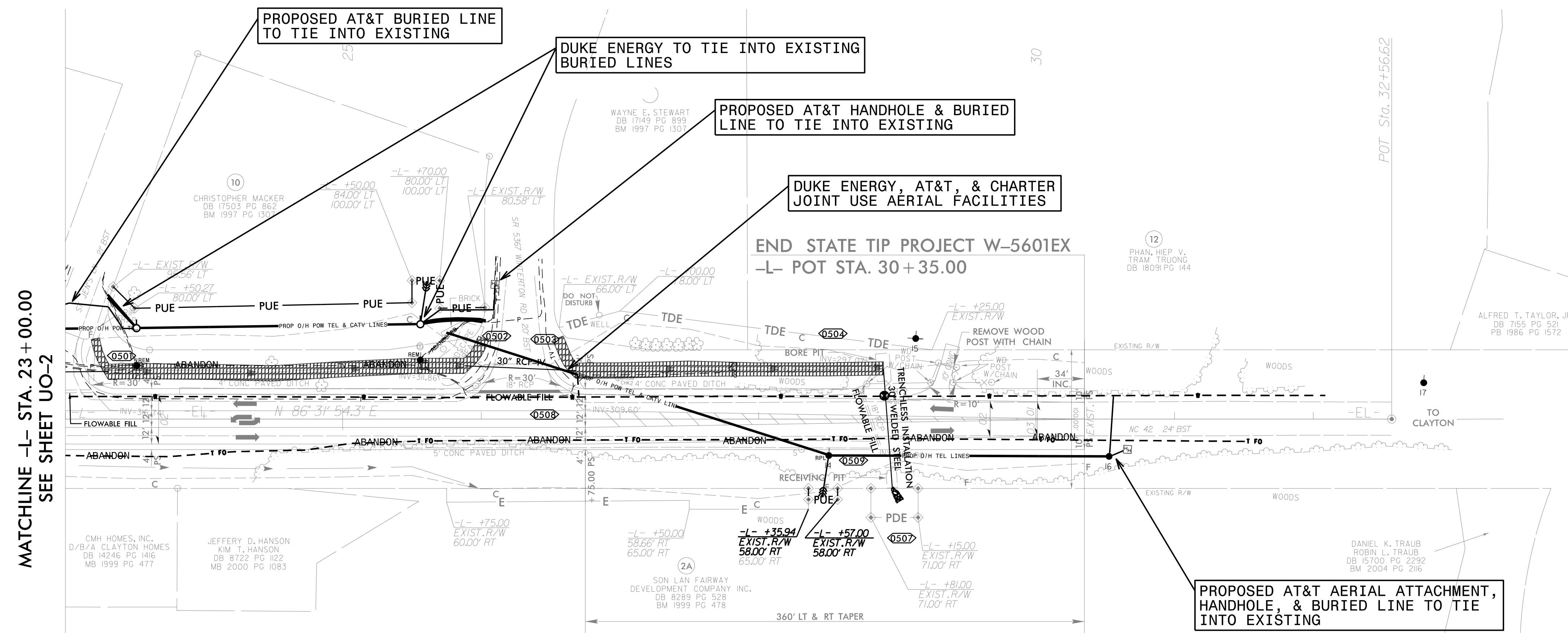

MATCHLINE -L- STA. 23+00.00
SEE SHEET UO-2

KCI
ASSOCIATES OF N.C.

CIVIL ENGINEERS
ENVIRONMENTAL - CEI
LAND SURVEYING
SUBSURFACE UTILITY
ENGINEERING

4505 FALLS OF NEUSE RD
SUITE 400
RALEIGH, NORTH CAROLINA 27609
(919) 783-9214
WWW.KCI.COM

5/14/99
94 NCD0031 W-5601EX UT RDY5 UO03 PSH.dgn
31 MAY 2007 15:19
\$\$\$\$\$