

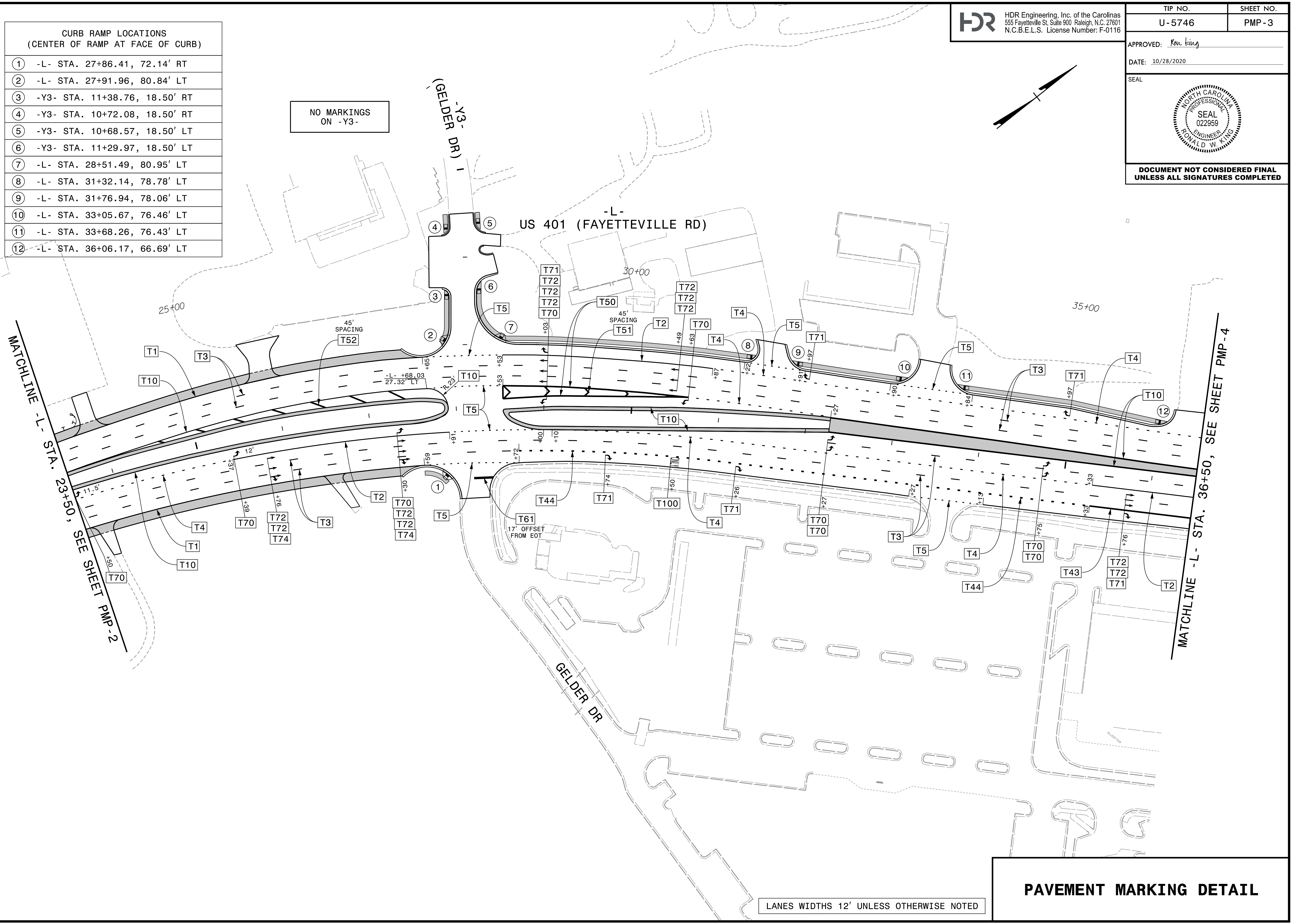

CURB RAMP LOCATIONS (CENTER OF RAMP AT FACE OF CURB)	
①	-L- STA. 27+86.41, 72.14' RT
②	-L- STA. 27+91.96, 80.84' LT
③	-Y3- STA. 11+38.76, 18.50' RT
④	-Y3- STA. 10+72.08, 18.50' RT
⑤	-Y3- STA. 10+68.57, 18.50' LT
⑥	-Y3- STA. 11+29.97, 18.50' LT
⑦	-L- STA. 28+51.49, 80.95' LT
⑧	-L- STA. 31+32.14, 78.78' LT
⑨	-L- STA. 31+76.94, 78.06' LT
⑩	-L- STA. 33+05.67, 76.46' LT
⑪	-L- STA. 33+68.26, 76.43' LT
⑫	-L- STA. 36+06.17, 66.69' LT

NO MARKINGS  
ON -Y3-

PLOT DRIVER: NCDOT\_color\_eng\_50.pht  
USER: CHARNDEN  
DATE: 10/27/2020  
FILE: p:\pwhdr\users\charnd\US\_East\01\Documents\NCDOT\2016\NCDOT\_Central\_Reg\_Div\_Plan\_Design\_0n-Cali\_M\_U-5746\_Task\_Order\_3\6.0\_CAD\_BIM\6.2\_WIP\U-5746\_TO\_3\Traffic\ Pavement\_Markings\U5746\_PM\_PMP03



MATCHLINE -L- STA. 23+50, SEE SHEET PMP-2

MATCHLINE -L- STA. 36+50, SEE SHEET PMP-4

LANES WIDTHS 12' UNLESS OTHERWISE NOTED

**PAVEMENT MARKING DETAIL**