

- 1. BRASSFIELD RD**
- 2. DEER FOREST TRL**
- 3. STAR RD**

WAKE COUNTY

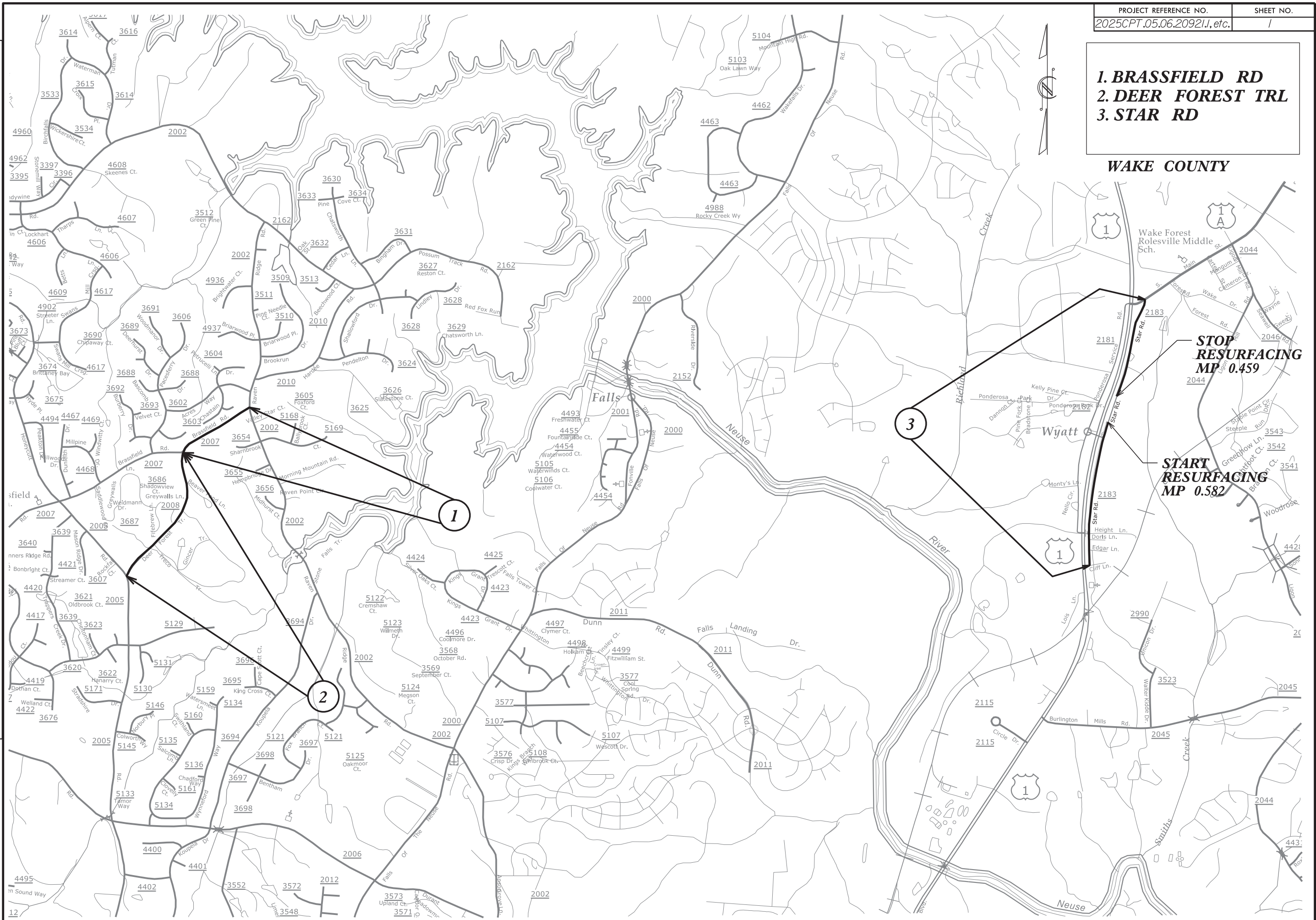

**STOP
RESURFACING
MP 0.459**

**START
RESURFACING
MP 0.582**

**4. MITCHELL MILL RD
5. WATKINS RD**

WAKE COUNTY

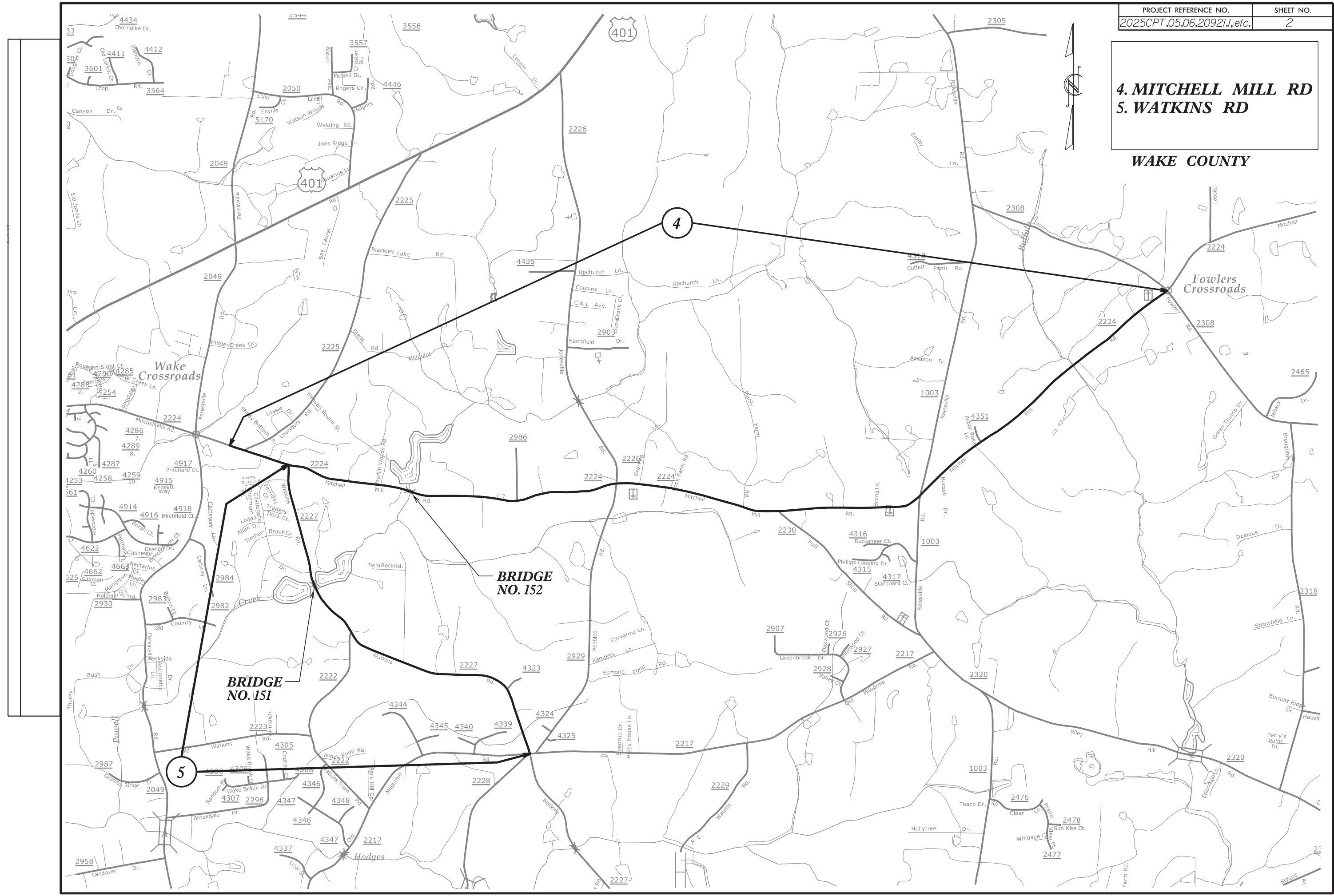
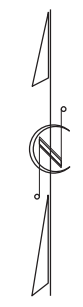



6. BAKER RD
7. THORNBURG DR
8. STUARTS RIDGE RD
27. WINFREE LN

WAKE COUNTY

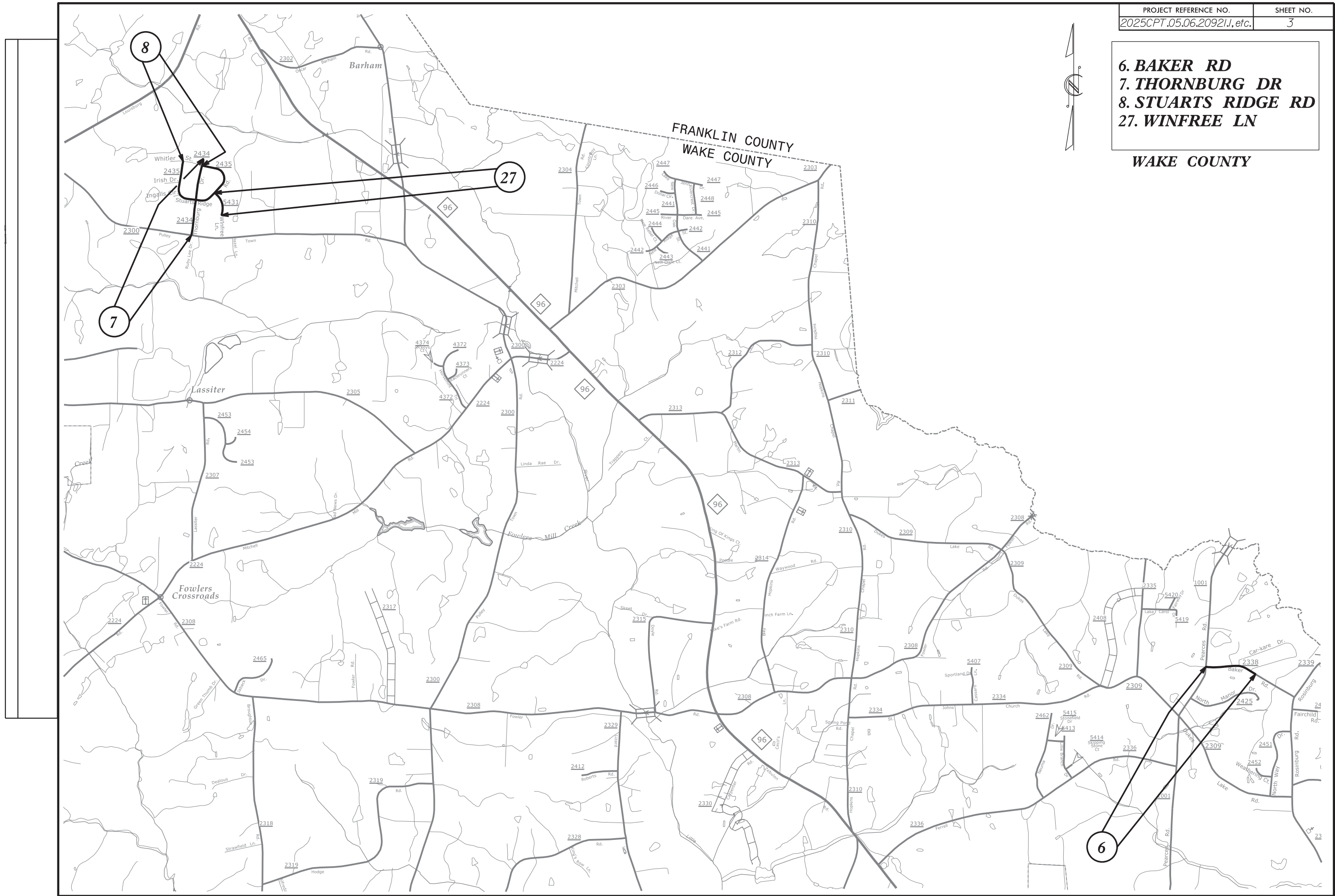

- 10. LAURELFORD LN**
 - 11. NEW FOREST LN**
 - 12. PENFOLD LN**
 - 20. TYNEWIND DR**
 - 21. RIVER PARK DR**
 - 22. WELCOME DR**
 - 23. WISLEY WAY**
 - 24. CLARINCARDE CT**
- WAKE COUNTY**

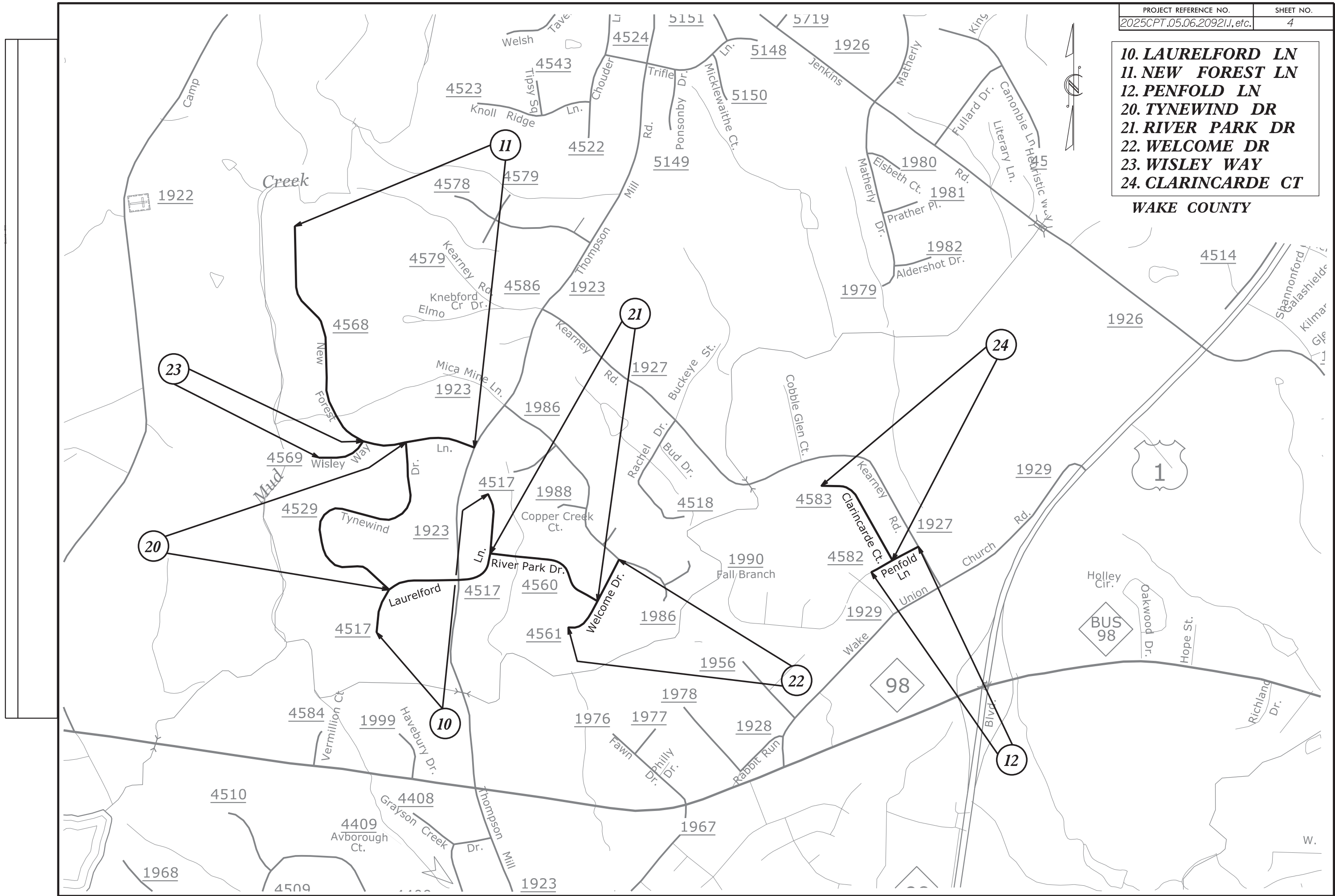

14. DUNN RD
15. WOODROSE LN
16. BRACKEN CT
17. LIGHTFOOT CT
18. GREENHOW LN

WAKE COUNTY



**9. PAMPLONA DR
13. LIGHT FALLS DR
19. TROUVILLE CT**

WAKE COUNTY

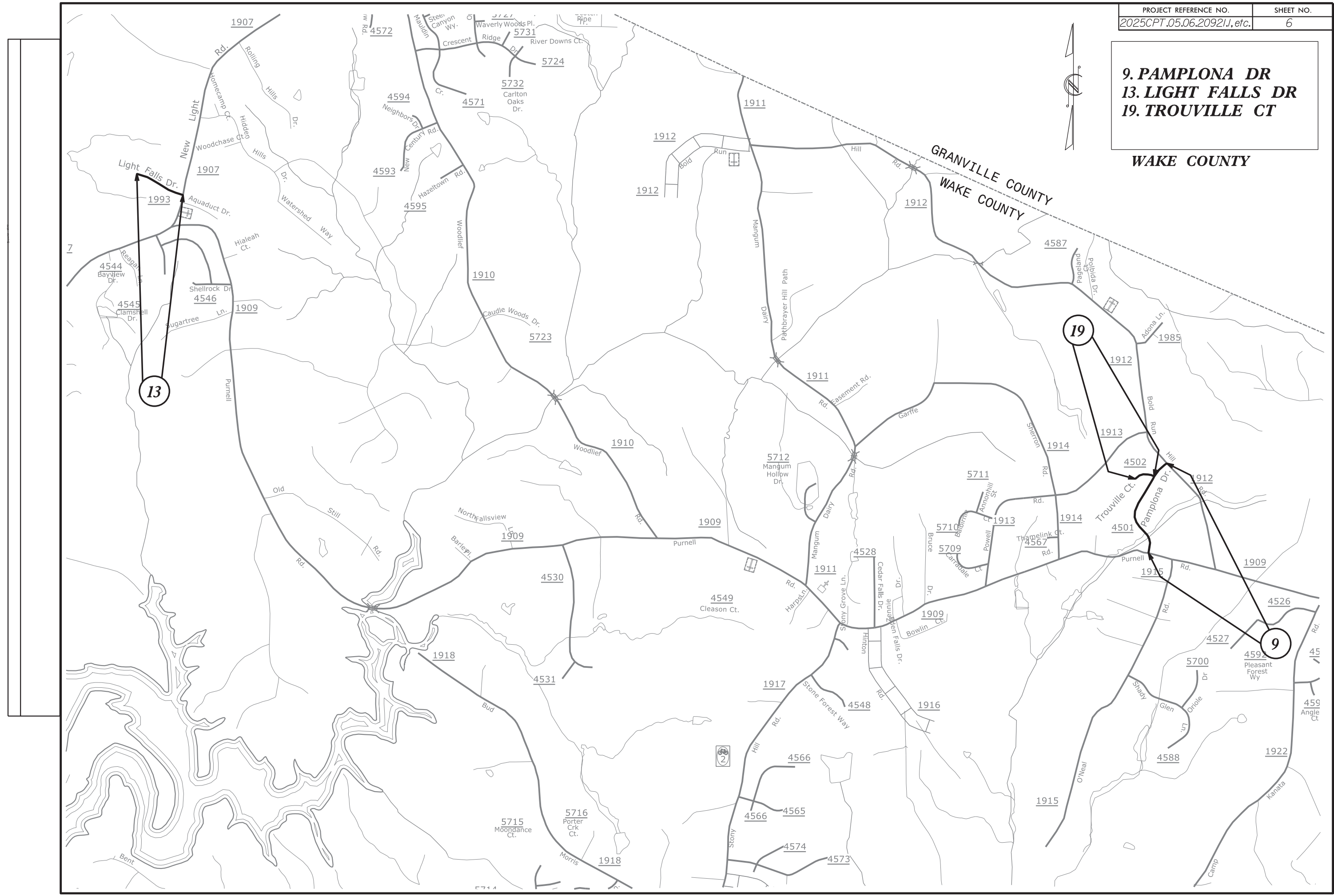
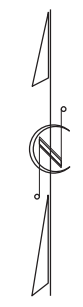

25. SWEET CHESTNUT LN
26. BRIERLEY HILL CT

WAKE COUNTY

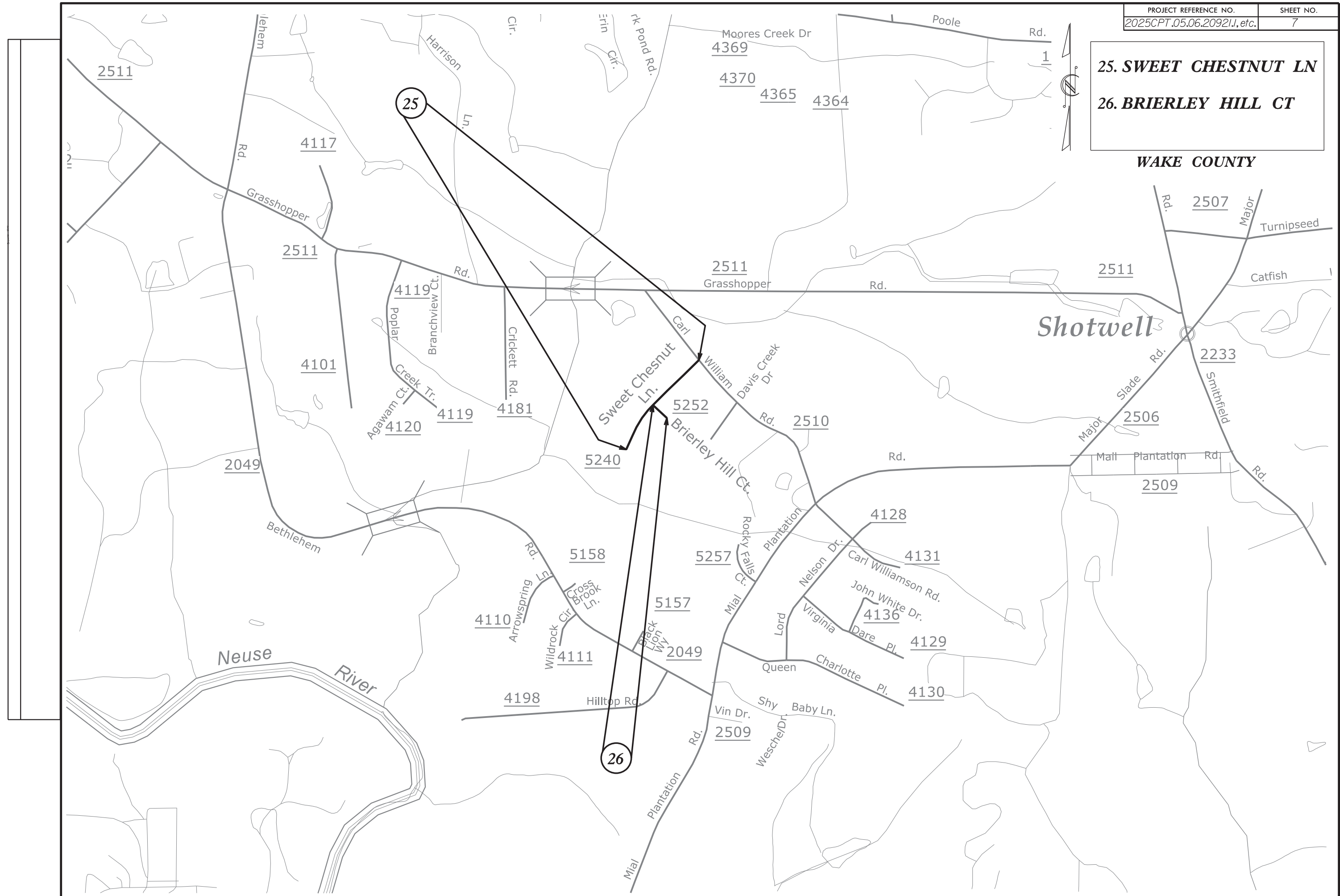

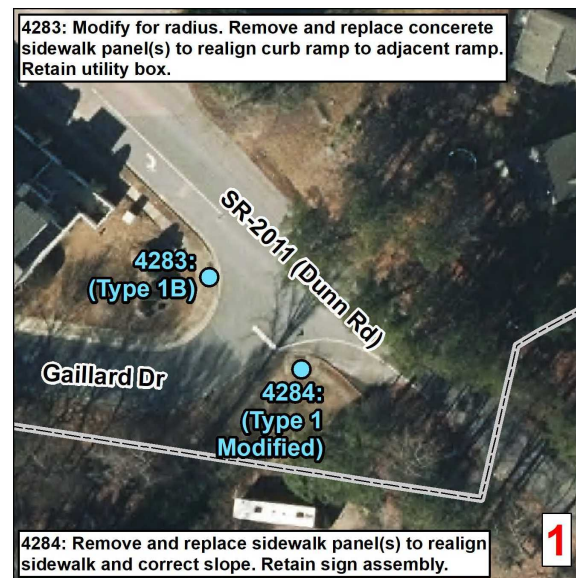
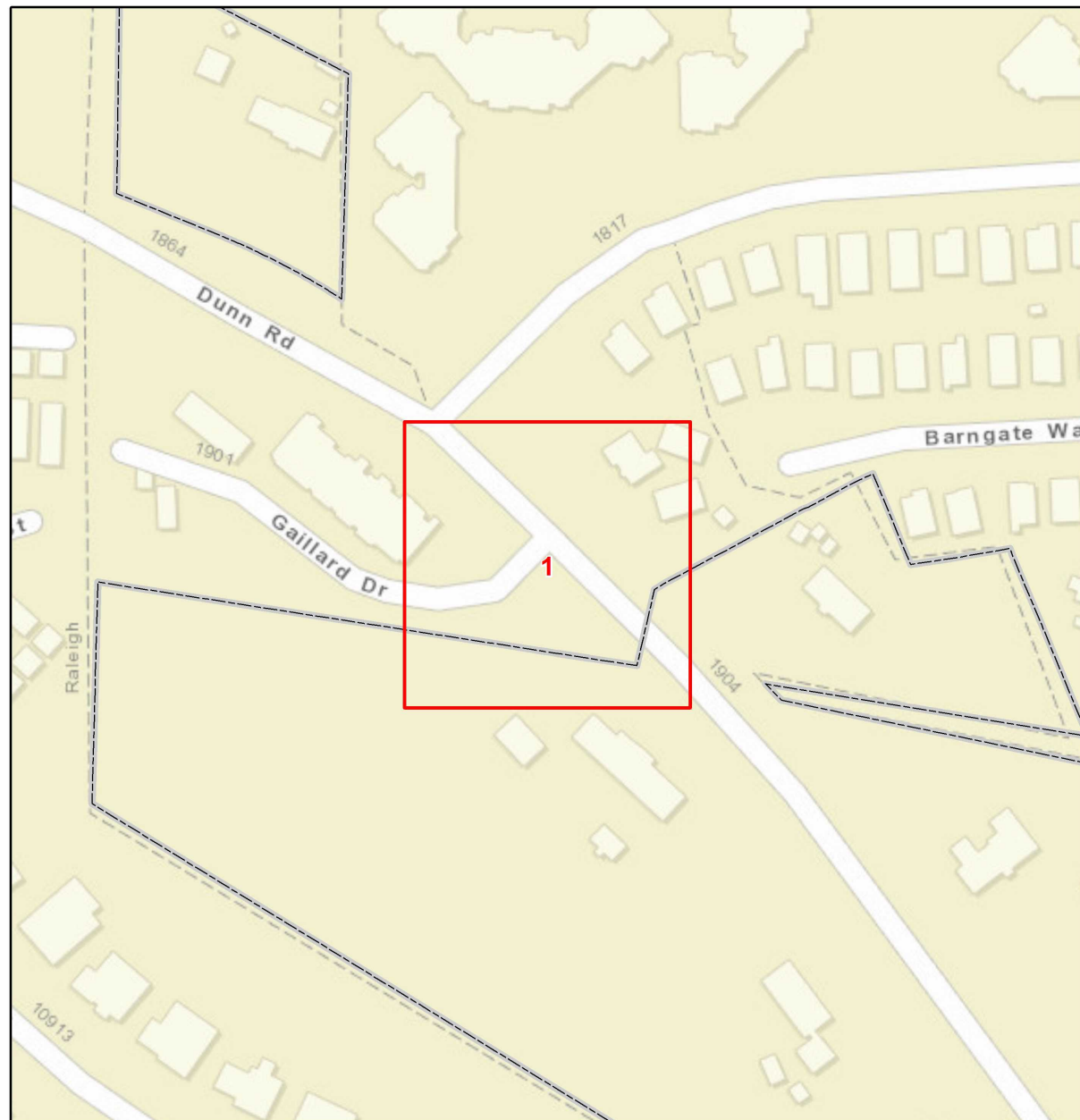

4283: Modify for radius. Remove and replace concrete sidewalk panel(s) to realign curb ramp to adjacent ramp. Retain utility box.

4284: Remove and replace sidewalk panel(s) to realign sidewalk and correct slope. Retain sign assembly.

Curb Ramps To Be Repaired

- Retrofit
- Remove and Replace
- New Curb Ramp
- Remove Ramp
- Other

Municipal Boundary

NCHPO Historic Boundary (NR and LHD)

North

Project Number: 2025CPT.05.06.20922.1

Dunn Rd From Falls Landing Dr To End Maintenance

 NORTH CAROLINA DEPARTMENT OF TRANSPORTATION DIVISION 5

Source: NV5 Engineers and Consultants Inc., ESRI, NC OneMap, NCDOT, NCHPO

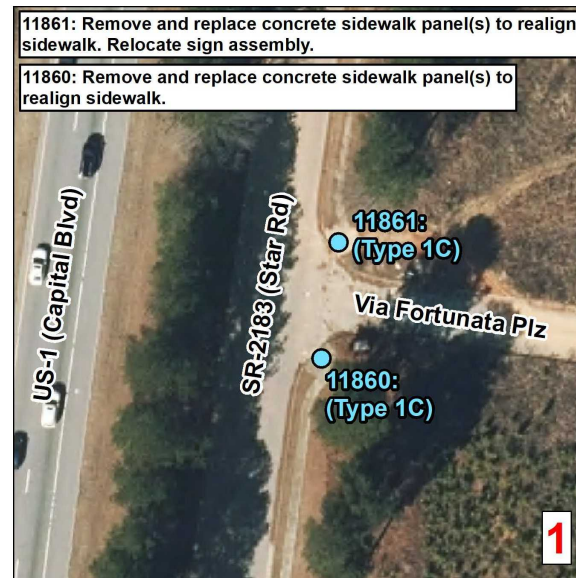

| | | |
|---|--|---|
| Curb Ramps To Be Repaired <ul style="list-style-type: none"> ● Retrofit ● Remove and Replace ● New Curb Ramp ● Remove Ramp ■ Other | | |
| <ul style="list-style-type: none"> Municipal Boundary NCHPO Historic Boundary (NR and LHD) | | |
| <p>North Project Number: 2025CPT.05.06.20921.1 Star Rd From US 1 Alt To End Maintenance</p> | | |
| | | <p>NORTH CAROLINA DEPARTMENT OF TRANSPORTATION DIVISION 5</p> |
| <p>Source: NV5 Engineers and Consultants Inc., ESRI, NC OneMap, NCDOT, NCHPO</p> | | |

8/17/99

| PAVEMENT SCHEDULE | |
|-------------------|--|
| C1 | PROP. APPROX. 1" ASPHALT CONCRETE SURFACE COURSE, TYPE S9.5B, AT AN AVERAGE RATE OF 110 LBS. PER SQ. YD. |
| C2 | PROP. APPROX. 1¼" ASPHALT CONCRETE SURFACE COURSE, TYPE S9.5B, AT AN AVERAGE RATE OF 137.5 LBS. PER SQ. YD. |
| C3 | PROP. APPROX. 1½" ASPHALT CONCRETE SURFACE COURSE, TYPE S9.5B, AT AN AVERAGE RATE OF 165 LBS. PER SQ. YD. |
| C4 | PROP. APPROX. 1½" ASPHALT CONCRETE SURFACE COURSE, TYPE S9.5C, AT AN AVERAGE RATE OF 168 LBS. PER SQ. YD. |
| D1 | PROP. APPROX. 2.5" ASPHALT CONCRETE INTERMEDIATE COURSE, TYPE I19.0C, AT AN AVERAGE RATE OF 285 LBS. PER SQ. YD. |
| V1 | MILLING OF EXISTING ASPHALT PAVEMENT AT DEPTH OF 1½" |
| V2 | MILLING OF EXISTING ASPHALT PAVEMENT AT DEPTH OF 2½" |
| V3 | MILLING OF EXISTING ASPHALT PAVEMENT, 0" TO 1½" |
| T | SHOULDER RECONSTRUCTION |
| U | EXISTING PAVEMENT |

| PROJECT REFERENCE NO. | SHEET NO. |
|---------------------------|-----------|
| 2025CPT.05.06.2092I, etc. | 10 |

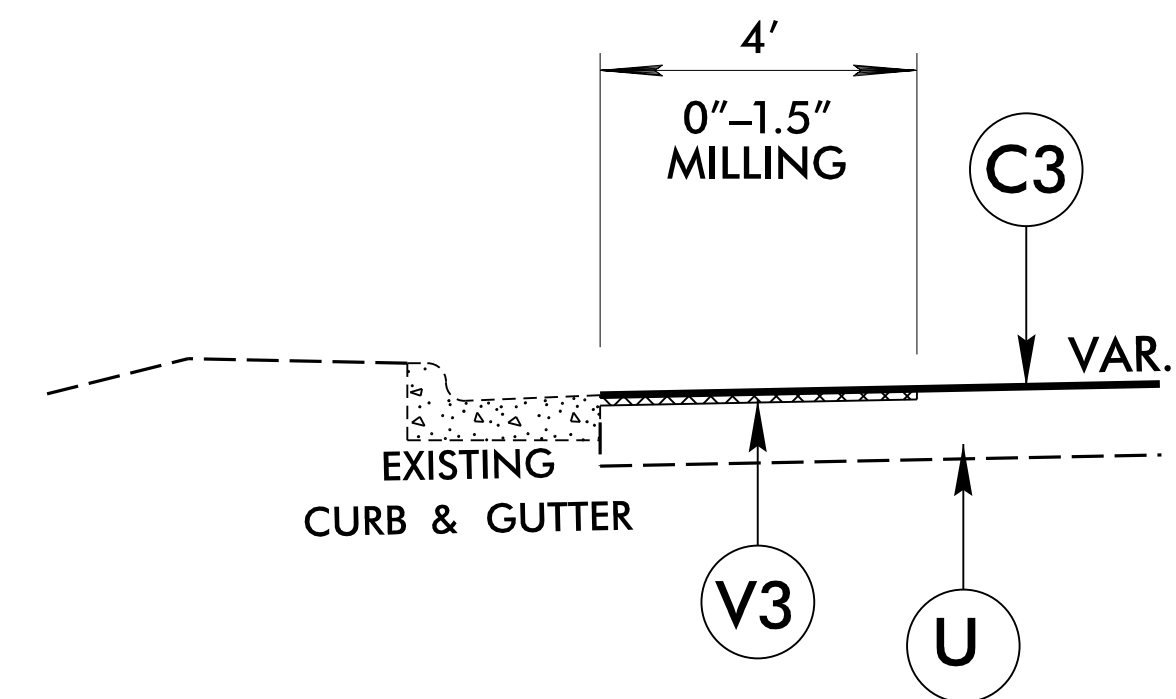
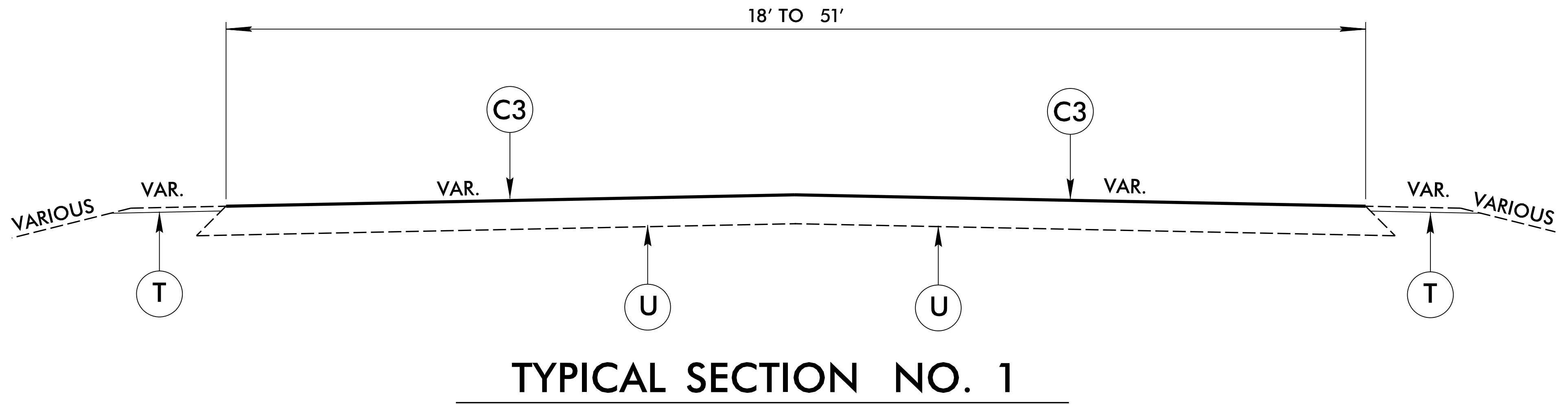

USE IN CONJUNCTION WITH TYPICAL SECTION NO. 1

- MAP 10 – MAP 10 LAUREL DR
CURB AND GUTTER SECTION – 126' +/-
- MAP 11 NEW FOREST LN
CURB AND GUTTER SECTION – 206' +/-
- MAP 3 STAR RD
CURB AND GUTTER SECTION – 902' +/-

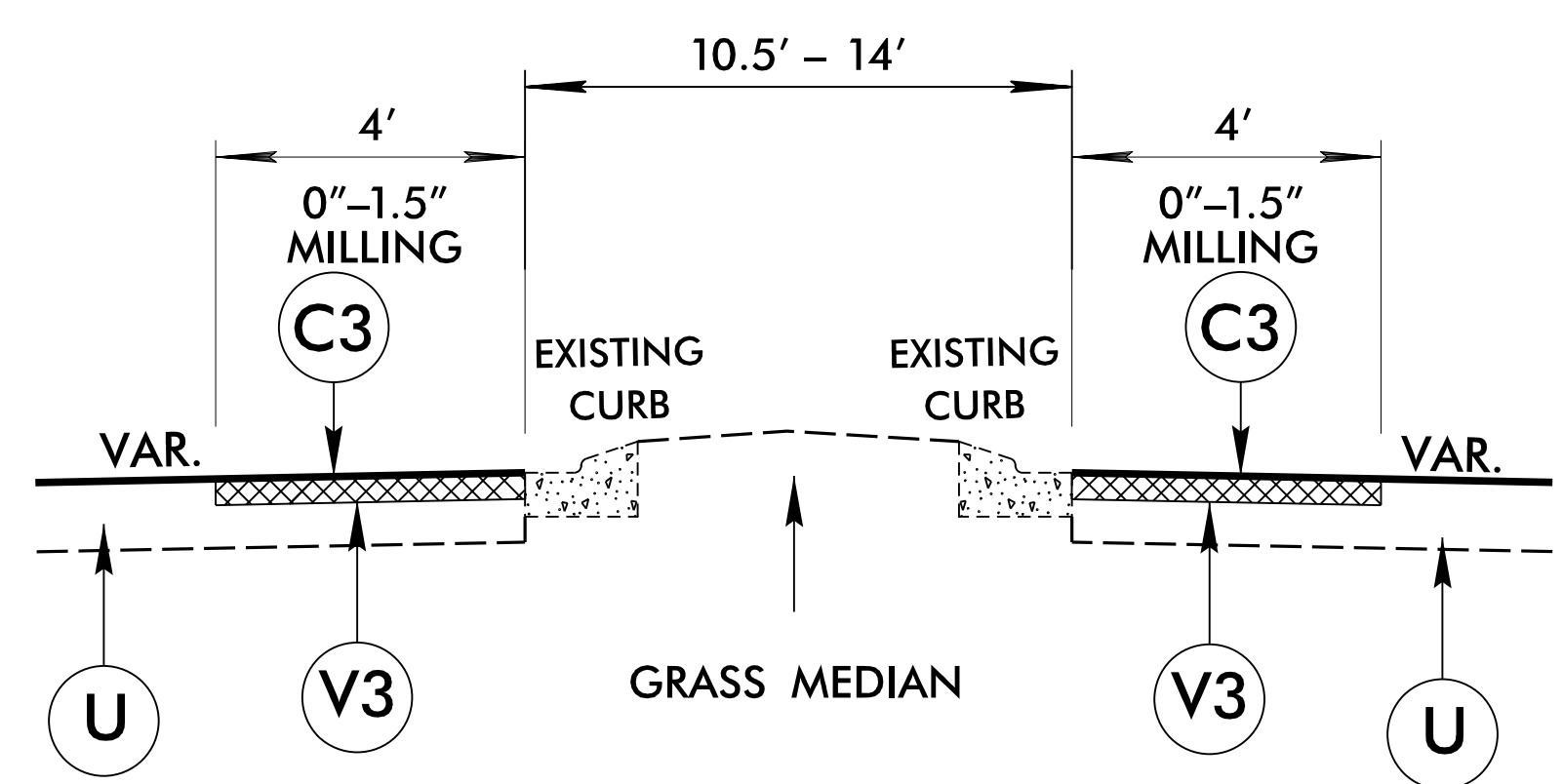

USE IN CONJUNCTION WITH TYPICAL SECTION NO. 1

- MAP 9 PAMPLONA DR
CURB AND GUTTER SECTION – 44' +/-
- MAP 10 LAUREL DR
CURB AND GUTTER SECTION – 20' +/-
- MAP 11 NEW FOREST LN
CURB AND GUTTER SECTION – 128' +/-

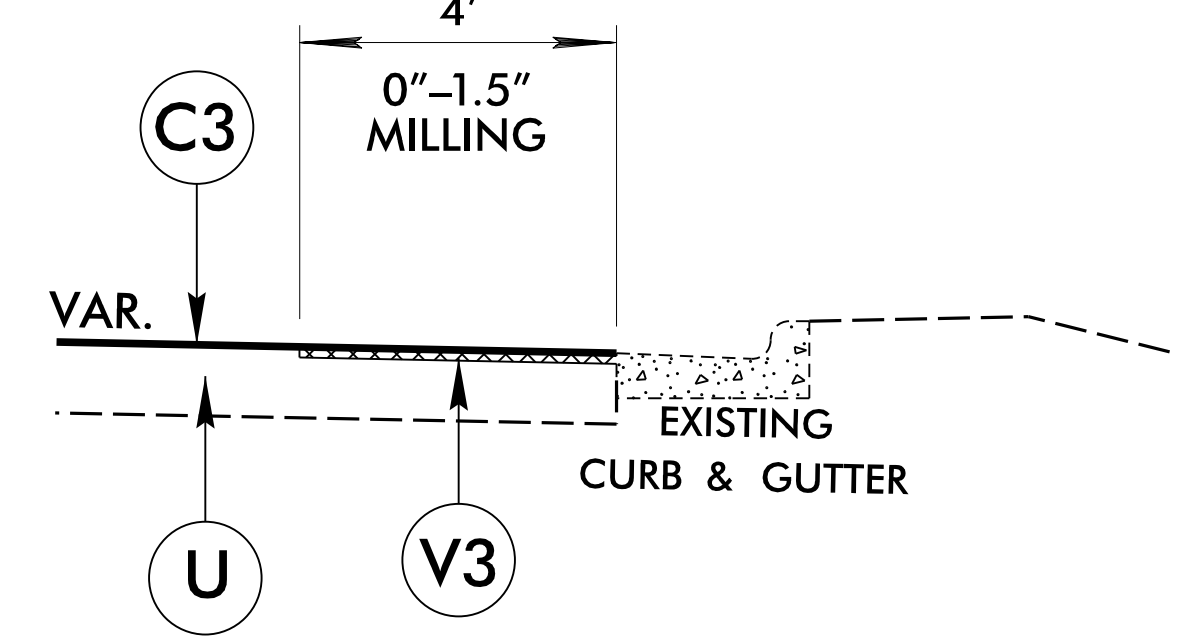

USE IN CONJUNCTION WITH TYPICAL SECTION NO. 1

- MAP 10 – MAP 10 LAUREL DR
CURB AND GUTTER SECTION – 126' +/-
- MAP 11 NEW FOREST LN
CURB AND GUTTER SECTION – 206' +/-

NOTE:
MILL 1½" ON MAP 4, BRIDGE NO. 910152 AS DIRECTED BY THE ENGINEER TO RESURFACE AND NOT ADD ANY ADDITIONAL WEIGHT ON THE BRIDGE. TO BE PAID FOR AS INCIDENTAL MILLING.

8/17/99

| PAVEMENT SCHEDULE | |
|-------------------|--|
| C1 | PROP. APPROX. 1" ASPHALT CONCRETE SURFACE COURSE, TYPE S9.5B, AT AN AVERAGE RATE OF 110 LBS. PER SQ. YD. |
| C2 | PROP. APPROX. 1¼" ASPHALT CONCRETE SURFACE COURSE, TYPE S9.5B, AT AN AVERAGE RATE OF 137.5 LBS. PER SQ. YD. |
| C3 | PROP. APPROX. 1½" ASPHALT CONCRETE SURFACE COURSE, TYPE S9.5B, AT AN AVERAGE RATE OF 165 LBS. PER SQ. YD. |
| C4 | PROP. APPROX. 1½" ASPHALT CONCRETE SURFACE COURSE, TYPE S9.5C, AT AN AVERAGE RATE OF 168 LBS. PER SQ. YD. |
| D1 | PROP. APPROX. 2.5" ASPHALT CONCRETE INTERMEDIATE COURSE, TYPE I19.0C, AT AN AVERAGE RATE OF 285 LBS. PER SQ. YD. |
| V1 | MILLING OF EXISTING ASPHALT PAVEMENT AT DEPTH OF 1½" |
| V2 | MILLING OF EXISTING ASPHALT PAVEMENT AT DEPTH OF 2½" |
| V3 | MILLING OF EXISTING ASPHALT PAVEMENT, 0" TO 1½" |
| T | SHOULDER RECONSTRUCTION |
| U | EXISTING PAVEMENT |

| | |
|---------------------------|-----------|
| PROJECT REFERENCE NO. | SHEET NO. |
| 2025CPT.05.06.2092I, etc. | // |

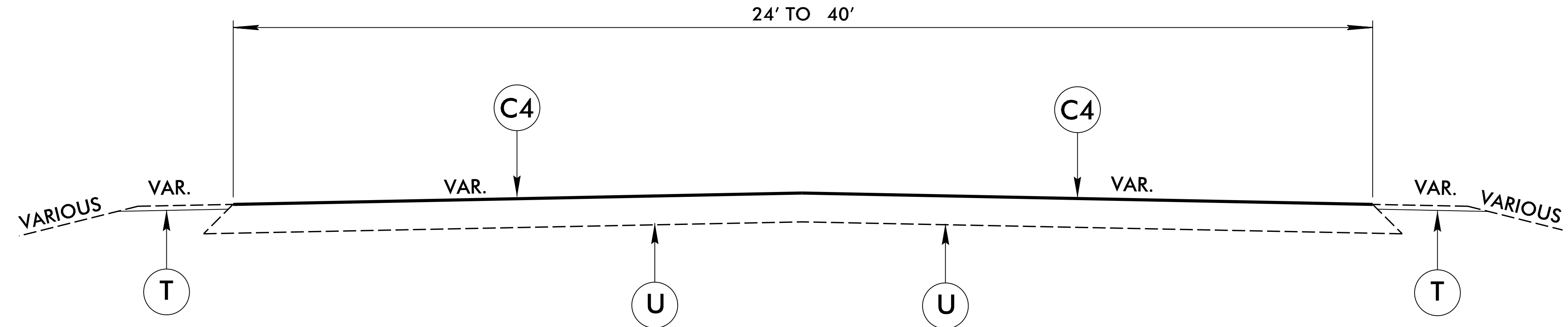

TYPICAL SECTION NO. 2

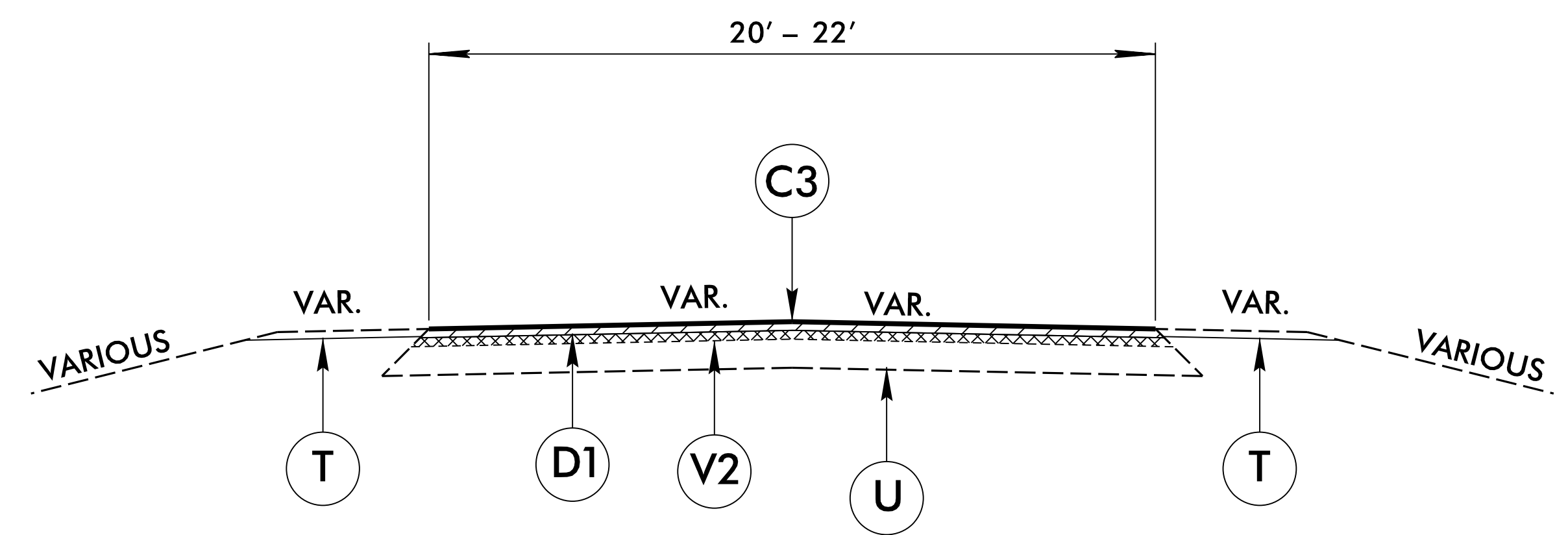

TYPICAL SECTION NO. 3

NOTE:
 MILL AND FILL 1½" ON MAP 5, BRIDGE NO. 910151 TO PREVENT ANY ADDITIONAL WEIGHT ON THE BRIDGE. MILL 1.5" AND FILL WITHIN THE BRIDGE PROJECT ASPHALT LIMITS AS DIRECTED BY THE ENGINEER.

8/17/99

| PAVEMENT SCHEDULE | |
|-------------------|--|
| C1 | PROP. APPROX. 1" ASPHALT CONCRETE SURFACE COURSE, TYPE S9.5B, AT AN AVERAGE RATE OF 110 LBS. PER SQ. YD. |
| C2 | PROP. APPROX. 1¼" ASPHALT CONCRETE SURFACE COURSE, TYPE S9.5B, AT AN AVERAGE RATE OF 137.5 LBS. PER SQ. YD. |
| C3 | PROP. APPROX. 1½" ASPHALT CONCRETE SURFACE COURSE, TYPE S9.5B, AT AN AVERAGE RATE OF 165 LBS. PER SQ. YD. |
| C4 | PROP. APPROX. 1½" ASPHALT CONCRETE SURFACE COURSE, TYPE S9.5C, AT AN AVERAGE RATE OF 168 LBS. PER SQ. YD. |
| D1 | PROP. APPROX. 2.5" ASPHALT CONCRETE INTERMEDIATE COURSE, TYPE I19.0C, AT AN AVERAGE RATE OF 285 LBS. PER SQ. YD. |
| V1 | MILLING OF EXISTING ASPHALT PAVEMENT AT DEPTH OF 1½" |
| V2 | MILLING OF EXISTING ASPHALT PAVEMENT AT DEPTH OF 2½" |
| V3 | MILLING OF EXISTING ASPHALT PAVEMENT, 0" TO 1½" |
| T | SHOULDER RECONSTRUCTION |
| U | EXISTING PAVEMENT |

| PROJECT REFERENCE NO. | SHEET NO. |
|---------------------------|-----------|
| 2025CPT.05.06.2092I, etc. | 12 |

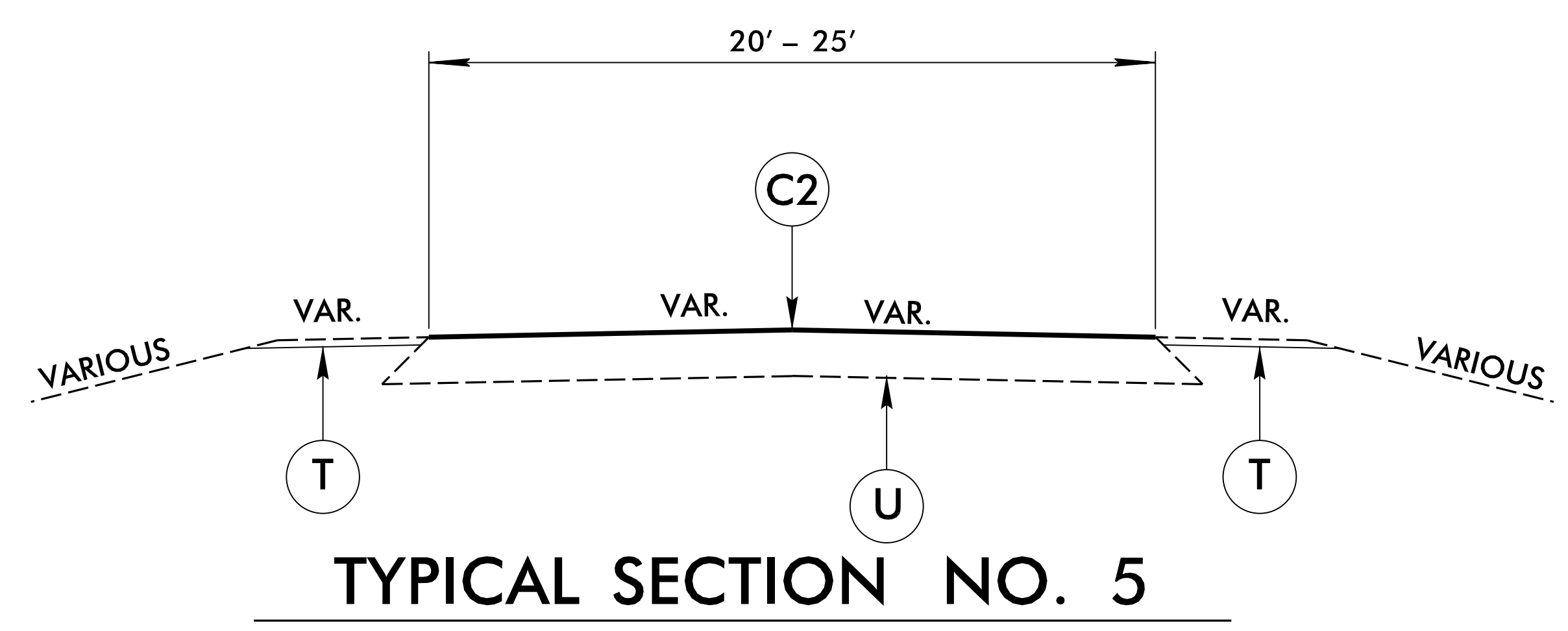
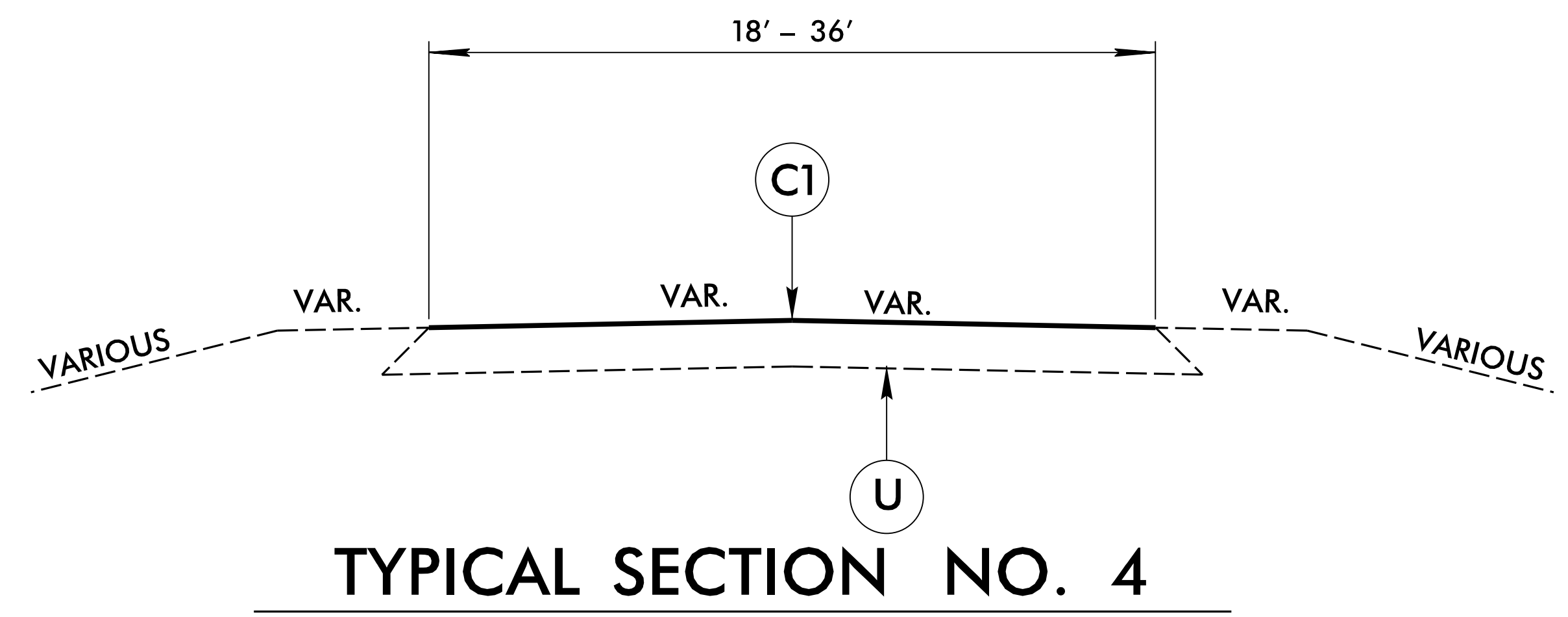

NOTES

ALL UNPAVED S.R. ROADS TO BE RESURFACED 50' FROM EDGE OF PAVEMENT OF MAIN PROJECT.
 ALL PAVED S.R. ROADS TO BE RESURFACED TO THE ENDS OF THE RADII, OR AS DIRECTED BY THE ENGINEER.
 EDGES, PAVEMENT WIDENING, INTERSECTIONS AND BRIDGE FLARES ARE INCLUDED IN THE TABLE OF QUANTITIES.
 BRIDGES TO BE RESURFACED AT LOCATIONS AND TO DEPTH AS DIRECTED BY THE ENGINEER.

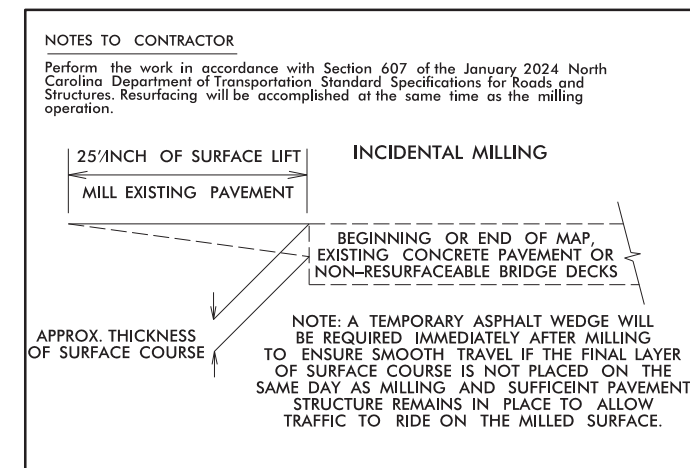
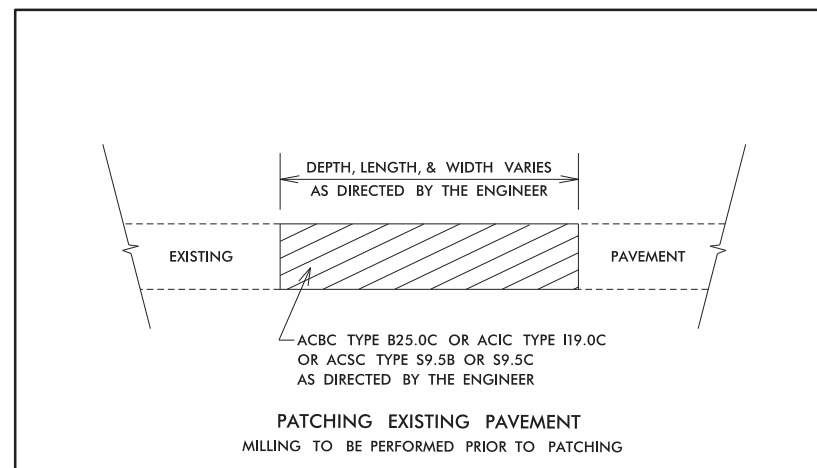

NOTES:

- 1) DETAIL DOES NOT APPLY TO OGAFB AND ULTRA-THIN BONDED WEARING COURSE.
- 2) BACKFILL SHOULDER WITH APPROVED MATERIAL.
- 3) THE SHOULDER WEDGE DEVICE MAY BE DISENGAGED AT PAVED DRIVEWAYS, SIDE STREETS, HIGH SHOULDERS, AND OTHER LOCATIONS NOT FEASIBLE TO CONSTRUCT AS APPROVED BY THE ENGINEER.

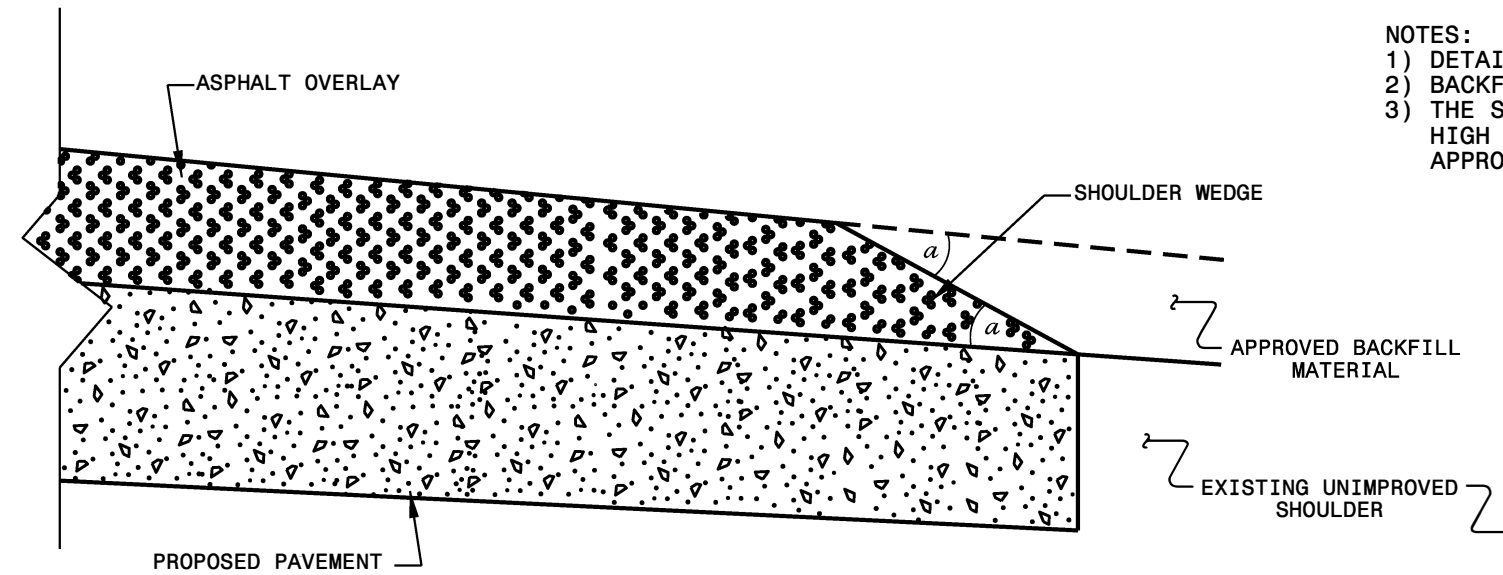

SHOULDER WEDGE DETAIL

(Resurfacing Projects w/ Widening or with Existing Paved Shoulder having no dropoffs)

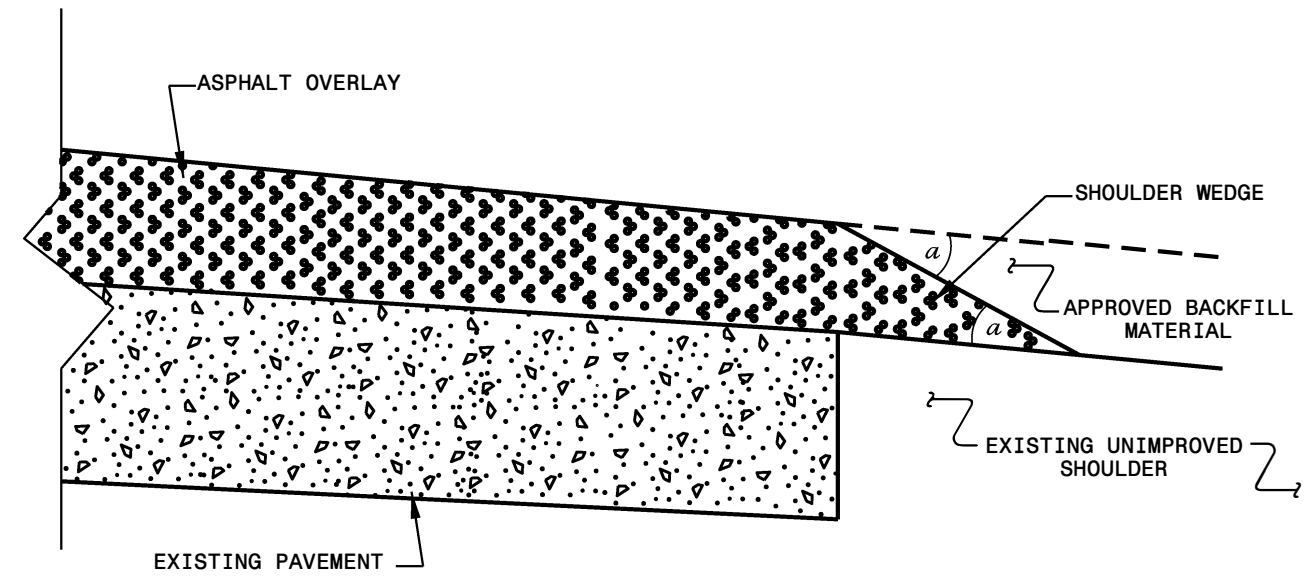

SHOULDER WEDGE DETAIL

(Resurfacing Projects w/ NO Widening)

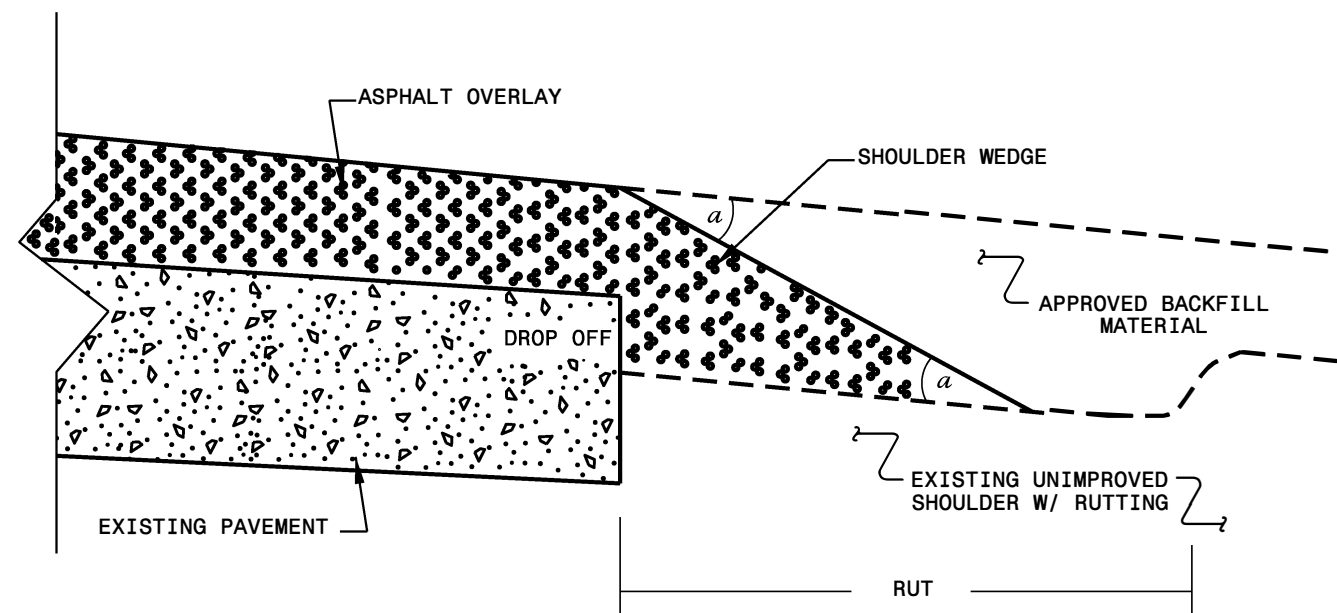

SHOULDER WEDGE DETAIL

(Resurfacing Adjacent to Rutted Shoulder)

- SHOULDER WEDGE ANGLE = 30°

CONTRACT STANDARDS AND DEVELOPMENT UNIT
Office 919-707-6950 FAX 919-250-4119

SHOULDER WEDGE DETAILS

ORIGINAL BY: T.SPELL DATE: 7-19-11
 MODIFIED BY: DATE: 2/2/16
 CHECKED BY: DATE:
 FILE SPEC.: s:\usr\details\stand\shoulderwedgedetail.dgn

ADA SUMMARY OF QUANTITIES - TOTALS

| | |
|---------|-----------------------|
| Project | 2025CPT.05.06.20921.1 |
| Number: | 2025CPT.05.06.20922.1 |
| County: | Wake |

| |
|-----------|
| Sheet No. |
| 16 |

| Project Number | County | Municipality | Resurfacing Route | 444700000-E (LF) Pedestrian Channelizing Devices | 460000000-N (EA) Generic Traffic Control Item - Pedestrian Transport Service (Per Trip) | 460000000-N (EA) Generic Traffic Control Item - Audible Warning Devices | 254900000-E (LF) 2'-6" Concrete Curb & Gutter | 275200000-E (LF) Remove and Replace Curb & Gutter | 273800000-E (SY) Remove and Replace Sidewalk | 411610000-N (EA) Sign Erection, relocate Type E (Ground Mounted) | 261250000-N (EA) Remove and Replace Concrete Curb Ramps |
|-----------------------|--------|--------------|--|---|--|--|--|--|---|---|--|
| 2025CPT.05.06.20922.1 | Wake | Raleigh | Dunn Rd From Falls Landing Dr To End Maintenance | 10 | 2 | 1 | 5 | | 9 | | 2 |
| 2025CPT.05.06.20921.1 | Wake | Wake Forest | Star Rd From US 1 Alt To End Maintenance | 10 | 3 | 1 | 10 | 10 | 12 | 1 | 3 |
| GRAND TOTAL | | | | 20 | 5 | 2 | 15 | 10 | 21 | 1 | 5 |

ADA SUMMARY OF QUANTITIES - DUNN RD FROM FALLS LANDING DR TO END MAINTENANCE

| | |
|-----------------|-----------------------|
| Municipality: | Raleigh |
| Project Number: | 2025CPT.05.06.20922.1 |
| County: | Wake |

| |
|-----------|
| Sheet No. |
| 17 |

| Ramp ID | Inset Map Number | Route 1 | Route 2 | 4447000000-E (LF) Pedestrian Channelizing Devices | 4600000000-N (EA) Generic Traffic Control Item - Pedestrian Transport Service (Per Trip) | 4600000000-N (EA) Generic Traffic Control Item - Audible Warning Devices | 2549000000-E (LF) 2'-6" Concrete Curb & Gutter | 2752000000-E (LF) Remove and Replace Curb & Gutter | 2738000000-E (SY) Remove and Replace Sidewalk | 4116100000-N (EA) Sign Erection, relocate Type E (Ground Mounted) | 2612500000-N (EA) Remove and Replace Concrete Curb Ramps | Improvement Type |
|---|------------------|-------------------|-------------|--|---|---|---|---|--|--|---|--------------------------|
| 4283 | 1 | SR-2011 (Dunn Rd) | Gaillard Dr | | | | | | 6 | | 1 | Type 1B - 848.06 |
| 4284 | 1 | SR-2011 (Dunn Rd) | Gaillard Dr | | | | | | 3 | | 1 | Type 1 Modified - 848.06 |
| - | - | - | - | 10 | 2 | 1 | 5* | - | - | - | - | |
| Sub-Total for Dunn Rd From Falls Landing Dr To End Maintenance | | | | 10 | 2 | 1 | 5 | 0 | 9 | 0 | 2 | |

Note: (1) ADA quantity totals are provided on the project 'ADA SUMMARY OF QUANTITIES - TOTALS' page. (2) * Contingency line item amount provided for adjustments outside of curb ramp paylimits.

ADA SUMMARY OF QUANTITIES - STAR RD FROM US 1 ALT TO END MAINTENANCE

| | |
|-----------------|-----------------------|
| Municipality: | Wake Forest |
| Project Number: | 2025CPT.05.06.20921.1 |
| County: | Wake |

| |
|-----------|
| Sheet No. |
| 18 |

| Ramp ID | Inset Map Number | Route 1 | Route 2 | 4447000000-E (LF) Pedestrian Channelizing Devices | 4600000000-N (EA) Generic Traffic Control Item - Pedestrian Transport Service (Per Trip) | 4600000000-N (EA) Generic Traffic Control Item - Audible Warning Devices | 2549000000-E (LF) 2'-6" Concrete Curb & Gutter | 2752000000-E (LF) Remove and Replace Curb & Gutter | 2738000000-E (SY) Remove and Replace Sidewalk | 4116100000-N (EA) Sign Erection, relocate Type E (Ground Mounted) | 2612500000-N (EA) Remove and Replace Concrete Curb Ramps | Improvement Type |
|---|------------------|----------------------|-------------------|--|---|---|---|---|--|--|---|--------------------------|
| 11860 | 1 | SR-2183 (Star Rd) | Via Fortunata Plz | | | | | | 6 | | 1 | Type 1C - 848.06 |
| 11861 | 1 | SR-2183 (Star Rd) | Via Fortunata Plz | | | | | | 6 | 1 | 1 | Type 1C - 848.06 |
| 4270 | 2 | US-1-ALT (S Main St) | SR-2183 (Star Rd) | | | | | 10 | | | 1 | Type 1 Modified - 848.06 |
| - | - | - | - | 10 | 3 | 1 | 10* | - | - | - | - | |
| Sub-Total for Star Rd From US 1 Alt To End Maintenance | | | | 10 | 3 | 1 | 10 | 10 | 12 | 1 | 3 | |

Note: (1) ADA quantity totals are provided on the project 'ADA SUMMARY OF QUANTITIES - TOTALS' page. (2) * Contingency line item amount provided for adjustments outside of curb ramp paylimits.

| | | |
|----------------------------|-----------|-----------|
| PROJECT NO. | SHEET NO. | TOTAL NO. |
| 2025CPT.05.06.20921.1, ETC | 19 | |

SUMMARY OF QUANTITIES

| PROJECT NO | COUNTY | MAP NO | ROUTE | DESCRIPTION | TYP NO | LANES | LANE TYPE | FINAL SURFACE TESTING REQUIRED | WARM MIX ASPHALT REQUIRED | LENGTH | WIDTH | 1220000000-E | 1245000000-E | 1260000000-E | 1297000000-E | | | 1308000000-E | 1330000000-E | 1503000000-E | 1519000000-E | 1523000000-E | 1575000000-E |
|---|--------|--------|-----------------------------|--|--------|-------|-----------|--------------------------------|---------------------------|--------|---------------|-----------------------|-------------------------|---------------------------|----------------|----------------|--------------------|--------------------|-----------------------------|-----------------------|-----------------------|------------------------------|--------------|
| | | | | | | | | | | | | INCIDENTAL STONE BASE | SHOULDER RECONSTRUCTION | AGGREGATE SHOULDER BORROW | 2 1/2" MILLING | 1 1/2" MILLING | 0" TO 1.5" MILLING | INCIDENTAL MILLING | INTERMEDIATE COURSE, I19.0C | SURFACE COURSE, S9.5B | SURFACE COURSE, S9.5C | ASPHALT BINDER FOR PLANT MIX | |
| | | | | | | | | | | | MI | FT | TONS | SMI | TON | SY | SY | SY | SY | TONS | TONS | TONS | TON |
| 2025CPT.05.06.20921.1 | Wake | 1 | SR-2007 / BRASSFIELD RD | FROM SR 2008 TO SR 2002 | 1 | 2 | 2WU | NO | NO | 0.37 | 20-28 | 15 | 0.70 | 131 | | | | 468 | | 427 | | | 31 |
| 2025CPT.05.06.20921.1 | Wake | 2 | SR-2008 / DEER FOREST TRL | FROM SR 2005 TO SR 2007 | 1 | 2 | 2WU | NO | NO | 0.66 | 20 | 15 | 1.30 | 233 | | | | 167 | | 667 | | | 45 |
| 2025CPT.05.06.20921.1 | Wake | 3 | SR-2183 / STAR RD | FROM US 1 ALT TO END MAINTENANCE | 1 | 2 | 2WU | NO | NO | 1.244 | 22-35 | 30 | 0.90 | 159 | | | 401 | 2,174 | | 1,522 | | | 111 |
| 2025CPT.05.06.20921.1 | Wake | 4 | SR-2224 / MITCHELL MILL RD | FROM PVMNT JOINT .17 MI EAST OF SR 2049 TO SR 2308 | 2 | 2 | 2WU | NO | NO | 4.817 | 24-40 | 50 | 9.25 | 1,633 | | | | 7,337 | | | 7,212 | | 426 |
| 2025CPT.05.06.20921.1 | Wake | 5 | SR-2227 / WATKINS RD | FROM SR 2224 TO SR 2217 | 3 | 2 | 2WU | NO | NO | 1.991 | 20-22 | 30 | 4.00 | 705 | 25,697 | 515 | | 1,659 | 3,845 | 2,226 | | | 329 |
| 2025CPT.05.06.20921.1 | Wake | 6 | SR-2338 / BAKER RD | FROM SR 1001 TO PVMT JT | 1 | 2 | 2WU | NO | NO | 0.329 | 18-21 | 2 | 0.30 | 53 | | | | 156 | | 302 | | | 25 |
| 2025CPT.05.06.20921.1 | Wake | 7 | SR-2434 / THORNBURG DR | FROM SR 2300 TO CUL-DE-SAC | 5 | 2 | 2WU | NO | NO | 0.482 | 20-25 | 7 | 0.75 | 132 | | | | 80 | | 429 | | | 30 |
| 2025CPT.05.06.20921.1 | Wake | 8 | SR-2435 / STUARTS RIDGE RD | FROM E WHITER ST TO SR 2434 | 5 | 2 | 2WU | NO | NO | 0.746 | 20 | 4 | 1.00 | 176 | | | | 431 | | 664 | | | 47 |
| 2025CPT.05.06.20921.1 | Wake | 9 | SR-4501 / PAMPLONA DR | FROM SR 1909 TO SR 1912 | 1 | 2 | 2WU | NO | NO | 0.394 | 20-51 | 5 | 0.30 | 53 | | | 40 | 242 | | 426 | | | 30 |
| 2025CPT.05.06.20921.1 | Wake | 10 | SR-4517 / LAURELFORD LN | FROM CUL-DE-SAC TO CUL-DE-SAC | 1 | 2 | 2WU | NO | NO | 0.533 | 22-44 | 5 | 0.50 | 88 | | | 130 | 306 | | 587 | | | 39 |
| 2025CPT.05.06.20921.1 | Wake | 11 | SR-4568 / NEW FOREST LN | FROM SR 1923 TO CUL-DE-SAC | 1 | 2 | 2WU | NO | NO | 0.561 | 20 | 5 | 0.50 | 88 | | | 298 | 137 | | 838 | | | 55 |
| 2025CPT.05.06.20921.1 | Wake | 12 | SR-4582 / PENFOLD LN | FROM SR 1927 TO END MAINTENANCE | 1 | 2 | 2WU | NO | NO | 0.125 | 20 | 1 | 0.15 | 26 | | | | 185 | | 138 | | | 9 |
| TOTAL FOR PROJ NO. 2025CPT.05.06.20921.1 | | | | | | | | | | | 12.252 | | 169 | 19.65 | 3,477 | 25,697 | 515 | 869 | 13,342 | 3,845 | 8,226 | 7,212 | 1,177 |
| 2025CPT.05.06.20922.1 | Wake | 13 | SR-1993 / LIGHT FALLS DR | FROM SR 1907 TO CUL-DE-SAC | 4 | 2 | 2WU | NO | NO | 0.196 | 20 | 1 | | | | | | 64 | | 152 | | | 11 |
| 2025CPT.05.06.20922.1 | Wake | 14 | SR-2011 / DUNN RD | FROM FALLS LANDING DR TO BEGIN CURB & GUTTER | 4 | 2 | 2WU | NO | NO | 0.256 | 20-36 | | | | | | | 100 | | 198 | | | 14 |
| 2025CPT.05.06.20922.1 | Wake | 15 | SR-3540 / WOODROSE LN | FROM SR 2044 TO CUL-DE-SAC | 4 | 2 | 2WU | NO | NO | 0.052 | 20 | 1 | | | | | | 56 | | 50 | | | 5 |
| 2025CPT.05.06.20922.1 | Wake | 16 | SR-3541 / BRACKEN CT | FROM SR 2044 TO CUL-DE-SAC | 4 | 2 | 2WU | NO | NO | 0.078 | 20 | 2 | | | | | | 56 | | 73 | | | 5 |
| 2025CPT.05.06.20922.1 | Wake | 17 | SR-3542 / LIGHTFOOT CT | FROM SR 2044 TO CUL-DE-SAC | 4 | 2 | 2WU | NO | NO | 0.126 | 20 | 3 | | | | | | 56 | | 98 | | | 6 |
| 2025CPT.05.06.20922.1 | Wake | 18 | SR-3543 / GREENHOW LN | FROM SR 2044 TO CUL-DE-SAC | 4 | 2 | 2WU | NO | NO | 0.121 | 20 | 5 | | | | | | 56 | | 100 | | | 7 |
| 2025CPT.05.06.20922.1 | Wake | 19 | SR-4502 / TROUVILLE CT | FROM SR 4501 TO CUL-DE-SAC | 4 | 2 | 2WU | NO | NO | 0.08 | 20 | 1 | | | | | | 101 | | 81 | | | 6 |
| 2025CPT.05.06.20922.1 | Wake | 20 | SR-4529 / TYNEWIND DR | FROM SR 4517 TO SR 4568 | 4 | 2 | 2WU | NO | NO | 0.642 | 20 | 1 | | | | | | 266 | | 109 | | | 7 |
| 2025CPT.05.06.20922.1 | Wake | 21 | SR-4560 / RIVER PARK DR | FROM SR 4517 TO SR 4561 | 4 | 2 | 2WU | NO | NO | 0.296 | 20 | 1 | | | | | | 228 | | 219 | | | 15 |
| 2025CPT.05.06.20922.1 | Wake | 22 | SR-4561 / WELCOME DR | FROM SR 1986 TO CUL-DE-SAC | 4 | 2 | 2WU | NO | NO | 0.215 | 20 | 1 | | | | | | 56 | | 162 | | | 11 |
| 2025CPT.05.06.20922.1 | Wake | 23 | SR-4569 / WISLEY WAY | FROM SR 4568 TO CUL-DE-SAC | 4 | 2 | 2WU | NO | NO | 0.115 | 18 | 1 | | | | | | 114 | | 100 | | | 7 |
| 2025CPT.05.06.20922.1 | Wake | 24 | SR-4583 / CLARINCARDE CT | FROM SR 4582 TO CUL-DE-SAC | 4 | 2 | 2WU | NO | NO | 0.27 | 20 | 1 | | | | | | 120 | | 210 | | | 14 |
| 2025CPT.05.06.20922.1 | Wake | 25 | SR-5240 / SWEET CHESTNUT LN | FROM SR 2510 TO CUL-DE-SAC | 4 | 2 | 2WU | NO | NO | 0.271 | 18 | 1 | | | | | | 50 | | 205 | | | 14 |
| 2025CPT.05.06.20922.1 | Wake | 26 | SR-5252 / BRIERLEY HILL CT | FROM SR 5240 TO CUL-DE-SAC | 4 | 2 | 2WU | NO | NO | 0.045 | 20 | 1 | | | | | | 114 | | 57 | | | 4 |
| 2025CPT.05.06.20922.1 | Wake | 27 | SR-5431 / WINFREE LN | FROM SR 2435 TO CUL-DE-SAC | 4 | 2 | 2WD | NO | NO | 0.16 | 20 | 1 | | | | | | 107 | | 135 | | | 9 |
| TOTAL FOR PROJ NO. 2025CPT.05.06.20922.1 | | | | | | | | | | | 2.923 | | 21 | | | | | | 1,544 | | 1,949 | | 135 |
| GRAND TOTAL | | | | | | | | | | | 15.175 | | 190 | 19.65 | 3,477 | 25,697 | 515 | 869 | 14,886 | 3,845 | 10,175 | 7,212 | 1,312 |

| | | |
|----------------------------|-----------|-----------|
| PROJECT NO. | SHEET NO. | TOTAL NO. |
| 2025CPT.05.06.20921.1, ETC | 20 | |

SUMMARY OF QUANTITIES

| PROJECT NO | COUNTY | MAP NO | ROUTE | DESCRIPTION | TYP NO | LANES | LANE TYPE | FINAL SURFACE TESTING REQUIRED | WARM MIX ASPHALT REQUIRED | LENGTH | WIDTH | 1704000000-E | 2549000000-E | 2612500000-N | 2738000000-E | 2752000000-E | 2830000000-N | 2845000000-N | 4116100000-N | 4600000000-N | | 7444000000-E | | | |
|---|--------|--------|-----------------------------|--|--------|-------|-----------|--------------------------------|---------------------------|--------|---------------|----------------------------|---------------------|--|-----------------------------|----------------------------------|-----------------|---------------------------|---|-------------------------|------------------------------|-----------------------|------------|--|--|
| | | | | | | | | | | | | PATCHING EXISTING PAVEMENT | 2'-6" CURB & GUTTER | REMOVE AND REPLACE CONCRETE CURB RAMPS | REMOVE AND REPLACE SIDEWALK | REMOVE AND REPLACE CURB & GUTTER | ADJUST MANHOLES | ADJUST METER OR VALVE BOX | SIGN ERECTION, RELOCATE TYPE E (GROUND MOUNTED) | AUDIBLE WARNING DEVICES | PEDESTRIAN TRANSPORT SERVICE | INDUCTIVE LOOP SAWCUT | | | |
| | | | | | | | | | | | MI | FT | TONS | LF | EA | SY | LF | EA | EA | EA | EA | EA | EA | | |
| 2025CPT.05.06.20921.1 | Wake | 1 | SR-2007 / BRASSFIELD RD | FROM SR 2008 TO SR 2002 | 1 | 2 | 2WU | NO | NO | 0.37 | 20-28 | 74 | | | | | | | | | | | | | |
| 2025CPT.05.06.20921.1 | Wake | 2 | SR-2008 / DEER FOREST TRL | FROM SR 2005 TO SR 2007 | 1 | 2 | 2WU | NO | NO | 0.66 | 20 | 31 | | | | | | | | | | | | | |
| 2025CPT.05.06.20921.1 | Wake | 3 | SR-2183 / STAR RD | FROM US 1 ALT TO END MAINTENANCE | 1 | 2 | 2WU | NO | NO | 1.244 | 22-35 | 258 | 10 | 3 | 12 | 10 | | | 1 | 1 | 3 | | | | |
| 2025CPT.05.06.20921.1 | Wake | 4 | SR-2224 / MITCHELL MILL RD | FROM PVMNT JOINT .17 MI EAST OF SR 2049 TO SR 2308 | 2 | 2 | 2WU | NO | NO | 4.817 | 24-40 | 6 | | | | | | | | | | | 830 | | |
| 2025CPT.05.06.20921.1 | Wake | 5 | SR-2227 / WATKINS RD | FROM SR 2224 TO SR 2217 | 3 | 2 | 2WU | NO | NO | 1.991 | 20-22 | 1 | | | | | | | | | | | | | |
| 2025CPT.05.06.20921.1 | Wake | 6 | SR-2338 / BAKER RD | FROM SR 1001 TO PVMNT JT | 1 | 2 | 2WU | NO | NO | 0.329 | 18-21 | 108 | | | | | | | | | | | | | |
| 2025CPT.05.06.20921.1 | Wake | 7 | SR-2434 / THORNBURG DR | FROM SR 2300 TO CUL-DE-SAC | 5 | 2 | 2WU | NO | NO | 0.482 | 20-25 | 49 | | | | | | | | | | | | | |
| 2025CPT.05.06.20921.1 | Wake | 8 | SR-2435 / STUARTS RIDGE RD | FROM E WHITER ST TO SR 2434 | 5 | 2 | 2WU | NO | NO | 0.746 | 20 | 87 | | | | | | | | | | | | | |
| 2025CPT.05.06.20921.1 | Wake | 9 | SR-4501 / PAMPLONA DR | FROM SR 1909 TO SR 1912 | 1 | 2 | 2WU | NO | NO | 0.394 | 20-51 | 44 | | | | | | | | | | | | | |
| 2025CPT.05.06.20921.1 | Wake | 10 | SR-4517 / LAURELFORD LN | FROM CUL-DE-SAC TO CUL-DE-SAC | 1 | 2 | 2WU | NO | NO | 0.533 | 22-44 | 10 | | | | | | | | | | | | | |
| 2025CPT.05.06.20921.1 | Wake | 11 | SR-4568 / NEW FOREST LN | FROM SR 1923 TO CUL-DE-SAC | 1 | 2 | 2WU | NO | NO | 0.561 | 20 | 15 | | | | | | | | | | | | | |
| 2025CPT.05.06.20921.1 | Wake | 12 | SR-4582 / PENFOLD LN | FROM SR 1927 TO END MAINTENANCE | 1 | 2 | 2WU | NO | NO | 0.125 | 20 | | | | | | | | | | | | | | |
| TOTAL FOR PROJ NO. 2025CPT.05.06.20921.1 | | | | | | | | | | | | | | | | | | | | | | | | | |
| | | | | | | | | | | | 12.252 | | 683 | 10 | 3 | 12 | 10 | | | 1 | 1 | 3 | 830 | | |
| 2025CPT.05.06.20922.1 | Wake | 13 | SR-1993 / LIGHT FALLS DR | FROM SR 1907 TO CUL-DE-SAC | 4 | 2 | 2WU | NO | NO | 0.196 | 20 | 30 | | | | | | | | | | | | | |
| 2025CPT.05.06.20922.1 | Wake | 14 | SR-2011 / DUNN RD | FROM FALLS LANDING DR TO BEGIN CURB & GUTTER | 4 | 2 | 2WU | NO | NO | 0.256 | 20-36 | 25 | 5 | 2 | 9 | | 5 | 19 | | 1 | 2 | | | | |
| 2025CPT.05.06.20922.1 | Wake | 15 | SR-3540 / WOODROSE LN | FROM SR 2044 TO CUL-DE-SAC | 4 | 2 | 2WU | NO | NO | 0.052 | 20 | 37 | | | | | | | | | | | | | |
| 2025CPT.05.06.20922.1 | Wake | 16 | SR-3541 / BRACKEN CT | FROM SR 2044 TO CUL-DE-SAC | 4 | 2 | 2WU | NO | NO | 0.078 | 20 | 4 | | | | | | | | | | | | | |
| 2025CPT.05.06.20922.1 | Wake | 17 | SR-3542 / LIGHTFOOT CT | FROM SR 2044 TO CUL-DE-SAC | 4 | 2 | 2WU | NO | NO | 0.126 | 20 | 1 | | | | | | | | | | | | | |
| 2025CPT.05.06.20922.1 | Wake | 18 | SR-3543 / GREENHOW LN | FROM SR 2044 TO CUL-DE-SAC | 4 | 2 | 2WU | NO | NO | 0.121 | 20 | 1 | | | | | | | | | | | | | |
| 2025CPT.05.06.20922.1 | Wake | 19 | SR-4502 / TROUVILLE CT | FROM SR 4501 TO CUL-DE-SAC | 4 | 2 | 2WU | NO | NO | 0.08 | 20 | 14 | | | | | | | | | | | | | |
| 2025CPT.05.06.20922.1 | Wake | 20 | SR-4529 / TYNEWIND DR | FROM SR 4517 TO SR 4568 | 4 | 2 | 2WU | NO | NO | 0.642 | 20 | 2 | | | | | | 2 | | | | | | | |
| 2025CPT.05.06.20922.1 | Wake | 21 | SR-4560 / RIVER PARK DR | FROM SR 4517 TO SR 4561 | 4 | 2 | 2WU | NO | NO | 0.296 | 20 | 11 | | | | | | 4 | | | | | | | |
| 2025CPT.05.06.20922.1 | Wake | 22 | SR-4561 / WELCOME DR | FROM SR 1986 TO CUL-DE-SAC | 4 | 2 | 2WU | NO | NO | 0.215 | 20 | 2 | | | | | | | | | | | | | |
| 2025CPT.05.06.20922.1 | Wake | 23 | SR-4569 / WISLEY WAY | FROM SR 4568 TO CUL-DE-SAC | 4 | 2 | 2WU | NO | NO | 0.115 | 18 | 1 | | | | | | 4 | | | | | | | |
| 2025CPT.05.06.20922.1 | Wake | 24 | SR-4583 / CLARINCARDE CT | FROM SR 4582 TO CUL-DE-SAC | 4 | 2 | 2WU | NO | NO | 0.27 | 20 | | | | | | | | | | | | | | |
| 2025CPT.05.06.20922.1 | Wake | 25 | SR-5240 / SWEET CHESTNUT LN | FROM SR 2510 TO CUL-DE-SAC | 4 | 2 | 2WU | NO | NO | 0.271 | 18 | 24 | | | | | | 2 | | | | | | | |
| 2025CPT.05.06.20922.1 | Wake | 26 | SR-5252 / BRIERLEY HILL CT | FROM SR 5240 TO CUL-DE-SAC | 4 | 2 | 2WU | NO | NO | 0.045 | 20 | | | | | | | 2 | | | | | | | |
| 2025CPT.05.06.20922.1 | Wake | 27 | SR-5431 / WINFREE LN | FROM SR 2435 TO CUL-DE-SAC | 4 | 2 | 2WD | NO | NO | 0.16 | 20 | 10 | | | | | | 2 | | | | | | | |
| TOTAL FOR PROJ NO. 2025CPT.05.06.20922.1 | | | | | | | | | | | | | | | | | | | | | | | | | |
| | | | | | | | | | | | 2.923 | | 162 | 5 | 2 | 9 | | 5 | 35 | | 1 | 2 | | | |
| GRAND TOTAL | | | | | | | | | | | | | | | | | | | | | | | | | |
| | | | | | | | | | | | 15.175 | | 845 | 15 | 5 | 21 | 10 | 5 | 35 | 1 | 2 | 5 | 830 | | |

| | | |
|----------------------------|-----------|-----------|
| PROJECT NO. | SHEET NO. | TOTAL NO. |
| 2025CPT.05.06.20921.1, ETC | 21 | |

THERMOPLASTIC AND PAINT QUANTITIES

| PROJECT NO | COUNTY | MAP NO | ROUTE | DESCRIPTION | TYP NO | LANES | LANE TYPE | LENGTH | WIDTH | 4413000000-E | 4447000000-E | 4457000000-N | 4685000000-E | | 4687000000-E | | |
|---|--------|--------|-----------------------------|--|--------|-------|-----------|--------|---------------|--|---------------------------------|---------------------------|------------------------|-------------------------|-------------------------|------------|--------|
| | | | | | | | | | | WORK ZONE ADVANCE/ GENERAL WARNING SIGNING | PEDESTRIAN CHANNELIZING DEVICES | TEMPORARY TRAFFIC CONTROL | 4" X 90 M WHITE THERMO | 4" X 90 M YELLOW THERMO | 4" X 240 M WHITE THERMO | | |
| | | | | | | | | | MI | FT | SF | LF | LS | LF | LF | LF | |
| 2025CPT.05.06.20921.1 | Wake | 1 | SR-2007 / BRASSFIELD RD | FROM SR 2008 TO SR 2002 | 1 | 2 | 2WU | 0.37 | 20-28 | 41 | | | | | 4,280 | 4,160 | |
| 2025CPT.05.06.20921.1 | Wake | 2 | SR-2008 / DEER FOREST TRL | FROM SR 2005 TO SR 2007 | 1 | 2 | 2WU | 0.66 | 20 | 74 | | | | | 7,450 | 7,450 | |
| 2025CPT.05.06.20921.1 | Wake | 3 | SR-2183 / STAR RD | FROM US 1 ALT TO END MAINTENANCE | 1 | 2 | 2WU | 1.244 | 22-35 | 139 | | 10 | | | 12,770 | 13,370 | |
| 2025CPT.05.06.20921.1 | Wake | 4 | SR-2224 / MITCHELL MILL RD | FROM PVMNT JOINT .17 MI EAST OF SR 2049 TO SR 2308 | 2 | 2 | 2WU | 4.817 | 24-40 | 540 | | | | | 56,740 | 59,930 | 510.00 |
| 2025CPT.05.06.20921.1 | Wake | 5 | SR-2227 / WATKINS RD | FROM SR 2224 TO SR 2217 | 3 | 2 | 2WU | 1.991 | 20-22 | 223 | | | | | 22,940 | 22,930 | |
| 2025CPT.05.06.20921.1 | Wake | 6 | SR-2338 / BAKER RD | FROM SR 1001 TO PVMT JT | 1 | 2 | 2WU | 0.329 | 18-21 | 37 | | | | | 3,660 | 3,660 | |
| 2025CPT.05.06.20921.1 | Wake | 7 | SR-2434 / THORNBURG DR | FROM SR 2300 TO CUL-DE-SAC | 5 | 2 | 2WU | 0.482 | 20-25 | 54 | | | | | | | |
| 2025CPT.05.06.20921.1 | Wake | 8 | SR-2435 / STUARTS RIDGE RD | FROM E WHITER ST TO SR 2434 | 5 | 2 | 2WU | 0.746 | 20 | 84 | | | | | | | |
| 2025CPT.05.06.20921.1 | Wake | 9 | SR-4501 / PAMPLONA DR | FROM SR 1909 TO SR 1912 | 1 | 2 | 2WU | 0.394 | 20-51 | 44 | | | | | | | |
| 2025CPT.05.06.20921.1 | Wake | 10 | SR-4517 / LAURELFORD LN | FROM CUL-DE-SAC TO CUL-DE-SAC | 1 | 2 | 2WU | 0.533 | 22-44 | 60 | | | | | | | |
| 2025CPT.05.06.20921.1 | Wake | 11 | SR-4568 / NEW FOREST LN | FROM SR 1923 TO CUL-DE-SAC | 1 | 2 | 2WU | 0.561 | 20 | 63 | | | | | | | |
| 2025CPT.05.06.20921.1 | Wake | 12 | SR-4582 / PENFOLD LN | FROM SR 1927 TO END MAINTENANCE | 1 | 2 | 2WU | 0.125 | 20 | 14 | | | | | | | |
| TOTAL FOR PROJ NO. 2025CPT.05.06.20921.1 | | | | | | | | | 12.252 | | 1,373 | 10 | 1.00 | 107,840 | 111,500 | 510 | |
| | | | | | | | | | | | | | 219,340 | | | | |
| 2025CPT.05.06.20922.1 | Wake | 13 | SR-1993 / LIGHT FALLS DR | FROM SR 1907 TO CUL-DE-SAC | 4 | 2 | 2WU | 0.196 | 20 | 22 | | | | | | | |
| 2025CPT.05.06.20922.1 | Wake | 14 | SR-2011 / DUNN RD | FROM FALLS LANDING DR TO BEGIN CURB & GUTTER | 4 | 2 | 2WU | 0.256 | 20-36 | 29 | | 10 | | | 2,740 | 2,640 | |
| 2025CPT.05.06.20922.1 | Wake | 15 | SR-3540 / WOODROSE LN | FROM SR 2044 TO CUL-DE-SAC | 4 | 2 | 2WU | 0.052 | 20 | 6 | | | | | | | |
| 2025CPT.05.06.20922.1 | Wake | 16 | SR-3541 / BRACKEN CT | FROM SR 2044 TO CUL-DE-SAC | 4 | 2 | 2WU | 0.078 | 20 | 9 | | | | | | | |
| 2025CPT.05.06.20922.1 | Wake | 17 | SR-3542 / LIGHTFOOT CT | FROM SR 2044 TO CUL-DE-SAC | 4 | 2 | 2WU | 0.126 | 20 | 14 | | | | | | | |
| 2025CPT.05.06.20922.1 | Wake | 18 | SR-3543 / GREENHOW LN | FROM SR 2044 TO CUL-DE-SAC | 4 | 2 | 2WU | 0.121 | 20 | 14 | | | | | | | |
| 2025CPT.05.06.20922.1 | Wake | 19 | SR-4502 / TROUVILLE CT | FROM SR 4501 TO CUL-DE-SAC | 4 | 2 | 2WU | 0.08 | 20 | 9 | | | | | | | |
| 2025CPT.05.06.20922.1 | Wake | 20 | SR-4529 / TYNEWIND DR | FROM SR 4517 TO SR 4568 | 4 | 2 | 2WU | 0.642 | 20 | 72 | | | | | | | |
| 2025CPT.05.06.20922.1 | Wake | 21 | SR-4560 / RIVER PARK DR | FROM SR 4517 TO SR 4561 | 4 | 2 | 2WU | 0.296 | 20 | 33 | | | | | | | |
| 2025CPT.05.06.20922.1 | Wake | 22 | SR-4561 / WELCOME DR | FROM SR 1986 TO CUL-DE-SAC | 4 | 2 | 2WU | 0.215 | 20 | 24 | | | | | | | |
| 2025CPT.05.06.20922.1 | Wake | 23 | SR-4569 / WISLEY WAY | FROM SR 4568 TO CUL-DE-SAC | 4 | 2 | 2WU | 0.115 | 18 | 13 | | | | | | | |
| 2025CPT.05.06.20922.1 | Wake | 24 | SR-4583 / CLARINCARDE CT | FROM SR 4582 TO CUL-DE-SAC | 4 | 2 | 2WU | 0.27 | 20 | 30 | | | | | | | |
| 2025CPT.05.06.20922.1 | Wake | 25 | SR-5240 / SWEET CHESTNUT LN | FROM SR 2510 TO CUL-DE-SAC | 4 | 2 | 2WU | 0.271 | 18 | 30 | | | | | | | |
| 2025CPT.05.06.20922.1 | Wake | 26 | SR-5252 / BRIERLEY HILL CT | FROM SR 5240 TO CUL-DE-SAC | 4 | 2 | 2WU | 0.045 | 20 | 5 | | | | | | | |
| 2025CPT.05.06.20922.1 | Wake | 27 | SR-5431 / WINFREE LN | FROM SR 2435 TO CUL-DE-SAC | 4 | 2 | 2WD | 0.16 | 20 | 18 | | | | | | | |
| TOTAL FOR PROJ NO. 2025CPT.05.06.20922.1 | | | | | | | | | 2.923 | | 328 | 10 | 1.000 | 2,740 | 2,640 | | |
| | | | | | | | | | | | | | 5,380 | | | | |
| GRAND TOTAL | | | | | | | | | 15.175 | | 1,701 | 20 | 1.000 | 110,580 | 114,140 | 510 | |
| | | | | | | | | | | | | | 224,720 | | | | |

| | | |
|----------------------------|-----------|-----------|
| PROJECT NO. | SHEET NO. | TOTAL NO. |
| 2025CPT.05.06.20921.1, ETC | 22 | |

THERMOPLASTIC AND PAINT QUANTITIES

| PROJECT NO | COUNTY | MAP NO | ROUTE | DESCRIPTION | TYP NO | LANES | LANE TYPE | LENGTH | WIDTH | 4688000000-E | | 4695000000-E | 4700000000-E | | 4709000000-E | 4720000000-E | | 4725000000-E | | | |
|---|--------|--------|-----------------------------|--|--------|-------|-----------|--------|---------------|------------------------|-------------------------|-------------------------|-------------------------|--------------------------|-------------------------|-----------------------|----------------------|----------------------|----------------------|----------------------------|----------|
| | | | | | | | | | | 6" X 90 M WHITE THERMO | 6" X 90 M YELLOW THERMO | 8" X 90 M YELLOW THERMO | 12" X 90 M WHITE THERMO | 12" X 90 M YELLOW THERMO | 24" X 90 M WHITE THERMO | THERMO MSG AHEAD 90 M | THERMO MSG STOP 90 M | THERMO LT ARROW 90 M | THERMO RT ARROW 90 M | THERMO STR & LT ARROW 90 M | |
| | | | | | | | | | | LF | LF | LF | LF | LF | LF | EA | EA | EA | EA | EA | |
| 2025CPT.05.06.20921.1 | Wake | 1 | SR-2007 / BRASSFIELD RD | FROM SR 2008 TO SR 2002 | 1 | 2 | 2WU | 0.37 | 20-28 | | | | | | 50 | 5 | 4 | | | | |
| 2025CPT.05.06.20921.1 | Wake | 2 | SR-2008 / DEER FOREST TRL | FROM SR 2005 TO SR 2007 | 1 | 2 | 2WU | 0.66 | 20 | | | | | | | | | | | | |
| 2025CPT.05.06.20921.1 | Wake | 3 | SR-2183 / STAR RD | FROM US 1 ALT TO END MAINTENANCE | 1 | 2 | 2WU | 1.244 | 22-35 | | | 140 | | | 80 | | | 2 | | | |
| 2025CPT.05.06.20921.1 | Wake | 4 | SR-2224 / MITCHELL MILL RD | FROM PVMNT JOINT .17 MI EAST OF SR 2049 TO SR 2308 | 2 | 2 | 2WU | 4.817 | 24-40 | 730 | 1,130 | | 210 | 300 | 160 | 10 | 8 | 13 | 3 | 2 | |
| 2025CPT.05.06.20921.1 | Wake | 5 | SR-2227 / WATKINS RD | FROM SR 2224 TO SR 2217 | 3 | 2 | 2WU | 1.991 | 20-22 | | | | | | | | | | | | |
| 2025CPT.05.06.20921.1 | Wake | 6 | SR-2338 / BAKER RD | FROM SR 1001 TO PVMT JT | 1 | 2 | 2WU | 0.329 | 18-21 | | | | | | | | | | | | |
| 2025CPT.05.06.20921.1 | Wake | 7 | SR-2434 / THORNBURG DR | FROM SR 2300 TO CUL-DE-SAC | 5 | 2 | 2WU | 0.482 | 20-25 | | | | | | | | | | | | |
| 2025CPT.05.06.20921.1 | Wake | 8 | SR-2435 / STUARTS RIDGE RD | FROM E WHITER ST TO SR 2434 | 5 | 2 | 2WU | 0.746 | 20 | | | | | | | | | | | | |
| 2025CPT.05.06.20921.1 | Wake | 9 | SR-4501 / PAMPLONA DR | FROM SR 1909 TO SR 1912 | 1 | 2 | 2WU | 0.394 | 20-51 | | | | | | | | | | | | |
| 2025CPT.05.06.20921.1 | Wake | 10 | SR-4517 / LAURELFORD LN | FROM CUL-DE-SAC TO CUL-DE-SAC | 1 | 2 | 2WU | 0.533 | 22-44 | | | | | | | | | | | | |
| 2025CPT.05.06.20921.1 | Wake | 11 | SR-4568 / NEW FOREST LN | FROM SR 1923 TO CUL-DE-SAC | 1 | 2 | 2WU | 0.561 | 20 | | | | | | | | | | | | |
| 2025CPT.05.06.20921.1 | Wake | 12 | SR-4582 / PENFOLD LN | FROM SR 1927 TO END MAINTENANCE | 1 | 2 | 2WU | 0.125 | 20 | | | | | | | | | | | | |
| TOTAL FOR PROJ NO. 2025CPT.05.06.20921.1 | | | | | | | | | 12.252 | | 730 | 1,130 | 140 | 210 | 300.00 | 290 | 15 | 12 | 15 | 3 | 2 |
| | | | | | | | | | | 1,860 | | 510 | | 27 | | 20 | | | | | |
| 2025CPT.05.06.20922.1 | Wake | 13 | SR-1993 / LIGHT FALLS DR | FROM SR 1907 TO CUL-DE-SAC | 4 | 2 | 2WU | 0.196 | 20 | | | | | | | | | | | | |
| 2025CPT.05.06.20922.1 | Wake | 14 | SR-2011 / DUNN RD | FROM FALLS LANDING DR TO BEGIN CURB & GUTTER | 4 | 2 | 2WU | 0.256 | 20-36 | | | | | | | | | | 1 | | |
| 2025CPT.05.06.20922.1 | Wake | 15 | SR-3540 / WOODROSE LN | FROM SR 2044 TO CUL-DE-SAC | 4 | 2 | 2WU | 0.052 | 20 | | | | | | | | | | | | |
| 2025CPT.05.06.20922.1 | Wake | 16 | SR-3541 / BRACKEN CT | FROM SR 2044 TO CUL-DE-SAC | 4 | 2 | 2WU | 0.078 | 20 | | | | | | | | | | | | |
| 2025CPT.05.06.20922.1 | Wake | 17 | SR-3542 / LIGHTFOOT CT | FROM SR 2044 TO CUL-DE-SAC | 4 | 2 | 2WU | 0.126 | 20 | | | | | | | | | | | | |
| 2025CPT.05.06.20922.1 | Wake | 18 | SR-3543 / GREENHOW LN | FROM SR 2044 TO CUL-DE-SAC | 4 | 2 | 2WU | 0.121 | 20 | | | | | | | | | | | | |
| 2025CPT.05.06.20922.1 | Wake | 19 | SR-4502 / TROUVILLE CT | FROM SR 4501 TO CUL-DE-SAC | 4 | 2 | 2WU | 0.08 | 20 | | | | | | | | | | | | |
| 2025CPT.05.06.20922.1 | Wake | 20 | SR-4529 / TYNEWIND DR | FROM SR 4517 TO SR 4568 | 4 | 2 | 2WU | 0.642 | 20 | | | | | | | | | | | | |
| 2025CPT.05.06.20922.1 | Wake | 21 | SR-4560 / RIVER PARK DR | FROM SR 4517 TO SR 4561 | 4 | 2 | 2WU | 0.296 | 20 | | | | | | | | | | | | |
| 2025CPT.05.06.20922.1 | Wake | 22 | SR-4561 / WELCOME DR | FROM SR 1986 TO CUL-DE-SAC | 4 | 2 | 2WU | 0.215 | 20 | | | | | | | | | | | | |
| 2025CPT.05.06.20922.1 | Wake | 23 | SR-4569 / WISLEY WAY | FROM SR 4568 TO CUL-DE-SAC | 4 | 2 | 2WU | 0.115 | 18 | | | | | | | | | | | | |
| 2025CPT.05.06.20922.1 | Wake | 24 | SR-4583 / CLARINCARDE CT | FROM SR 4582 TO CUL-DE-SAC | 4 | 2 | 2WU | 0.27 | 20 | | | | | | | | | | | | |
| 2025CPT.05.06.20922.1 | Wake | 25 | SR-5240 / SWEET CHESTNUT LN | FROM SR 2510 TO CUL-DE-SAC | 4 | 2 | 2WU | 0.271 | 18 | | | | | | | | | | | | |
| 2025CPT.05.06.20922.1 | Wake | 26 | SR-5252 / BRIERLEY HILL CT | FROM SR 5240 TO CUL-DE-SAC | 4 | 2 | 2WU | 0.045 | 20 | | | | | | | | | | | | |
| 2025CPT.05.06.20922.1 | Wake | 27 | SR-5431 / WINFREE LN | FROM SR 2435 TO CUL-DE-SAC | 4 | 2 | 2WD | 0.16 | 20 | | | | | | | | | | | | |
| TOTAL FOR PROJ NO. 2025CPT.05.06.20922.1 | | | | | | | | | 2.923 | | | | | | | | | | 1 | | |
| | | | | | | | | | | | | | | | | | | 1 | | | |
| GRAND TOTAL | | | | | | | | | 15.175 | | 730 | 1,130 | 140 | 210 | 300.00 | 290 | 15 | 12 | 15 | 4 | 2 |
| | | | | | | | | | | 1,860 | | 510 | | 27 | | 21 | | | | | |

SIGNING FOR RESURFACING PROJECTS

LEGEND
 ┆ STATIONARY SIGN
 ← DIRECTION OF TRAFFIC FLOW

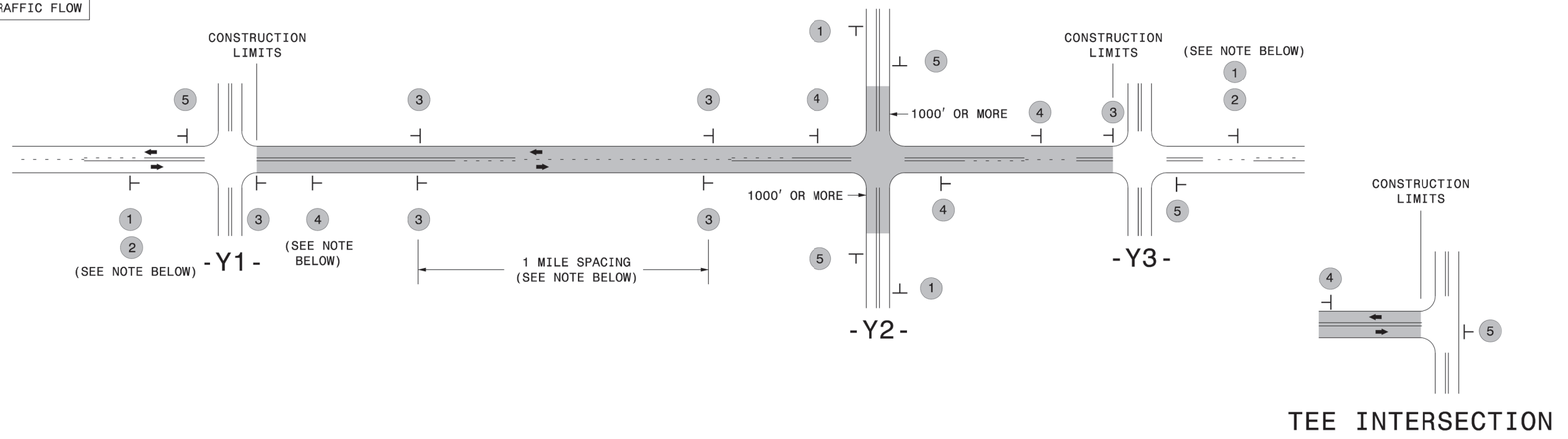

MAINLINE (-L-) SIGNING

-Y- LINE SIGNING

| | | | | |
|---|---|--|---|---|
| SIGNING NOTES AND PLACEMENT PER DIRECTION | 1 | | PLACE 1000' PRIOR TO BEGINNING OF CONSTRUCTION LIMITS. ONLY USED ON -Y- LINES IF RESURFACING LIMITS EXTEND 1000' ALONG -Y- LINE. | <p>NO REQUIRED STATIONARY SIGNING FOR THE FOLLOWING -Y- LINE CONDITIONS:</p> <ol style="list-style-type: none"> 1) LESS THAN 1000' OF RESURFACING ALONG -Y- LINE 2) SUBDIVISION ROADS 3) DEAD END ROADS <p>WHEN PAVING/CONSTRUCTION ACTIVITIES PROCEED ACROSS AN UNSIGNED -Y- LINE, PORTABLE ADVANCE WARNING SIGNS SHALL BE USED ALONG THE -Y- LINE AS SHOWN BELOW. REMOVE UPON COMPLETION OF WORK.</p> <div style="display: flex; justify-content: space-around;"> <div style="text-align: center;"> W20-1 48" X 48" PLACED 500' IN ADVANCE OF FLAGGER. </div> <div style="text-align: center;"> W20-7 A 48" X 48" PLACED 250' IN ADVANCE OF FLAGGER. </div> </div> |
| | 2 | | #2 SIGN ONLY USED WHEN CONSTRUCTION LIMITS ARE 2 OR MORE MILES IN LENGTH. ROUND UP TO NEXT WHOLE NUMBER. (NO FRACTIONAL OR DECIMAL NUMBERS) | |
| | 3 | | - PLACE INITIALLY AT THE CONSTRUCTION LIMITS AND SPACE 1 MILE APART THEREAFTER. - AT TEE INTERSECTIONS INSTALL INITIALLY 1/2 MILE FROM INTERSECTION AND SPACE 1 MILE APART THEREAFTER. | |
| | 4 | | - THESE ARE FOR -Y- LINES THAT ARE "THROUGH" ROADWAYS. - DEAD END AND SUBDIVISION ROADS ARE NOT "THROUGH" ROADWAYS. - INSTALL 500' +/- FROM EACH -Y- LINE APPROACH AS SHOWN ABOVE. - FOR MULTIPLE -Y- LINES THAT ARE SEPARATED BY 0.25 MILES OR LESS, TREAT AS A SINGLE UNIT AND INSTALL WITHIN 500' OF EACH APPROACH. - A MAXIMUM OF 2 SIGN SETS PER MILE. DO NOT INSTALL WHEN -Y- LINES ARE WITHIN 0.5 MILES FROM "END ROAD WORK" SIGN. - FOR TEE INTERSECTIONS, INSTALL WITHIN 500' +/- OF THE INTERSECTION ALONG -L- LINE. | |
| | 5 | | PLACE 500' FOLLOWING THE END OF CONSTRUCTION LIMITS OR AS SHOWN WHEN WORK ENDS AT A 3-WAY TEE INTERSECTION. | |

THE ABOVE SIGNS ARE ALL THAT ARE REQUIRED FOR A CONTRACTOR TO BEGIN A RESURFACING CONTRACT. ANY ADDITIONAL SIGNS REQUESTED BY NCDOT DIVISIONS SHALL BE INSTALLED WITHIN 7 BUSINESS DAYS OF THE START OF CONTRACT WORK.

MAPS LESS THAN 2 MILES

FOR RESURFACING MAPS WITH CONSTRUCTION LIMITS LESS THAN 2 MILES IN LENGTH, NO STATIONARY SIGNS ARE REQUIRED. USE PORTABLE "ROAD UNDER CONSTRUCTION" OR "ROAD WORK AHEAD" SIGNS IN LIEU OF STATIONARY ADVANCE WARNINGS SIGNS.

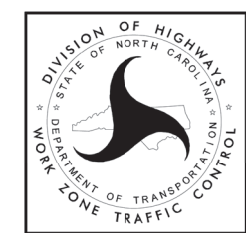

ADVANCE WARNING SIGNS FOR RURAL AND SUBURBAN 2-LANE ROADWAY RESURFACING

High Speed Detection (≥40 mph)

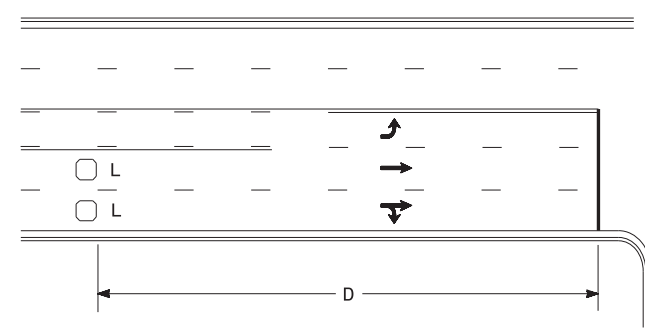

| Speed Limit mph | D ft |
|--------------------|---------|
| 40 | 250 |
| 45 | 300 |
| 50 | 355 |
| 55 | 420 |

L = 6ft X 6ft
Wired separately

Volume Density Operation

OR

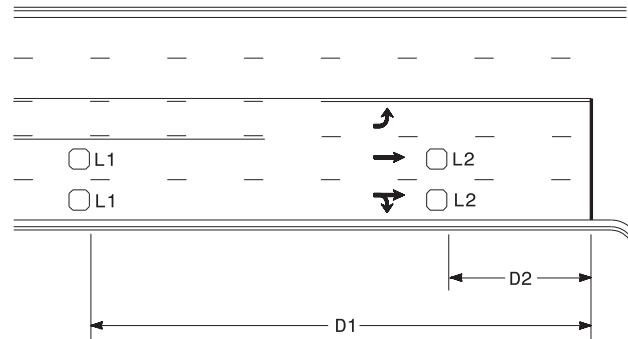

| Speed Limit mph | D1 ft | D2 ft |
|--------------------|----------|----------|
| 40 | 250 | 80 |
| 45 | 300 | 90 |
| 50 | 355 | 100 |
| 55 | 420 | 110 |

L1 = 6ft X 6ft
Wired in series

L2 = 6ft X 6ft
Wired in series

"Stretch" Operation

Low Speed Detection (≤35 mph)

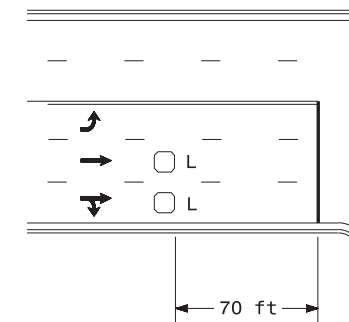

L = 6ft X 6ft
Wired in series

OR

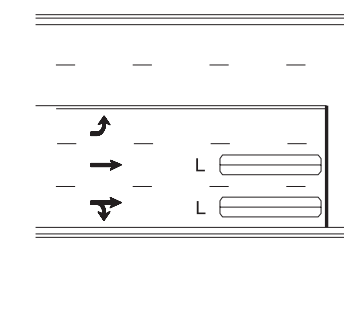

L = 6ft X 40ft
Quadrupole loop, wired separately

Left Turn Lane Detection

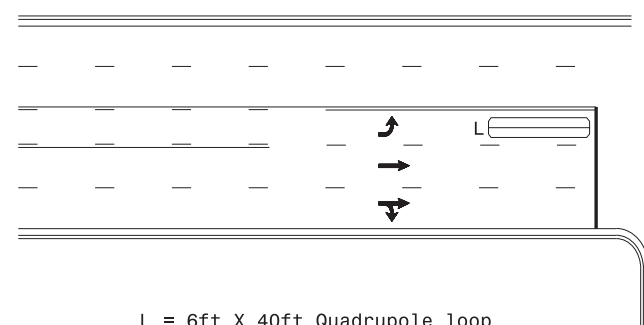

L = 6ft X 40ft Quadrupole loop

Presence Loop Detection

OR

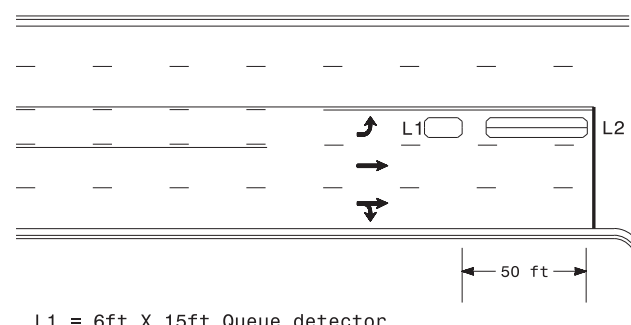

L1 = 6ft X 15ft Queue detector
L2 = 6ft X 40ft Quadrupole loop

Queue Loop Detection

Right Turn Lane Detection

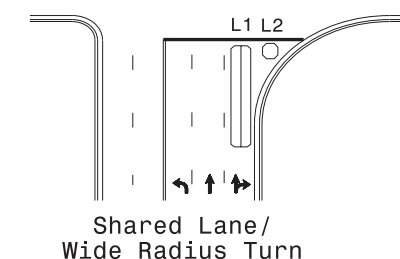

L1 = 6ft X 40ft Quadrupole loop
L2 = 6ft X 6ft [Minimum] Presence loop
Wired separately

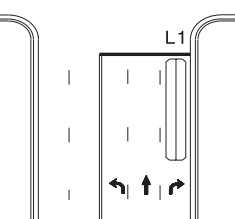

Standard Turn

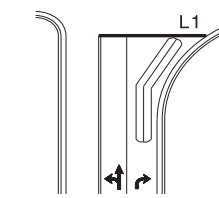

Wide Radius Turn

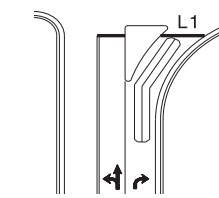

Channelized Turn

Side Street Detection

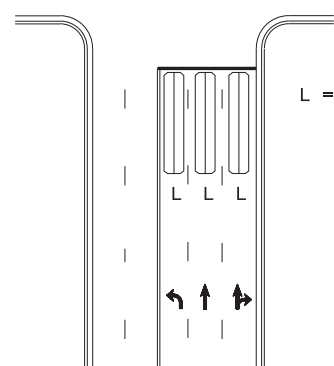

L = 6ft X 40ft
Quadrupole loop
Wired to separate
detectors/channels

Presence Loop Placement at Stop Lines

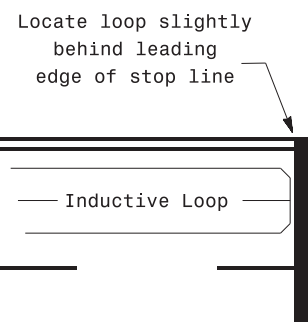

Note:
Loop may be located in advance of stop line under any of the following conditions:
1) stop line is greater than 15' from edge of intersecting roadway
2) loop detects a permissive or protected/permissive left turn
3) for an exclusive right turn lane

Recommended Number of Turns

Single 6' X 6' loop
(when wired separately):

| Length of Lead-in ft | Number of Turns |
|-------------------------|-----------------|
| < 250 | 3 |
| 250-375 | 4 |
| 375-525 | 5 |
| > 525 | 6 |

Quadrupole loops: Use 2-4-2 turns

6' X 15' Loops:
Lead-in < 150', use 2 turns
Lead-in > 150', use 3 turns

750 N. Greenfield Pkwy, Garner, NC 27529

Prepared in the Offices of:

TRANSPORTATION MOBILITY AND SAFETY DIVISION
STATE OF NORTH CAROLINA
STATE OF TRANSPORTATION
Signal Design Section

SEAL
NORTH CAROLINA
PROFESSIONAL ENGINEER
029904
JASON P. GALLOWAY

| Typical Signal Loop Locations | |
|-------------------------------|-----------------------|
| PLAN DATE: September 2020 | REVIEWED BY: JPG |
| PREPARED BY: PLA | REVIEWED BY: |
| SCALE: N/A | REVISIONS: INIT. DATE |
| | |
| | |

9/8/2020
DATE
SIG. INVENTORY NO.