

PROJECT REFERENCE NO.	SHEET NO.
U-6202	EC-18/CONST.18
RW SHEET NO.	
ROADWAY DESIGN ENGINEER	HYDRAULICS ENGINEER
CASSIDY B. BAILEY	

CLEARING AND GRUBBING
 EROSION CONTROL FOR
 CONSTRUCTION SHEET 18

NOTE:
 PLACE TEMPORARY ROCK SEDIMENT DAMS TYPE - B
 AND TEMPORARY ROCK SILT CHECKS TYPE - A AT
 DRAINAGE OUTLETS.

INSTALL FABRIC INSERT INLET PROTECTION DEVICE IN LIEU OF
 ROCK INLET SEDIMENT TRAP TYPE 'C' AS DIRECTED BY ENGINEER.

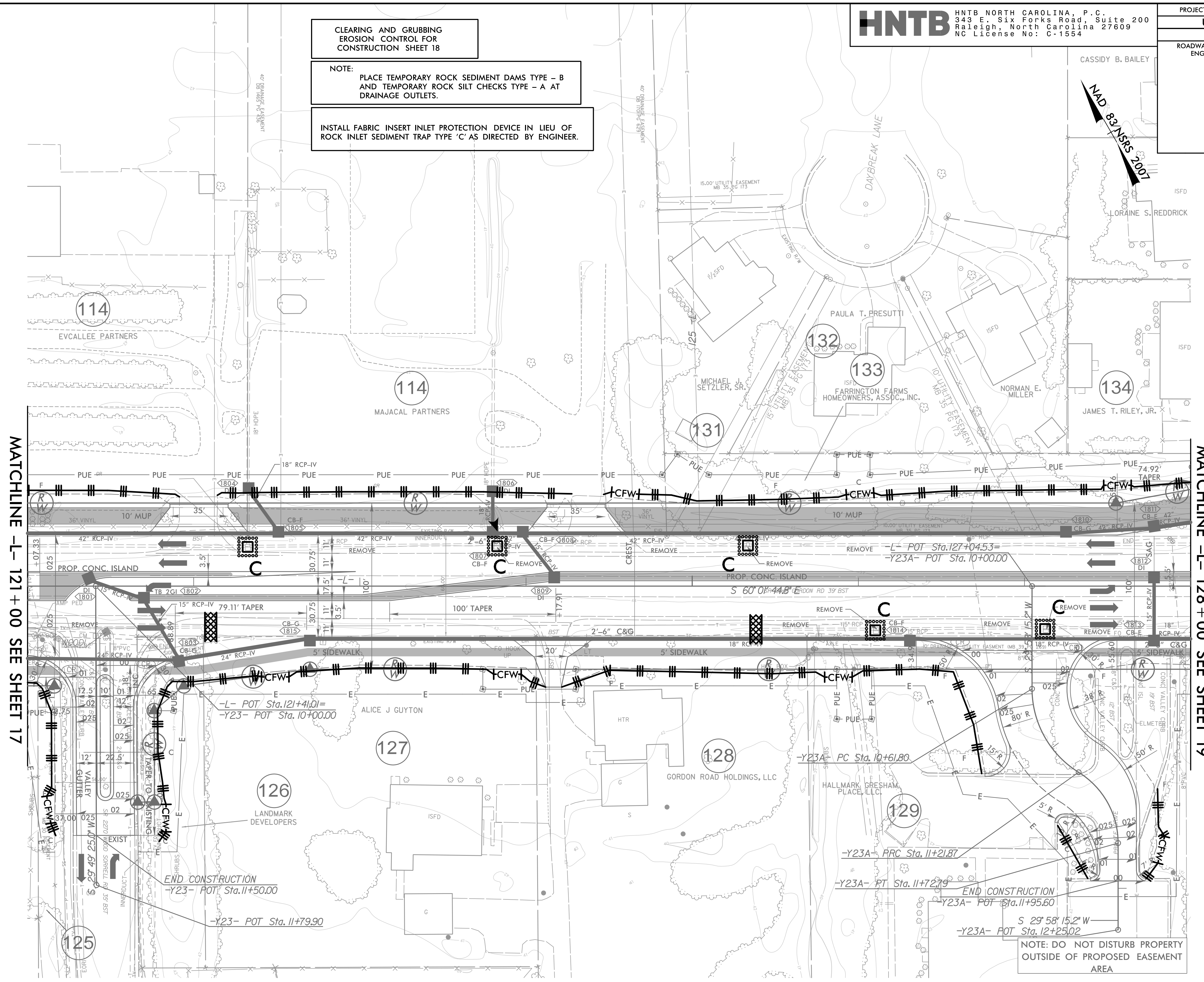
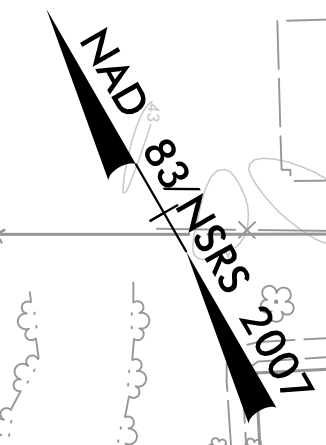

MATCHLINE -L- 121 + 00 SEE SHEET 17

MATCHLINE -L- 128 + 00 SEE SHEET 19

NOTE: DO NOT DISTURB PROPERTY
 OUTSIDE OF PROPOSED EASEMENT
 AREA

NOTE:
 1. ALL DRIVEWAYS HAVE 10' RADII UNLESS OTHERWISE NOTED.

FOR -L- PROFILE, SEE SHEET 30
 FOR -Y23- PROFILE, SEE SHEET 37
 FOR -Y23A- PROFILE, SEE SHEET 38
 FOR INTERSECTION DETAIL, SEE SHEET 2B-3

REVISIONS

8/17/99

4/17/2024
 4/17/2024 EC.PSH18.dgn
 HNTB