

TIP PROJECT: U-6202

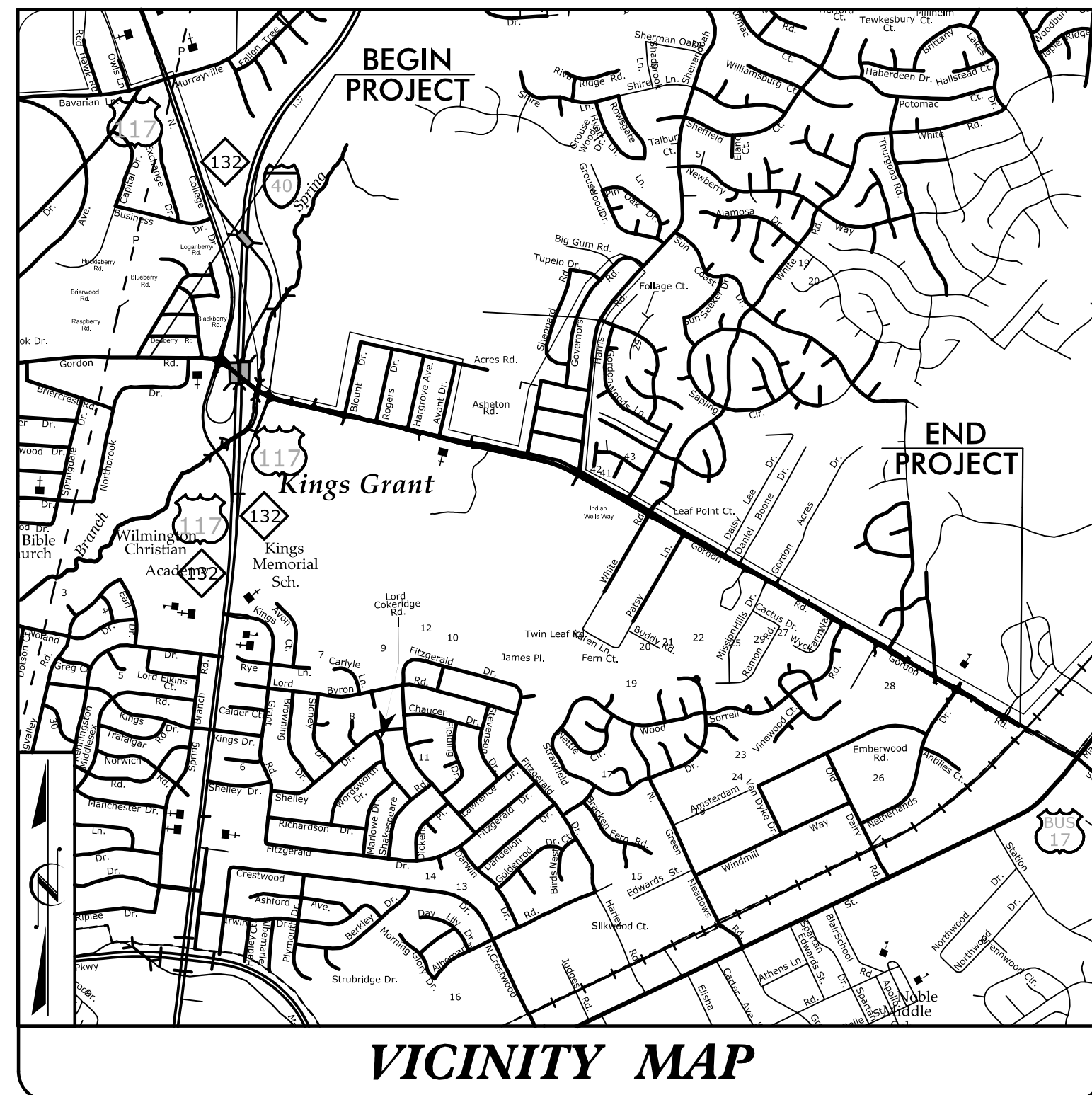

VICINITY MAP

STATE OF NORTH CAROLINA
DIVISION OF HIGHWAYS
**PLAN FOR PROPOSED
HIGHWAY EROSION CONTROL**

NEW HANOVER COUNTY

**LOCATION: SR 2048 (GORDON ROAD) FROM
WEST OF INTERSTATE-40 TO
WEST OF US 17 BUS (MARKET STREET)**

TYPE OF WORK: GRADING, DRAINAGE, PAVING, CULVERT, AND SIGNALS

STATE	STATE PROJECT REFERENCE NO.	SHEET NO.	TOTAL SHEETS
N.C.	U-6202	EC-1	
STATE PROJ. NO.	F.A. PROJ. NO.	DESCRIPTION	

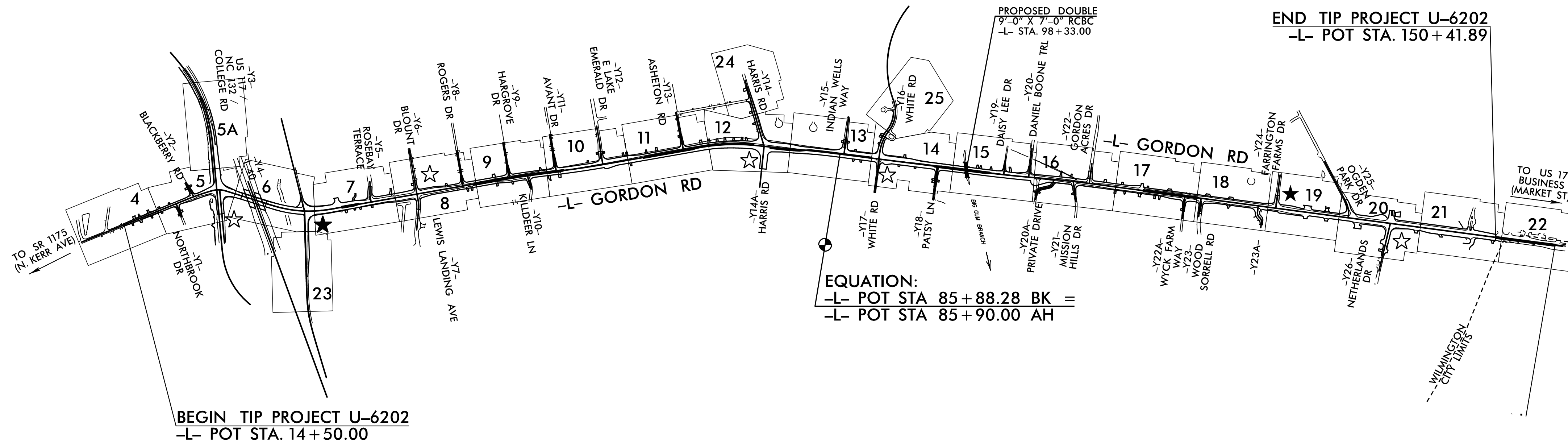

EQUATION:
-L- POT STA 85+88.28 BK =
-L- POT STA 85+90.00 AH

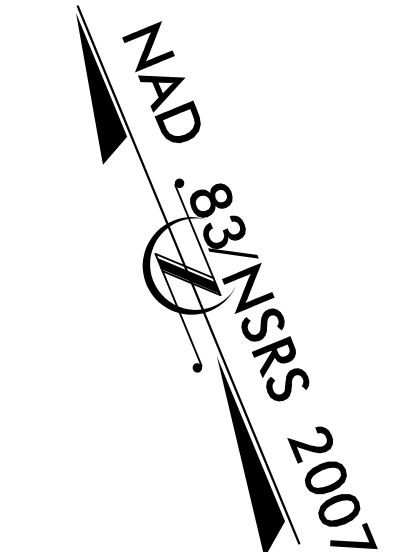

**THIS PROJECT CONTAINS
EROSION CONTROL PLANS
FOR CLEARING AND
GRUBBING PHASE OF
CONSTRUCTION.**

**THE OUTSIDE BUFFER, WETLAND,
OR WATER BOUNDARY SHALL
BE CLEARLY MARKED BY
HIGHLY VISIBLE FENCING
(ORANGE SAFETY FENCE)**

GRAPHIC SCALE



**THESE EROSION AND SEDIMENT CONTROL PLANS COMPLY WITH
THE APPLICABLE REGULATIONS SET FORTH BY THE NCG-01000
GENERAL CONSTRUCTION PERMIT EFFECTIVE APRIL 1, 2019
AND ISSUED BY THE NORTH CAROLINA DEPARTMENT OF
ENVIRONMENTAL QUALITY DIVISION OF WATER RESOURCES.**

HNTB

PREPARED IN THE OFFICE OF:
HNTB HNTB NORTH CAROLINA, P.C.
343 E. Six Forks Road, Suite 200
Raleigh, North Carolina 27609
NC License No: C-15554
FOR NCDOT DIVISION 3

Designed by:

NATALIE CHAN, P.E.
NAME

3444
LEVEL III CERTIFICATION NO.

Roadway Standard Drawings

The "Roadway Standard Drawings"- Roadway Design Unit - N. C. Department of Transportation - Raleigh, N. C., dated January 2024 and the latest revision thereto are applicable to this project and by reference hereby are considered a part of these plans.