

TIP PROJECT: U-6202

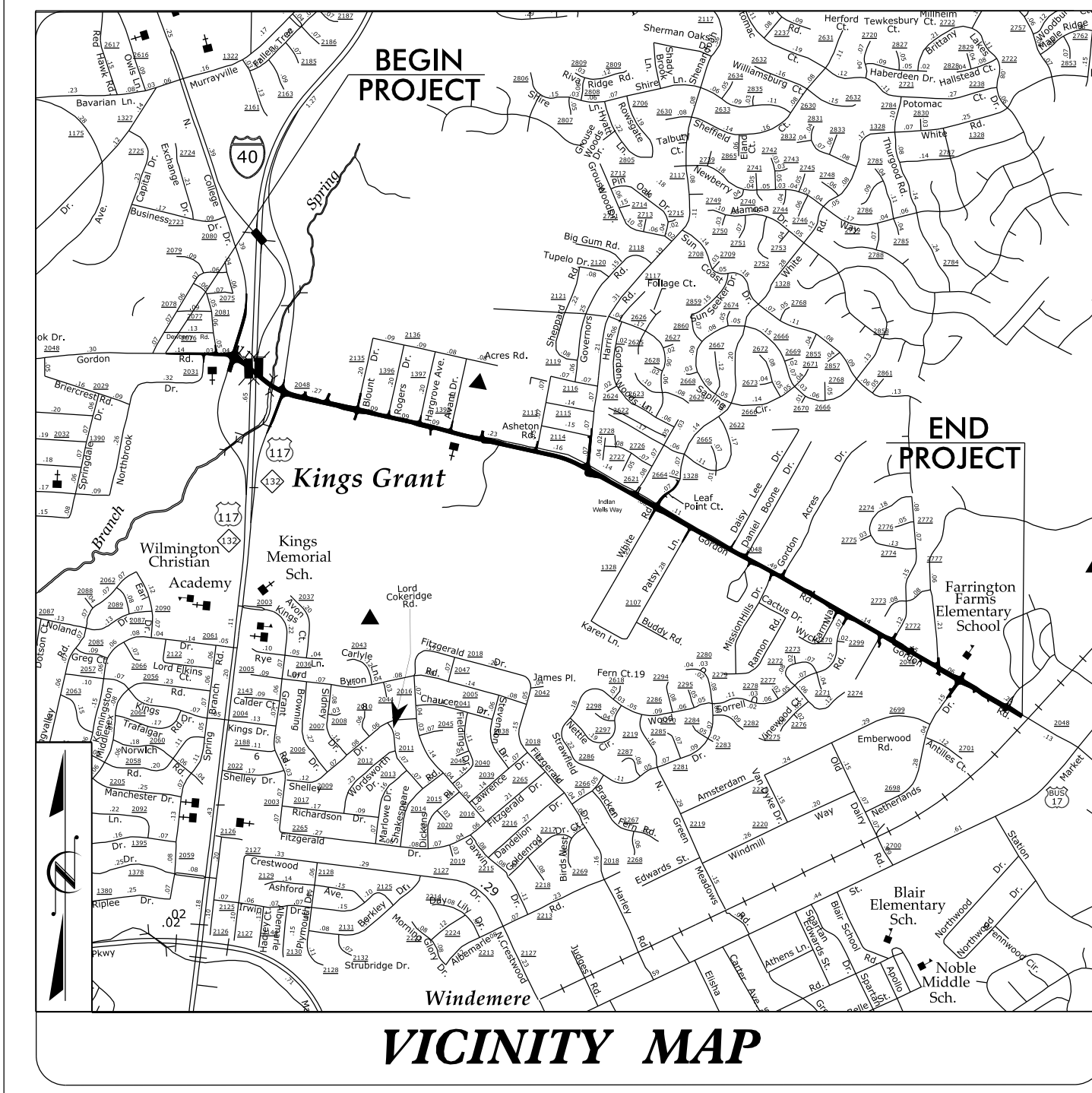

SEPTEMBER 11, 2023 - REVISED ROW PLAN SET

STATE OF NORTH CAROLINA
DIVISION OF HIGHWAYS

SURVEY CONTROL, EXISTING CENTERLINES,
RIGHT OF WAY, EASEMENTS
AND PROPERTY TIES

NEW HANOVER COUNTY

STATE	STATE PROJECT REFERENCE NO.	SHEET NO.	TOTAL SHEETS
N.C.	48662.1.1	RW01	47

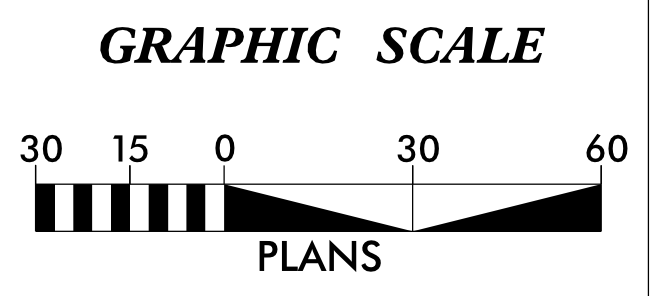
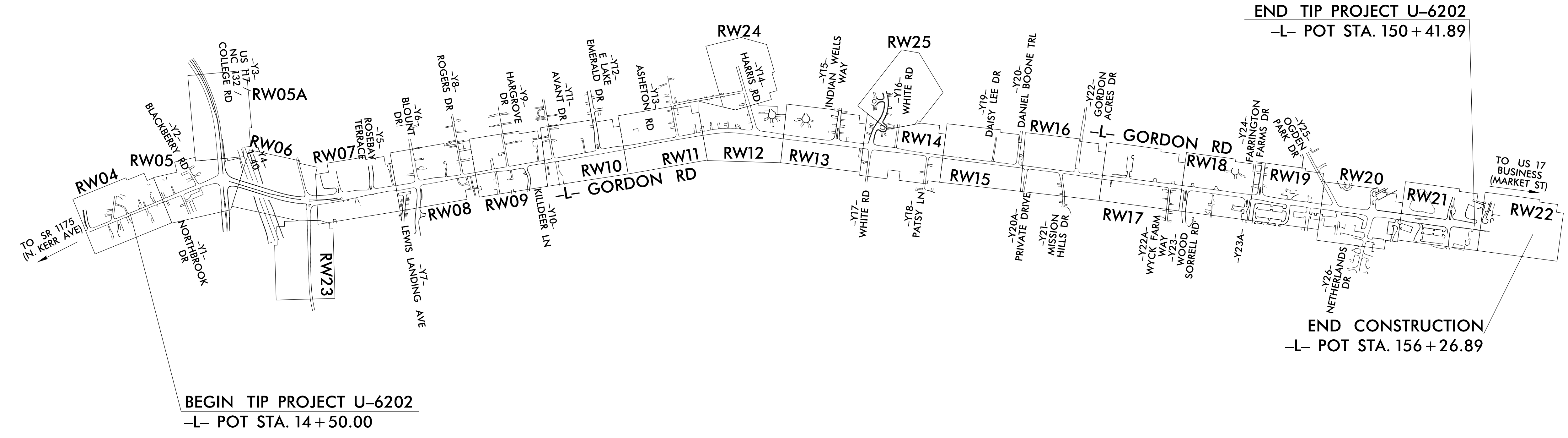
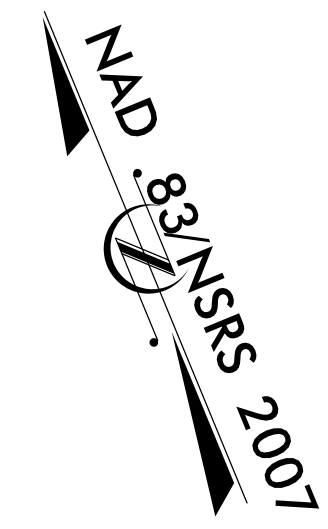

DATUM DESCRIPTION

THE LOCALIZED COORDINATE SYSTEM DEVELOPED FOR THIS PROJECT IS BASED ON THE STATE PLANE COORDINATES ESTABLISHED BY NCDOT FOR MONUMENT "P-122" (U-4751) WITH NAD 83/NSRS 2007 STATE PLANE GRID COORDINATES OF NORTHING: 205424.53(ft) EASTING: 2360493.54(ft)

THE AVERAGE COMBINED GRID FACTOR USED ON THIS PROJECT (GROUND TO GRID) IS: 1.000012368

THE N.C. LAMBERT GRID BEARING AND LOCALIZED HORIZONTAL GROUND DISTANCE FROM "P-122" TO -L- STATION 10+00.00 IS S 61°05'30.35" W 23144.72(ft)

ALL LINEAR DIMENSIONS ARE LOCALIZED HORIZONTAL DISTANCES



4300 EDWARDS MILL RD
RALEIGH, NC 27612
(P) 919-233-8091

2018 STANDARD SPECIFICATIONS

RIGHT OF WAY DATE:
06/17/2022

LETTING DATE:
07/16/2024

PROFESSIONAL LAND SURVEYOR



DocuSigned by:
Jeffrey D. Aker
15853A597D5E41D...

5/6/2024
Date:

