

8.17.19

| | |
|--|------------------------|
| PROJECT REFERENCE NO. U-6202 | SHEET NO. 10 |
| RW SHEET NO. | |
| ROADWAY DESIGN ENGINEER | HYDRAULICS ENGINEER |
| | |
| DOCUMENT NOT CONSIDERED FINAL UNLESS ALL SIGNATURES COMPLETED | |

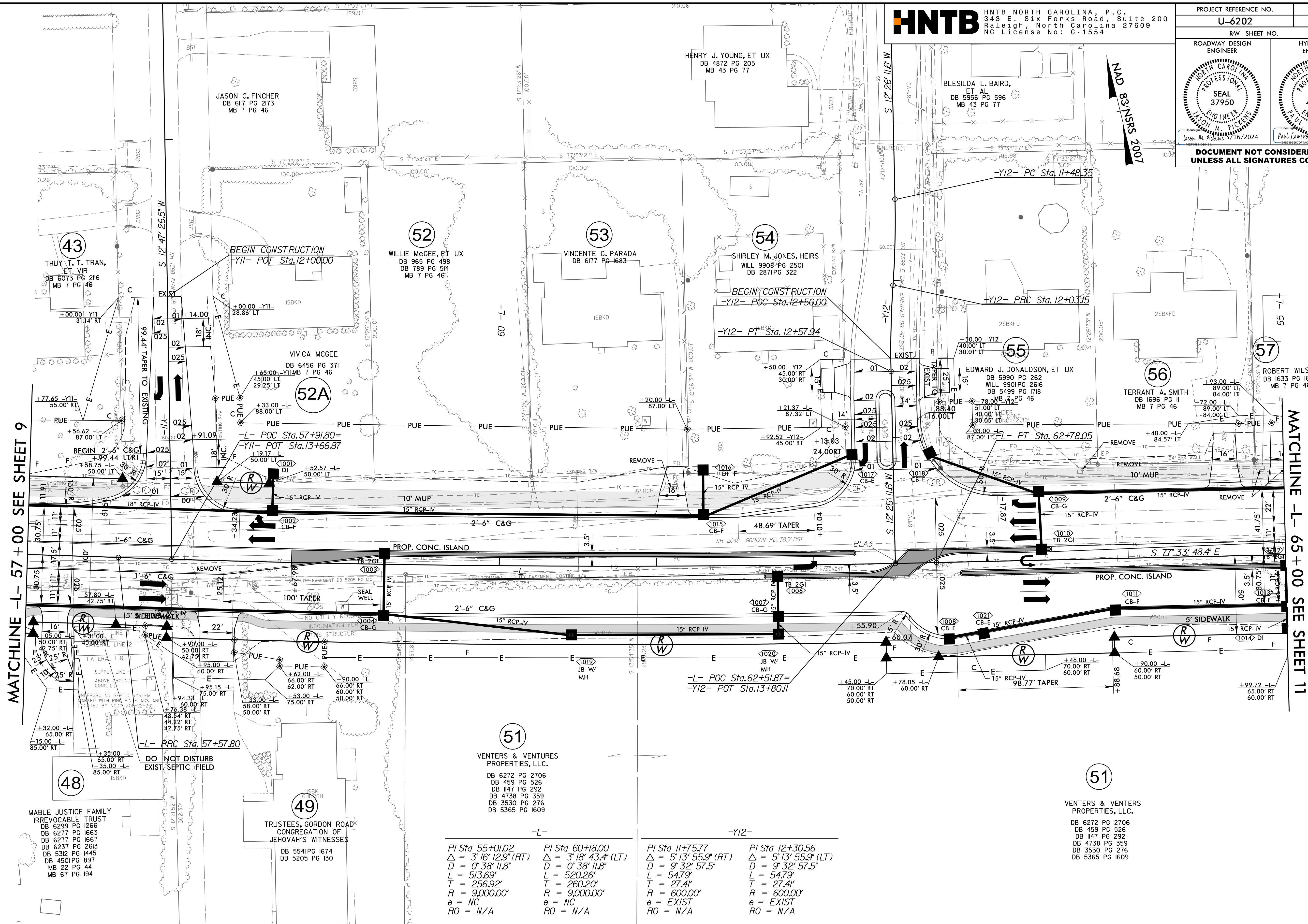

MATCHLINE -L- 57 + 00 SEE SHEET 9

MATCHLINE -L- 65 + 00 SEE SHEET 11

NOTE:
 1. ALL DRIVEWAYS HAVE 10' RADII UNLESS OTHERWISE NOTED.

| -L- | -Y12- | -L- | -Y12- |
|-------------------------------|-------------------------------|-------------------------------|-------------------------------|
| PI Sta 55+01.02 | PI Sta 60+18.00 | PI Sta 11+75.77 | PI Sta 12+30.56 |
| $\Delta = 3' 16' 12.9''$ (RT) | $\Delta = 3' 18' 43.4''$ (LT) | $\Delta = 5' 13' 55.9''$ (RT) | $\Delta = 5' 13' 55.9''$ (LT) |
| $D = 0' 38' 11.8''$ | $D = 0' 38' 11.8''$ | $D = 9' 32' 57.5''$ | $D = 9' 32' 57.5''$ |
| $L = 513.69'$ | $L = 520.26'$ | $L = 54.79'$ | $L = 54.79'$ |
| $T = 256.92'$ | $T = 260.20'$ | $T = 27.4'$ | $T = 27.4'$ |
| $R = 9,000.00'$ | $R = 9,000.00'$ | $R = 600.00'$ | $R = 600.00'$ |
| $e = NC$ | $e = NC$ | $e = EXIST$ | $e = EXIST$ |
| $RO = N/A$ | $RO = N/A$ | $RO = N/A$ | $RO = N/A$ |

FOR -L- PROFILE, SEE SHEET 27
 FOR -Y11- PROFILE, SEE SHEET 34
 FOR -Y12- PROFILE, SEE SHEET 35
 FOR INTERSECTION DETAIL, SEE SHEET 2B-2

13 MAY 2024 09:05
 P:\Projects\2024\U-6202-RD\PSH\0.dgn
 HNTB