

REVISIONS

14-MAR-2022 08:10 C:\p1601\2021\2021014.73\SURV\w sheets\5726\1s.rwl.dgn AT NCCAR-GRANS100 scott@eanford

MATCHLINE -L- STA. 101 +00.00 SEE SHEET NO. 10

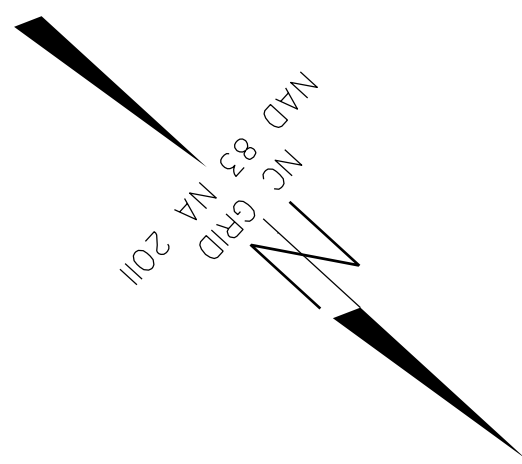
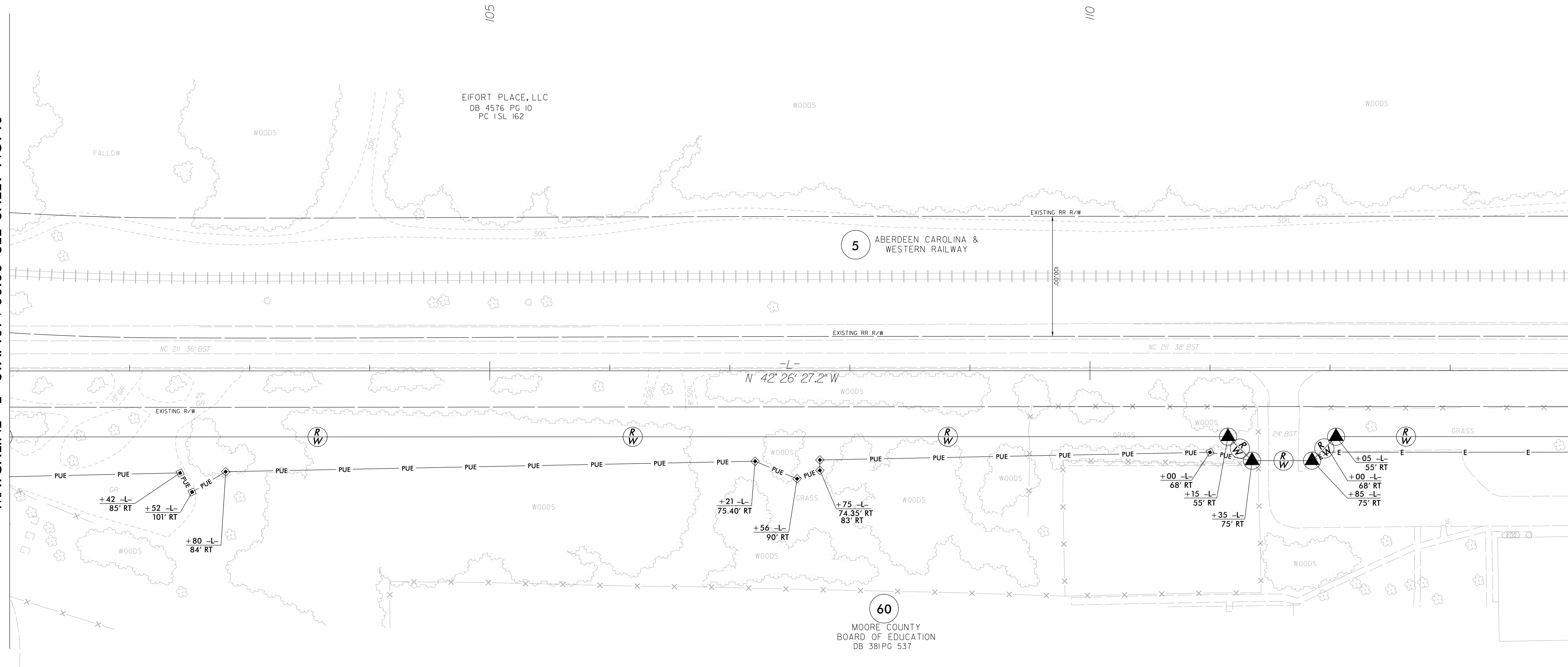

I, C. Andrew Heath, Jr., certify that the right of way and permanent easement monumentation for this project shown herein was completed under my direct and responsible charge from an actual survey made under my supervision; that all horizontal closures had a minimum ratio of precision of 1:10,000 (Class A). Field work was performed from 11/03/2021 to 03/11/2022, and all coordinates are based on NAD83/2011; That this survey was performed to meet the requirements of 21NCAC 56.1600 as applicable.

This 14th day of March, 2022.  
 C. Andrew Heath, Jr.  
 Professional Land Surveyor L-3281

PROJECT REFERENCE NO. R-5726	SHEET NO. RW11
<b>Location and Surveys</b>	
<small>NV5 ENGINEERS &amp; CONSULTANTS, INC.        3300 REGENCY PARKWAY, SUITE 100        CARR, NC 27518        P: 919.851.1912 www.NV5.com        NC License # F-1333        Services: Civil Engineers &amp; Consultants</small>	
PROJECT SURVEYOR	
DOCUMENT NOT CONSIDERED FINAL UNLESS ALL SIGNATURES COMPLETED	

MATCHLINE -L- STA. 114 +00.00 SEE SHEET NO. 12

**NOTES:**

1. IF FURTHER INFORMATION REGARDING PROJECT CONTROL IS NEEDED PLEASE CONTACT THE LOCATION AND SURVEYS UNIT.
2. PROJECT CONTROL WAS ESTABLISHED USING GNSS, THE GLOBAL NAVIGATION SATELLITE SYSTEM.
3. RIGHT OF WAY MONUMENTATION ESTABLISHED NOVEMBER 2021 TO MARCH 2022 .