

TIP PROJECT: R-5726

STATE	STATE PROJECT REFERENCE NO.	SHEET NO.	TOTAL SHEETS
N.C.	R-5726	RW01	42

STATE OF NORTH CAROLINA
 DIVISION OF HIGHWAYS
 SURVEY CONTROL, EXISTING CENTERLINES,
 RIGHT OF WAY, EASEMENTS AND PROPERTY TIES
MOORE COUNTY

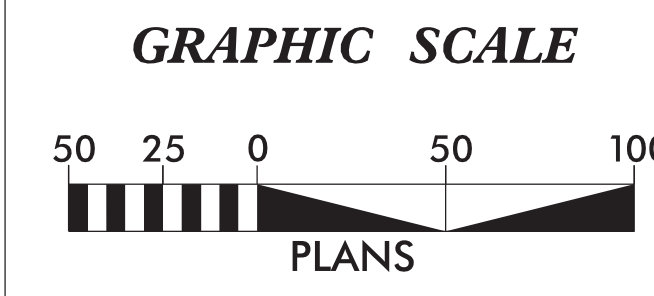
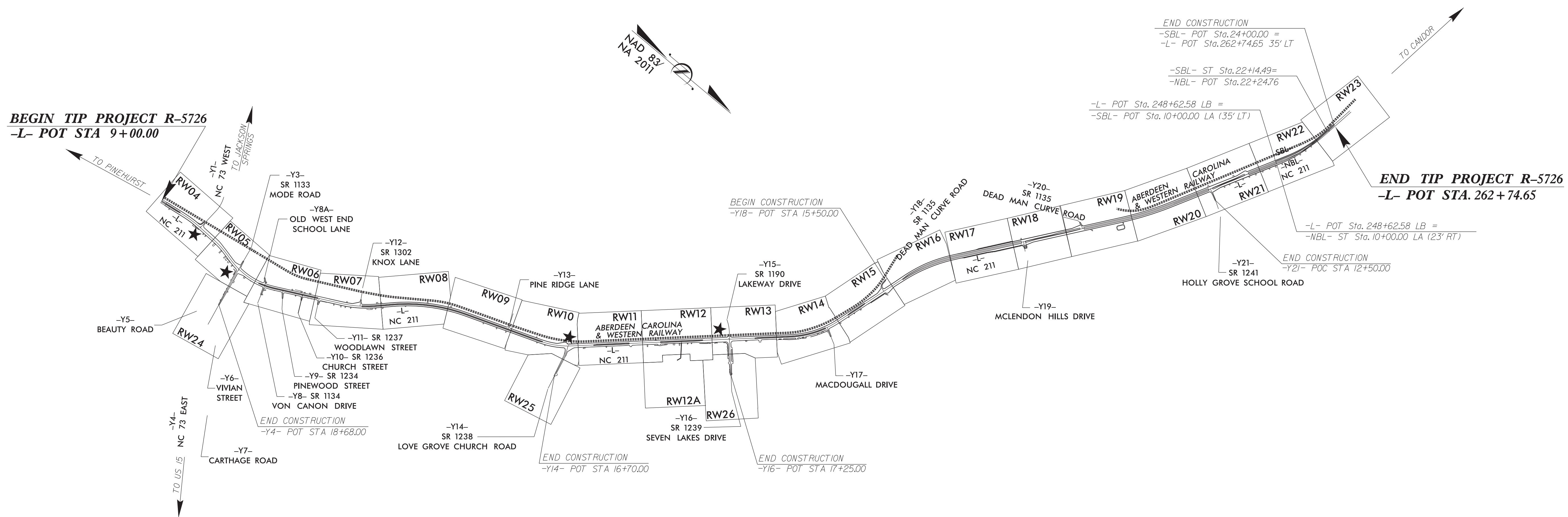

DATUM DESCRIPTION

THE LOCALIZED COORDINATE SYSTEM DEVELOPED FOR THIS PROJECT IS BASED ON THE STATE PLANE COORDINATES ESTABLISHED BY NCDOT FOR MONUMENT "R5726-7" WITH NAD 83/NA 2011 STATE PLANE GRID COORDINATES OF NORTHING: 551,275.724(ft) EASTING: 1,825,309.563(ft) ELEVATION: 611.021(ft)

THE AVERAGE COMBINED GRID FACTOR USED ON THIS PROJECT (GROUND TO GRID) IS: 0.999848475

THE N.C. LAMBERT GRID BEARING AND LOCALIZED HORIZONTAL GROUND DISTANCE FROM "R5726-7" TO -L- STATION 9+00.00 IS S 26-21'19.2" E 11817.650(ft)

ALL LINEAR DIMENSIONS ARE LOCALIZED HORIZONTAL DISTANCES VERTICAL DATUM USED IS NAVD 88-GEOID 12B

Prepared in the Office of:

NIV5

NIV5 ENGINEERS & CONSULTANTS, INC.
 3300 REGENCY PARKWAY, SUITE 100
 CARY, NC 27518
 P: 919.851.1912 www.NIV5.com
 NC License #11333 formerly CALYX Engineers & Consultants

2018 STANDARD SPECIFICATIONS

RIGHT OF WAY DATE:
 06/29/2018

LETTING DATE:
 11/19/2024

PROFESSIONAL LAND SURVEYOR

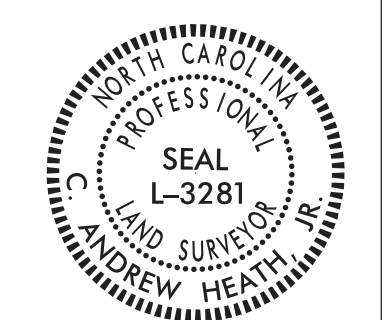

DocuSigned by:
 C. Andrew Heath Jr.
 20201481929747F...

Date:
 3/17/2022

