

5/14/99

PROJECT REFERENCE NO. <i>R-5726</i>	SHEET NO. <i>36</i>
ROADWAY DESIGN ENGINEER MOTT MACDONALD I & E, LLC LICENSE NO. F-0669	HYDRAULICS ENGINEER HDR ENGINEERING LICENSE NO. F-0116
DOCUMENT NOT CONSIDERED FINAL UNLESS ALL SIGNATURES COMPLETED	
Prepared in the Office of:	
M MOTT MACDONALD	M HDR Engineering, Inc. of the Carolinas 930 Main Campus Drive, Suite 200 Raleigh, NC 27606 www.mottmac.com

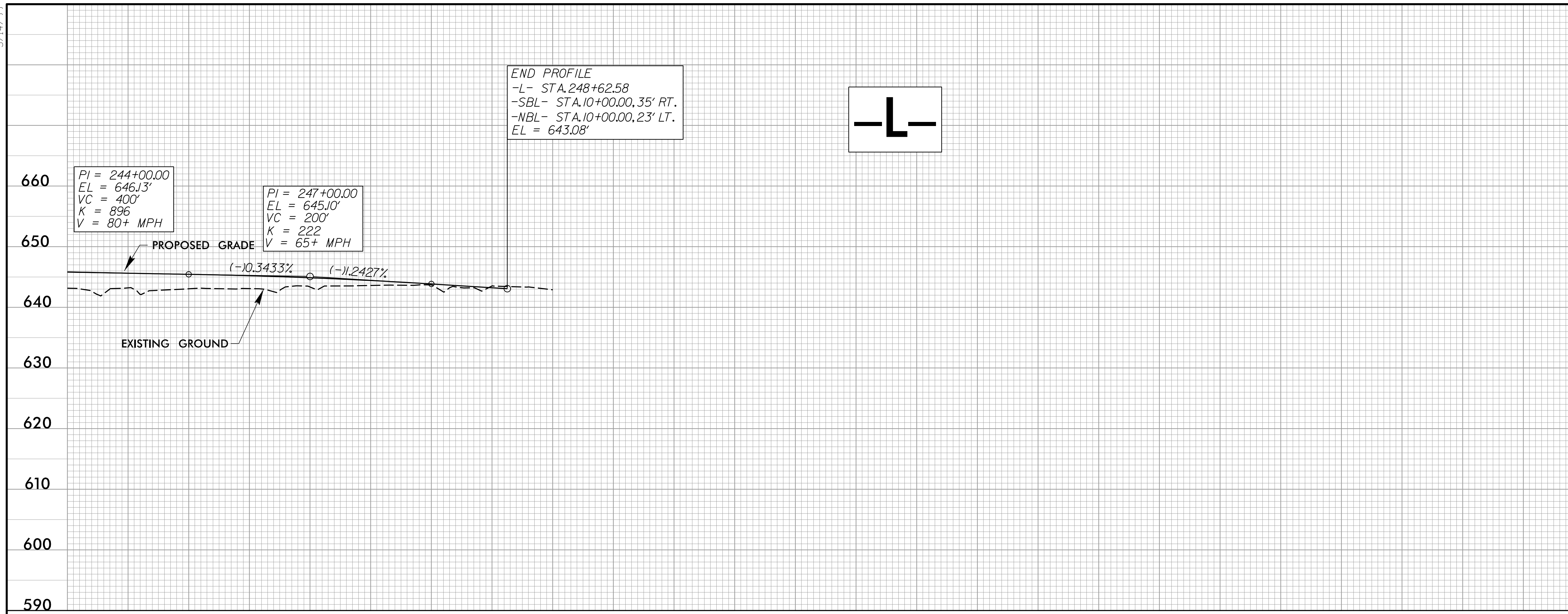

END PROFILE
 -L- STA. 248+62.58
 -SBL- STA. 10+00.00, 35' RT.
 -NBL- STA. 10+00.00, 23' LT.
 EL = 643.08'

PI = 244+00.00
 EL = 646.13'
 VC = 400'
 K = 896
 V = 80+ MPH

PI = 247+00.00
 EL = 645.10'
 VC = 200'
 K = 222
 V = 65+ MPH

660
650
640
630
620
610
600
590

640
630
620
610
600
590

245 246 247 248 249

LEFT DITCH -----
 RIGHT DITCH -----
 -L- PLANS SEE SHEETS 22 & 23

7/25/2024
R:\Projects\5726\Drawings\Profile\psh.dgn